



1017603

IN ALL CASES PLOT THE INTENDED WELL ON THE PLAT BELOW

Plat of acreage attributable to a well in a prorated or spaced field

If the intended well is in a prorated or spaced field, please fully complete this side of the form. If the intended well is in a prorated or spaced field complete the plat below showing that the well will be properly located in relationship to other wells producing from the common source of supply. Please show all the wells and within 1 mile of the boundaries of the proposed acreage attribution unit for gas wells and within 1/2 mile of the boundaries of the proposed acreage attribution unit for oil wells.

API No. 15 - _____

Operator: _____

Lease: _____

Well Number: _____

Field: _____

Number of Acres attributable to well: _____

QTR/QTR/QTR/QTR of acreage: _____ - _____ - _____ - _____

Location of Well: County: _____

_____ feet from N / S Line of Section

_____ feet from E / W Line of Section

Sec. _____ Twp. _____ S. R. _____ E W

Is Section: Regular or Irregular

If Section is Irregular, locate well from nearest corner boundary.

Section corner used: NE NW SE SW

PLAT

(Show location of the well and shade attributable acreage for prorated or spaced wells.)

(Show footage to the nearest lease or unit boundary line.)

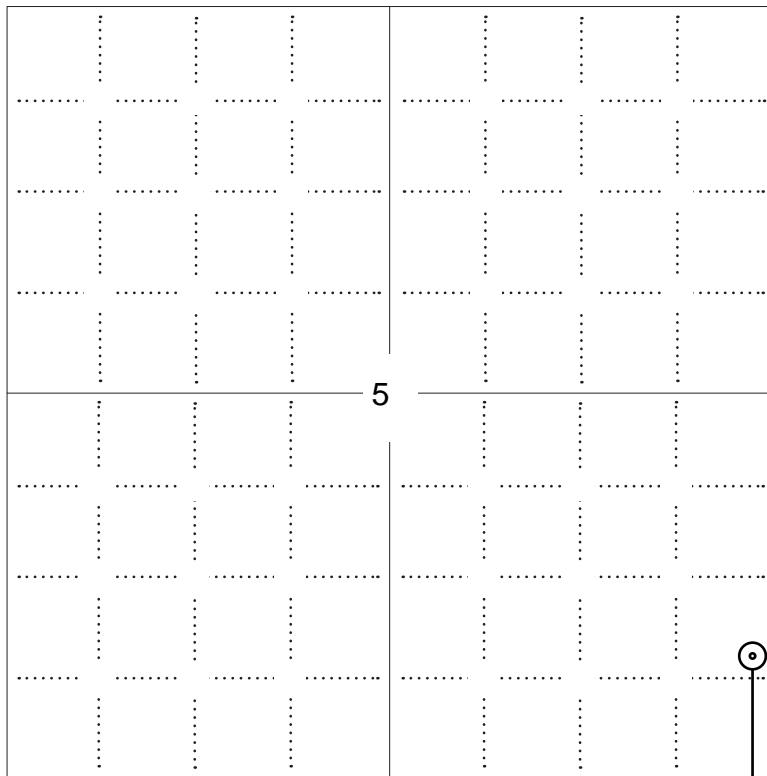

NOTE: In all cases locate the spot of the proposed drilling locaton.

150 ft.

840 ft.

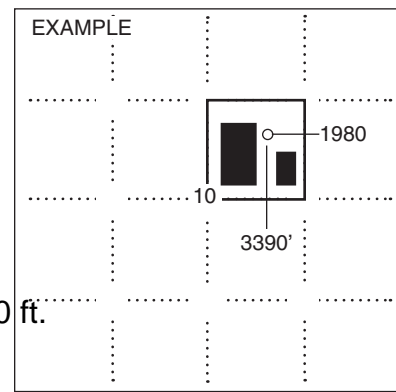

In plotting the proposed location of the well, you must show:

1. The manner in which you are using the depicted plat by identifying section lines, i.e. 1 section, 1 section with 8 surrounding sections, 4 sections, etc.
2. The distance of the proposed drilling location from the south / north and east / west outside section lines.
3. The distance to the nearest lease or unit boundary line (in footage).
4. If proposed location is located within a prorated or spaced field a certificate of acreage attribution plat must be attached: (C0-7 for oil wells; CG-8 for gas wells).



KANSAS CORPORATION COMMISSION 1017603
OIL & GAS CONSERVATION DIVISION

Form CDP-1
April 2004
Form must be Typed

APPLICATION FOR SURFACE PIT

Submit in Duplicate

Operator Name: _____		License Number: _____	
Operator Address: _____			
Contact Person: _____		Phone Number: _____	
Lease Name & Well No.: _____		Pit Location (QQQQ): _____ - _____ - _____ - _____	
Type of Pit: <input type="checkbox"/> Emergency Pit <input type="checkbox"/> Burn Pit <input type="checkbox"/> Settling Pit <input type="checkbox"/> Drilling Pit <input type="checkbox"/> Workover Pit <input type="checkbox"/> Haul-Off Pit <i>(If WP Supply API No. or Year Drilled)</i>		Pit is: <input type="checkbox"/> Proposed <input type="checkbox"/> Existing If Existing, date constructed: _____ Pit capacity: _____ (bbls)	
Is the pit located in a Sensitive Ground Water Area? <input type="checkbox"/> Yes <input type="checkbox"/> No		Chloride concentration: _____ mg/l <i>(For Emergency Pits and Settling Pits only)</i>	
Is the bottom below ground level? <input type="checkbox"/> Yes <input type="checkbox"/> No		Artificial Liner? <input type="checkbox"/> Yes <input type="checkbox"/> No	
How is the pit lined if a plastic liner is not used?		_____	
Pit dimensions (all but working pits): _____ Length (feet) _____ Width (feet) _____ N/A: Steel Pits Depth from ground level to deepest point: _____ (feet) _____ No Pit			
If the pit is lined give a brief description of the liner material, thickness and installation procedure.		Describe procedures for periodic maintenance and determining liner integrity, including any special monitoring.	
Distance to nearest water well within one-mile of pit _____ feet Depth of water well _____ feet		Depth to shallowest fresh water _____ feet. Source of information: _____ measured _____ well owner _____ electric log _____ KDWR	
Emergency, Settling and Burn Pits ONLY: Producing Formation: _____ Number of producing wells on lease: _____ Barrels of fluid produced daily: _____ Does the slope from the tank battery allow all spilled fluids to flow into the pit? <input type="checkbox"/> Yes <input type="checkbox"/> No		Drilling, Workover and Haul-Off Pits ONLY: Type of material utilized in drilling/workover: _____ Number of working pits to be utilized: _____ Abandonment procedure: _____ _____ Drill pits must be closed within 365 days of spud date.	
Submitted Electronically			

KCC OFFICE USE ONLY		Steel Pit	RFAC	RFAS
Date Received: _____	Permit Number: _____	Permit Date: _____	Lease Inspection: <input type="checkbox"/> Yes <input type="checkbox"/> No	

NESS COUNTY

SCHABEN MISSISSIPPI OIL POOL (19-21W, 19-22W, 20-21W & 20-22W): Mississippian

- 1) **Docket No.** 194,757-C (C-28, 006)
- 2) **Order(s) Issued** November 12, 1996
- 3) **Effective Date** not given—November 12, 1996?
- 4) **Acreage** ~
 - A) **T 19S-21W**
 - (1) **Section 19:** South Half (S/2)
 - (2) **Sections 29-31:** all
 - (3) **Section 32:** North Half (N/2) & Southwest Quarter (SW/4)
 - B) **T 19S-22W**
 - (1) S/2 of **Sec.24 + Section 25:** all
 - (2) **Section 36:** all
 - C) **T 20S-21W: Sections 5-8:** all
 - D) **T 20S-22W**
 - (1) **Section 1:** all
 - (2) **Section 12:** E/2 of Se/4 and all of NE/4
- 5) **Spacing** (p. 4 of 11/12/96 Order)
 - A) 40 adjoining and contiguous acres per unit and length shall not exceed the width
 - B) 2 wells per unit
 - C) Wells located no nearer than 400 feet from a unit boundary
- 6) **Prorated** (p. 5 of 11/12/96 Order)
 - A) Each of 2 wells on unit have daily allowable of 44 bbls
 - B) In no case shall allowable be greater than wells' productivity, as determined by Commission
- 7) **Termination** not given

AMENDED DECLARATION OF UNITIZATION

KNOW ALL MEN BY THESE PRESENTS:

THAT WHEREAS, John O. Farmer, Inc., is the owner of the following described oil and gas leases, to-wit:

1. An oil and gas lease dated September 29, 2005, from Ida McJunkin, a widow, et al., lessors, to John O. Farmer, Inc., lessee, and recorded in Book 298 at page 596 in the office of the register of deeds of Ness County, Kansas, and
2. An oil and gas lease dated September 29, 2005, from Ivar McJunkin and Betty McJunkin, Trustees of the Ivar McJunkin Revocable Living Trust dated 8/20/96 and of the Betty McJunkin Revocable Living Trust dated 8/20/96, lessors, to John O. Farmer, Inc., lessee, and recorded in Book 298 at page 598 in the office of the register of deeds of Ness County, Kansas;

both of said leases covering the following described lands, to-wit:

The Southeast Quarter (SE/4) of Section Five (5), Township Twenty (20) South, Range Twenty-one (21) West of the 6th P.M., Ness County, Kansas;



AND WHEREAS, John O. Farmer, Inc., is the owner of the following described oil and gas lease, to-wit:

An oil and gas lease dated March 21, 2006, from Larry J. Janke, Trustee of the Kathryn Young Family Trust No. 1, dated 1/25/89, lessor, to John O. Farmer, Inc., lessee, and recorded in Book 307 at page 707 in the office of the register of deeds of Ness County, Kansas, and covering the following described lands, to-wit:

The Southwest Quarter (SW/4) of Section Four (4), Township Twenty (20) South, Range Twenty-one (21) West of the 6th P.M., Ness County, Kansas;

AND WHEREAS, all of the above described leases contain the following described language, to-wit:

“Lessee, at its option, is hereby given the right and power to pool or combine the acreage covered by this lease or any portion thereof with other land, lease or leases in the immediate vicinity

State of Kansas - Ness County
Book: 315 Page: 193
Receipt #: 3871 Recording Fee: \$16.00
Pages Recorded: 3
Cashier Initials: MH
Date Recorded: 3/26/2008 11:25:00 AM

thereof, when in lessee's judgment it is necessary or advisable to do so in order to properly develop and operate said lease premises so as to promote the conservation of oil, gas or other minerals in and under and that may be produced from said premises, such pooling to be of tracts contiguous to one another and to be into a unit or units not exceeding 40 acres each in the event of an oil well, or into a unit or units not exceeding 640 acres each in the event of a gas well. Lessee shall execute in writing and record in the conveyance records of the county in which the land herein leased is situated an instrument identifying and describing the pooled acreage. The entire acreage so pooled into a tract or unit shall be treated, for all purposes except the payment of royalties on production from the pooled unit, as if it were included in this lease. If production is found on the pooled acreage, it shall be treated as if production is had from this lease, whether the well or wells be located on the premises covered by this lease or not. In lieu of the royalties elsewhere herein specified, lessor shall receive on production from a unit so pooled only such portion of the royalty stipulated herein as the amount of his acreage placed in the unit or his royalty interest therein on an acreage basis bears to the total acreage so pooled in the particular unit involved."

AND WHEREAS, the undersigned did, on the 10th day of March, 2008, record a Declaration of Unitization in Book 314 at page 798 in the office of the register of deeds of Ness County, Kansas;

AND WHEREAS, the aforesaid Declaration of Unitization does not correctly describe the unit which the undersigned desires to establish and the undersigned wishes to amend said aforesaid Declaration of Unitization.

NOW THEREFORE, the undersigned hereby declares that the following described real estate is hereby unitized for production of oil and gas, to-wit:

A 40 acre tract beginning 334 feet North and 400 feet East of the Southwest Corner (SW/C) of Section Four (4), Township Twenty (20) South, Range Twenty-one (21) West of the 6th P.M., Ness County, Kansas; thence North 1013 feet; thence West 1720 feet; thence South 1013 feet; thence East 1720 feet to the point of origin (McJunkin Unit).

This unitization shall be effective the 1st day of March, 2008.

JOHN O. FARMER, INC.

By John O. Farmer III
(Title) Vice President

ACKNOWLEDGMENT

STATE OF KANSAS, COUNTY OF RUSSELL, ss:

Before me, the undersigned, a Notary Public, within and for the County and State, on this 25th day of March, 2008, personally appeared John O. Farmer III, (title) Vice President of John O. Farmer, Inc., a Kansas corporation, who executed the within and foregoing AMENDED Declaration Of Unitization and acknowledged to me that he executed the same for and on behalf of, and as the act and deed of said corporation for the uses and purposes therein set forth.

IN WITNESS WHEREOF, I have hereunto set my hand and official seal the day and year last above written.

My appointment expires: 3/28/2011

Trisha K. VonLintel
Notary Public
Trisha K. VonLintel

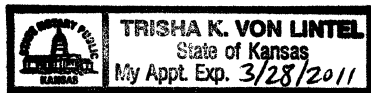

PLAT AND CERTIFICATION OF ACREAGE ATTRIBUTABLE TO A OIL WELL

Kansas Corporation Commission, Conservation Division
 Finney State Office Building, 130 South Market, Room 2078
 Wichita, Kansas 67202

API NUMBER 15- _____

LOCATION OF WELL: COUNTY Ness

OPERATOR John O. Farmer, Inc.

LEASE McJunkin Unit

840 feet from south/north line of section

WELL NUMBER 1

150 feet from east/west line of section

FIELD Schaben

SECTION 5 TWP 20 (S) RG 21 E/W

NUMBER OF ACRES ATTRIBUTABLE TO WELL _____

IS SECTION X REGULAR or _____ IRREGULAR

QTR/QTR/QTR OF ACREAGE _____

IF SECTION IS IRREGULAR, LOCATE WELL FROM
 NEAREST CORNER BOUNDARY. (check line below)

Section corner used: NE NW SE SW

(Show the location of the well and shade attributable acreage for prorated or spaced wells).
 (Show the footage to the nearest lease or unit boundary line; and show footage to the nearest
 common source supply well).

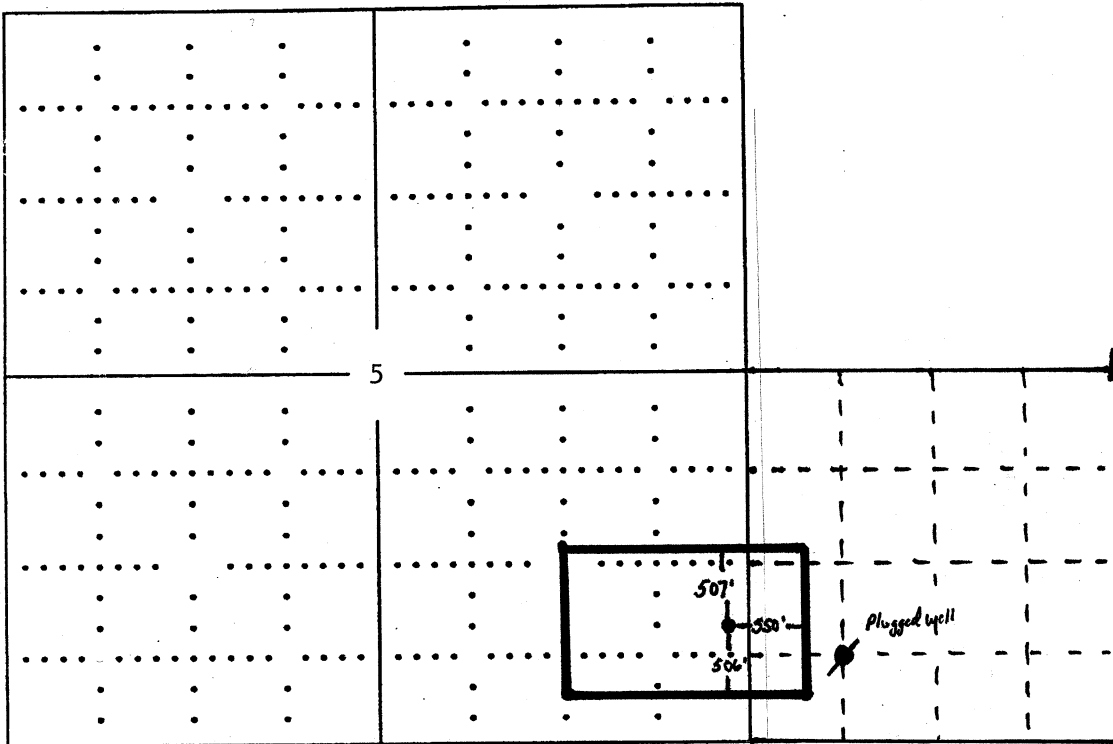

The undersigned hereby certifies as Vice President (title) for

John O. Farmer, Inc.

NE NE sec. 8 produce well plugged well NW NW sec. 9

(Co.), a duly authorized agent, that all information shown hereon is true and correct to the best of my knowledge and belief, that all acreage claimed attributable to the well named herein is held by production from that well.

Signature John O. Farmer, IV

Subscribed and sworn to before me on this 25th day of March, 2008

Trisha K. VonLintel

Notary Public
 Trisha K. VonLintel

My Commission expires 3/28/2011

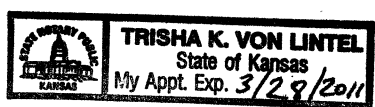

PLAT AND CERTIFICATION OF ACREAGE ATTRIBUTABLE TO A OIL WELL

Kansas Corporation Commission, Conservation Division
 Finney State Office Building, 130 South Market, Room 2078
 Wichita, Kansas 67202

API NUMBER 15- _____

LOCATION OF WELL: COUNTY Ness

OPERATOR John O. Farmer, Inc.

LEASE McJunkin Unit

840 feet from south / north line of section

WELL NUMBER 1

150 feet from east / west line of section

FIELD Schaben

SECTION 5 TWP 20 (S) RG 21 E/W

NUMBER OF ACRES ATTRIBUTABLE TO WELL _____

IS SECTION X REGULAR or _____ IRREGULAR

QTR/QTR/QTR OF ACREAGE _____

IF SECTION IS IRREGULAR, LOCATE WELL FROM
 NEAREST CORNER BOUNDARY. (check line below)

Section corner used: NE NW SE SW

(Show the location of the well and shade attributable acreage for prorated or spaced wells).
 (Show the footage to the nearest lease or unit boundary line; and show footage to the nearest
 common source supply well).

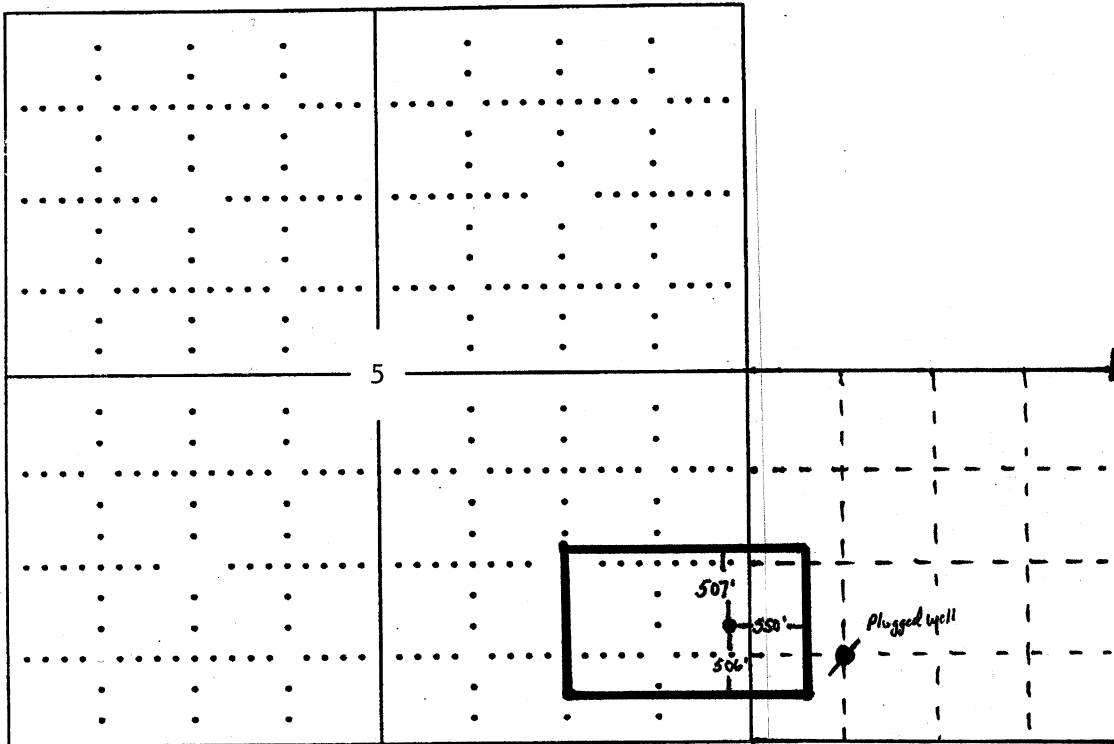

The undersigned hereby certifies as Vice President (title) for

John O. Farmer, Inc.

NE NE sec. 8 produce well plugged well NW NW sec. 9

(Co.), a duly authorized agent, that all information shown hereon is true and correct to the best of my knowledge and belief, that all acreage claimed attributable to the well named herein is held by production from that well.

Signature John O. Farmer, IV

Subscribed and sworn to before me on this 25th day of March, 2008

Trisha K. VonLintel

Notary Public
 Trisha K. VonLintel

My Commission expires 3/28/2011

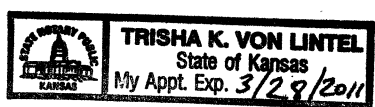

PLAT AND CERTIFICATION OF ACREAGE ATTRIBUTABLE TO A OIL WELL

Kansas Corporation Commission, Conservation Division
 Finney State Office Building, 130 South Market, Room 2078
 Wichita, Kansas 67202

API NUMBER 15- _____

LOCATION OF WELL: COUNTY Ness

OPERATOR John O. Farmer, Inc.

LEASE McJunkin Unit

840 feet from south / north line of section

WELL NUMBER 1

150 feet from east / west line of section

FIELD Schaben

SECTION 5 TWP 20 (S) RG 21 E/W

NUMBER OF ACRES ATTRIBUTABLE TO WELL _____

IS SECTION X REGULAR or _____ IRREGULAR

QTR/QTR/QTR OF ACREAGE _____

IF SECTION IS IRREGULAR, LOCATE WELL FROM
 NEAREST CORNER BOUNDARY. (check line below)

Section corner used: NE NW SE SW

(Show the location of the well and shade attributable acreage for prorated or spaced wells).
 (Show the footage to the nearest lease or unit boundary line; and show footage to the nearest
 common source supply well).

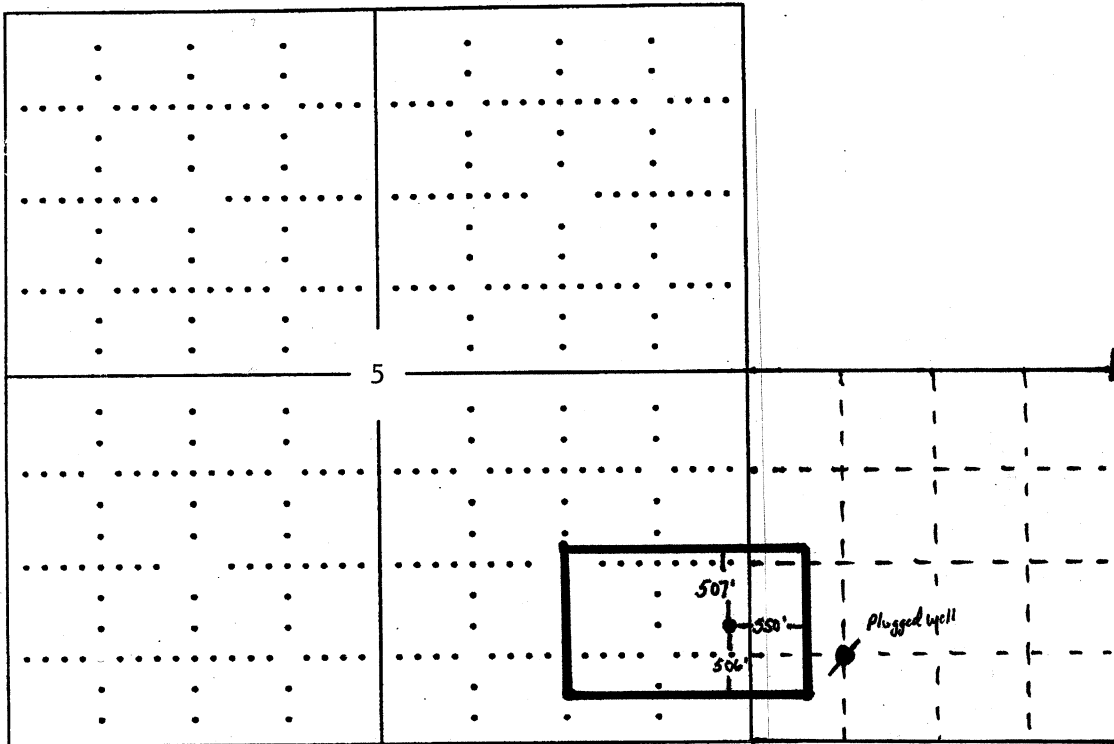

The undersigned hereby certifies as Vice President (title) for

John O. Farmer, Inc.

NE NE sec. 8 produce well plugged well NW NW sec. 9

(Co.), a duly authorized agent, that all information shown hereon is true and correct to the best of my knowledge and belief, that all acreage claimed attributable to the well named herein is held by production from that well.

Signature John O. Farmer, IV

Subscribed and sworn to before me on this 25th day of March, 2008

Trisha K. VonLintel

Notary Public
 Trisha K. VonLintel

My Commission expires 3/28/2011

