



KANSAS CORPORATION COMMISSION 1017900
OIL & GAS CONSERVATION DIVISION

Form must be Typed
Form must be Signed
All blanks must be Filled

For KCC Use:
Effective Date:
District #:
SGA? Yes No

NOTICE OF INTENT TO DRILL
Must be approved by KCC five (5) days prior to commencing well

Expected Spud Date: month day year

OPERATOR: License#
Name:
Address 1:
Address 2:
City: State: Zip: +
Contact Person:
Phone:

CONTRACTOR: License#
Name:

Well Drilled For: Well Class: Type Equipment:
Oil Enh Rec Infield Mud Rotary
Gas Storage Pool Ext. Air Rotary
Disposal Wildcat Cable
Seismic; # of Holes Other
Other:
If OWWO: old well information as follows:

Operator:
Well Name:
Original Completion Date: Original Total Depth:

Directional, Deviated or Horizontal wellbore? Yes No
If Yes, true vertical depth:
Bottom Hole Location:
KCC DKT #:

Spot Description:
Sec. Twp. S. R. E W
feet from N / S Line of Section
feet from E / W Line of Section

Is SECTION: Regular Irregular?
(Note: Locate well on the Section Plat on reverse side)

County:
Lease Name: Well #:

Field Name:
Is this a Prorated / Spaced Field? Yes No

Target Formation(s):
Nearest Lease or unit boundary line (in footage):

Ground Surface Elevation: feet MSL
Water well within one-quarter mile: Yes No

Public water supply well within one mile: Yes No
Depth to bottom of fresh water:

Depth to bottom of usable water:
Surface Pipe by Alternate: I II

Length of Surface Pipe Planned to be set:
Length of Conductor Pipe (if any):

Projected Total Depth:
Formation at Total Depth:

Water Source for Drilling Operations:
Well Farm Pond Other:

DWR Permit #:
(Note: Apply for Permit with DWR)

Will Cores be taken? Yes No
If Yes, proposed zone:

AFFIDAVIT

The undersigned hereby affirms that the drilling, completion and eventual plugging of this well will comply with K.S.A. 55 et. seq.

It is agreed that the following minimum requirements will be met:

- 1. Notify the appropriate district office prior to spudding of well;
2. A copy of the approved notice of intent to drill shall be posted on each drilling rig;
3. The minimum amount of surface pipe as specified below shall be set by circulating cement to the top; in all cases surface pipe shall be set through all unconsolidated materials plus a minimum of 20 feet into the underlying formation.
4. If the well is dry hole, an agreement between the operator and the district office on plug length and placement is necessary prior to plugging;
5. The appropriate district office will be notified before well is either plugged or production casing is cemented in;
6. If an ALTERNATE II COMPLETION, production pipe shall be cemented from below any usable water to surface within 120 DAYS of spud date. Or pursuant to Appendix "B" - Eastern Kansas surface casing order #133,891-C, which applies to the KCC District 3 area, alternate II cementing must be completed within 30 days of the spud date or the well shall be plugged. In all cases, NOTIFY district office prior to any cementing.

Submitted Electronically

For KCC Use ONLY
API # 15 -
Conductor pipe required feet
Minimum surface pipe required feet per ALT. I II
Approved by:
This authorization expires:
(This authorization void if drilling not started within 12 months of approval date.)
Spud date: Agent:

Remember to:

- File Drill Pit Application (form CDP-1) with Intent to Drill;
- File Completion Form ACO-1 within 120 days of spud date;
- File acreage attribution plat according to field proration orders;
- Notify appropriate district office 48 hours prior to workover or re-entry;
- Submit plugging report (CP-4) after plugging is completed (within 60 days);
- Obtain written approval before disposing or injecting salt water.
- If this permit has expired (See: authorized expiration date) please check the box below and return to the address below.

Well Not Drilled - Permit Expired Date:
Signature of Operator or Agent:



IN ALL CASES PLOT THE INTENDED WELL ON THE PLAT BELOW

Plat of acreage attributable to a well in a prorated or spaced field

If the intended well is in a prorated or spaced field, please fully complete this side of the form. If the intended well is in a prorated or spaced field complete the plat below showing that the well will be properly located in relationship to other wells producing from the common source of supply. Please show all the wells and within 1 mile of the boundaries of the proposed acreage attribution unit for gas wells and within 1/2 mile of the boundaries of the proposed acreage attribution unit for oil wells.

API No. 15 - _____
 Operator: _____
 Lease: _____
 Well Number: _____
 Field: _____

Number of Acres attributable to well: _____
 QTR/QTR/QTR/QTR of acreage: _____ - _____ - _____ - _____

Location of Well: County: _____
 _____ feet from N / S Line of Section
 _____ feet from E / W Line of Section
 Sec. _____ Twp. _____ S. R. _____ E W

Is Section: Regular or Irregular

If Section is Irregular, locate well from nearest corner boundary.

Section corner used: NE NW SE SW

PLAT

(Show location of the well and shade attributable acreage for prorated or spaced wells.)

(Show footage to the nearest lease or unit boundary line.)

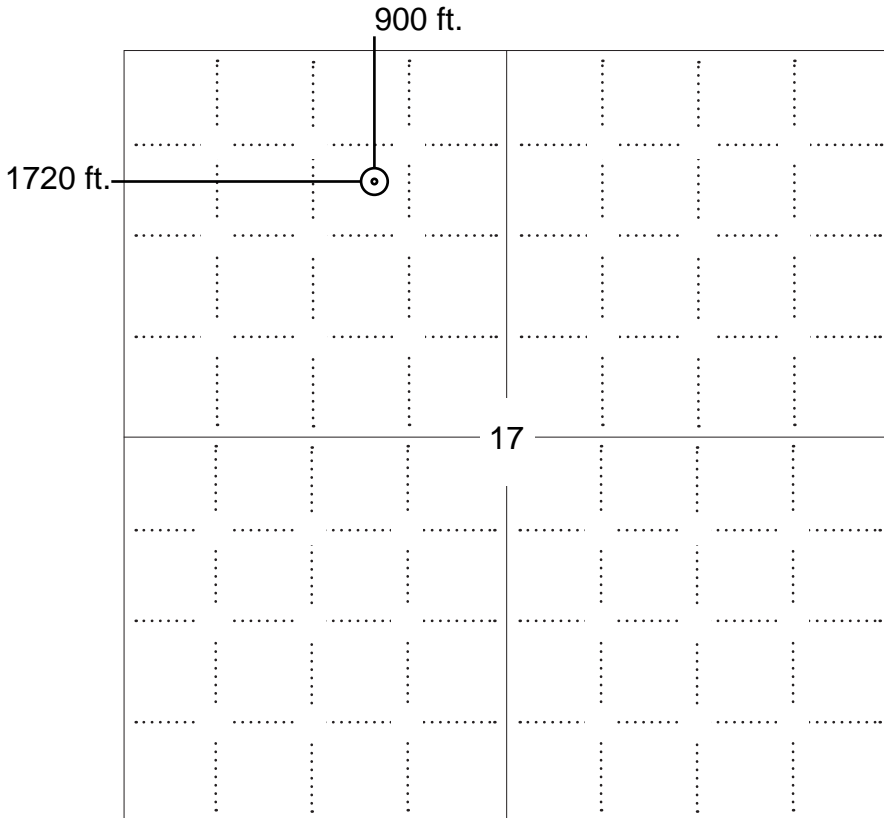

NOTE: In all cases locate the spot of the proposed drilling location.

In plotting the proposed location of the well, you must show:

1. The manner in which you are using the depicted plat by identifying section lines, i.e. 1 section, 1 section with 8 surrounding sections, 4 sections, etc.
2. The distance of the proposed drilling location from the south / north and east / west outside section lines.
3. The distance to the nearest lease or unit boundary line (in footage).
4. If proposed location is located within a prorated or spaced field a certificate of acreage attribution plat must be attached: (C0-7 for oil wells; CG-8 for gas wells).

**APPLICATION FOR SURFACE PIT***Submit in Duplicate*

Operator Name:		License Number:	
Operator Address:			
Contact Person:		Phone Number:	
Lease Name & Well No.:		Pit Location (QQQQ): ____ - ____ - ____ - ____	
Type of Pit: <input type="checkbox"/> Emergency Pit <input type="checkbox"/> Burn Pit <input type="checkbox"/> Settling Pit <input type="checkbox"/> Drilling Pit <input type="checkbox"/> Workover Pit <input type="checkbox"/> Haul-Off Pit <i>(If WP Supply API No. or Year Drilled)</i>		Pit is: <input type="checkbox"/> Proposed <input type="checkbox"/> Existing If Existing, date constructed: _____ Pit capacity: _____ (bbls)	
Is the pit located in a Sensitive Ground Water Area? <input type="checkbox"/> Yes <input type="checkbox"/> No		Chloride concentration: _____ mg/l <i>(For Emergency Pits and Settling Pits only)</i>	
Is the bottom below ground level? <input type="checkbox"/> Yes <input type="checkbox"/> No		Artificial Liner? <input type="checkbox"/> Yes <input type="checkbox"/> No	
How is the pit lined if a plastic liner is not used?			
Pit dimensions (all but working pits): _____ Length (feet) _____ Width (feet) _____ N/A: Steel Pits Depth from ground level to deepest point: _____ (feet) _____ No Pit			
If the pit is lined give a brief description of the liner material, thickness and installation procedure.		Describe procedures for periodic maintenance and determining liner integrity, including any special monitoring.	
Distance to nearest water well within one-mile of pit _____ feet Depth of water well _____ feet		Depth to shallowest fresh water _____ feet. Source of information: _____ measured _____ well owner _____ electric log _____ KDWR	
Emergency, Settling and Burn Pits ONLY: Producing Formation: _____ Number of producing wells on lease: _____ Barrels of fluid produced daily: _____ Does the slope from the tank battery allow all spilled fluids to flow into the pit? <input type="checkbox"/> Yes <input type="checkbox"/> No		Drilling, Workover and Haul-Off Pits ONLY: Type of material utilized in drilling/workover: _____ Number of working pits to be utilized: _____ Abandonment procedure: _____ _____ Drill pits must be closed within 365 days of spud date.	
Submitted Electronically			

KCC OFFICE USE ONLY

Steel Pit

RFAC

RFAS

Date Received: _____ Permit Number: _____ Permit Date: _____ Lease Inspection: Yes No

**KANSAS CORPORATION COMMISSION
OIL & GAS CONSERVATION DIVISION
APPLICATION FOR SURFACE PIT**

Form GDP-1
April 2004
Form must be Typed

Submit in Duplicate

Operator Name: Murfin Drilling Company, Inc.		License Number: 30606
Operator Address: 250 N. Water, Suite 300,		Wichita, KS 67202
Contact Person: Shauna Gunzelman		Phone Number: 316-267-3241
Lease Name & Well No.: Miller-McReynolds Unit #1-17		Pit Location (QQQQ): S/2 - S/2 - S/2 - SE Sec. <u>8</u> Twp. <u>20</u> R. <u>12</u> <input type="checkbox"/> East <input checked="" type="checkbox"/> West <u>900</u> Feet from <input checked="" type="checkbox"/> North / <input type="checkbox"/> South Line of Section <u>1,750</u> Feet from <input type="checkbox"/> East / <input checked="" type="checkbox"/> West Line of Section Barton County
Type of Pit: <input type="checkbox"/> Emergency Pit <input type="checkbox"/> Burn Pit <input type="checkbox"/> Settling Pit <input type="checkbox"/> Drilling Pit <input type="checkbox"/> Workover Pit <input checked="" type="checkbox"/> Haul-Off Pit <small>(If WP Supply API No. or Year Drilled)</small>	Pit is: <input checked="" type="checkbox"/> Proposed <input type="checkbox"/> Existing If Existing, date constructed: _____ Pit capacity: <u>600</u> (bbls)	
Is the pit located in a Sensitive Ground Water Area? <input checked="" type="checkbox"/> Yes <input type="checkbox"/> No		Chloride concentration: _____ mg/l <small>(For Emergency Pits and Settling Pits only)</small>
Is the bottom below ground level? <input checked="" type="checkbox"/> Yes <input type="checkbox"/> No	Artificial Liner? <input type="checkbox"/> Yes <input checked="" type="checkbox"/> No	How is the pit lined if a plastic liner is not used? Bentonite & solids from drilling operations self seal pits.
Pit dimensions (all but working pits): <u>100</u> Length (feet) <u>100</u> Width (feet) <input type="checkbox"/> N/A: Steel Pits Depth from ground level to deepest point: <u>4</u> (feet) <input type="checkbox"/> No Pit		
If the pit is lined give a brief description of the liner material, thickness and installation procedure.		Describe procedures for periodic maintenance and determining liner integrity, including any special monitoring.
Distance to nearest water well within one-mile of pit <u>1046</u> feet Depth of water well <u>108</u> feet		Depth to shallowest fresh water <u>35</u> feet. Source of information: <input type="checkbox"/> measured <input type="checkbox"/> well owner <input type="checkbox"/> electric log <input checked="" type="checkbox"/> KDWR
Emergency, Settling and Burn Pits ONLY: Producing Formation: _____ Number of producing wells on lease: _____ Barrels of fluid produced daily: _____ Does the slope from the tank battery allow all spilled fluids to flow into the pit? <input type="checkbox"/> Yes <input type="checkbox"/> No		Drilling, Workover and Haul-Off Pits ONLY: Type of material utilized in drilling/workover: <u>Bentonite</u> Number of working pits to be utilized: <u>1</u> Abandonment procedure: <u>Allow pit to evaporate until dry then backfill when conditions allow</u> Drill pits must be closed within 365 days of spud date.
I hereby certify that the above statements are true and correct to the best of my knowledge and belief.		
<u>4/3/08</u> Date	 Signature of Applicant or Agent	

KCC OFFICE USE ONLY		Steel Pit <input type="checkbox"/>	RFAC <input type="checkbox"/>	RFAS <input type="checkbox"/>
Date Received: _____	Permit Number: _____	Permit Date: _____	Lease Inspection: <input type="checkbox"/> Yes <input type="checkbox"/> No	

Mail to: KCC - Conservation Division, 130 S. Market - Room 2078, Wichita, Kansas 67202



*Kathleen Sebelius, Governor
Thomas E. Wright, Chairman
Michael C. Moffet, Commissioner
Joseph F. Harkins, Commissioner*

April 09, 2008

Shauna Gunzelman
Murfin Drilling Co., Inc.
250 N WATER STE 300
WICHITA, KS67202-1216

Re: Haul-Off Pit Application
Miller-McReynolds Unit Lease Well No. 1-17
SW/4 Sec.08-20S-12W
Barton County, Kansas

Dear Shauna Gunzelman:

District staff has inspected the above referenced location and has determined that the haul-off pit shall be constructed **without slots**, the bottom shall be flat and reasonably level and the free fluids must be removed. The fluids are to be removed from the haul-off pit as soon as the Hutchinson Salt section has been drilled through and displacement of the fluids into the haul-off pit has occurred. The fluids should be removed again as soon as practical after drilling operations have ceased.

If production casing is set all completion fluids shall be removed from the working pits daily. NO completion fluids or non-exempt wastes shall be placed in the haul-off pit.

The fluids should be taken to an authorized disposal well. Please call the District Office at (785) 625-0550 when the fluids have been removed. Please file form CDP-5 (August 2004), Exploration and Production Waste Transfer, within 30 days of fluid removal. Conservation division forms are available through our office and on the KCC web site:
kcc.ks.gov/conservation/forms/

A copy of this letter should be posted in the doghouse along with the approved Intent to Drill. If you have any questions or concerns please feel free to contact the District Office at (785) 625-0550.

Summary of Changes

Lease Name and Number: Miller-McReynolds Unit 1-17

API/Permit #: 15-009-25179-00-00

Doc ID: 1017900

Correction Number: 1

Approved By: Rick Hestermann 04/10/2008

Field Name	Previous Value	New Value
Abandonment Procedure	Allow pits to evaporate until dry then backfill when conditions allow	Clean out and backfill in a reasonable time frame
Artificial Liner?	No	Yes
Description of Pit Liner		20 mil liner
Expected Spud Date	3/24/2008	4/5/2008
Ground Surface Elevation	1858	1864
How Pit is Lined if Plastic Liner Not Used	Bentonite and solids from drilling operations self seal pits	
KCC Only - Approved By	Rick Hestermann 03/06/2008	Rick Hestermann 04/10/2008
KCC Only - Date Received	03/05/2008	04/03/2008
KCC Only - Permit Date	03/05/2008	04/10/2008
Liner Maintenance Procedures		pump fluid to remote reserve pit clean out and backfill when

Summary of changes for correction 1 continued

Field Name	Previous Value	New Value
LocationInfoLink	https://solar.kgs.ku.edu/kcc/detail/locationInformation.cfm?section=17&t	https://solar.kgs.ku.edu/kcc/detail/locationInformation.cfm?section=17&t
Number of Feet East or West From Section Line	1750	1720
Number of Feet East or West From Section Line	1750	1720
Number of Working Pits to be Used	4	1
Pit Capacity BBLs	600	200
Pit Deepest Depth	4	5
Pit Length	100	10
Pit Width	100	70
SaveLink	.../kcc/detail/operatorEditDetail.cfm?docID=1017045	.../kcc/detail/operatorEditDetail.cfm?docID=1017900&rand=nSIZppsw

DynamicPDF