



1024202

IN ALL CASES PLOT THE INTENDED WELL ON THE PLAT BELOW

Plat of acreage attributable to a well in a prorated or spaced field

If the intended well is in a prorated or spaced field, please fully complete this side of the form. If the intended well is in a prorated or spaced field complete the plat below showing that the well will be properly located in relationship to other wells producing from the common source of supply. Please show all the wells and within 1 mile of the boundaries of the proposed acreage attribution unit for gas wells and within 1/2 mile of the boundaries of the proposed acreage attribution unit for oil wells.

API No. 15 - _____

Operator: _____

Lease: _____

Well Number: _____

Field: _____

Number of Acres attributable to well: _____

QTR/QTR/QTR/QTR of acreage: _____ - _____ - _____ - _____

Location of Well: County: _____

_____ feet from N / S Line of Section

_____ feet from E / W Line of Section

Sec. _____ Twp. _____ S. R. _____ E W

Is Section: Regular or Irregular

If Section is Irregular, locate well from nearest corner boundary.

Section corner used: NE NW SE SW

PLAT

(Show location of the well and shade attributable acreage for prorated or spaced wells.)

(Show footage to the nearest lease or unit boundary line.)

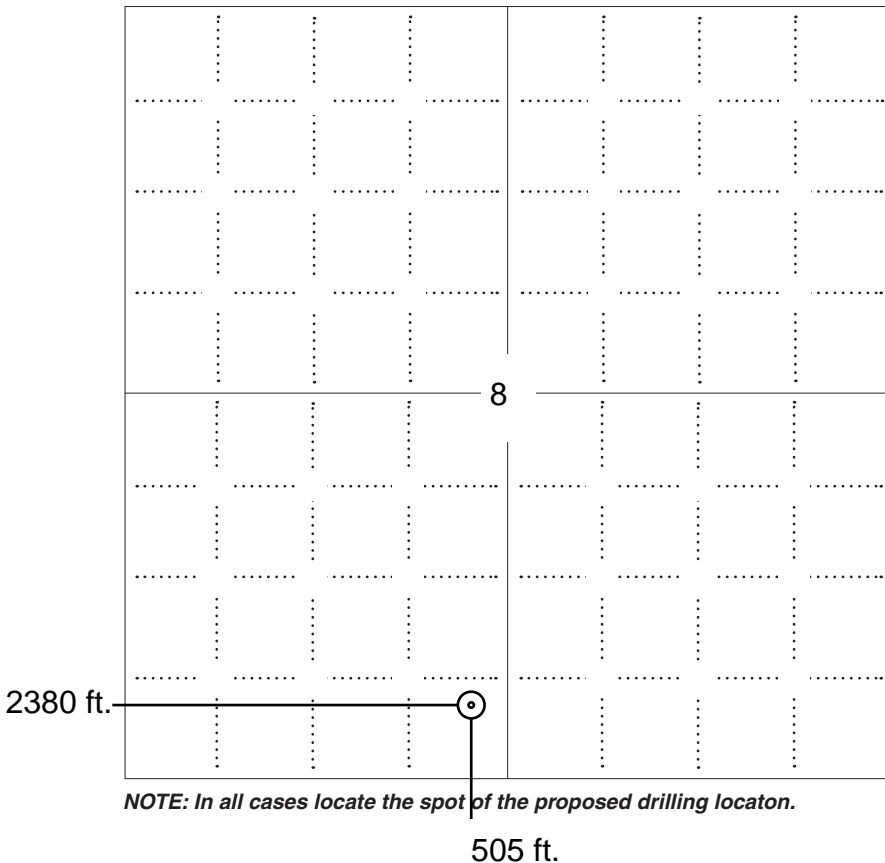

NOTE: In all cases locate the spot of the proposed drilling location.



In plotting the proposed location of the well, you must show:

1. The manner in which you are using the depicted plat by identifying section lines, i.e. 1 section, 1 section with 8 surrounding sections, 4 sections, etc.
2. The distance of the proposed drilling location from the south / north and east / west outside section lines.
3. The distance to the nearest lease or unit boundary line (in footage).
4. If proposed location is located within a prorated or spaced field a certificate of acreage attribution plat must be attached: (C0-7 for oil wells; CG-8 for gas wells).



KANSAS CORPORATION COMMISSION 1024202
OIL & GAS CONSERVATION DIVISION

Form CDP-1
April 2004
Form must be Typed

APPLICATION FOR SURFACE PIT

Submit in Duplicate

Operator Name: _____		License Number: _____	
Operator Address: _____			
Contact Person: _____		Phone Number: _____	
Lease Name & Well No.: _____		Pit Location (QQQQ): _____ - _____ - _____ - _____	
Type of Pit: <input type="checkbox"/> Emergency Pit <input type="checkbox"/> Burn Pit <input type="checkbox"/> Settling Pit <input type="checkbox"/> Drilling Pit <input type="checkbox"/> Workover Pit <input type="checkbox"/> Haul-Off Pit <i>(If WP Supply API No. or Year Drilled)</i>		Pit is: <input type="checkbox"/> Proposed <input type="checkbox"/> Existing If Existing, date constructed: _____ Pit capacity: _____ (bbls)	
Is the pit located in a Sensitive Ground Water Area? <input type="checkbox"/> Yes <input type="checkbox"/> No		Chloride concentration: _____ mg/l <i>(For Emergency Pits and Settling Pits only)</i>	
Is the bottom below ground level? <input type="checkbox"/> Yes <input type="checkbox"/> No		Artificial Liner? <input type="checkbox"/> Yes <input type="checkbox"/> No	
How is the pit lined if a plastic liner is not used?		_____	
Pit dimensions (all but working pits): _____ Length (feet) _____ Width (feet) _____ N/A: Steel Pits Depth from ground level to deepest point: _____ (feet) _____ No Pit			
If the pit is lined give a brief description of the liner material, thickness and installation procedure.		Describe procedures for periodic maintenance and determining liner integrity, including any special monitoring.	
Distance to nearest water well within one-mile of pit _____ feet Depth of water well _____ feet		Depth to shallowest fresh water _____ feet. Source of information: _____ measured _____ well owner _____ electric log _____ KDWR	
Emergency, Settling and Burn Pits ONLY: Producing Formation: _____ Number of producing wells on lease: _____ Barrels of fluid produced daily: _____ Does the slope from the tank battery allow all spilled fluids to flow into the pit? <input type="checkbox"/> Yes <input type="checkbox"/> No		Drilling, Workover and Haul-Off Pits ONLY: Type of material utilized in drilling/workover: _____ Number of working pits to be utilized: _____ Abandonment procedure: _____ _____ Drill pits must be closed within 365 days of spud date.	
Submitted Electronically			

KCC OFFICE USE ONLY		Steel Pit	RFAC	RFAS
Date Received: _____	Permit Number: _____	Permit Date: _____	Lease Inspection: <input type="checkbox"/> Yes <input type="checkbox"/> No	

CORRECTION DECLARATION OF UNITIZATION

12 STATE OF KANSAS)
) §
COUNTY OF MEADE)

KNOW ALL MEN BY THESE PRESENTS:

WHEREAS, KEITH F. WALKER OIL & GAS CO., L.L.C. is the owner of record of the oil and gas leases described in Exhibit "A" attached hereto and made a part hereof; and

WHEREAS, the described leases grant to the Lessee, its heirs, administrators, trustees and assigns, the right and privilege to consolidate said gas leasehold with any other adjacent or contiguous gas leasehold estates to form a consolidated gas leasehold estate and the Lessor's gas royalty estate created by the leases so as to create by combination of one or more consolidated gas leasehold estates of Three Hundred and Twenty (320) acres each; and

WHEREAS, a Declaration of Unitization executed October 20, 2008 was recorded October 23, 2008 in Book 48 at Pages 399-400 of the Records of Meade County, Kansas creating the following unit, to-wit:

Township 31 South, Range 30 West, 6th P.M.:
Section 8: S/2
Meade County, Kansas, and

WHEREAS, the undersigned desires to correct the aforementioned Declaration of Unitization by amending the leases unitized thereby, and by defining an Effective Date for such unit; and

NOW, THEREFORE, the undersigned, present owner of all of the right, title and interest of the original Lessee in, to and under the leases described in Exhibit A, pursuant to consolidation and unitization provisions of said oil and gas leases, does hereby designate and describe the following lands as a consolidated gas leasehold estate for the purpose of exploration, development and production of gas:

Township 31 South, Range 30 West, 6th P.M.:
Section 8: S/2
Meade County, Kansas,

Executed the 2nd day of December, 2008, but EFFECTIVE as of October 12, 2008.

KEITH F. WALKER OIL & GAS COMPANY, L.L.C.

John P. Gilbert, Vice-President of Land and Marketing

STATE OF OKLAHOMA)
) §
COUNTY OF CLEVELAND)

BEFORE ME, the undersigned authority, on this day personally appeared John P. Gilbert, known to me to be the person whose name is subscribed to the foregoing instrument, and known to me to be the Vice-President of Land and Marketing of **Keith F. Walker Oil & Gas Company, L.L.C.** and acknowledged to me that he executed said instrument for the purposes and consideration therein expressed.

GIVEN UNDER my hand and seal of office this 2nd day of December, 2008.

My Commission Expires: 11/10/09

Notary Public: Rebecca A. Casey



STATE OF KANSAS, Meade County
This instrument was filed for record on the 5 day of Dec., A.D. 2008
at 9:40 A M. and duly recorded
in Book 48 on Page(s) 561-562
Melita Davis
Register of Deeds \$1200
Xael



Photocopied

EXHIBIT "A"
 Attached to and Made a Part of That Certain
Correction Declaration of Unitization
 Executed December 2nd, 2008, but Effective as of October 12, 2008

STATE OF Kansas
 COUNTY OF Meade

Lease No.	Lease Name	Lessee	Lease Date	Recorded Bk / Pg	Legal Description
P0027108A	Estate of Ralph Joseph Kisner Decd by Co-Executors	Keith F Walker Oil & Gas Company LLC	31-Jul-08	115 / 286	Sec 8, T31S-R30W 6P Tr:3 S/2 SW/4 (80 gr ac) Tr:4 N/2 SW/4 (80 gr ac)
P0027108B	Kerry Knott and Lynne Knott his wife	J Fred Hambright Inc	06-Sep-08	115 / 663	Sec 8, T31S-R30W 6P Tr:4 N/2 SW/4 (80 gr ac)
P0027109	Estate of Ralph Joseph Kisner Decd by Co-Executors	Keith F Walker Oil & Gas Company LLC	31-Jul-08	115 / 279	Sec 8, T31S-R30W 6P Tr:5 SE/4 (160 gr ac)