





1027203

**IN ALL CASES PLOT THE INTENDED WELL ON THE PLAT BELOW**

*Plat of acreage attributable to a well in a prorated or spaced field*

**If the intended well is in a prorated or spaced field, please fully complete this side of the form.** If the intended well is in a prorated or spaced field complete the plat below showing that the well will be properly located in relationship to other wells producing from the common source of supply. Please show all the wells and within 1 mile of the boundaries of the proposed acreage attribution unit for gas wells and within 1/2 mile of the boundaries of the proposed acreage attribution unit for oil wells.

API No. 15 - \_\_\_\_\_  
Operator: \_\_\_\_\_  
Lease: \_\_\_\_\_  
Well Number: \_\_\_\_\_  
Field: \_\_\_\_\_

Location of Well: County: \_\_\_\_\_  
\_\_\_\_\_ feet from  N /  S Line of Section  
\_\_\_\_\_ feet from  E /  W Line of Section  
Sec. \_\_\_\_\_ Twp. \_\_\_\_\_ S. R. \_\_\_\_\_  E  W

Number of Acres attributable to well: \_\_\_\_\_  
QTR/QTR/QTR/QTR of acreage: \_\_\_\_\_ - \_\_\_\_\_ - \_\_\_\_\_ - \_\_\_\_\_

Is Section:  Regular or  Irregular

**If Section is Irregular, locate well from nearest corner boundary.**

Section corner used:  NE  NW  SE  SW

**PLAT**

*(Show location of the well and shade attributable acreage for prorated or spaced wells.)*

*(Show footage to the nearest lease or unit boundary line.)*

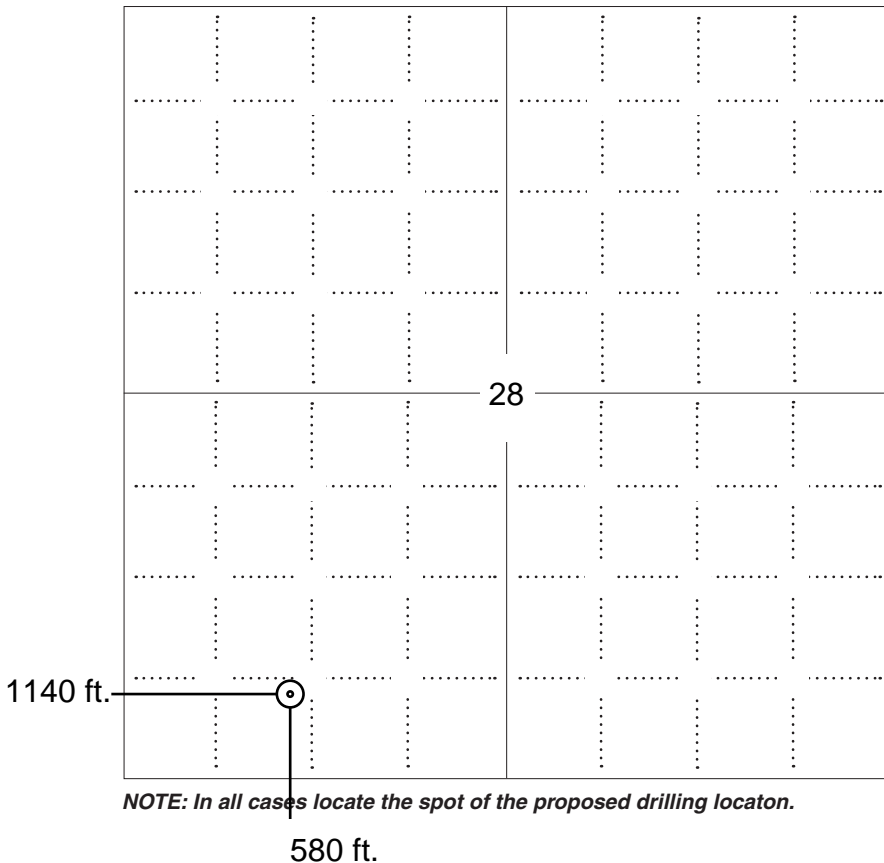

**NOTE: In all cases locate the spot of the proposed drilling locaton.**

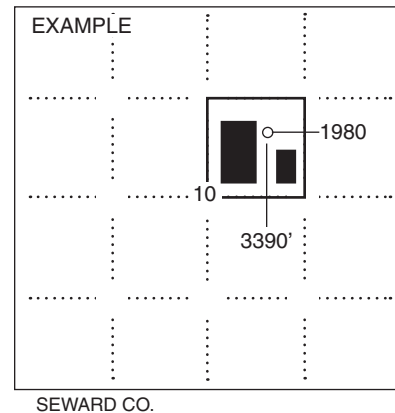

**In plotting the proposed location of the well, you must show:**

1. The manner in which you are using the depicted plat by identifying section lines, i.e. 1 section, 1 section with 8 surrounding sections, 4 sections, etc.
2. The distance of the proposed drilling location from the south / north and east / west outside section lines.
3. The distance to the nearest lease or unit boundary line (in footage).
4. If proposed location is located within a prorated or spaced field a certificate of acreage attribution plat must be attached: (C0-7 for oil wells; CG-8 for gas wells).



KANSAS CORPORATION COMMISSION 1027203  
OIL & GAS CONSERVATION DIVISION

Form CDP-1  
April 2004  
Form must be Typed

**APPLICATION FOR SURFACE PIT**

*Submit in Duplicate*

Operator Name: _____		License Number: _____	
Operator Address: _____			
Contact Person: _____		Phone Number: _____	
Lease Name & Well No.: _____		Pit Location (QQQQ): _____ - _____ - _____ - _____	
Type of Pit: <input type="checkbox"/> Emergency Pit <input type="checkbox"/> Burn Pit <input type="checkbox"/> Settling Pit <input type="checkbox"/> Drilling Pit <input type="checkbox"/> Workover Pit <input type="checkbox"/> Haul-Off Pit <i>(If WP Supply API No. or Year Drilled)</i>		Pit is: <input type="checkbox"/> Proposed <input type="checkbox"/> Existing If Existing, date constructed: _____ Pit capacity: _____ (bbls)	
Is the pit located in a Sensitive Ground Water Area? <input type="checkbox"/> Yes <input type="checkbox"/> No		Chloride concentration: _____ mg/l <i>(For Emergency Pits and Settling Pits only)</i>	
Is the bottom below ground level? <input type="checkbox"/> Yes <input type="checkbox"/> No		Artificial Liner? <input type="checkbox"/> Yes <input type="checkbox"/> No	
How is the pit lined if a plastic liner is not used?		_____	
Pit dimensions (all but working pits): _____ Length (feet)    _____ Width (feet)    _____ N/A: Steel Pits Depth from ground level to deepest point: _____ (feet)    _____ No Pit			
If the pit is lined give a brief description of the liner material, thickness and installation procedure.		Describe procedures for periodic maintenance and determining liner integrity, including any special monitoring.	
Distance to nearest water well within one-mile of pit _____ feet    Depth of water well _____ feet		Depth to shallowest fresh water _____ feet. Source of information: _____ measured    _____ well owner    _____ electric log    _____ KDWR	
<b>Emergency, Settling and Burn Pits ONLY:</b> Producing Formation: _____ Number of producing wells on lease: _____ Barrels of fluid produced daily: _____ Does the slope from the tank battery allow all spilled fluids to flow into the pit? <input type="checkbox"/> Yes <input type="checkbox"/> No		<b>Drilling, Workover and Haul-Off Pits ONLY:</b> Type of material utilized in drilling/workover: _____ Number of working pits to be utilized: _____ Abandonment procedure: _____ _____ Drill pits must be closed within 365 days of spud date.	
Submitted Electronically			

<b>KCC OFFICE USE ONLY</b>		Steel Pit	RFAC	RFAS
Date Received: _____	Permit Number: _____	Permit Date: _____	Lease Inspection: <input type="checkbox"/> Yes <input type="checkbox"/> No	

KANSAS  
CORPORATION COMMISSION  
Market, Room 2078  
Tulsa, KS 67202

WELL PLUGGING RECORD  
K.A.R.-82-3-117

API NUMBER 15-015-23437-0000

LEASE NAME Burlingame Stokes A

WELL NUMBER 78

TYPE OR PRINT  
NOTICE: Fill out completely  
and return to  
Cons. Div. Office within  
30 days.

580 Ft. from S Section Line

4140 Ft. from E Section Line

LEASE OPERATOR OXY USA Inc.

SEC. 28 TWP. 25S RGE. 5 (E) or (X)

ADDRESS P. O. Box 26100

COUNTY Butler

PHONE# (405) 749-2309 Operators License #5447

Date Well Completed 4/3/95

Character of Well D & A

Plugging Commenced 4/4/95

(Oil, Gas, D&A, SWD, Input, Water Supply Well)

Plugging Completed 4/4/95

The plugging proposal was approved on 4/4/95 (date)

by Jerry Clark (KCC District Agent's name).

Is ACO-1 filed? Yes If not, is well log attached? yes

Producing Formation Dry Depth to Top \_\_\_\_\_ Bottom \_\_\_\_\_ T.D. 2505

Show depth and thickness of all water, oil and gas formations.

OIL, GAS OR WATER RECORDS		CASING RECORD				
Formation	Content	From	To	Size	Put in	Pulled Out
Arbuckle	Dry			8 5/8"	260	

Describe in detail the manner in which the well was plugged, indicating where the mud fluid was placed and the methods used in introducing it into the hole. If cement or other plug were used, state the character of same and depth placed, from \_\_\_\_\_ feet to \_\_\_\_\_ feet each set.

Drill string @ 2465'. Spotted 35sks @ 2465'. Drill string @300' Spotted 35sks @300'. Drill string @60' & circ 25sks to surface. Plugged rathole w/10sks.

(If additional description is necessary, use BACK of this form.)

Name of Plugging Contractor Allen Drilling Co License No. 5418

Address \_\_\_\_\_

NAME OF PARTY RESPONSIBLE FOR PLUGGING FEES: OXY USA Inc.

STATE OF OKLAHOMA COUNTY OF OKLAHOMA, ss.

Jerry Ledlow (Employee of Operator) or (Operator) of above-described well, being first duly sworn on oath, says: That I have knowledge of the facts, statements, and matters herein contained and the log of the above-described well as filed that the same are true and correct, so help me God.

(Signature) [Signature]  
(Address) P. O. Box 26100, OKC, OK 73126-0100

SUBSCRIBED AND SWORN TO before me this 8<sup>th</sup> day of MAY, 19 95

Quetta J. Schwadlerak  
Notary Public

My Commission Expires: 7-23-98