





1028576

**IN ALL CASES PLOT THE INTENDED WELL ON THE PLAT BELOW**

*Plat of acreage attributable to a well in a prorated or spaced field*

**If the intended well is in a prorated or spaced field, please fully complete this side of the form.** If the intended well is in a prorated or spaced field complete the plat below showing that the well will be properly located in relationship to other wells producing from the common source of supply. Please show all the wells and within 1 mile of the boundaries of the proposed acreage attribution unit for gas wells and within 1/2 mile of the boundaries of the proposed acreage attribution unit for oil wells.

API No. 15 - \_\_\_\_\_

Operator: \_\_\_\_\_

Lease: \_\_\_\_\_

Well Number: \_\_\_\_\_

Field: \_\_\_\_\_

Number of Acres attributable to well: \_\_\_\_\_

QTR/QTR/QTR/QTR of acreage: \_\_\_\_\_ - \_\_\_\_\_ - \_\_\_\_\_ - \_\_\_\_\_

Location of Well: County: \_\_\_\_\_

\_\_\_\_\_ feet from  N /  S Line of Section

\_\_\_\_\_ feet from  E /  W Line of Section

Sec. \_\_\_\_\_ Twp. \_\_\_\_\_ S. R. \_\_\_\_\_  E  W

Is Section:  Regular or  Irregular

**If Section is Irregular, locate well from nearest corner boundary.**

Section corner used:  NE  NW  SE  SW

**PLAT**

*(Show location of the well and shade attributable acreage for prorated or spaced wells.)*

*(Show footage to the nearest lease or unit boundary line.)*

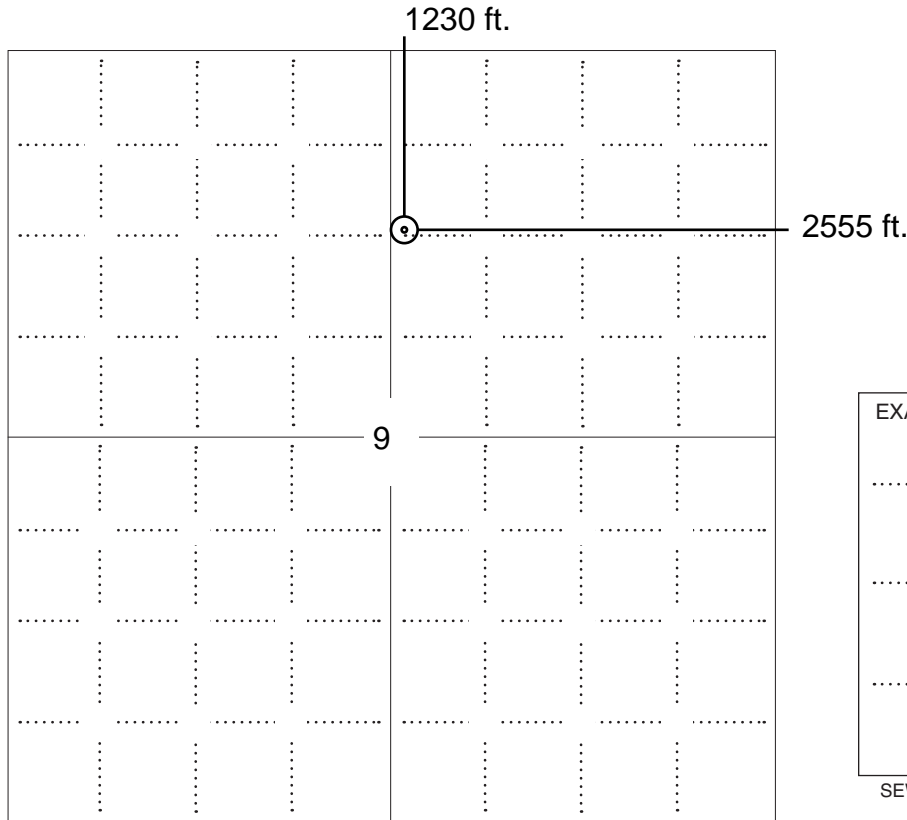

**NOTE: In all cases locate the spot of the proposed drilling locaton.**

**In plotting the proposed location of the well, you must show:**

1. The manner in which you are using the depicted plat by identifying section lines, i.e. 1 section, 1 section with 8 surrounding sections, 4 sections, etc.
2. The distance of the proposed drilling location from the south / north and east / west outside section lines.
3. The distance to the nearest lease or unit boundary line (in footage).
4. If proposed location is located within a prorated or spaced field a certificate of acreage attribution plat must be attached: (C0-7 for oil wells; CG-8 for gas wells).



KANSAS CORPORATION COMMISSION 1028576  
OIL & GAS CONSERVATION DIVISION

Form CDP-1  
April 2004  
Form must be Typed

**APPLICATION FOR SURFACE PIT**

*Submit in Duplicate*

Operator Name: _____		License Number: _____	
Operator Address: _____			
Contact Person: _____		Phone Number: _____	
Lease Name & Well No.: _____		Pit Location (QQQQ): _____ - _____ - _____ - _____	
Type of Pit: <input type="checkbox"/> Emergency Pit <input type="checkbox"/> Burn Pit <input type="checkbox"/> Settling Pit <input type="checkbox"/> Drilling Pit <input type="checkbox"/> Workover Pit <input type="checkbox"/> Haul-Off Pit <i>(If WP Supply API No. or Year Drilled)</i>		Pit is: <input type="checkbox"/> Proposed <input type="checkbox"/> Existing If Existing, date constructed: _____ Pit capacity: _____ (bbls)	
Is the pit located in a Sensitive Ground Water Area? <input type="checkbox"/> Yes <input type="checkbox"/> No		Chloride concentration: _____ mg/l <i>(For Emergency Pits and Settling Pits only)</i>	
Is the bottom below ground level? <input type="checkbox"/> Yes <input type="checkbox"/> No		Artificial Liner? <input type="checkbox"/> Yes <input type="checkbox"/> No	
How is the pit lined if a plastic liner is not used?		_____	
Pit dimensions (all but working pits): _____ Length (feet)    _____ Width (feet)    _____ N/A: Steel Pits Depth from ground level to deepest point: _____ (feet)    _____ No Pit			
If the pit is lined give a brief description of the liner material, thickness and installation procedure.		Describe procedures for periodic maintenance and determining liner integrity, including any special monitoring.	
Distance to nearest water well within one-mile of pit _____ feet    Depth of water well _____ feet		Depth to shallowest fresh water _____ feet. Source of information: _____ measured    _____ well owner    _____ electric log    _____ KDWR	
<b>Emergency, Settling and Burn Pits ONLY:</b> Producing Formation: _____ Number of producing wells on lease: _____ Barrels of fluid produced daily: _____ Does the slope from the tank battery allow all spilled fluids to flow into the pit? <input type="checkbox"/> Yes <input type="checkbox"/> No		<b>Drilling, Workover and Haul-Off Pits ONLY:</b> Type of material utilized in drilling/workover: _____ Number of working pits to be utilized: _____ Abandonment procedure: _____ _____ Drill pits must be closed within 365 days of spud date.	
Submitted Electronically			

<b>KCC OFFICE USE ONLY</b>		Steel Pit	RFAC	RFAS
Date Received: _____	Permit Number: _____	Permit Date: _____	Lease Inspection: <input type="checkbox"/> Yes <input type="checkbox"/> No	

# PLAT AND CERTIFICATION OF ACREAGE ATTRIBUTABLE TO A OIL WELL

Kansas Corporation Commission, Conservation Division  
 Finney State Office Building, 130 South Market, Room 2078  
 Wichita, Kansas 67202

API NUMBER 15- (NOT YET ASSIGNED)

LOCATION OF WELL: COUNTY BARTON

OPERATOR CREDO PETROLEUM CORPORATION

LEASE KLEPPER CPC

WELL NUMBER 1-9

FIELD ARRANS NORTH

1230 feet from south/north line of section

2555 feet from east/west line of section

SECTION 9 TWP 19 (S) RG 11 E (W)

IS SECTION X REGULAR or IRREGULAR

IF SECTION IS IRREGULAR, LOCATE WELL FROM  
 NEAREST CORNER BOUNDARY. (check line below)

Section corner used: NE NW SE SW

NUMBER OF ACRES ATTRIBUTABLE TO WELL 10  
 QTR/QTR/QTR OF ACREAGE SW - NW - NE

(Show the location of the well and shade attributable acreage for prorated or spaced wells).  
 (Show the footage to the nearest lease or unit boundary line; and show footage to the nearest  
 common source supply well).

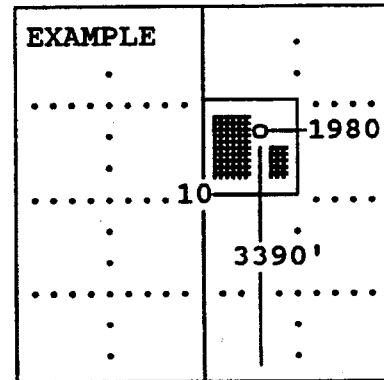
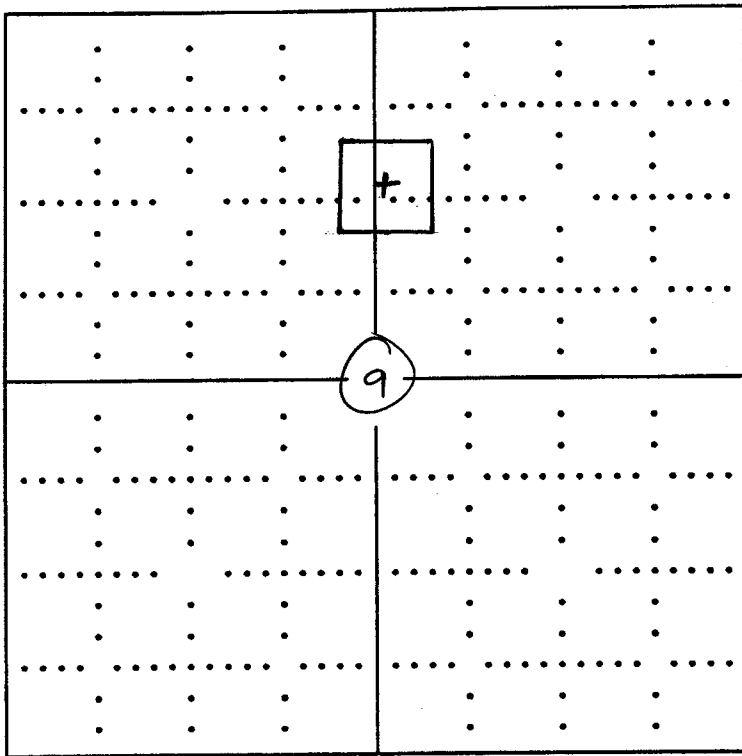

SEWARD CO.

The undersigned hereby certifies as Operations Manager (title) for

Credo Petroleum Corporation (Co.), a duly authorized agent, that all  
 information shown hereon is true and correct to the best of my knowledge and belief, that all  
 acreage claimed attributable to the well named herein is held by production from that well.

Signature [Handwritten Signature]

Subscribed and sworn to before me on 24 day of May, 19 2009

[Handwritten Signature]  
 Notary Public

My Commission expires \_\_\_\_\_

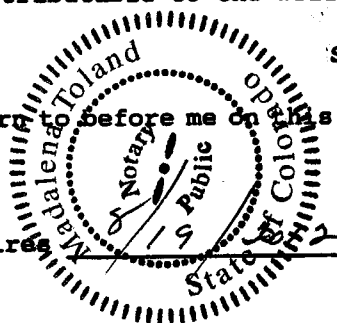

Attachment  
 To Application for Permit to Drill  
 Klepper CPC #1-9 Well  
 CREDO Petroleum Corporation, Operator  
 Summary of Leases to be Pooled

LESSOR	LESSEE	DATE			DESCRIPTION	BOOK	PAGE
Janet A & John Peters	Credo Petroleum Corp.	02/17/07	9	19S	11W NW/4	614	1803
Donald H & Jeanne R Schlochtermeyer	Credo Petroleum Corp.	02/17/07	9	19S	11W N/2NW/4	614	1802
Janice M & Darly E Klepper	Credo Petroleum Corp.	02/10/07	9	19S	11W N/2NW/4	614	1801
Kathleen A & Jay D Mai	Credo Petroleum Corp.	02/10/07	9	19S	11W N/2NW/4	614	1798
Rose M. Meyers	Credo Petroleum Corp.	02/10/07	9	19S	11W N/2NW/4	614	1800
Rita M & Michael R Goscha	Credo Petroleum Corp.	02/10/07	9	19S	11W N/2NW/4	614	1799
Roy J. & Elaine E. Schlochtermeyer	Credo Petroleum Corp.	02/17/07	9	19S	11W N/2NW/4	614	1788
Janice M & Daryl E Klepper	Credo Petroleum Corp.	01/09/09	9	19S	11W S/2NW/4	615	1006
Kathleen A & Jay D Mai	Credo Petroleum Corp.	01/09/09	9	19S	11W S/2NW/4	615	1007
Rose M. Meyers	Credo Petroleum Corp.	01/09/09	9	19S	11W S/2NW/4	615	1005
Rita M & Michael R Goscha	Credo Petroleum Corp.	01/09/09	9	19S	11W S/2NW/4	615	1008
Lawrence A. & Eunice J. Klepper	Credo Petroleum Corp.	02/15/07	9	19S	11W NE/4,N/2N/2SE/4	614	1780
Joyce M. & Gerald M. Ware	Credo Petroleum Corp.	02/15/07	9	19S	11W NE/4,N/2N/2SE/4	614	2453
Richard E. Klepper	Credo Petroleum Corp.	02/15/07	9	19S	11W NE/4,N/2N/2SE/4	614	1783
Diane & Edward S. Nemnich	Credo Petroleum Corp.	02/15/07	9	19S	11W NE/4,N/2N/2SE/4	614	1791
Vernon A. & Brenda S. Schaffer	Credo Petroleum Corp.	02/15/07	9	19S	11W NE/4,N/2N/2SE/4	614	1792

Attachment  
To Application for Permit to Drill  
Klepper CPC #1-9 Well  
CREDO Petroleum Corporation, Operator  
Summary of Leases to be Pooled

LESSOR	LESSEE	DATE	DESCRIPTION				BOOK	PAGE
Janet E. & Don L. Offutt	Credo Petroleum Corp.	02/15/07	9	19S	11W	NE/4,N/2N/2SE/4	614	1793
Roger D. & Cathy A. Blasi	Credo Petroleum Corp.	02/15/07	9	19S	11W	NE/4,N/2N/2SE/4	614	1794
David A. & Paula J. Blasi	Credo Petroleum Corp.	02/15/07	9	19S	11W	NE/4,N/2N/2SE/4	614	1795
Marlene A. & David D. Panning	Credo Petroleum Corp.	02/15/07	9	19S	11W	NE/4,N/2N/2SE/4	614	1796
Marcella Blasi	Credo Petroleum Corp.	02/15/07	9	19S	11W	NE/4,N/2N/2SE/4	614	1797