





1028593

**IN ALL CASES PLOT THE INTENDED WELL ON THE PLAT BELOW**

*Plat of acreage attributable to a well in a prorated or spaced field*

**If the intended well is in a prorated or spaced field, please fully complete this side of the form.** If the intended well is in a prorated or spaced field complete the plat below showing that the well will be properly located in relationship to other wells producing from the common source of supply. Please show all the wells and within 1 mile of the boundaries of the proposed acreage attribution unit for gas wells and within 1/2 mile of the boundaries of the proposed acreage attribution unit for oil wells.

API No. 15 - \_\_\_\_\_

Operator: \_\_\_\_\_

Lease: \_\_\_\_\_

Well Number: \_\_\_\_\_

Field: \_\_\_\_\_

Number of Acres attributable to well: \_\_\_\_\_

QTR/QTR/QTR/QTR of acreage: \_\_\_\_\_ - \_\_\_\_\_ - \_\_\_\_\_ - \_\_\_\_\_

Location of Well: County: \_\_\_\_\_

\_\_\_\_\_ feet from  N /  S Line of Section

\_\_\_\_\_ feet from  E /  W Line of Section

Sec. \_\_\_\_\_ Twp. \_\_\_\_\_ S. R. \_\_\_\_\_  E  W

Is Section:  Regular or  Irregular

**If Section is Irregular, locate well from nearest corner boundary.**

Section corner used:  NE  NW  SE  SW

**PLAT**

*(Show location of the well and shade attributable acreage for prorated or spaced wells.)*

*(Show footage to the nearest lease or unit boundary line.)*

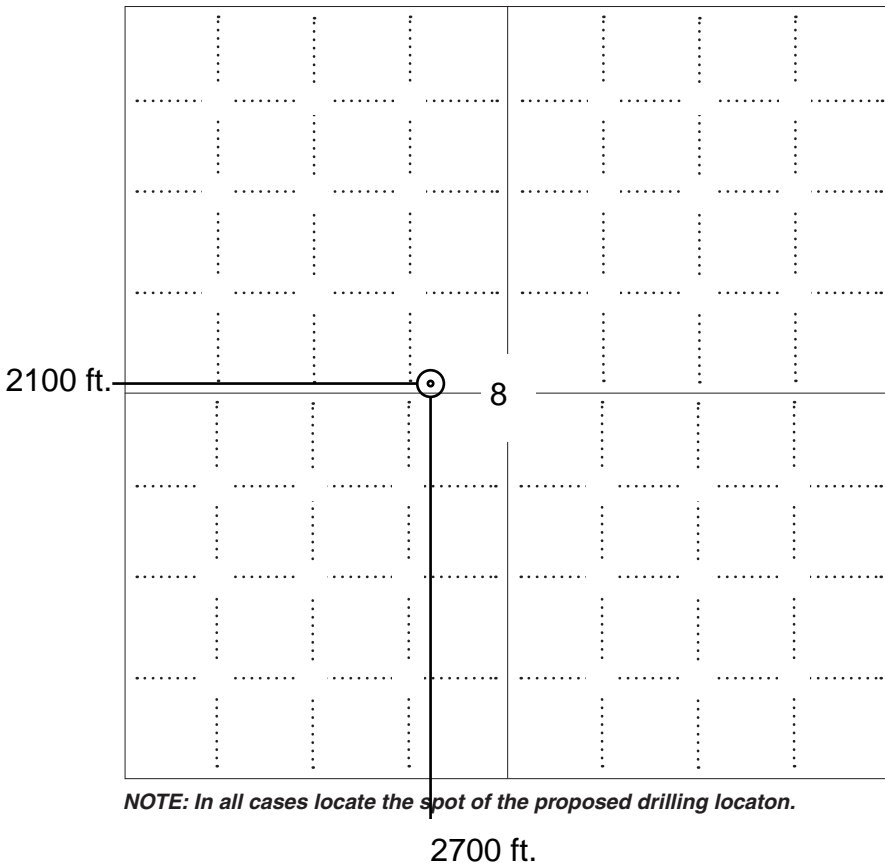

**NOTE: In all cases locate the spot of the proposed drilling locaton.**

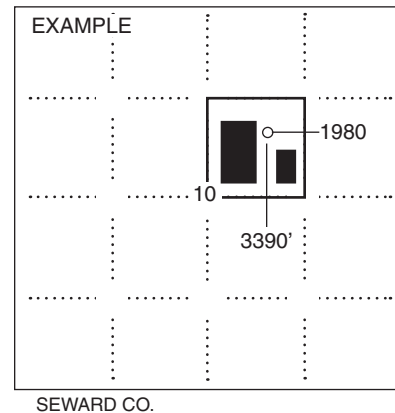

**In plotting the proposed location of the well, you must show:**

1. The manner in which you are using the depicted plat by identifying section lines, i.e. 1 section, 1 section with 8 surrounding sections, 4 sections, etc.
2. The distance of the proposed drilling location from the south / north and east / west outside section lines.
3. The distance to the nearest lease or unit boundary line (in footage).
4. If proposed location is located within a prorated or spaced field a certificate of acreage attribution plat must be attached: (C0-7 for oil wells; CG-8 for gas wells).



KANSAS CORPORATION COMMISSION 1028593  
OIL & GAS CONSERVATION DIVISION

Form CDP-1  
April 2004  
Form must be Typed

**APPLICATION FOR SURFACE PIT**

*Submit in Duplicate*

|   |  |  |  |
|---|--|--|--|
| Operator Name: _____  |  | License Number: _____  |  |
| Operator Address: _____   |  |  |  |
| Contact Person: _____   |  | Phone Number: _____  |  |
| Lease Name & Well No.: _____  |  | Pit Location (QQQQ):<br>_____-_____-_____-_____  |  |
| Type of Pit:<br><input type="checkbox"/> Emergency Pit <input type="checkbox"/> Burn Pit<br><input type="checkbox"/> Settling Pit <input type="checkbox"/> Drilling Pit<br><input type="checkbox"/> Workover Pit <input type="checkbox"/> Haul-Off Pit<br><i>(If WP Supply API No. or Year Drilled)</i>             |  | Pit is:<br><input type="checkbox"/> Proposed <input type="checkbox"/> Existing<br>If Existing, date constructed:<br>_____<br>Pit capacity:<br>_____ (bbls)   |  |
| Is the pit located in a Sensitive Ground Water Area? <input type="checkbox"/> Yes <input type="checkbox"/> No   |  | Chloride concentration: _____ mg/l<br><i>(For Emergency Pits and Settling Pits only)</i>   |  |
| Is the bottom below ground level?<br><input type="checkbox"/> Yes <input type="checkbox"/> No   |  | Artificial Liner?<br><input type="checkbox"/> Yes <input type="checkbox"/> No  |  |
| How is the pit lined if a plastic liner is not used?  |  | _____  |  |
| Pit dimensions (all but working pits): _____ Length (feet)    _____ Width (feet)    _____ N/A: Steel Pits<br>Depth from ground level to deepest point: _____ (feet)    _____ No Pit   |  |  |  |
| If the pit is lined give a brief description of the liner material, thickness and installation procedure.   |  | Describe procedures for periodic maintenance and determining liner integrity, including any special monitoring.  |  |
| Distance to nearest water well within one-mile of pit<br>_____ feet    Depth of water well _____ feet   |  | Depth to shallowest fresh water _____ feet.<br>Source of information:<br>_____ measured    _____ well owner    _____ electric log    _____ KDWR  |  |
| <b>Emergency, Settling and Burn Pits ONLY:</b><br>Producing Formation: _____<br>Number of producing wells on lease: _____<br>Barrels of fluid produced daily: _____<br>Does the slope from the tank battery allow all spilled fluids to flow into the pit? <input type="checkbox"/> Yes <input type="checkbox"/> No |  | <b>Drilling, Workover and Haul-Off Pits ONLY:</b><br>Type of material utilized in drilling/workover: _____<br>Number of working pits to be utilized: _____<br>Abandonment procedure: _____<br>_____<br>Drill pits must be closed within 365 days of spud date. |  |
| Submitted Electronically  |  |  |  |

|                            |                      |                    |  |      |
|----------------------------|----------------------|--------------------|--|------|
| <b>KCC OFFICE USE ONLY</b> |                      | Steel Pit          | RFAC   | RFAS |
| Date Received: _____       | Permit Number: _____ | Permit Date: _____ | Lease Inspection: <input type="checkbox"/> Yes <input type="checkbox"/> No |      |

State of Kansas, Graham County SS.  
This instrument was filed for Record on  
the 19 day of AUGUST  
20 08 A.D. at 9:45 o'clock A.M.  
Fees \$ 12.00 and duly recorded in  
Book 234 Page 584-585  
*Juanita Toll*  
Juanita Toll, REGISTER OF DEEDS

234 584

Direct  
Indirect  
Indexed  
Computer  
*JT*



THE STATE CORPORATION COMMISSION  
OF THE STATE OF KANSAS

CERTIFICATE OF ESTABLISHMENT OF UNIT AREA

The State Corporation Commission of the State of Kansas (the "Commission") hereby certifies the following pursuant to K.S.A. 55-1313:

1. On August 7, 2008, the Commission entered its Order Granting Unitization in Docket No. 08-CONS-172-CUNI authorizing the creation of the Clack/Swenson Unit unitizing the Lansing-Kansas City and Arbuckle formations underlying the following lands in Graham County, Kansas:

a 20.66 acre tract beginning 2,200 feet North and 2,600 feet East of the Southwest Corner (SW/C) of Section Eight (8), Township Nine (9) South, Range Twenty-One (21) West of the 6<sup>th</sup> P.M., Graham County, Kansas; thence North 1,000 feet; thence West 1,000 feet; thence South 500 feet; thence Southeast 640 feet; thence East 600 feet to the point of origin.

2. The Order Granting Unitization was issued pursuant to the Application filed by John O. Farmer, Inc. under the Kansas Unitization Act, K.S.A. 55-1301, *et seq.* (the "Act"), on May 12, 2008. Approval of the Unit Agreement and Unit Operating Agreement by the percentages of royalty interest owners and working interest owners required by the Act was obtained prior to filing of the Application. Commencement of unit operations will start on the effective date of the Order.

3. The tracts comprising this unit and the allocation of production from the unit among the owners of each tract is as fully setout in the Unit Agreement and Unit Operating Agreement.

IN WITNESS WHEREOF, this Certificate has been executed by the Kansas Corporation Commission on this 12<sup>th</sup> day of August, 2008.

KANSAS CORPORATION COMMISSION

[Signature]  
Thomas E. Wright, Chairman

[Signature]  
Michael C. Moffet, Commissioner

[Signature]  
Joseph F. Harkins, Commissioner

ATTEST:

[Signature]  
Susan K. Duffy  
Executive Director

SUBSCRIBED AND SWORN to me this 12 day of August, 2008.

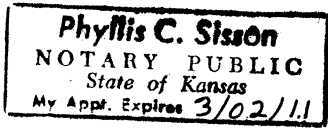

[Signature]  
Notary Public

My Appointment Expires:

March 02, 2011