



1029871

IN ALL CASES PLOT THE INTENDED WELL ON THE PLAT BELOW

Plat of acreage attributable to a well in a prorated or spaced field

If the intended well is in a prorated or spaced field, please fully complete this side of the form. If the intended well is in a prorated or spaced field complete the plat below showing that the well will be properly located in relationship to other wells producing from the common source of supply. Please show all the wells and within 1 mile of the boundaries of the proposed acreage attribution unit for gas wells and within 1/2 mile of the boundaries of the proposed acreage attribution unit for oil wells.

API No. 15 - _____

Operator: _____

Lease: _____

Well Number: _____

Field: _____

Number of Acres attributable to well: _____

QTR/QTR/QTR/QTR of acreage: _____ - _____ - _____ - _____

Location of Well: County: _____

_____ feet from N / S Line of Section

_____ feet from E / W Line of Section

Sec. _____ Twp. _____ S. R. _____ E W

Is Section: Regular or Irregular

If Section is Irregular, locate well from nearest corner boundary.

Section corner used: NE NW SE SW

PLAT

(Show location of the well and shade attributable acreage for prorated or spaced wells.)

(Show footage to the nearest lease or unit boundary line.)

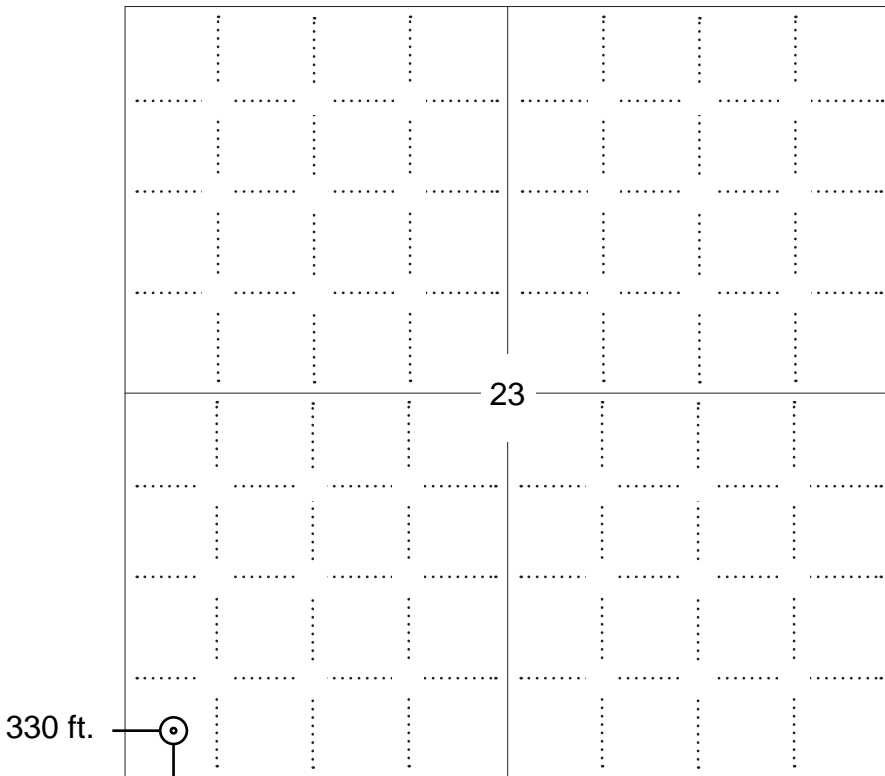

NOTE: In all cases locate the spot of the proposed drilling location.

330 ft.

In plotting the proposed location of the well, you must show:

1. The manner in which you are using the depicted plat by identifying section lines, i.e. 1 section, 1 section with 8 surrounding sections, 4 sections, etc.
2. The distance of the proposed drilling location from the south / north and east / west outside section lines.
3. The distance to the nearest lease or unit boundary line (in footage).
4. If proposed location is located within a prorated or spaced field a certificate of acreage attribution plat must be attached: (C0-7 for oil wells; CG-8 for gas wells).



KANSAS CORPORATION COMMISSION 1029871
OIL & GAS CONSERVATION DIVISION

Form CDP-1
April 2004
Form must be Typed

APPLICATION FOR SURFACE PIT

Submit in Duplicate

Operator Name: _____		License Number: _____	
Operator Address: _____			
Contact Person: _____		Phone Number: _____	
Lease Name & Well No.: _____		Pit Location (QQQQ): _____ - _____ - _____ - _____	
Type of Pit: <input type="checkbox"/> Emergency Pit <input type="checkbox"/> Burn Pit <input type="checkbox"/> Settling Pit <input type="checkbox"/> Drilling Pit <input type="checkbox"/> Workover Pit <input type="checkbox"/> Haul-Off Pit <i>(If WP Supply API No. or Year Drilled)</i>		Pit is: <input type="checkbox"/> Proposed <input type="checkbox"/> Existing If Existing, date constructed: _____ Pit capacity: _____ (bbls)	
Is the pit located in a Sensitive Ground Water Area? <input type="checkbox"/> Yes <input type="checkbox"/> No		Chloride concentration: _____ mg/l <i>(For Emergency Pits and Settling Pits only)</i>	
Is the bottom below ground level? <input type="checkbox"/> Yes <input type="checkbox"/> No		Artificial Liner? <input type="checkbox"/> Yes <input type="checkbox"/> No	
How is the pit lined if a plastic liner is not used?		_____	
Pit dimensions (all but working pits): _____ Length (feet) _____ Width (feet) _____ N/A: Steel Pits Depth from ground level to deepest point: _____ (feet) _____ No Pit			
If the pit is lined give a brief description of the liner material, thickness and installation procedure.		Describe procedures for periodic maintenance and determining liner integrity, including any special monitoring.	
Distance to nearest water well within one-mile of pit _____ feet Depth of water well _____ feet		Depth to shallowest fresh water _____ feet. Source of information: _____ measured _____ well owner _____ electric log _____ KDWR	
Emergency, Settling and Burn Pits ONLY: Producing Formation: _____ Number of producing wells on lease: _____ Barrels of fluid produced daily: _____ Does the slope from the tank battery allow all spilled fluids to flow into the pit? <input type="checkbox"/> Yes <input type="checkbox"/> No		Drilling, Workover and Haul-Off Pits ONLY: Type of material utilized in drilling/workover: _____ Number of working pits to be utilized: _____ Abandonment procedure: _____ _____ Drill pits must be closed within 365 days of spud date.	
Submitted Electronically			

KCC OFFICE USE ONLY		Steel Pit	RFAC	RFAS
Date Received: _____	Permit Number: _____	Permit Date: _____	Lease Inspection: <input type="checkbox"/> Yes <input type="checkbox"/> No	

STATE OF KANSAS
STATE CORPORATION COMMISSION
200 Colorado Derby Building
Wichita, Kansas 67202

WELL PLUGGING RECORD
K.A.R.-82-3-117

File

15-163-20694-00-00

API NUMBER _____

LEASE NAME Kellogg

WELL NUMBER B-1

330 Ft. from S Section Line

4950 Ft. from E Section Line

SEC. 23 TWP. 8 RGE. 19 ~~W~~ or (W)

COUNTY Rooks

Date Well Completed 5/9/77

Plugging Commenced 11/28/90

Plugging Completed 11/28/90

TYPE OR PRINT
NOTICE: Fill out completely
and return to Cons. Div.
office within 30 days.

LEASE OPERATOR Bowman Oil Company

ADDRESS Box 17 Codell, Ks 67630

PHONE# (913) 434-2304 OPERATORS LICENSE NO. 6931

Character of Well Oil

(Oil, Gas, D&A, SWD, Input, Water Supply Well)

The plugging proposal was approved on 9/7/88 (date)

by Dennis Hamel (KCC District Agent's Name).

Is ACO-1 filed? _____ If not, is well log attached? Yes

Producing Formation Arbuckle Depth to Top 3358 Bottom 3378 T.D. 3439

Show depth and thickness of all water, oil and gas formations.

OIL, GAS OR WATER RECORDS

CASING RECORD

Formation	Content	From	To	Size	Put in	Pulled out
Arbuckle	Oil & Water	0	259	8 5/8	259	None
		0	3439	5 1/2	3439	None

Describe in detail the manner in which the well was plugged, indicating where the mud fluid was placed and the method or methods used in introducing it into the hole. If cement or other plug were used, state the character of same and depth placed, from feet to feet each set
Well was perforated 3164', anhydrite 1340, Dakota 750', then Halliburton cemented from 0 to 3439' with 150 sacks of cement with 1/4# fl0-celc per sack using 600# hulls, finished with good pressure.

(If additional description is necessary, use BACK of this form.)

Name of Plugging Contractor Halliburton Services (Hays, Ks) License No. _____

Address P. O. Box 951046 Dallas, Tx 75395-1046

NAME OF PARTY RESPONSIBLE FOR PLUGGING FEES: Bowman Oil Company

STATE OF Kansas COUNTY OF Rooks, ss.

Louis D. Bowman (Employee of Operator) or (Operator) of above-described well, being first duly sworn on oath, says: That I have knowledge of the facts statements, and matters herein contained and the log of the above-described well as filed the the same are true and correct, so help me God.

(Signature) Louis D. Bowman

(Address) Box 37 Codell, Ks 67630

SUBSCRIBED AND SWORN TO before me this 19th day of May

STATE CORPORATION COMMISSION
RECEIVED
MAY 20 1993

Vesta J. Russell
Notary Public

My Commission Expires: July 17, 1996

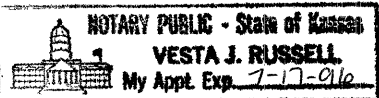

CONSERVATION DIVISION
Wichita, Kansas
Form CP-4
Revised 05-88

S-20-93

15-163-20694-00-00

DRILLERS' WELL LOG

DATE COMMENCED: May 1, 1977
DATE COMPLETED: May 9, 1977

Southern States Oil Company
KELLOGG B-1
SW SW SW
Sec 23-T8-R19W
Rooks County, Kansas

ELEVATION: 1931 K.B.

0 - 259' Clay and Shale
259 - 695' Shale, Sand Streaks
695 - 1060' Shale, Sand
1060 - 1332' Red Bed
1332 - 1372' Anhydrite
1372 - 1545' Shale
1545 - 3068' Shale and Lime
3068 - 3072' Shale
3072 - 3090' Lime and Shale
3090 - 3108' Lime
3108 - 3358' Lime and Shale
3358 - 3440' Dolomite
3440' RTD

FORMATION TOPS

Anhydrite 1332
Heebner 3068
Toronto 3090
Lansing 3108
Arbuckle 3358
RTD 3440

SURFACE PIPE:

Set used 8 5/8", 28# pipe
at 259' w/160 sacks Common,
2% Gel, 3% cc.

PRODUCTION PIPE:

Ran new 5 1/2", 14# casing at
3439' w/200 sacks Common,
10% salt, .75% CRF2 and
10 bbl salt flush ahead.

5,100.50 TO 300 4-10-77

A F F I D A V I T

STATE OF KANSAS)
COUNTY OF BARTON) ss.

Larry Curtis, of lawful age, does swear and state that the facts and
statements herein contained are true and correct to the best of his knowledge.

Larry Curtis

Subscribed and sworn to before me this 10th day of May, 1977.

Christy M. Haque
Notary Public

RECEIVED
STATE CORPORATION COMM
MAY 20 1993

My Commission Expires: April 11, 1978

CONSERVATION DIVISION
Wichita, Kansas
S-20-93



*Mark Parkinson, Governor
Thomas E. Wright, Chairman
Michael C. Moffet, Commissioner
Joseph F. Harkins, Commissioner*

July 16, 2009

Kenneth Vehige
Black Diamond Oil, Inc.
PO BOX 641
HAYS, KS67601-0641

Re: Drilling Pit Application
Kellogg B Lease Well No. 1
SW/4 Sec.23-08S-19W
Rooks County, Kansas

Dear Kenneth Vehige:

District staff has inspected the above referenced location and has determined that the reserve pit shall be constructed **without slots**, the bottom shall be flat and reasonably level, and the free fluids must be removed. The fluids are to be removed from the reserve pit as soon as practical after drilling operations have ceased. Keep pits away from draw/drainage.

If production casing is set all completion fluids shall be removed from the working pits daily. NO completion fluids or non-exempt wastes shall be placed in the reserve pit.

The fluids should be taken to an authorized disposal well. Please call the District Office at (785) 625-0550 when the fluids have been removed. Please file form CDP-5 (August 2004), Exploration and Production Waste Transfer, within 30 days of fluid removal. Conservation division forms are available through our office and on the KCC web site:
kcc.ks.gov/conservation/forms/

A copy of this letter should be posted in the doghouse along with the approved Intent to Drill. If you have any questions or concerns please feel free to contact the District Office at (785) 625-0550.