



1030320

IN ALL CASES PLOT THE INTENDED WELL ON THE PLAT BELOW

Plat of acreage attributable to a well in a prorated or spaced field

If the intended well is in a prorated or spaced field, please fully complete this side of the form. If the intended well is in a prorated or spaced field complete the plat below showing that the well will be properly located in relationship to other wells producing from the common source of supply. Please show all the wells and within 1 mile of the boundaries of the proposed acreage attribution unit for gas wells and within 1/2 mile of the boundaries of the proposed acreage attribution unit for oil wells.

API No. 15 - _____

Operator: _____

Lease: _____

Well Number: _____

Field: _____

Number of Acres attributable to well: _____

QTR/QTR/QTR/QTR of acreage: _____ - _____ - _____ - _____

Location of Well: County: _____

_____ feet from N / S Line of Section

_____ feet from E / W Line of Section

Sec. _____ Twp. _____ S. R. _____ E W

Is Section: Regular or Irregular

If Section is Irregular, locate well from nearest corner boundary.

Section corner used: NE NW SE SW

PLAT

(Show location of the well and shade attributable acreage for prorated or spaced wells.)

(Show footage to the nearest lease or unit boundary line.)

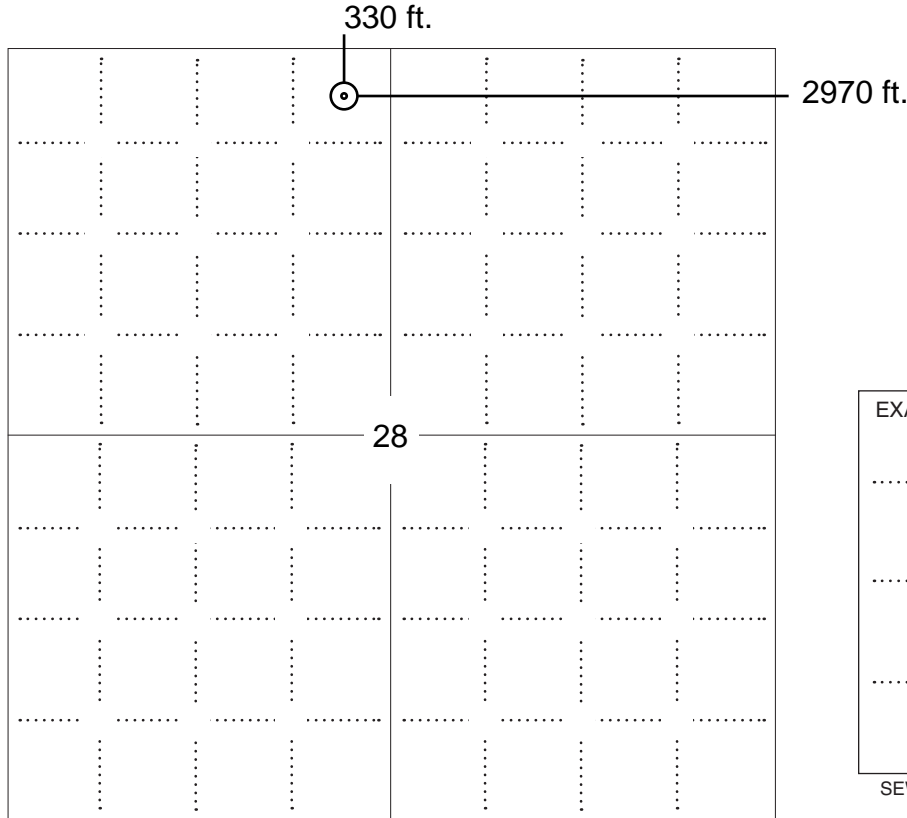

NOTE: In all cases locate the spot of the proposed drilling locaton.

In plotting the proposed location of the well, you must show:

1. The manner in which you are using the depicted plat by identifying section lines, i.e. 1 section, 1 section with 8 surrounding sections, 4 sections, etc.
2. The distance of the proposed drilling location from the south / north and east / west outside section lines.
3. The distance to the nearest lease or unit boundary line (in footage).
4. If proposed location is located within a prorated or spaced field a certificate of acreage attribution plat must be attached: (C0-7 for oil wells; CG-8 for gas wells).



KANSAS CORPORATION COMMISSION 1030320
OIL & GAS CONSERVATION DIVISION

Form CDP-1
April 2004
Form must be Typed

APPLICATION FOR SURFACE PIT

Submit in Duplicate

Operator Name: _____		License Number: _____	
Operator Address: _____			
Contact Person: _____		Phone Number: _____	
Lease Name & Well No.: _____		Pit Location (QQQQ): _____-_____-_____-_____	
Type of Pit: <input type="checkbox"/> Emergency Pit <input type="checkbox"/> Burn Pit <input type="checkbox"/> Settling Pit <input type="checkbox"/> Drilling Pit <input type="checkbox"/> Workover Pit <input type="checkbox"/> Haul-Off Pit <i>(If WP Supply API No. or Year Drilled)</i>		Pit is: <input type="checkbox"/> Proposed <input type="checkbox"/> Existing If Existing, date constructed: _____ Pit capacity: _____ (bbls)	
Is the pit located in a Sensitive Ground Water Area? <input type="checkbox"/> Yes <input type="checkbox"/> No		Chloride concentration: _____ mg/l <i>(For Emergency Pits and Settling Pits only)</i>	
Is the bottom below ground level? <input type="checkbox"/> Yes <input type="checkbox"/> No		Artificial Liner? <input type="checkbox"/> Yes <input type="checkbox"/> No	
How is the pit lined if a plastic liner is not used?		_____	
Pit dimensions (all but working pits): _____ Length (feet) _____ Width (feet) _____ N/A: Steel Pits Depth from ground level to deepest point: _____ (feet) _____ No Pit			
If the pit is lined give a brief description of the liner material, thickness and installation procedure.		Describe procedures for periodic maintenance and determining liner integrity, including any special monitoring.	
Distance to nearest water well within one-mile of pit _____ feet Depth of water well _____ feet		Depth to shallowest fresh water _____ feet. Source of information: _____ measured _____ well owner _____ electric log _____ KDWR	
Emergency, Settling and Burn Pits ONLY: Producing Formation: _____ Number of producing wells on lease: _____ Barrels of fluid produced daily: _____ Does the slope from the tank battery allow all spilled fluids to flow into the pit? <input type="checkbox"/> Yes <input type="checkbox"/> No		Drilling, Workover and Haul-Off Pits ONLY: Type of material utilized in drilling/workover: _____ Number of working pits to be utilized: _____ Abandonment procedure: _____ _____ Drill pits must be closed within 365 days of spud date.	
Submitted Electronically			

KCC OFFICE USE ONLY		Steel Pit	RFAC	RFAS
Date Received: _____	Permit Number: _____	Permit Date: _____	Lease Inspection: <input type="checkbox"/> Yes <input type="checkbox"/> No	

STATE OF KANSAS
STATE CORPORATION COMMISSION

Give All Information Completely
Make Required Affidavit
Mail or Deliver Report to:
Conservation Division
State Corporation Commission
211 No. Broadway
Wichita, Kansas

15-051-05222-00-00
WELL PLUGGING RECORD

NORTH

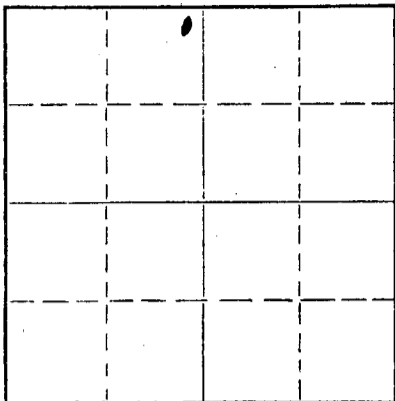

Locate well correctly on above
Section Plat

Ellis County. Sec. 28 Twp. 11S Rge. (X) 18 (W)

Location as "NE/CNW/SW" or footage from lines C NE NE NW
Lease Owner Gulf Oil Corporation
Lease Name I Truan Well No. 1
Office Address Box 661, Tulsa, Oklahoma
Character of Well (completed as Oil, Gas or Dry Hole) Oil
Date well completed 11-15 19 58
Application for plugging filed 1-31 19 58
Application for plugging approved 2- 3 19 58
Plugging commenced 2-15 19 58
Plugging completed 2-19 19 58
Reason for abandonment of well or producing formation Well operating below its economic limit.
If a producing well is abandoned, date of last production 1-15 19 58
Was permission obtained from the Conservation Division or its agents before plugging was commenced? Yes

Name of Conservation Agent who supervised plugging of this well Eldon Petty
Producing formation Arbuckle Depth to top 3527 Bottom 3535 Total Depth of Well 3535 Feet
Show depth and thickness of all water, oil and gas formations.

OIL, GAS OR WATER RECORDS

CASING RECORD

FORMATION	CONTENT	FROM	TO	SIZE	PUT IN	PULLED OUT
				8-5/8"	1300'	-0-
				5-1/2"	3528'	2759'

Describe in detail the manner in which the well was plugged, indicating where the mud fluid was placed and the method or methods used in introducing it into the hole. If cement or other plugs were used, state the character of same and depth placed, from _____ feet to _____ feet for each plug set.

Filled with rock to 3500' and spotted 4 sx. cement. Mudded with 31 sx mud and spotted 40 sx. cement. Mudded to 35' and capped with 10 sx. cement.

RECEIVED
STATE CORPORATION COMMISSION
2-25-1958
FEB 25 1958
CONSERVATION DIVISION
Wichita, Kansas

(If additional description is necessary, use BACK of this sheet)

Name of Plugging Contractor Morgan Well Plugging Service
Address Hutchinson, Kansas

STATE OF Kansas, COUNTY OF Sedgwick, ss. Thomas A. Trax (employee of owner) or (owner or operator) of the above-described

well, being first duly sworn on oath, says: That I have knowledge of the facts, statements, and matters herein contained and the log of the above-described well as filed and that the same are true and correct. So help me God.

(Signature) Thomas A. Trax

Box 2233, Wichita, Kansas
(Address)

SUBSCRIBED AND SWORN TO before me this 20th day of February, 19 58

C. C. Lewis
C. C. LEWIS, NOTARY PUBLIC Notary Public.

My commission expires 6-3-61

JRM:WB

PLUGGING
FILE SEC 28 T 11 R 184
BOOK PAGE 80 LINE 16

15-051-05222-00-00

GULF OIL CORPORATION

IDA TRUAN NO. 1

Center NE NE NW of Section 28-11S-18W,
Ellis County, Kansas

8-5/8" O.D. casing cemented at 1306'
5-1/2" O.D. casing cemented at 3529'

Drilling commenced 10-22-48
Drilling completed 11-5-48

FROM	TO	FORMATION	REMARKS
0'	605'	Pyrite, sand, shale and shells	
605	765	Pyrite and sand	
765	910	Sand and shells	
910	1125	Shale and shells	
1025	1170	Red bed and shells	
1170	1284	Shale and shells	8-5/8" O.D. casing cemented with 525 sacks cement and 2% jel at 1306'.
1284	1320	Anhydrite	
1320	1825	Shale and shells	
1825	1850	Shale and gyp	
1850	1900	Anhydrite, lime and shale	
1900	2180	Shale and lime	
2180	2315	Lime and shale	
2315	2485	Shale and shells	
2485	2540	Lime and shale	
2540	2820	Shale	
2820	2890	Lime and shale	
2890	3040	Shale and lime	
3040	3085	Lime and shale	
3085	3240	Lime	
3240	3265	Shale and lime	
3265	3380	Lime	
3380	3400	Lime and shale	
3400	3500	Lime	
3500	3525	Lime and shale	
3525	3527	Shale	5-1/2" O.D. casing cemented with 100 sacks bulk cement at 3529'.
3527	3529	Arbuckle	

T.D. 3529'

Well acidized

Deepend with Cobble tools to 3535' T.D.

PLUGGING			
FILE	SEC	T. H. R.	18W
BOOK	PAGE	80	LINE 16

COMMISSION
2-1-1958
FEB 1 1958
CONSERVATION DIVISION
Wichita, Kansas