



KANSAS CORPORATION COMMISSION 1033469  
OIL & GAS CONSERVATION DIVISION

Form CP-1  
March 2009

This Form must be Typed  
Form must be Signed  
All blanks must be Filled

WELL PLUGGING APPLICATION

Please TYPE Form and File ONE Copy

OPERATOR: License #: \_\_\_\_\_  
Name: \_\_\_\_\_  
Address 1: \_\_\_\_\_  
Address 2: \_\_\_\_\_  
City: \_\_\_\_\_ State: \_\_\_\_\_ Zip: \_\_\_\_\_ + \_\_\_\_\_  
Contact Person: \_\_\_\_\_  
Phone: ( \_\_\_\_\_ ) \_\_\_\_\_

API No. 15 - \_\_\_\_\_  
If pre 1967, supply original completion date: \_\_\_\_\_  
Spot Description: \_\_\_\_\_  
\_\_\_\_ - \_\_\_\_ - \_\_\_\_ Sec. \_\_\_\_ Twp. \_\_\_\_ S. R. \_\_\_\_  East  West  
\_\_\_\_ Feet from  North /  South Line of Section  
\_\_\_\_ Feet from  East /  West Line of Section  
Footages Calculated from Nearest Outside Section Corner:  
 NE  NW  SE  SW  
County: \_\_\_\_\_  
Lease Name: \_\_\_\_\_ Well #: \_\_\_\_\_

Check One:  Oil Well  Gas Well  OG  D&A  Cathodic  Water Supply Well  Other: \_\_\_\_\_  
 SWD Permit #: \_\_\_\_\_  ENHR Permit #: \_\_\_\_\_  Gas Storage Permit #: \_\_\_\_\_

Conductor Casing Size: \_\_\_\_\_ Set at: \_\_\_\_\_ Cemented with: \_\_\_\_\_ Sacks  
Surface Casing Size: \_\_\_\_\_ Set at: \_\_\_\_\_ Cemented with: \_\_\_\_\_ Sacks  
Production Casing Size: \_\_\_\_\_ Set at: \_\_\_\_\_ Cemented with: \_\_\_\_\_ Sacks

List (ALL) Perforations and Bridge Plug Sets:

Elevation: \_\_\_\_\_ (  G.L. /  K.B. ) T.D.: \_\_\_\_\_ PBTD: \_\_\_\_\_ Anhydrite Depth: \_\_\_\_\_  
(Stone Corral Formation)

Condition of Well:  Good  Poor  Junk in Hole  Casing Leak at: \_\_\_\_\_  
(Interval)

Proposed Method of Plugging (attach a separate page if additional space is needed):

Is Well Log attached to this application?  Yes  No Is ACO-1 filed?  Yes  No

If ACO-1 not filed, explain why:

Plugging of this Well will be done in accordance with K.S.A. 55-101 et. seq. and the Rules and Regulations of the State Corporation Commission

Company Representative authorized to supervise plugging operations: \_\_\_\_\_

Address: \_\_\_\_\_ City: \_\_\_\_\_ State: \_\_\_\_\_ Zip: \_\_\_\_\_ + \_\_\_\_\_

Phone: ( \_\_\_\_\_ ) \_\_\_\_\_

Plugging Contractor License #: \_\_\_\_\_ Name: \_\_\_\_\_

Address 1: \_\_\_\_\_ Address 2: \_\_\_\_\_

City: \_\_\_\_\_ State: \_\_\_\_\_ Zip: \_\_\_\_\_ + \_\_\_\_\_

Phone: ( \_\_\_\_\_ ) \_\_\_\_\_

Proposed Date of Plugging (if known): \_\_\_\_\_

Payment of the Plugging Fee (K.A.R. 82-3-118) will be guaranteed by Operator or Agent

Submitted Electronically

Form	CP1 - Well Plugging Application
Operator	Vess Oil Corporation
Well Name	Pierpoint A 101W
Doc ID	1033469

Perforations And Bridge Plug Sets

Perforation Top	Perforation Base	Formation	Bridge Plug Depth
1951	1980	KC	1340
593	603	Admire	585
745	776	cement	

**SCHLUMBERGER WELL SURVEYING CORPORATION**  
Houston, Texas

COUNTY FIELD or LOCATION WELL  
 COUNTY Butler STATE Kansas  
 COMPANY Cities Service Oil Co.  
 WELL Pierpont No. 101  
 FIELD El Dorado  
 LOCATION 700 N. & 6th W. Okemata Other Services:  
 Sec. 33 Twp. 25S Rge. 5E  
 Permanent Datum: Ground, Elev. 1357 Elev.: K.B. 1362  
 Log Measured From K13 5 Ft. Above Perm. Datum D.F.  
 Drilling Measured From K13 G.L. 1357

Date	<u>October 31, 1963</u>
Run No.	<u>C10</u>
Depth—Driller	<u>2036</u>
Depth—Logger	<u>2035</u>
Btm. Log Interval	<u>2034</u>
Top Log Interval	
Casing—Driller	<u>2512 @ 650 @ @ @</u>
Casing—Logger	
Bit Size	<u>7 7/8</u>
Type Fluid in Hole	<u>Gas</u>
Dens.	<u>9.6</u>
Visc.	<u>40</u>
pH	
Fluid Loss	<u>10</u> <u>11.4</u> ml
Source of Sample	<u>Flow line</u>
R <sub>m</sub> @ Meas. Temp.	<u>0.80 @ 74 °F @ °F @ °F @ °F</u>
R <sub>mf</sub> @ Meas. Temp.	<u>0.532 @ 74 °F @ °F @ °F @ °F</u>
R <sub>mc</sub> @ Meas. Temp.	<u>@ °F @ °F @ °F @ °F</u>
Source: R <sub>mf</sub> R <sub>mc</sub>	<u>M @</u>
R <sub>m</sub> @ BHT	<u>0.70 @ 85 °F @ °F @ °F @ °F</u>
Time Since Circ.	<u>2 hours</u>
Max. Rec. Temp.	<u>85 °F °F °F °F</u>
Equip. Location	<u>2924 Wichita</u>
Recorded By	<u>Z. J. Day</u>
Witnessed By	<u>H. J. P. P.</u>

FOLD HERE

**REMARKS**

Changes in Mud Type or Additional Samples  
 Date Sample No. Type Log Depth Scale Up Hole Scale Down  
 Depth—Driller  
 Type Fluid in Hole  
 Dens. Visc. ml  
 ph Fluid Loss ml  
 Source of Sample  
 R<sub>m</sub> @ Meas. Temp. 0.80 @ 74 °F @ °F @ °F @ °F  
 R<sub>mf</sub> @ Meas. Temp. 0.532 @ 74 °F @ °F @ °F @ °F  
 R<sub>mc</sub> @ Meas. Temp. @ °F @ °F @ °F @ °F  
 Source: R<sub>mf</sub> R<sub>mc</sub> M @  
 R<sub>m</sub> @ BHT 0.70 @ 85 °F @ °F @ °F @ °F  
 R<sub>mf</sub> @ BHT 0.466 @ 85 °F @ °F @ °F @ °F  
 R<sub>mc</sub> @ BHT @ °F @ °F @ °F @ °F  
 Equipment Data  
 Tool Position  
 Tool Type  
 Run No.  
 C.D.: Used S.O.: 1 1/2"  
 Equip. Used: CART. No.  
 PANEL No.  
 SONDE No.

SPONTANEOUS-POTENTIAL millivolts	-   ↔   + 15	DEPTHS	CONDUCTIVITY millimhos/m = $\frac{1000}{\text{ohms. m}^2/\text{m}}$
			INDUCTION FF40 1000 500 1500
RESISTIVITY -ohms. m <sup>2</sup> /m	A-16" -M SHORT NORMAL 0 500	CONDUCTIVITY	
		RESISTIVITY	

A-16"-M	50
SHORT NORMAL	500
INDUCTION	50
	500

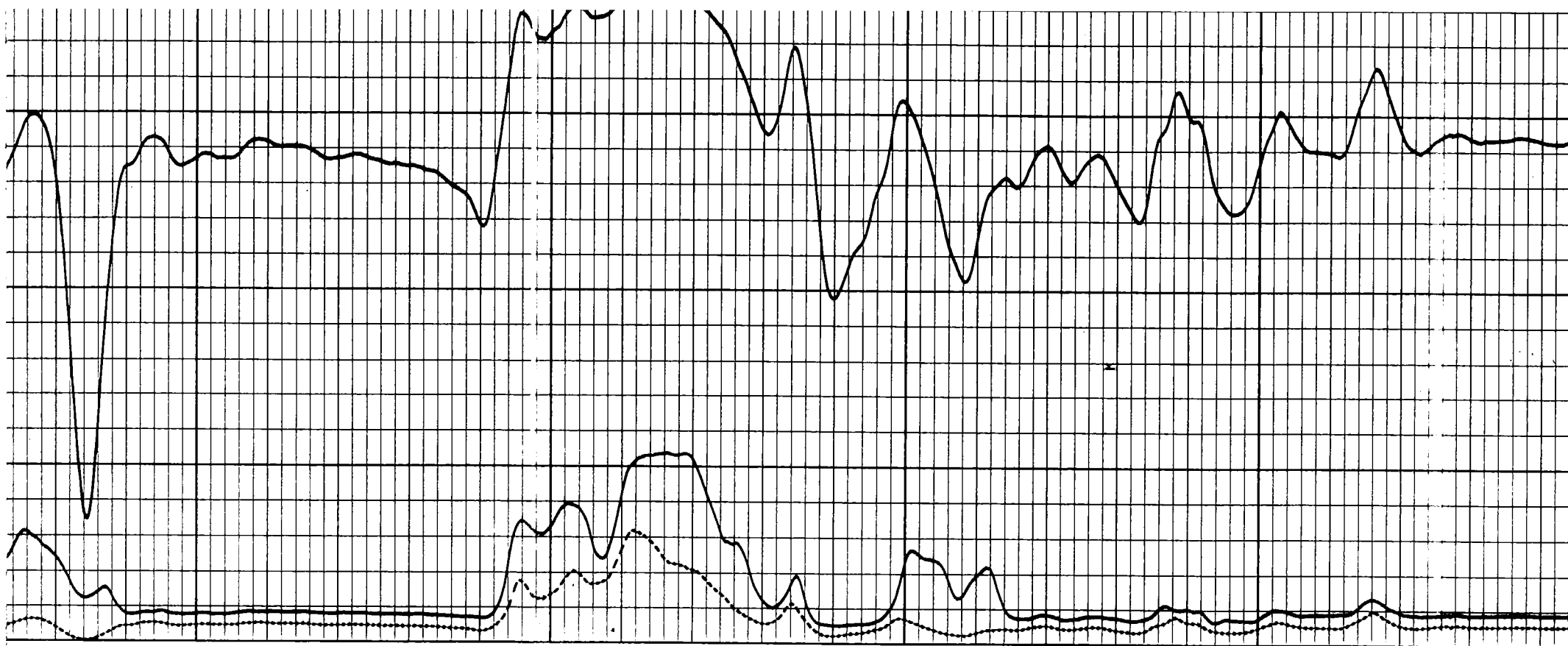

1300

1400

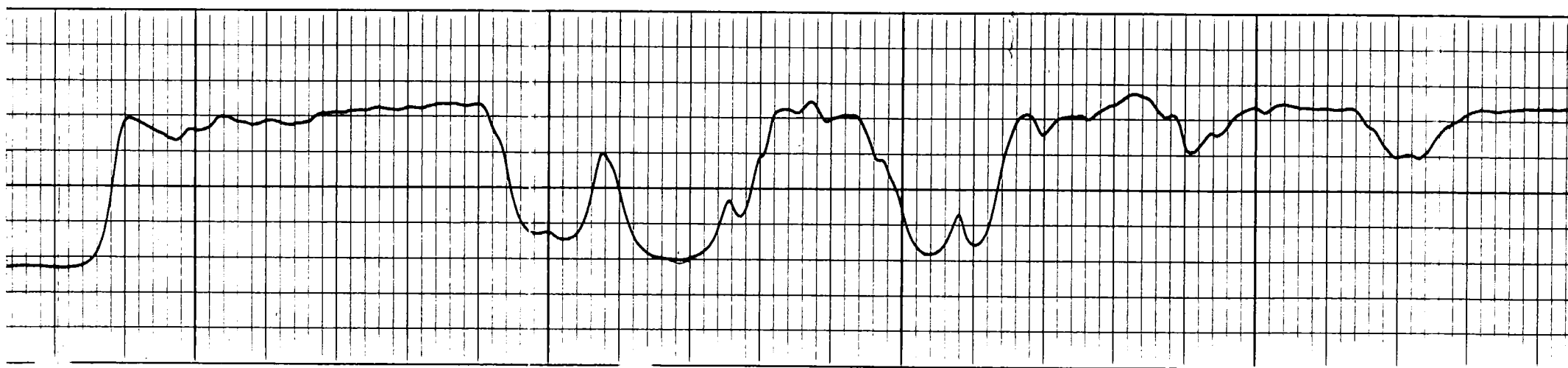



1500

1600

1700

1654  
1362  
292

132  
58

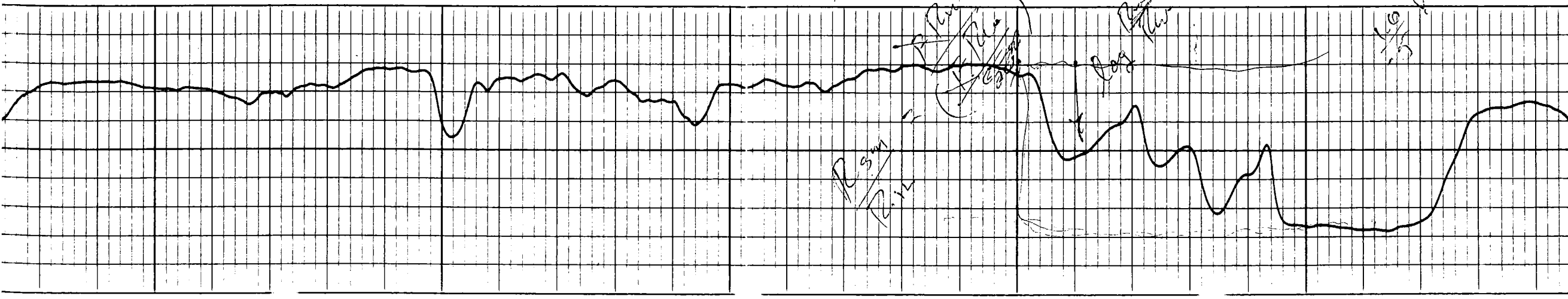

EX 1/200  
EX 2/200

132  
58

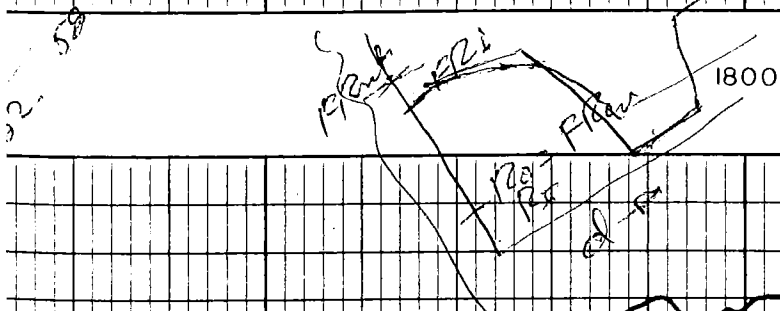
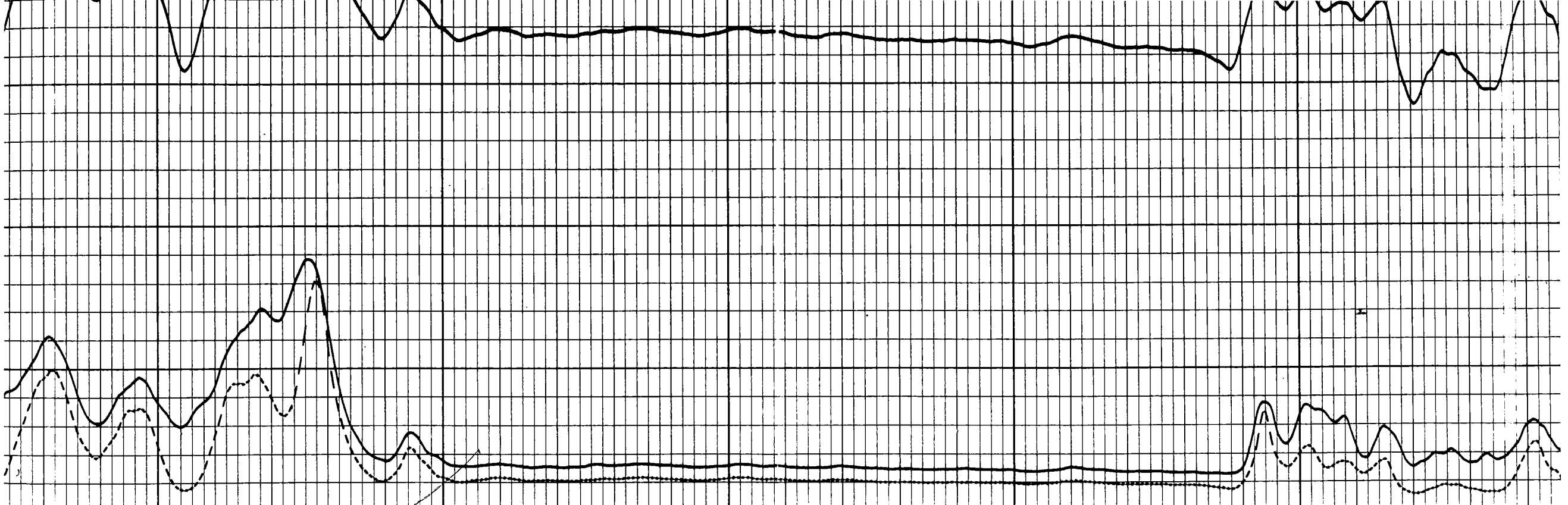

1900

1942  
1367  
-580

1130  
 P. 1. 100%  
 F. 1. 100%  
 T. 1. 100%  
 R. 1. 100%  
 L. 1. 100%  
 A. 1. 100%  
 V. 1. 100%  
 T. 1. 100%  
 L. 1. 100%

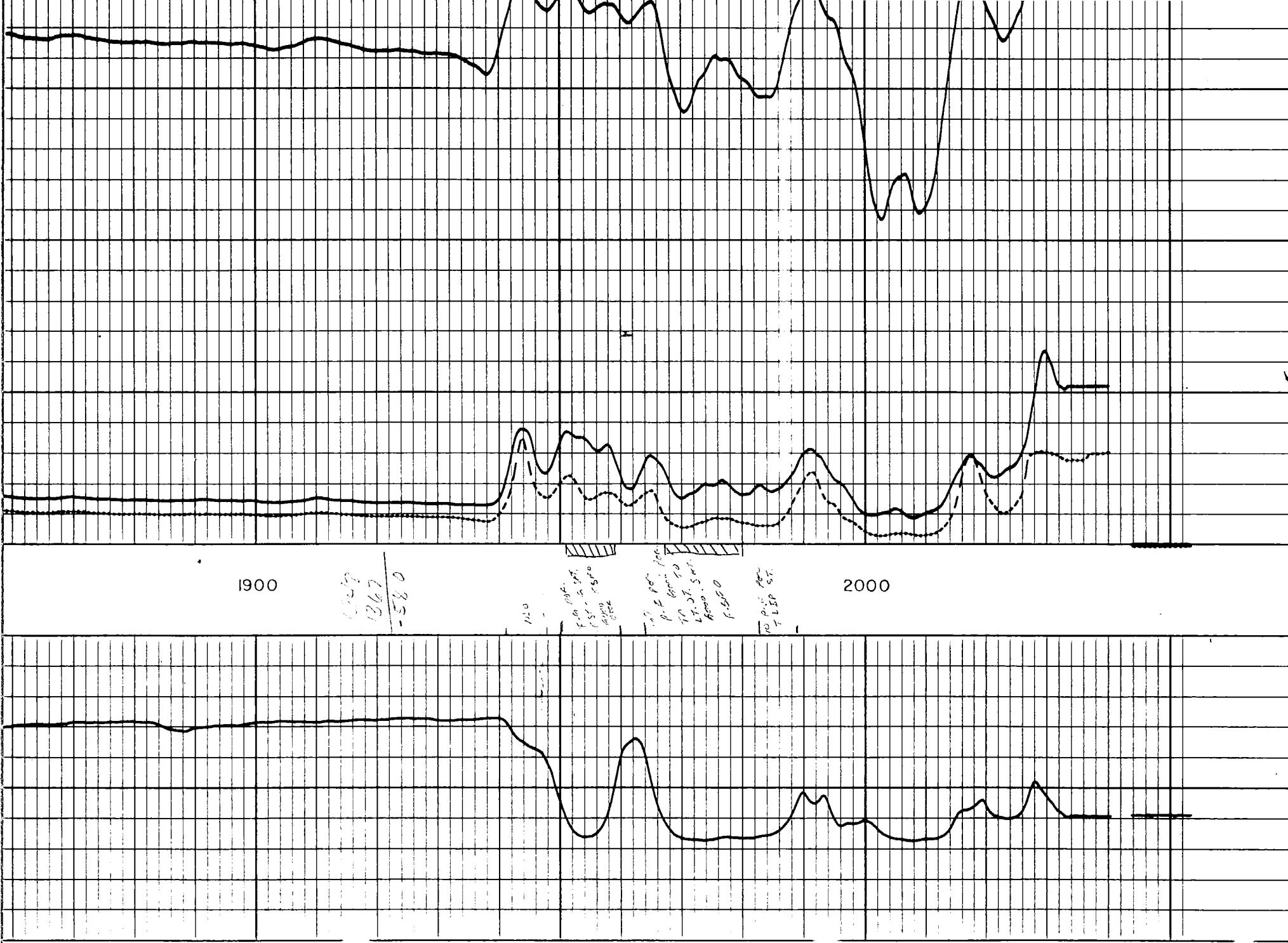

1900

2000

1949  
1367  
-580

1950

1950  
1950  
1950  
1950

1950  
1950  
1950  
1950  
1950  
1950  
1950  
1950

1950  
1950  
1950  
1950  
1950  
1950  
1950  
1950

Part 1951-59 - (8')

1967-80 (13')

$\frac{13}{8} \times 2 \text{ holes} = 42$

46 ball scalars



*Mark Parkinson, Governor  
Thomas E. Wright, Chairman  
Michael C. Moffet, Commissioner  
Joseph F. Harkins, Commissioner*

December 04, 2009

W.R. Horigan  
Vess Oil Corporation  
1700 WATERFRONT PKWY BLDG 500  
WICHITA, KS 67206-6619

Re: Plugging Application  
API 15-015-19748-00-00  
Pierpoint A 101W  
NW/4 Sec.33-25S-05E  
Butler County, Kansas

Dear W.R. Horigan:

This letter is to notify you that the Conservation Division has received your plugging proposal, form CP-1, for the above well and has reviewed the proposal for completeness. The central office will now forward your CP-1 to the district office listed below for review of the proposed plugging method. **Please contact the district office for approval of your proposed plugging method at least five (5) days before plugging the well, pursuant to K.A.R. 82-3-113(b). If a workover pit will be used during the plugging of the well it must be permitted. A CDP-1 form must be filed and approved prior to the use of the pit in accordance with K.A.R. 82-3-600.**

The Conservation Division's review of form CP-1, either in the central or district office, does not include an inquiry into well ownership or the filing operator's legal right to plug the well. This notice in no way constitutes authorization to plug the above well by persons not having legal rights of ownership or interest in the well.

**This notice is void after June 02, 2010. The CP-1 filing does not bring the above well into compliance with K.A.R 82-3-111 with regard to the Commission's temporary abandonment requirements.**

Sincerely,  
Production Department Supervisor

cc: District 2

(316) 630-4000