



1033738

IN ALL CASES PLOT THE INTENDED WELL ON THE PLAT BELOW

Plat of acreage attributable to a well in a prorated or spaced field

If the intended well is in a prorated or spaced field, please fully complete this side of the form. If the intended well is in a prorated or spaced field complete the plat below showing that the well will be properly located in relationship to other wells producing from the common source of supply. Please show all the wells and within 1 mile of the boundaries of the proposed acreage attribution unit for gas wells and within 1/2 mile of the boundaries of the proposed acreage attribution unit for oil wells.

API No. 15 - _____

Operator: _____

Lease: _____

Well Number: _____

Field: _____

Number of Acres attributable to well: _____

QTR/QTR/QTR/QTR of acreage: _____ - _____ - _____ - _____

Location of Well: County: _____

_____ feet from N / S Line of Section

_____ feet from E / W Line of Section

Sec. _____ Twp. _____ S. R. _____ E W

Is Section: Regular or Irregular

If Section is Irregular, locate well from nearest corner boundary.

Section corner used: NE NW SE SW

PLAT

(Show location of the well and shade attributable acreage for prorated or spaced wells.)

(Show footage to the nearest lease or unit boundary line.)

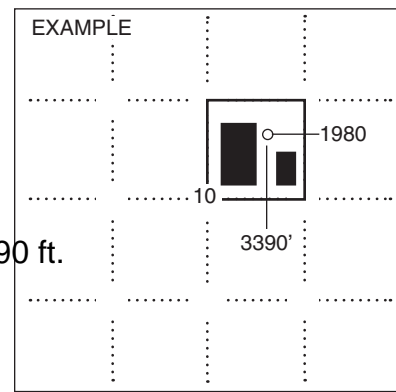
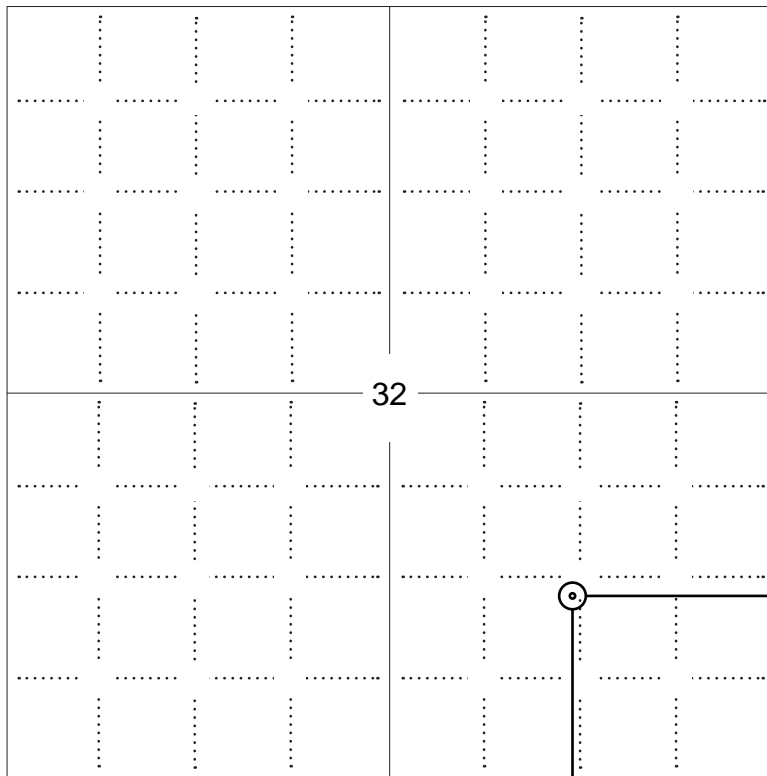

NOTE: In all cases locate the spot of the proposed drilling locaton.

1250 ft.

In plotting the proposed location of the well, you must show:

1. The manner in which you are using the depicted plat by identifying section lines, i.e. 1 section, 1 section with 8 surrounding sections, 4 sections, etc.
2. The distance of the proposed drilling location from the south / north and east / west outside section lines.
3. The distance to the nearest lease or unit boundary line (in footage).
4. If proposed location is located within a prorated or spaced field a certificate of acreage attribution plat must be attached: (C0-7 for oil wells; CG-8 for gas wells).



KANSAS CORPORATION COMMISSION 1033738
OIL & GAS CONSERVATION DIVISION

Form CDP-1
April 2004
Form must be Typed

APPLICATION FOR SURFACE PIT

Submit in Duplicate

Operator Name: _____		License Number: _____	
Operator Address: _____			
Contact Person: _____		Phone Number: _____	
Lease Name & Well No.: _____		Pit Location (QQQQ): _____ - _____ - _____ - _____	
Type of Pit: <input type="checkbox"/> Emergency Pit <input type="checkbox"/> Burn Pit <input type="checkbox"/> Settling Pit <input type="checkbox"/> Drilling Pit <input type="checkbox"/> Workover Pit <input type="checkbox"/> Haul-Off Pit <i>(If WP Supply API No. or Year Drilled)</i>		Pit is: <input type="checkbox"/> Proposed <input type="checkbox"/> Existing If Existing, date constructed: _____ Pit capacity: _____ (bbls)	
Is the pit located in a Sensitive Ground Water Area? <input type="checkbox"/> Yes <input type="checkbox"/> No		Chloride concentration: _____ mg/l <i>(For Emergency Pits and Settling Pits only)</i>	
Is the bottom below ground level? <input type="checkbox"/> Yes <input type="checkbox"/> No		Artificial Liner? <input type="checkbox"/> Yes <input type="checkbox"/> No	
How is the pit lined if a plastic liner is not used?		_____	
Pit dimensions (all but working pits): _____ Length (feet) _____ Width (feet) _____ N/A: Steel Pits Depth from ground level to deepest point: _____ (feet) _____ No Pit			
If the pit is lined give a brief description of the liner material, thickness and installation procedure.		Describe procedures for periodic maintenance and determining liner integrity, including any special monitoring.	
Distance to nearest water well within one-mile of pit _____ feet Depth of water well _____ feet		Depth to shallowest fresh water _____ feet. Source of information: _____ measured _____ well owner _____ electric log _____ KDWR	
Emergency, Settling and Burn Pits ONLY: Producing Formation: _____ Number of producing wells on lease: _____ Barrels of fluid produced daily: _____ Does the slope from the tank battery allow all spilled fluids to flow into the pit? <input type="checkbox"/> Yes <input type="checkbox"/> No		Drilling, Workover and Haul-Off Pits ONLY: Type of material utilized in drilling/workover: _____ Number of working pits to be utilized: _____ Abandonment procedure: _____ _____ Drill pits must be closed within 365 days of spud date.	
Submitted Electronically			

KCC OFFICE USE ONLY	Steel Pit	RFAC	RFAS
Date Received: _____ Permit Number: _____ Permit Date: _____ Lease Inspection: <input type="checkbox"/> Yes <input type="checkbox"/> No			

T31S-R38W

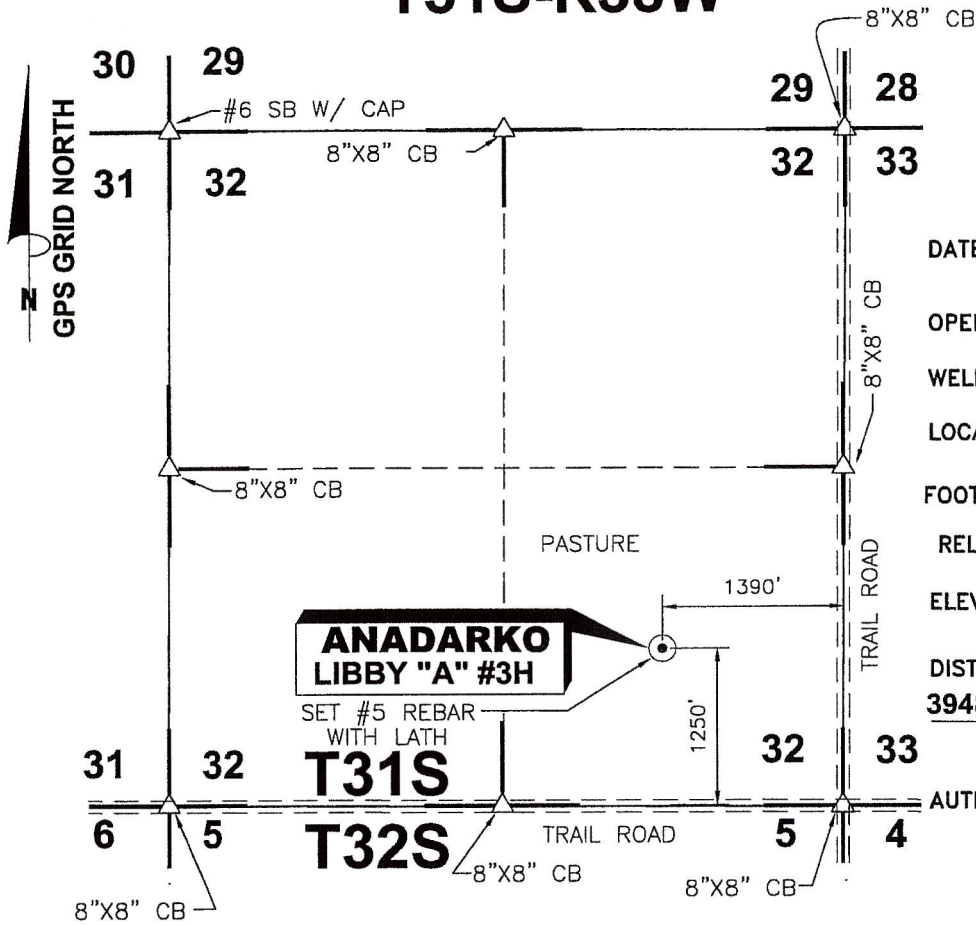

DATE 11/10/09

OPERATOR ANADARKO

WELL NAME LIBBY "A" #3H

LOCATION SE/4 SEC.32, T31S-R38W

FOOTAGES & 1250' F S L

RELATIONS 1390' F E L

ELEVATION 3165.56'

DISTANCE TO EXISTING WELL
3948.66' Δ CAVNER "A" #4 Δ
NW/4 SEC 33 T31S-R38W Δ

AUTHORIZED BY D. SMITH

SE/4 SEC.32, T31S - R38W STEVENS COUNTY, KANSAS

CROP PASTURE

WATER WELL _____

NEAREST TOWER _____

AIRPORT _____

LATITUDE 37°18'15.74125" N

LONGITUDE 101°28'12.98886" W

STATE PLANE COORD.
 KANSAS SOUTH ZONE
 NAD 27

X= 1136184.28

Y= 245959.72

DRIVING DIRECTIONS USED TO STAKE
 WELL FROM KNOWN LANDMARK OR CITY
 FROM:
FROM INTERSECTION FAS 480 &
HWY 25, 9 MILES NORTH OF HUGOTON,
KS. THENCE WEST 6 MILES. THENCE
SOUTH 1 MILE. THENCE NORTH 1250
FT. THENCE WEST 1390 FT INTO.

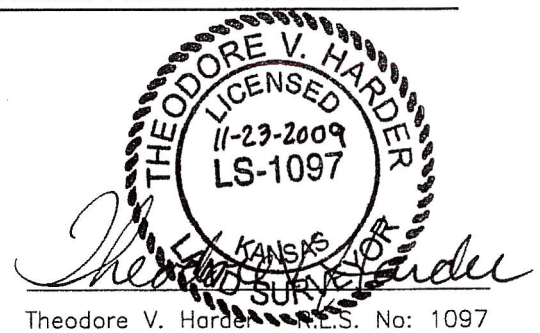

NOTE: CONTRACTOR TO CONTACT ONE CALL @ 1-800-DIG SAFE
 PRIOR TO ANY EXCAVATION OR CONSTRUCTION.

<p>1106 SHERMAN AVE. PETROLEUM CORPORATION ELKHART, KANSAS 67950</p>	NO. DWN.	REVISIONS	DATE	<p>AND ASSOCIATES "locating our world" LAND SURVEYING - GPS SPECIALISTS P.O. BOX 518 514 MORTON Elkhart, Kansas 67950 Phone: (620) 697-2696 Fax: (620) 697-4175 E-MAIL: tharder@elkhart.com</p>
	Δ SSA	CHANGED EXISTING WELL NAME & DISTANCE	11/20/09	
<p>WELL LOCATION OF THE LIBBY "A" #3H LOCATED IN THE SE/4 SEC.32, T31S-R38W, STEVENS COUNTY, KANSAS</p>	SCALE:	1"=1500'	DATE:	11/09/09
DRAWN BY: SSA	CHECKED BY: TVH	APPROVED BY:	AUTHORIZED BY: D. SMITH	WORK ORDER NO.:

PLAT AND CERTIFICATION OF ACREAGE ATTRIBUTABLE TO A GAS WELL

Kansas Corporation Commission, Conservation Division
 Finney State Office Building, 130 South Market, Room 2078
 Wichita, Kansas 67202

API NUMBER 15- _____
 OPERATOR Anadarko Petroleum Corporation
 LEASE Libby A
 WELL NUMBER 3H
 FIELD Hugoton

LOCATION OF WELL: COUNTY Stevens
1250 feet from south/~~north~~ line of section
1390 feet from east / ~~west~~ line of section

NUMBER OF ACRES ATTRIBUTABLE TO WELL 640
 QTR/QTR/QTR OF ACREAGE NE - SW - SE

SECTION 32 TWP 31 (S) RG 38 ~~XX~~W
 IS SECTION X REGULAR or _____ IRREGULAR
 IF SECTION IS IRREGULAR, LOCATE WELL FROM
 NEAREST CORNER BOUNDARY. (check line below)
 Section corner used: NE NW SE SW

(Show the location of the well and shade attributable acreage for prorated or spaced wells).
 (Show the footage to the nearest lease or unit boundary line; and show footage to the nearest common source supply well).

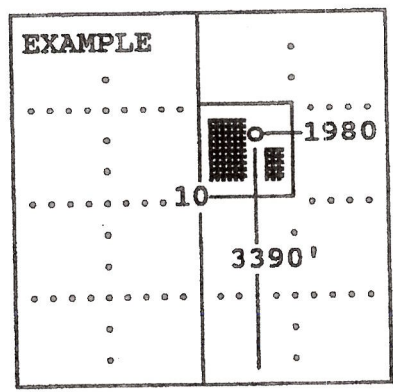
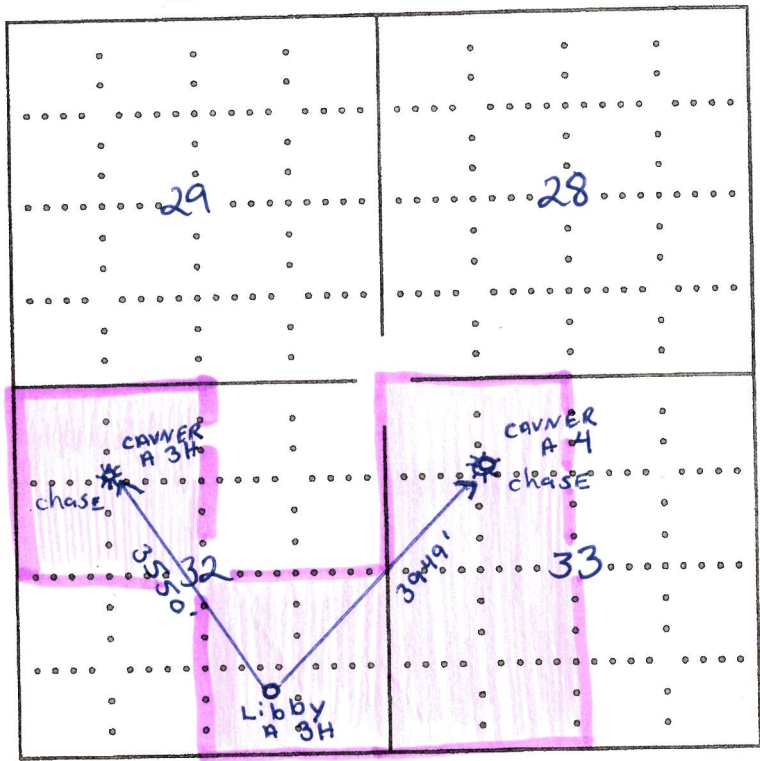

SEWARD CO.

The undersigned hereby certifies as Staff Regulatory Analyst (title) for

Anadarko Petroleum Corporation (Co.), a duly authorized agent, that all information shown hereon is true and correct to the best of my knowledge and belief, that all acreage claimed attributable to the well named herein is held by production from that well and hereby make application for an allowable to be assigned to the well upon the filing of this form and the State test, whichever is later.

Signature *Deana Smart*

Subscribed and sworn to before me on this 14th day of December, 19 2009
Bertha Neefe
 Notary Public



12-27-09

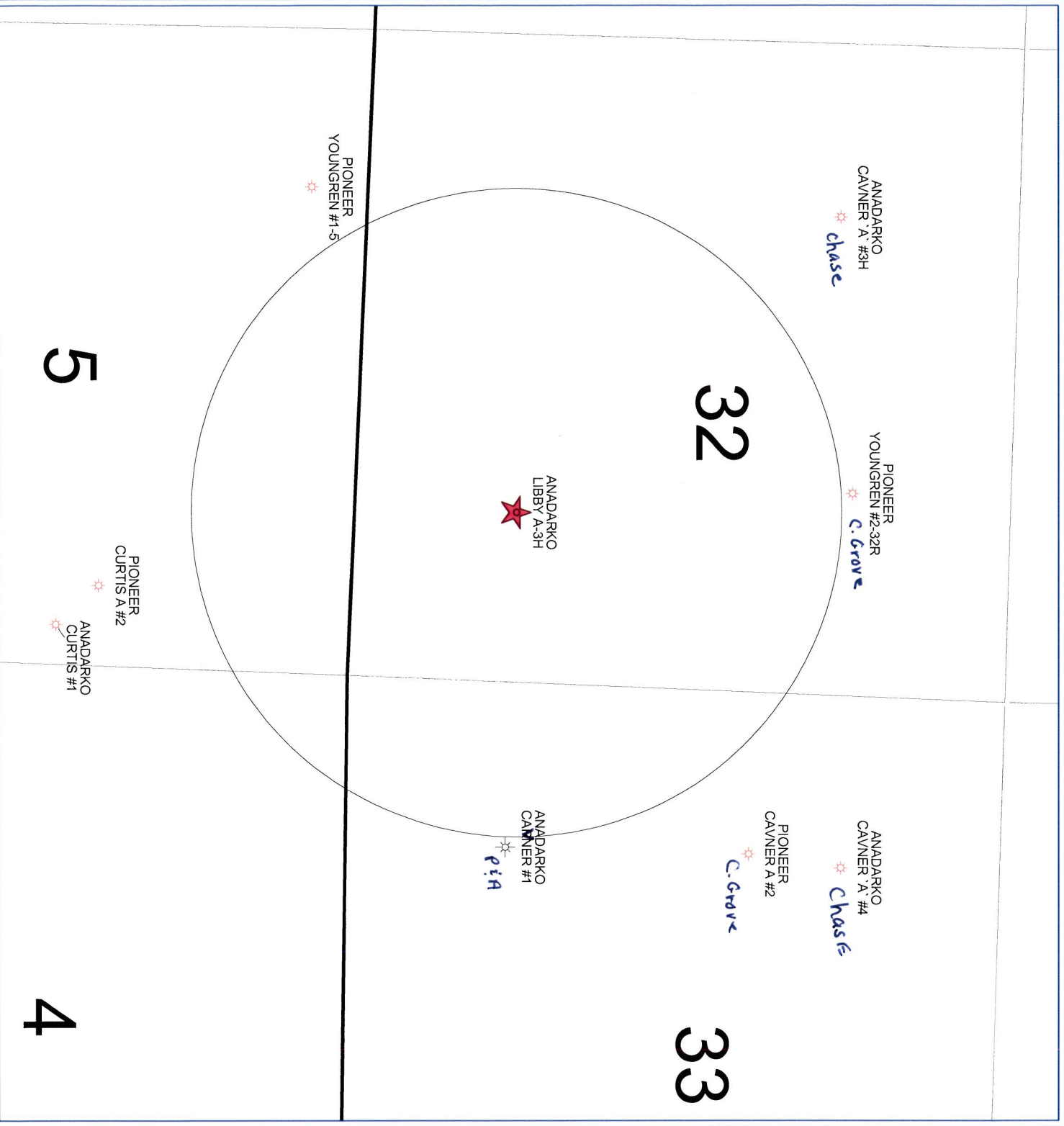





Anadarko
Petroleum Corporation

LIBBY A-3H
32-31S-38W
Stevens County, Kansas

POSTED WELL DATA

Operator
Well Label

WELL SYMBOLS

-  LOCATION
-  Gas Well
-  ABANDONED GAS WELL

FEET

0 1,081 2,162

December 9, 2009



*Mark Parkinson, Governor
Thomas E. Wright, Chairman
Michael C. Moffet, Commissioner
Joseph F. Harkins, Commissioner*

December 14, 2009

Diana Smart
Anadarko Petroleum Corporation
PO Box 1330
HOUSTON, TX 77251-1330

Re: Drilling Pit Application
Libby A 3H
SE/4 Sec.32-31S-38W
Stevens County, Kansas

Dear Diana Smart:

District staff has inspected the above referenced location and has determined that the reserve pit shall be constructed **without slots**, the bottom shall be flat and reasonably level, and the free fluids must be removed. The fluids are to be removed from the reserve pit within 96 hours of completion of drilling operations. KEEP pits away from draw/drainage.

If production casing is set all completion fluids shall be removed from the working pits daily. NO completion fluids or non-exempt wastes shall be placed in the reserve pit.

The fluids should be taken to an authorized disposal well. Please call the District Office at (620) 225-8888 when the fluids have been removed. Please file form CDP-5 (August 2008), Exploration and Production Waste Transfer, through SOLAR within 30 days of fluid removal.

A copy of this letter should be posted in the doghouse along with the approved Intent to Drill. If you have any questions or concerns please feel free to contact the District Office at (620) 225-8888.

CONSERVATION DIVISION

Finney State Office Building, 130 S. Market, Room 2078, Wichita, KS 67202-3802
(316) 337-6200 • Fax: (316) 337-6211 • <http://kcc.ks.gov/>