

FLATIRONS RESOURCES, LLC.
SCHADEL LEASE
SE. 1/4, SECTION 16, T16S, R30W
LANE COUNTY, KANSAS

NO ROAD

Notes:

1. Set iron rod at location sites.
2. All flagging Red & Yellow.
3. Overhead power available at W. line, Sec. 16.
4. Kansas One Call System Inc. should be notified before excavation (1-800-344-7233).
5. CAUTION: Various pipelines in Sec. 16.
6. Cattle in area at date of staking.
7. Contact landowner for best access.
8. Location fell on the slope of a draw, set alternate 30' south and 40' west.

*Ingress and egress to location as shown on this plat is per usage only and may not be legally opened for public use. Contact landowner, tenant and county road department for access.

DIRT ROAD (BISON II RD.)

ROAD

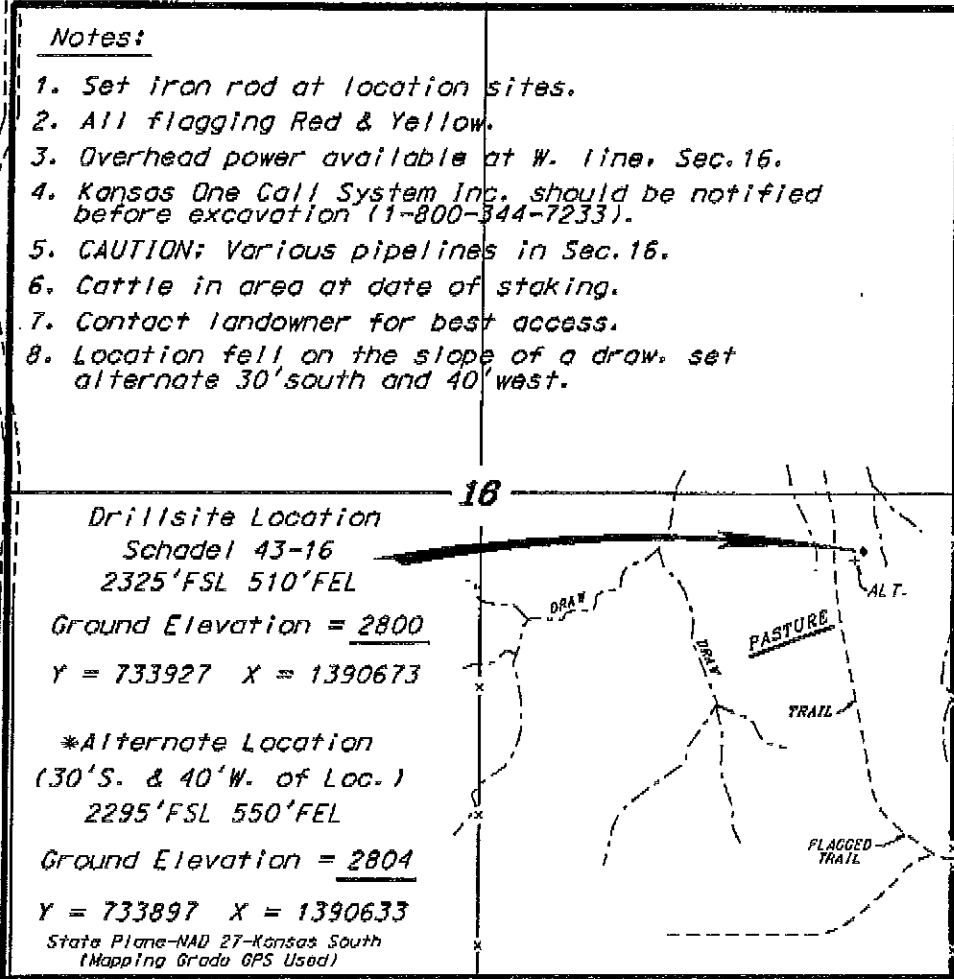
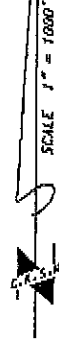

16
Drillsite Location
Schadel 43-16
2325'FSL 510'FEL
Ground Elevation = 2800
Y = 733927 X = 1390673

***Alternate Location**
(30'S. & 40'W. of Loc.)
2295'FSL 550'FEL
Ground Elevation = 2804
Y = 733897 X = 1390633

State Plane-NAD 27-Kansas South
 (Mapping Grade GPS Used)

NO ROAD

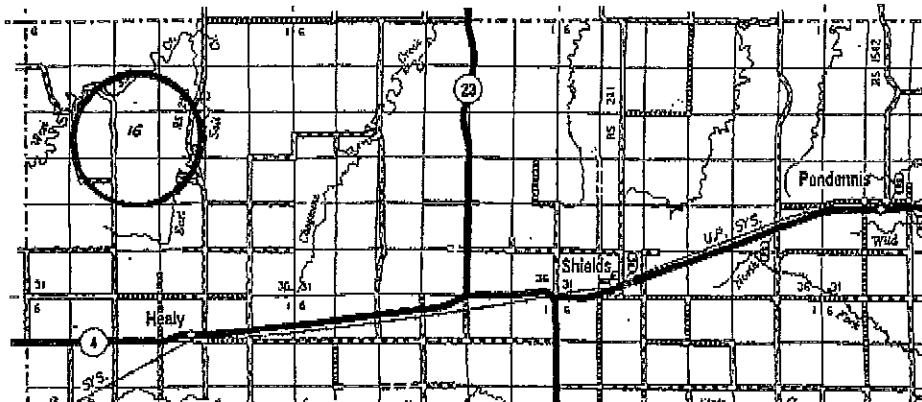

Centralizing data is based upon the best ADS and photographs available to us and upon a regular section of land containing 640 acres.
 Approximate section lines were determined using the normal standard of care of oilfield surveyors practicing in the state of Kansas. The section corners, which establish the precise section lines, are not necessarily located, and the exact location of the drillsite location in the section is not guaranteed, therefore, the operator assuming this service and accepting this site and all other parties relying thereon agree to hold Central Kansas Oilfield Services, Inc., its officers and employees harmless from all losses, costs and expenses and said entities released from any liability from incidental or consequential damages.
 Elevations derived from National Geodetic Vertical Datum.

Date **December 1, 2009**