



# PLAT AND CERTIFICATION OF ACREAGE ATTRIBUTABLE TO A GAS WELL

Kansas Corporation Commission, Conservation Division

Finney State Office Building, 130 South Market, Room 2078 Wichita, Kansas 67202

API NUMBER 15-  
OPERATOR: Anadarko Petroleum Corporation  
LEASE: Kirk A  
WELL NUMBER: 3H  
FIELD: Hugoton  
NUMBER OF ACRES ATTRIBUTABLE TO WELL: 640  
QTR/QTR/QTR: NE - SW - SW

(Show the location for the well and shade attributable acreage for prorated or spaced wells). (Show the footage to the nearest lease or unit boundary line; and show footage to the nearest common source supply well).

LOCATION OF WELL: COUNTY: Stevens  
1250 feet from X South North line of section  
1250 feet from East X West line of section  
SECTION 19 TWP 32(S) RNG 38W  
IS SECTION X REGULAR or IRREGULAR  
IF SECTION IS IRREGULAR, LOCATE WELL FROM  
NEAREST CORNER BOUNDARY (check line below)  
Section corner used: NE NW SE X SW

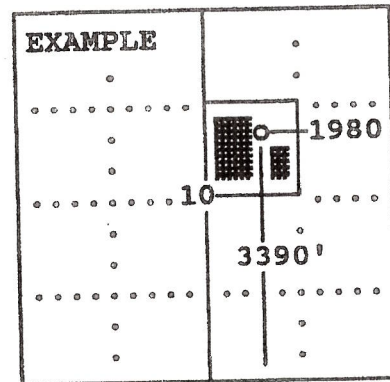
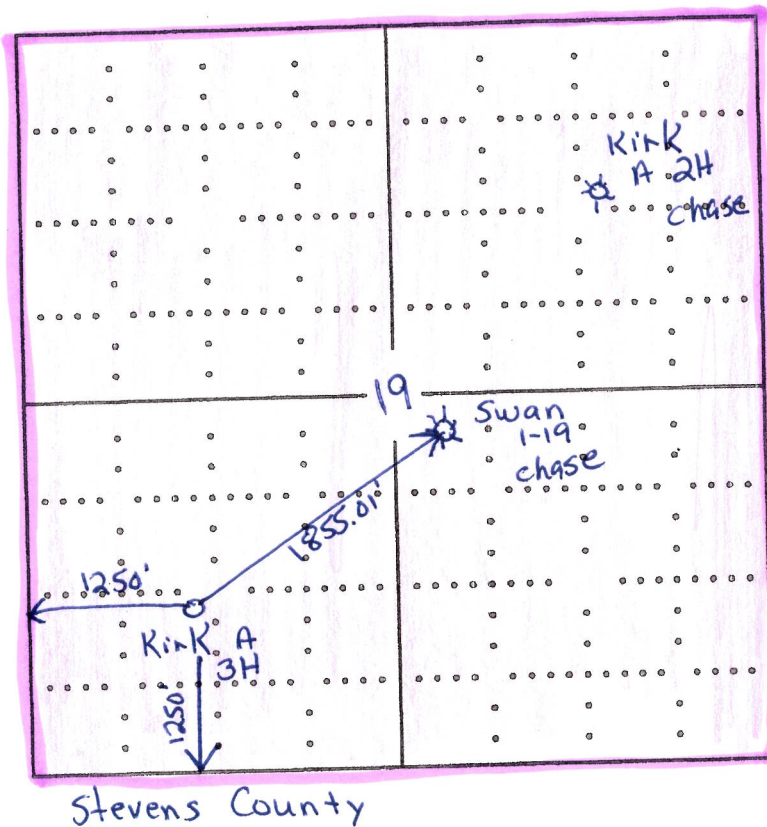

SEWARD CO.

The undersigned hereby certifies as Staff Regulatory Analyst (title) for Anadarko Petroleum Corporation (Co.), a duly authorized agent, that all information shown hereon is true and correct to the best of my knowledge and belief, that all acreage claimed attributable to the well named herein is held by production from that well and hereby make application for an allowable to be assigned to the well upon the filing of this form and the State test, whichever is later.

Signature Deana Smart

Subscribed and sworn before me this 23rd day of December, 2009

Bertha Nefe  
Notary Public

My Commission expires 12-27-09

FORM CG-8 (12/94)

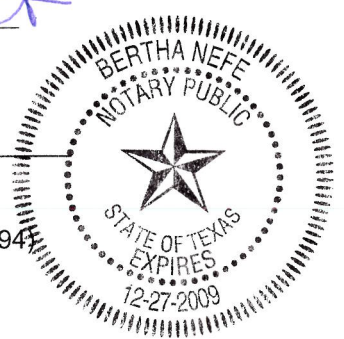

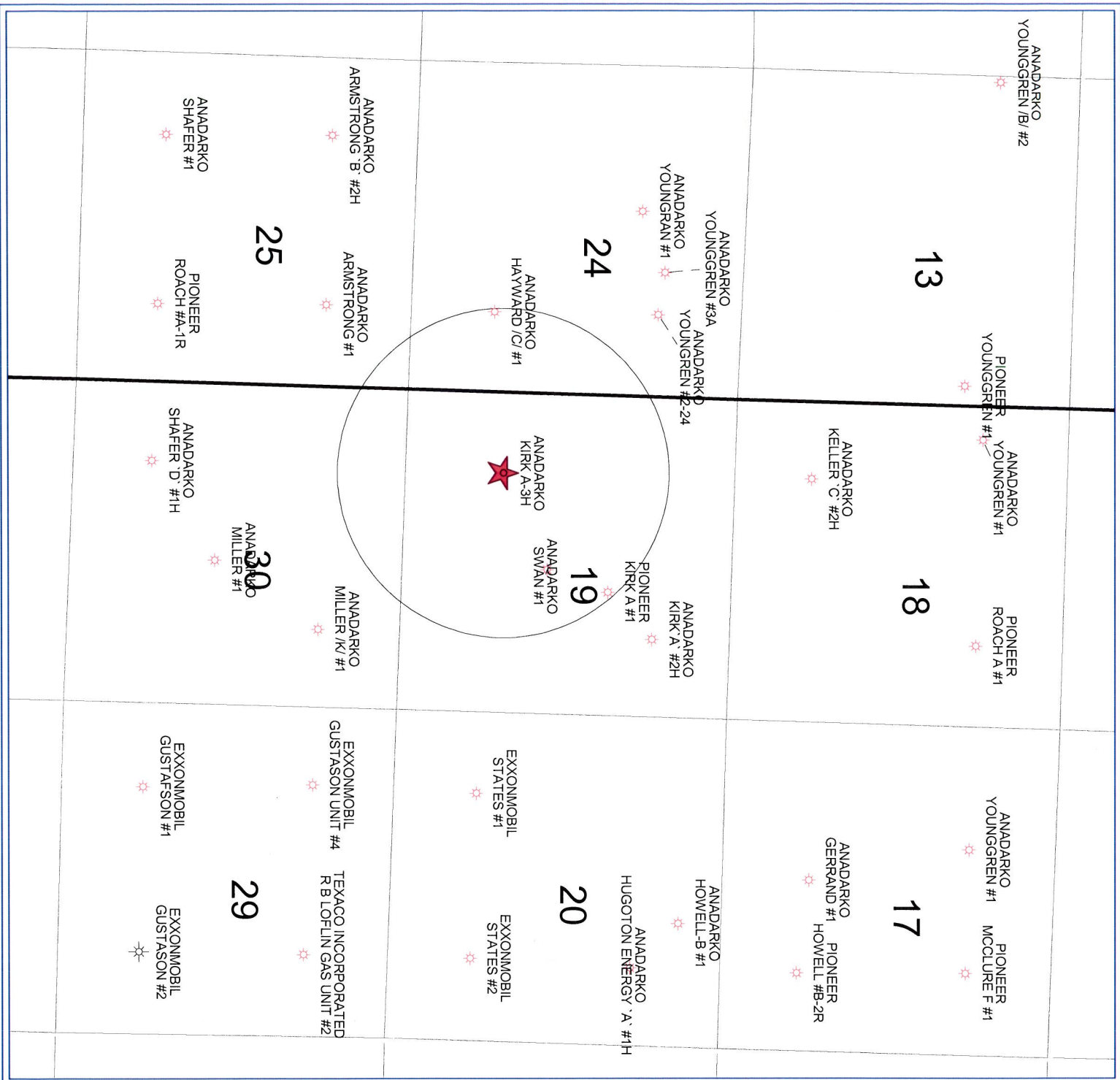

**Anadarko**  
Petroleum Corporation

**KIRK A-3H**  
19-32S-38W

Stevens County, Kansas

POSTED WELL DATA  
Operator  
Well Label

WELL SYMBOLS  
○ LOCATION  
\* Gas Well  
\* ABANDONED GAS WELL

0 2,159 4,318  
FEET

December 10, 2009