



1034813

IN ALL CASES PLOT THE INTENDED WELL ON THE PLAT BELOW

Plat of acreage attributable to a well in a prorated or spaced field

If the intended well is in a prorated or spaced field, please fully complete this side of the form. If the intended well is in a prorated or spaced field complete the plat below showing that the well will be properly located in relationship to other wells producing from the common source of supply. Please show all the wells and within 1 mile of the boundaries of the proposed acreage attribution unit for gas wells and within 1/2 mile of the boundaries of the proposed acreage attribution unit for oil wells.

API No. 15 - _____

Operator: _____

Lease: _____

Well Number: _____

Field: _____

Number of Acres attributable to well: _____

QTR/QTR/QTR/QTR of acreage: _____ - _____ - _____ - _____

Location of Well: County: _____

_____ feet from N / S Line of Section

_____ feet from E / W Line of Section

Sec. _____ Twp. _____ S. R. _____ E W

Is Section: Regular or Irregular

If Section is Irregular, locate well from nearest corner boundary.

Section corner used: NE NW SE SW

PLAT

(Show location of the well and shade attributable acreage for prorated or spaced wells.)

(Show footage to the nearest lease or unit boundary line.)

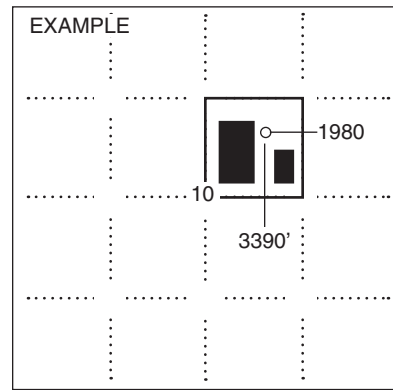
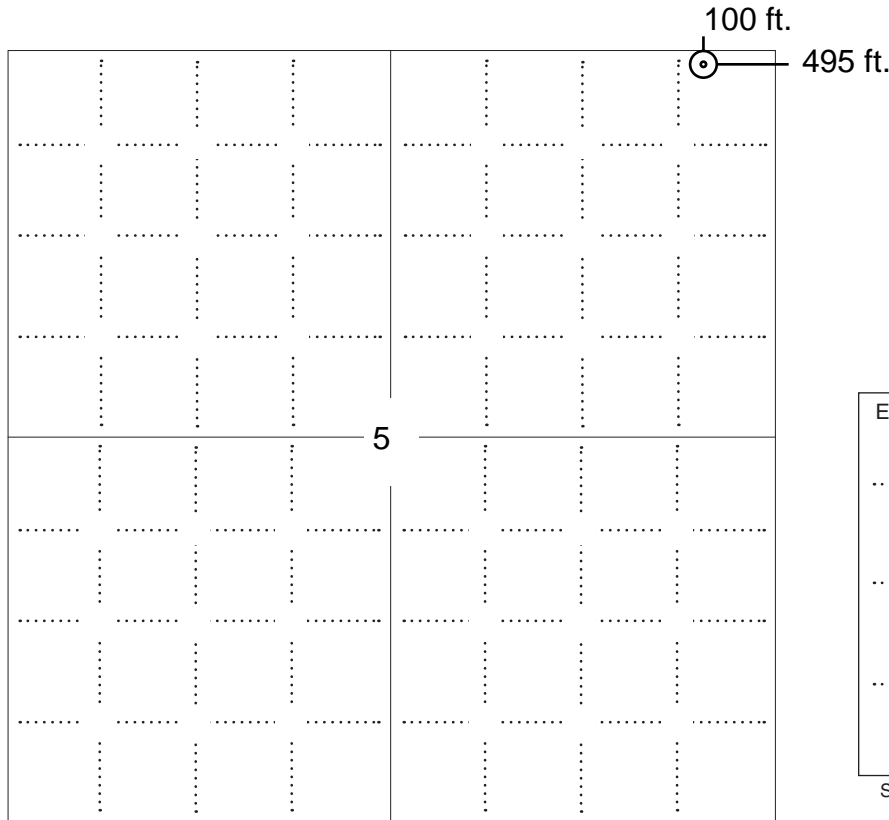

NOTE: In all cases locate the spot of the proposed drilling locaton.

In plotting the proposed location of the well, you must show:

1. The manner in which you are using the depicted plat by identifying section lines, i.e. 1 section, 1 section with 8 surrounding sections, 4 sections, etc.
2. The distance of the proposed drilling location from the south / north and east / west outside section lines.
3. The distance to the nearest lease or unit boundary line (in footage).
4. If proposed location is located within a prorated or spaced field a certificate of acreage attribution plat must be attached: (C0-7 for oil wells; CG-8 for gas wells).



KANSAS CORPORATION COMMISSION 1034813
OIL & GAS CONSERVATION DIVISION

Form CDP-1
April 2004
Form must be Typed

APPLICATION FOR SURFACE PIT

Submit in Duplicate

Operator Name: _____		License Number: _____	
Operator Address: _____			
Contact Person: _____		Phone Number: _____	
Lease Name & Well No.: _____		Pit Location (QQQQ): _____ - _____ - _____ - _____	
Type of Pit: <input type="checkbox"/> Emergency Pit <input type="checkbox"/> Burn Pit <input type="checkbox"/> Settling Pit <input type="checkbox"/> Drilling Pit <input type="checkbox"/> Workover Pit <input type="checkbox"/> Haul-Off Pit <i>(If WP Supply API No. or Year Drilled)</i>		Pit is: <input type="checkbox"/> Proposed <input type="checkbox"/> Existing If Existing, date constructed: _____ Pit capacity: _____ (bbls)	
Is the pit located in a Sensitive Ground Water Area? <input type="checkbox"/> Yes <input type="checkbox"/> No		Chloride concentration: _____ mg/l <i>(For Emergency Pits and Settling Pits only)</i>	
Is the bottom below ground level? <input type="checkbox"/> Yes <input type="checkbox"/> No		Artificial Liner? <input type="checkbox"/> Yes <input type="checkbox"/> No	
How is the pit lined if a plastic liner is not used?			
Pit dimensions (all but working pits): _____ Length (feet) _____ Width (feet) _____ N/A: Steel Pits Depth from ground level to deepest point: _____ (feet) _____ No Pit			
If the pit is lined give a brief description of the liner material, thickness and installation procedure.		Describe procedures for periodic maintenance and determining liner integrity, including any special monitoring.	
Distance to nearest water well within one-mile of pit _____ feet Depth of water well _____ feet		Depth to shallowest fresh water _____ feet. Source of information: _____ measured _____ well owner _____ electric log _____ KDWR	
Emergency, Settling and Burn Pits ONLY: Producing Formation: _____ Number of producing wells on lease: _____ Barrels of fluid produced daily: _____ Does the slope from the tank battery allow all spilled fluids to flow into the pit? <input type="checkbox"/> Yes <input type="checkbox"/> No		Drilling, Workover and Haul-Off Pits ONLY: Type of material utilized in drilling/workover: _____ Number of working pits to be utilized: _____ Abandonment procedure: _____ _____ Drill pits must be closed within 365 days of spud date.	
Submitted Electronically			

KCC OFFICE USE ONLY		Steel Pit	RFAC	RFAS
Date Received: _____	Permit Number: _____	Permit Date: _____	Lease Inspection: <input type="checkbox"/> Yes <input type="checkbox"/> No	

ADVANTAGE ELEVATIONS

OIL FIELD SURVEYORS

BOX 8604 - PRATT, KS 67124
(620) 672-6491

114105
INVOICE NO.

VAL ENERGY INC

OPERATOR

4-5

NO.

Goldman/Melcher

FARM

Barber

COUNTY

5

S

35s

T

11w

R

100' FNL & 495' FEL

LOCATION

ELEVATION: 1383' gr



VAL ENERGY INC
200 W Douglas, Ste 520
Wichita KS 67202-3005

AUTHORIZED BY: Todd

SCALE: 1" = 1000'

Set 5' & 3' wood stakes.
Moderate slope wheat field.

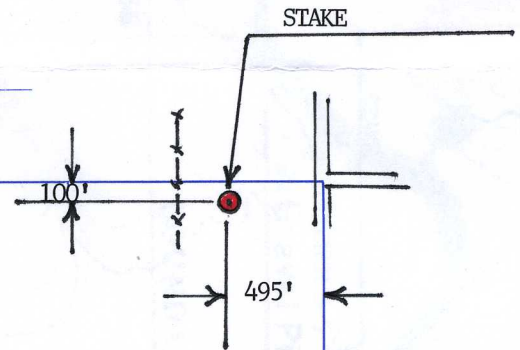

5

Staked 01/14/2010

ASSIGNMENT OF OIL & GAS LEASE

11/3/08
to extend
1/1-6-10



State of Kansas, Barber Co., SS
This Instrument was filed for record on
the 15 day of November
2007 at 3:48 o'clock A. M., and
duly recorded in book 317 on page 186
Betty J. Swayden
Register of Deeds
Fees \$8.00

State of Kansas)
)
County of Barber) ss.

KNOW ALL MEN BY THESE PRESENTS:

THAT, the undersigned, LOTUS OPERATING COMPANY, L.L.C. hereinafter referred to as "ASSIGNOR" for and in consideration of Ten Dollars (\$10.00) and other good and valuable consideration, the receipt of which is hereby acknowledged, does hereby sell, assign, transfer and set over unto VAL ENERGY, INC, hereinafter referred to as "ASSIGNEE" their heirs and assigns, the undivided working interest as set out below, together with a like interest in all of the personal property and equipment located on said lease and used or obtained in connection therewith.

Lease Date: January 6th, 2006
Lessor(s): Marilyn Blond Melcher, Trustee of the Marilyn Blond Melcher Revocable Trust, dated January 4, 1991; Stanley L. Goldman and Carolyn R. Goldman, Trustees for the benefit Of Stanley L. Goldman and Carolyn R. Goldman under agreement dated August 20, 1991
Lessee: Lotus Operating Company, L.L.C.
Term: Three (3) years
Recording Data: Book 309, Page 360 & 364
Acreage Description: SE/4 Sec. 32, T34S, R11W; and Lot 1 in Sec. 5, T35S, R11W Barber County, Kansas

<u>Name</u>	<u>Percentage Assigned</u>
Lotus Operation Company, L.L.C.	100% of the working interest

This assignment of working interest is made subject to all of the express and implied covenants and conditions of the herein described leases, which terms, covenants and conditions Assignee hereby assumes and agrees to perform with respect to the interest hereby assigned in the said leases. These assignments are made without warranty of title either express or implied.

EXECUTED this 13 day of November, 2007

LOTUS OPERATION COMPANY, L.L.C.

Timothy D. Hellman, Managing Member

ACKNOWLEDGMENT

State of Kansas)
)
County of Sedgwick) ss.

Before me, the undersigned, a Notary Public, within and for said County and State, on this 13 day of November, 2007 personally appeared Timothy D. Hellman, Managing Member of Lotus Operating Company, L.L.C. to me personally known to be the identical person who executed the within and foregoing instrument and acknowledged to me that he executed the same as his free and voluntary act and deed on behalf of the company.

IN WITNESS WHEREOF I have hereunto set my hand and official seal the day and year last above written.

My appointment expires:

63U (Rev. 1993)

OIL AND GAS LEASE

Reorder No. 09-115



Kansas Blue Print 700 S. Broadway PO Box 793 Wichita, KS 67201-0793 316-264-9344 • 264-5165 fax www.kbp.com • kbp@kbp.com

AGREEMENT, Made and entered into the 6th day of January 2006

by and between Stanley L. Goldman and Carolyn R. Goldman, Trustees for the benefit of Stanley L. Goldman and Carolyn R. Goldman under agreement dated August 20, 1991

whose mailing address is 5734 Windsor Dr., Fairway, KS 66205 hereinafter called Lessor (whether one or more), and Lotus Operating Co., 100 S. Main St. Ste. 420, Wichita, KS 67202 hereinafter called Lessee:

Lessor, in consideration of Ten and more Dollars (\$ 10.00 & more) in hand paid, receipt of which is here acknowledged and of the royalties herein provided and of the agreements of the lessee herein contained, hereby grants, leases and lets exclusively unto lessee for the purpose of investigating, exploring by geophysical and other means, prospecting drilling, mining and operating for and producing oil, liquid hydrocarbons, all gases, and their respective constituent products, injecting gas, water, other fluids, and air into subsurface strata, laying pipe lines, storing oil, building tanks, power stations, telephone lines, and other structures and things thereon to produce, save, take care of, treat, manufacture, process, store and transport said oil, liquid hydrocarbons, gases and their respective constituent products and other products manufactured therefrom, and housing and otherwise caring for its employees, the following described land, together with any reversionary rights and after-acquired interest, therein situated in County of Barber State of Kansas described as follows to-wit:

Township 34 South, Range 11 West Section: 32: SE/4

Township 35 South, Range 11 West Section 5: Lot 1 (32.86 acres)

In Section XXXXXXXXX Township XXXXXXXXX Range XXXXXXXXX and containing 192.86 acres, more or less, and all accretions thereto.

Subject to the provisions herein contained, this lease shall remain in force for a term of Three (3) years from this date (called "primary term"), and as long thereafter as oil, liquid hydrocarbons, gas or other respective constituent products, or any of them, is produced from said land or land with which said land is pooled.

In consideration of the premises the said lessee covenants and agrees:

1st. To deliver to the credit of lessor, free of cost, in the pipe line to which lessee may connect wells on said land, the equal one-eighth (1/8) part of all oil produced and saved from the leased premises.

2nd. To pay lessor for gas of whatsoever nature or kind produced and sold, or used off the premises, or used in the manufacture of any products therefrom, one-eighth (1/8) at the market price at the well, (but, as to gas sold by lessee, in no event more than one-eighth (1/8) of the proceeds received by lessee from such sales), for the gas sold, used off the premises, or in the manufacture of products therefrom, said payments to be made monthly. Where gas from a well producing gas only is not sold or used, lessee may pay or tender as royalty One Dollar (\$1.00) per year per net mineral acre retained hereunder, and if such payment or tender is made it will be considered that gas is being produced within the meaning of the preceding paragraph.

This lease may be maintained during the primary term hereof without further payment or drilling operations. If the lessee shall commence to drill a well within the term of this lease or any extension thereof, the lessee shall have the right to drill such well to completion with reasonable diligence and dispatch, and if oil or gas, or either of them, be found in paying quantities, this lease shall continue and be in force with like effect as if such well had been completed within the term of years first mentioned.

If said lessor owns a less interest in the above described land than the entire and undivided fee simple estate therein, then the royalties herein provided for shall be paid the said lessor only in the proportion which lessor's interest bears to the whole and undivided fee.

Lessee shall have the right to use, free of cost, gas, oil and water produced on said land for lessee's operation thereon, except water from the wells of lessor.

When requested by lessor, lessee shall bury lessee's pipe lines below plow depth.

No well shall be drilled nearer than 200 feet to the house or barn now on said premises without written consent of lessor.

Lessee shall pay for damages caused by lessee's operations to growing crops on said land.

Lessee shall have the right at any time to remove all machinery and fixtures placed on said premises, including the right to draw and remove casing.

If the estate of either party hereto is assigned, and the privilege of assigning in whole or in part is expressly allowed, the covenants hereof shall extend to their heirs, executors, administrators, successors or assigns, but no change in the ownership of the land or assignment of rentals or royalties shall be binding on the lessee until after the lessee has been furnished with a written transfer or assignment or a true copy thereof. In case lessee assigns this lease, in whole or in part, lessee shall be relieved of all obligations with respect to the assigned portion or portions arising subsequent to the date of assignment.

Lessee may at any time execute and deliver to lessor or place of record a release or releases covering any portion or portions of the above described premises and thereby surrender this lease as to such portion or portions and be relieved of all obligations as to the acreage surrendered.

All express or implied covenants of this lease shall be subject to all Federal and State Laws, Executive Orders, Rules or Regulations, and this lease shall not be terminated, in whole or in part, nor lessee held liable in damages, for failure to comply therewith, if compliance is prevented by, or if such failure is the result of, any such Law, Order, Rule or Regulation.

Lessor hereby warrants and agrees to defend the title to the lands herein described, and agrees that the lessee shall have the right at any time to redeem for lessor, by payment any mortgages, taxes or other liens on the above described lands, in the event of default of payment by lessor, and be subrogated to the rights of the holder thereof, and the undersigned lessors, for themselves and their heirs, successors and assigns, hereby surrender and release all right of dower and homestead in the premises described herein, in so far as said right of dower and homestead may in any way affect the purposes for which this lease is made, as recited herein.

Lessee, at its option, is hereby given the right and power to pool or combine the acreage covered by this lease or any portion thereof with other land, lease or leases in the immediate vicinity thereof, when in lessee's judgment it is necessary or advisable to do so in order to properly develop and operate said lease premises so as to promote the conservation of oil, gas or other minerals in and under and that may be produced from said premises, such pooling to be of tracts contiguous to one another and to be into a unit or units not exceeding 40 acres each in the event of an oil well, or into a unit or units not exceeding 640 acres each in the event of a gas well. Lessee shall execute in writing and record in the conveyance records of the county in which the land herein leased is situated an instrument identifying and describing the pooled acreage. The entire acreage so pooled into a tract or unit shall be treated, for all purposes except the payment of royalties on production from the pooled unit, as if it were included in this lease. If production is found on the pooled acreage, it shall be treated as if production is had from this lease, whether the well or wells be located on the premises covered by this lease or not. In lieu of the royalties elsewhere herein specified, lessor shall receive on production from a unit so pooled only such portion of the royalty stipulated herein as the amount of his acreage placed in the unit or his royalty interest therein on an acreage basis bears to the total acreage so pooled in the particular unit involved.

Lessee, or its assigns, will consult with Lessor regarding routes of ingress and egress prior to commencing operations.

Lessee, or its assigns, will restore surface to original condition as nearly as is practicable upon completion of operations, including backfilling all pits when dried and restoring terraces disturbed by operations.

In the event some or all of the lands covered by this lease are enrolled in the Conservation Reserve Program (CRP) of the U.S. Department of Agriculture, Lessee shall comply with the rules and notification procedures of that program insofar as the same may apply to operations of Lessee on the enrolled lands, Lessee shall compensate Lessor for CRP penalties or CRP withdrawal reimbursements resulting directly from Lessee's operations hereunder.

IN WITNESS WHEREOF, the undersigned execute this instrument as of the day and year first above written.

Witnesses: Stanley L. Goldman + Carolyn R. Goldman



*Mark Parkinson, Governor
Thomas E. Wright, Chairman
Joseph F. Harkins, Commissioner*

February 18, 2010

K. TODD ALLAM
Val Energy, Inc.
200 W DOUGLAS AVE STE 520
WICHITA, KS 67202-3005

Re: Drilling Pit Application
GOLDMAN MELCHER 4-5
NE/4 Sec.05-35S-11W
Barber County, Kansas

Dear K. TODD ALLAM:

District staff has inspected the above referenced location and has determined that the reserve pit shall be constructed **without slots**, the bottom shall be flat and reasonably level and the free fluids must be removed. The fluids are to be removed from the reserve pit as soon as the Hutchinson Salt section has been drilled through and displacement of the fluids into the reserve pit has occurred. The fluids should be removed again within 96 hours after drilling operations have ceased. Keep pits away from draw/drainage.

If production casing is set all completion fluids shall be removed from the working pits daily. NO completion fluids or non-exempt wastes shall be placed in the reserve pit.

The fluids should be taken to an authorized disposal well. Please call the District Office at (620) 225-8888 when the fluids have been removed. Please file form CDP-5 (August 2008), Exploration and Production Waste Transfer, through SOLAR within 30 days of fluid removal.

A copy of this letter should be posted in the doghouse along with the approved Intent to Drill. If you have any questions or concerns please feel free to contact the District Office at (620) 225-8888.

CONSERVATION DIVISION

Finney State Office Building, 130 S. Market, Room 2078, Wichita, KS 67202-3802
(316) 337-6200 • Fax: (316) 337-6211 • <http://kcc.ks.gov/>