

T29S-R41W

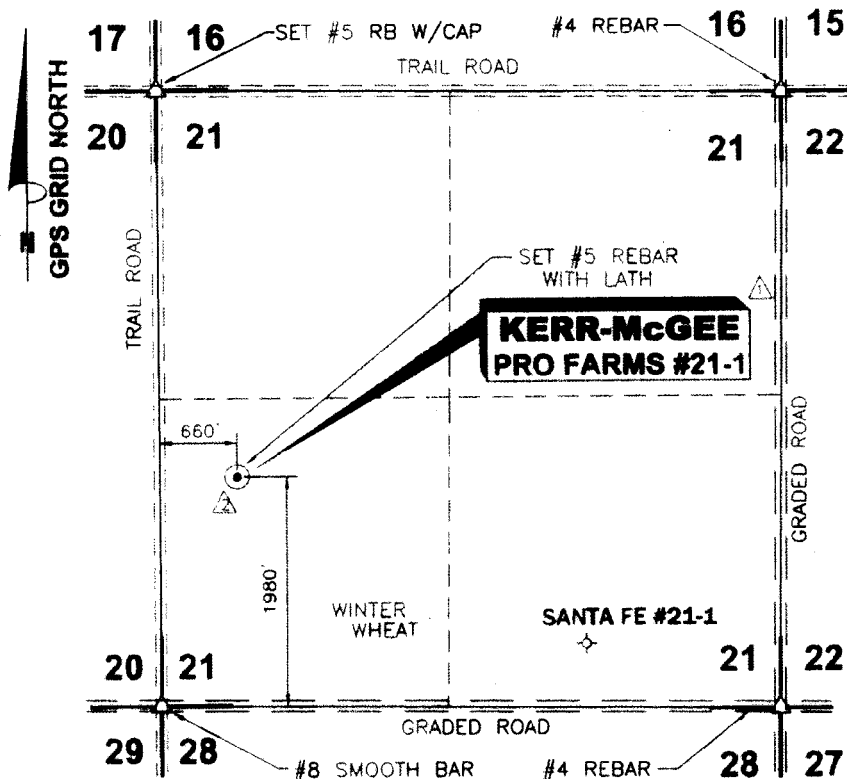

DATE 12/31/09
 OPERATOR △ KERR-McGEE OIL & GAS ONSHORE LP
 WELL NAME PRO FARMS #21-1
 LOCATION SW/4 SEC.21, T29S-R41W
 FOOTAGES & 1980' F S L △
 RELATIONS 660' F W L △
 ELEVATION 3408.02' △
 DISTANCE TO EXISTING WELL 3289.45' △ SANTA FE #21-1
 AUTHORIZED BY JOHN OTTO

SW/4 SEC.21, T29S - R41W STANTON COUNTY, KANSAS

CROP WINTER WHEAT

WATER WELL _____

NEAREST TOWER _____

AIRPORT _____

LATITUDE 37°30'38.10363" N △

LONGITUDE 101°48'49.43486" W

STATE PLANE COORD. X= 1039007.89 △
 KANSAS SOUTH ZONE Y= 324361.49

DRIVING DIRECTIONS USED TO STAKE
 WELL FROM KNOWN LANDMARK OR CITY
 FROM: FROM SW COR. JOHNSON CITY, KS.
THENCE SOUTH ON HWY 27 4.0 MILES.
THENCE WEST ON GRADED CO. RD.
3.0 MILES. THENCE NORTH 1980 FT.
THENCE EAST 660 FT. INTO.



NOTE: CONTRACTOR TO CONTACT ONE CALL @ 1-800-DIG SAFE PRIOR TO ANY EXCAVATION OR CONSTRUCTION.



**WELL LOCATION OF THE PRO FARMS #21-1
 LOCATED IN THE SW/4 SEC.21,
 T29S-R41W, STANTON COUNTY, KANSAS**

NO.	DWN.	REVISIONS	DATE
△	JLM	CHANGED TITLE BLOCK & OPERATOR NAME	1/08/09
△	JLM	RELOCATED WELL LOCATION	1/20/09

SCALE: 1" = 1500' DATE: 12/30/09

WORK ORDER NO. _____

HARDER
 AND ASSOCIATES "locating our world"
 LAND SURVEYING - GPS SPECIALISTS
 P.O. BOX 518 514 MORTON
 Elkhart, Kansas 67530
 Phone: (620) 697-2896
 Fax: (620) 697-4175
 E-MAIL: tharder@elkhart.com

DRAWN BY: SSA CHECKED BY: TVH APPROVED BY: _____ AUTHORIZED BY: JOHN OTTO