





1035501

### IN ALL CASES PLOT THE INTENDED WELL ON THE PLAT BELOW

*Plat of acreage attributable to a well in a prorated or spaced field*

**If the intended well is in a prorated or spaced field, please fully complete this side of the form.** If the intended well is in a prorated or spaced field complete the plat below showing that the well will be properly located in relationship to other wells producing from the common source of supply. Please show all the wells and within 1 mile of the boundaries of the proposed acreage attribution unit for gas wells and within 1/2 mile of the boundaries of the proposed acreage attribution unit for oil wells.

API No. 15 - \_\_\_\_\_

Operator: \_\_\_\_\_

Lease: \_\_\_\_\_

Well Number: \_\_\_\_\_

Field: \_\_\_\_\_

Number of Acres attributable to well: \_\_\_\_\_

QTR/QTR/QTR/QTR of acreage: \_\_\_\_\_ - \_\_\_\_\_ - \_\_\_\_\_ - \_\_\_\_\_

Location of Well: County: \_\_\_\_\_

\_\_\_\_\_ feet from  N /  S Line of Section

\_\_\_\_\_ feet from  E /  W Line of Section

Sec. \_\_\_\_\_ Twp. \_\_\_\_\_ S. R. \_\_\_\_\_  E  W

Is Section:  Regular or  Irregular

**If Section is Irregular, locate well from nearest corner boundary.**

Section corner used:  NE  NW  SE  SW

### PLAT

*(Show location of the well and shade attributable acreage for prorated or spaced wells.)*

*(Show footage to the nearest lease or unit boundary line.)*

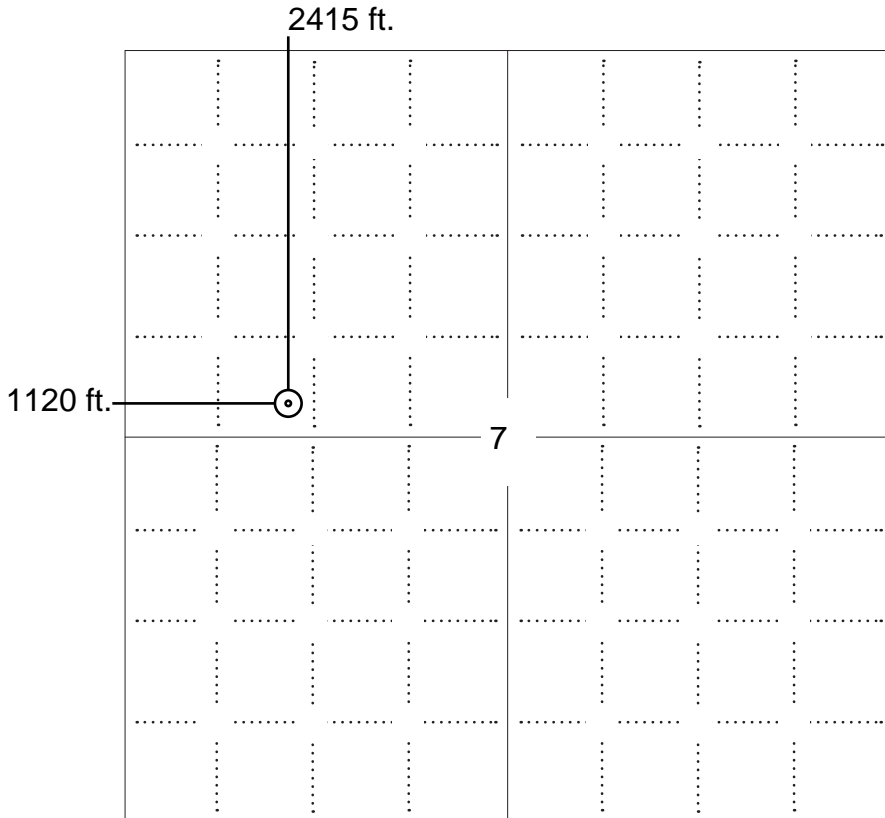

**NOTE: In all cases locate the spot of the proposed drilling locaton.**

#### In plotting the proposed location of the well, you must show:

1. The manner in which you are using the depicted plat by identifying section lines, i.e. 1 section, 1 section with 8 surrounding sections, 4 sections, etc.
2. The distance of the proposed drilling location from the south / north and east / west outside section lines.
3. The distance to the nearest lease or unit boundary line (in footage).
4. If proposed location is located within a prorated or spaced field a certificate of acreage attribution plat must be attached: (C0-7 for oil wells; CG-8 for gas wells).



KANSAS CORPORATION COMMISSION 1035501  
OIL & GAS CONSERVATION DIVISION

Form CDP-1  
April 2004  
Form must be Typed

**APPLICATION FOR SURFACE PIT**

*Submit in Duplicate*

Operator Name: _____		License Number: _____	
Operator Address: _____			
Contact Person: _____		Phone Number: _____	
Lease Name & Well No.: _____		Pit Location (QQQQ): _____ - _____ - _____ - _____	
Type of Pit: <input type="checkbox"/> Emergency Pit <input type="checkbox"/> Burn Pit <input type="checkbox"/> Settling Pit <input type="checkbox"/> Drilling Pit <input type="checkbox"/> Workover Pit <input type="checkbox"/> Haul-Off Pit <i>(If WP Supply API No. or Year Drilled)</i>		Pit is: <input type="checkbox"/> Proposed <input type="checkbox"/> Existing If Existing, date constructed: _____ Pit capacity: _____ (bbls)	
Is the pit located in a Sensitive Ground Water Area? <input type="checkbox"/> Yes <input type="checkbox"/> No		Chloride concentration: _____ mg/l <i>(For Emergency Pits and Settling Pits only)</i>	
Is the bottom below ground level? <input type="checkbox"/> Yes <input type="checkbox"/> No		Artificial Liner? <input type="checkbox"/> Yes <input type="checkbox"/> No	
How is the pit lined if a plastic liner is not used?		_____	
Pit dimensions (all but working pits): _____ Length (feet)    _____ Width (feet)    _____ N/A: Steel Pits Depth from ground level to deepest point: _____ (feet)    _____ No Pit			
If the pit is lined give a brief description of the liner material, thickness and installation procedure.		Describe procedures for periodic maintenance and determining liner integrity, including any special monitoring.	
Distance to nearest water well within one-mile of pit _____ feet    Depth of water well _____ feet		Depth to shallowest fresh water _____ feet. Source of information: _____ measured    _____ well owner    _____ electric log    _____ KDWR	
<b>Emergency, Settling and Burn Pits ONLY:</b> Producing Formation: _____ Number of producing wells on lease: _____ Barrels of fluid produced daily: _____ Does the slope from the tank battery allow all spilled fluids to flow into the pit? <input type="checkbox"/> Yes <input type="checkbox"/> No		<b>Drilling, Workover and Haul-Off Pits ONLY:</b> Type of material utilized in drilling/workover: _____ Number of working pits to be utilized: _____ Abandonment procedure: _____ _____ Drill pits must be closed within 365 days of spud date.	
Submitted Electronically			

<b>KCC OFFICE USE ONLY</b>		Steel Pit	RFAC	RFAS
Date Received: _____	Permit Number: _____	Permit Date: _____	Lease Inspection: <input type="checkbox"/> Yes <input type="checkbox"/> No	

8000 assigned to J.H. Sanderson  
Oil and Gas Lease 1633

AGREEMENT Made and entered into the 8th day of June A. D. 1924, by and between P.A. Hull and Emma Hull wife of P.A. Hull, Howard C. Higgins and C. C. Higgins, all of Ellipton, Kansas, parties of the first part, lessors, and E. J. Sobel of Tulsa, Oklahoma, party of second part, lessees,

WITNESSETH, That the said party... of the first part, for and in consideration of the sum of One Dollar to... in hand well and truly paid by the said party of the second part, the receipt of which is hereby acknowledged, and of the covenants and agreements hereinafter contained on the part of the party of the second part to be paid, kept and performed, has granted, demised, leased and let by these present do... grant, demise, lease and let unto the said second party... heirs, executors, administrators, successors or assigns, for the sole and only purpose of mining and operating for oil and gas, and of laying pipe lines, and building tanks, powers, station and structures thereon to produce and to take care of said products, all that certain tract of land situate in the County of Butler State of Kansas described as follows, to-wit:

W 1/2 of Sec 7 Township 26 Range 9

of Section 7 Township 26 Range 9 and containing 320 acres, more or less.

It is agreed that this lease shall remain in force for a term of five years from this date and as long thereafter as oil or gas, or either of them, is produced from said land by the party of the second part...

In consideration of the premises the said party of the second part covenants and agrees: 1st. To deliver to the credit of the first party...

2nd. To pay the first part Two Hundred DOLLARS, each year in advance, for the gas from each well where gas only is found, while the same is being used off the premises, and the first part... to have gas free of cost from any such well for all stoves and all inside lights in the principal dwelling house on said land during the same time by making their own connections with the well, or lease line.

3rd. To pay to the first part... for gas produced from any oil well and used off the premises at the rate of Fifty Dollars per year, for the time during which such gas shall be used, said payments to be made each three months in advance.

The party of the second part agrees to complete a well on said premises within One year from the date hereof, or pay at the rate of Fifty Cents per acre, except as to such part of said premises as is surrendered as hereinafter provided...

The party of the second part shall have the right to use, free of cost, gas, oil and water produced on said land for its operation thereon, except water from wells of first party.

When requested by first party, the second party shall bury its pipe lines below plow depth. No well shall be drilled nearer than 300 feet to the house or barn on said premises.

Second party shall pay for damages caused by them to growing crops on said land.

The party of the second part shall have the right at any time to remove all machinery and fixtures placed on said premises, including the right to draw and remove casing.

The party of the second part shall not be bound by any change in the ownership of said land until duly notified of any such change, either by notice in writing duly signed by the parties to the instrument of conveyance, or by receipt of the original instrument of conveyance, or duly certified copy thereof.

All payments which may fall due under this lease may be made by check directly to P.A. Hull and C.C. Higgins... or deposited by Second Party to Citizens State Bank of Ellipton, Kansas

It is agreed that the lessee upon the payment of One Dollar shall have the right to surrender and cancel this lease in toto or as to any part of the premises hereinafter described as the lessee may elect upon filing in the proper recording office a duly executed release thereof and all payments and liabilities provided for herein shall cease and determine except as to such portions of the said premises that the lessee shall at his option elect to retain, provided that in the event any suit or action is brought in any court by the lessee to enforce this lease, then this clause providing for the surrender of this lease by the lessee shall become inoperative immediately and concurrently with the commencement of such suit or action.

This lease, and all provisions herein, shall bind, and run in favor of the respective heirs, executors, administrators, successors and assigns of the parties hereto.

Upon failure of the lessee to comply with conditions of this lease, or to make any of the payments above provided for delay in completing a well on the date upon which the same become due, the lessor... shall have a right to declare a forfeiture of this lease if such payment be not made within 30 days after written notice to pay the same.

IN WITNESS WHEREOF, the parties hereto have set their hands and seals the day and year first above written.

Witness: Emma Hull P.A. Hull (SEAL) E. J. Sobel (SEAL)

(ACKNOWLEDGMENT TO THE LE.

STATE OF Kansas  
COUNTY OF Butler } SS:

BE IT REMEMBERED That on this 8 day of June in the year of our Lord one thousand nine hundred and thirteen, before me, a Notary Public in and for said County and State, personally appeared P.A. Hull and A.C. Higgins to be known to be the identical persons, who executed the within and foregoing instrument and acknowledged to me that they executed the same as their free and voluntary act and deed for the uses and purposes therein set forth.

IN WITNESS WHEREOF, I have hereunto set my official signature and affixed my notarial seal the day and year first above written.

My Commission expires Jan'y 23<sup>rd</sup> 1915

Walter J. Higgins Notary Public.

BUTLER COUNTY, KS.  
This instrument was filed for Record on the 22 day of Jan 1914 at 10 o'clock A.M. and duly recorded in Book 135-01 Page 37 Fees \$.....  
Walter J. Higgins  
REGISTRAR OF DEEDS.  
Butler, Kan.

KNOW ALL MEN BY THESE PRESENTS:

That ..... of ..... County, in the State of ..... the within named grant. In consideration of the sum of ..... DOLLARS to ..... in hand paid, the receipt whereof is hereby acknowledged, do hereby sell, assign, transfer, set over and convey unto ..... heirs, and assigns, the within grant. TO HAVE AND TO HOLD THE SAME FOREVER, subject nevertheless, to the condition therein contained. IN WITNESS WHEREOF, The said grant. ha. hereunto set. hand. this. day of ..... 191.....

(ACKNOWLEDGMENT TO THE Lease)

STATE OF Kansas  
COUNTY OF Butler } SS:

On this 16 day of January A. D., 1917, before me, the undersigned, Notary Public in and for the County and State aforesaid, personally appeared Emma Hull, wife of P.A. Hull to me known to be the identical person who executed the within and foregoing instrument and acknowledged to me that she executed the same as her free and voluntary act and deed for the uses and purposes therein set forth.

WITNESS my hand and official seal.

My commission expires October 2<sup>nd</sup> 1915

Ralph B. Holston Notary Public.

76 1633 12  
not Compared with Record  
**Oil and Gas Lease**  
FROM P.A. Hull, et al  
A.C. Higgins  
TO P.A. Hull  
Date June 8 1914  
Section 17 Township 24 Range 12  
No. of Acres 3.29  
Butler County Kansas  
Term Five Years  
STATE OF Kansas } SS:  
COUNTY OF Butler  
This instrument was filed for record on the 22 day of July A. D., 1914 at 7 o'clock P.M. and duly recorded in Book 135-01 at 10 o'clock A.M. of the year of this or at page 37 of the Record of Deeds. Walter J. Higgins Registrar of Deeds.  
Original Compared with Record. Walter J. Higgins Deputy Registrar of Deeds.  
1. Mail 11-70 527