





1035602

**IN ALL CASES PLOT THE INTENDED WELL ON THE PLAT BELOW**

*Plat of acreage attributable to a well in a prorated or spaced field*

**If the intended well is in a prorated or spaced field, please fully complete this side of the form.** If the intended well is in a prorated or spaced field complete the plat below showing that the well will be properly located in relationship to other wells producing from the common source of supply. Please show all the wells and within 1 mile of the boundaries of the proposed acreage attribution unit for gas wells and within 1/2 mile of the boundaries of the proposed acreage attribution unit for oil wells.

API No. 15 - \_\_\_\_\_

Operator: \_\_\_\_\_

Lease: \_\_\_\_\_

Well Number: \_\_\_\_\_

Field: \_\_\_\_\_

Number of Acres attributable to well: \_\_\_\_\_

QTR/QTR/QTR/QTR of acreage: \_\_\_\_\_ - \_\_\_\_\_ - \_\_\_\_\_ - \_\_\_\_\_

Location of Well: County: \_\_\_\_\_

\_\_\_\_\_ feet from  N /  S Line of Section

\_\_\_\_\_ feet from  E /  W Line of Section

Sec. \_\_\_\_\_ Twp. \_\_\_\_\_ S. R. \_\_\_\_\_  E  W

Is Section:  Regular or  Irregular

**If Section is Irregular, locate well from nearest corner boundary.**

Section corner used:  NE  NW  SE  SW

**PLAT**

*(Show location of the well and shade attributable acreage for prorated or spaced wells.)*

*(Show footage to the nearest lease or unit boundary line.)*

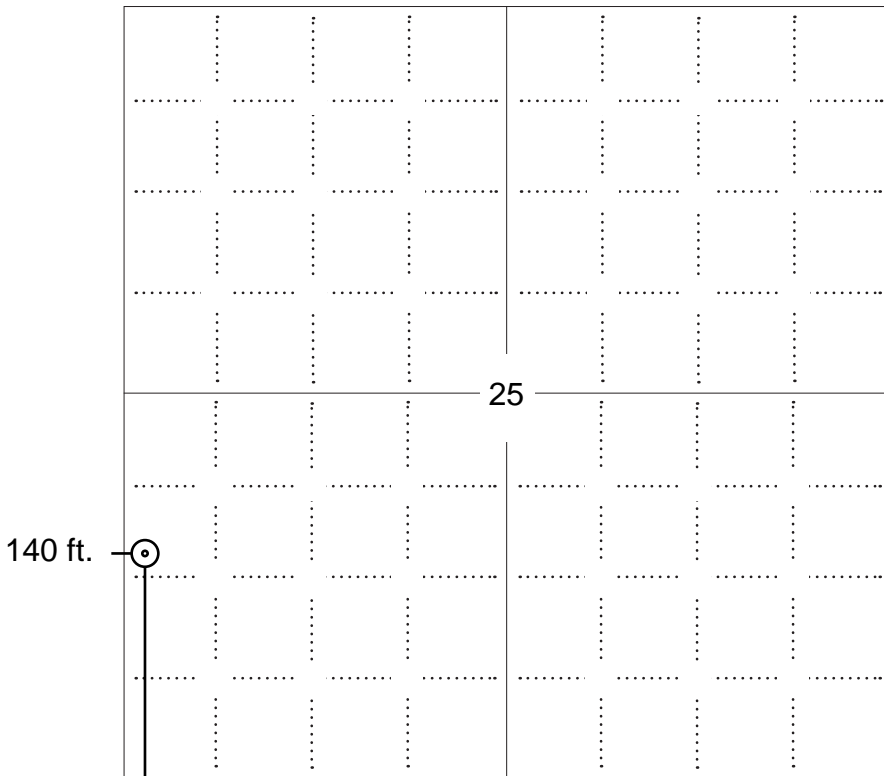

**NOTE: In all cases locate the spot of the proposed drilling locaton.**

1540 ft.

**In plotting the proposed location of the well, you must show:**

1. The manner in which you are using the depicted plat by identifying section lines, i.e. 1 section, 1 section with 8 surrounding sections, 4 sections, etc.
2. The distance of the proposed drilling location from the south / north and east / west outside section lines.
3. The distance to the nearest lease or unit boundary line (in footage).
4. If proposed location is located within a prorated or spaced field a certificate of acreage attribution plat must be attached: (C0-7 for oil wells; CG-8 for gas wells).



KANSAS CORPORATION COMMISSION 1035602  
OIL & GAS CONSERVATION DIVISION

Form CDP-1  
April 2004  
Form must be Typed

**APPLICATION FOR SURFACE PIT**

*Submit in Duplicate*

Operator Name: _____		License Number: _____	
Operator Address: _____			
Contact Person: _____		Phone Number: _____	
Lease Name & Well No.: _____		Pit Location (QQQQ): _____-_____-_____-_____	
Type of Pit: <input type="checkbox"/> Emergency Pit <input type="checkbox"/> Burn Pit <input type="checkbox"/> Settling Pit <input type="checkbox"/> Drilling Pit <input type="checkbox"/> Workover Pit <input type="checkbox"/> Haul-Off Pit <i>(If WP Supply API No. or Year Drilled)</i>		Pit is: <input type="checkbox"/> Proposed <input type="checkbox"/> Existing If Existing, date constructed: _____ Pit capacity: _____ (bbls)	
Is the pit located in a Sensitive Ground Water Area? <input type="checkbox"/> Yes <input type="checkbox"/> No		Chloride concentration: _____ mg/l <i>(For Emergency Pits and Settling Pits only)</i>	
Is the bottom below ground level? <input type="checkbox"/> Yes <input type="checkbox"/> No		Artificial Liner? <input type="checkbox"/> Yes <input type="checkbox"/> No	
How is the pit lined if a plastic liner is not used?		_____	
Pit dimensions (all but working pits): _____ Length (feet)    _____ Width (feet)    _____ N/A: Steel Pits Depth from ground level to deepest point: _____ (feet)    _____ No Pit			
If the pit is lined give a brief description of the liner material, thickness and installation procedure.		Describe procedures for periodic maintenance and determining liner integrity, including any special monitoring.	
Distance to nearest water well within one-mile of pit _____ feet    Depth of water well _____ feet		Depth to shallowest fresh water _____ feet. Source of information: _____ measured    _____ well owner    _____ electric log    _____ KDWR	
<b>Emergency, Settling and Burn Pits ONLY:</b> Producing Formation: _____ Number of producing wells on lease: _____ Barrels of fluid produced daily: _____ Does the slope from the tank battery allow all spilled fluids to flow into the pit? <input type="checkbox"/> Yes <input type="checkbox"/> No		<b>Drilling, Workover and Haul-Off Pits ONLY:</b> Type of material utilized in drilling/workover: _____ Number of working pits to be utilized: _____ Abandonment procedure: _____ _____ Drill pits must be closed within 365 days of spud date.	
Submitted Electronically			

<b>KCC OFFICE USE ONLY</b>		Steel Pit	RFAC	RFAS
Date Received: _____	Permit Number: _____	Permit Date: _____	Lease Inspection: <input type="checkbox"/> Yes <input type="checkbox"/> No	



COPY

**DECLARATION OF UNITIZATION**

**STATE OF KANSAS  
COUNTY OF SHERIDAN**

WHEREAS, the undersigned, Brinker Enterprises, LLC, is the operator of the following described Oil and Gas Leases, to-wit:

1. Oil and Gas Lease dated June 11, 2008, from Transue Sisters Trust, dated August 1, 1991, Velda Transue, Trustee, as Lessor, to Nor-West Kansas Oil, LLC, as Lessee, recorded in book 275, pages 541 et seq. in the office of the Register of Deeds in Sheridan County, Kansas,

Said lease covering the following described land, to-wit:

The Southwest Quarter (SW/4) of Section 25, Township 9, Range 26, Sheridan County, Kansas

**Insofar and only insofar as said lease covers:**

A tract in the Southwest Quarter (SW/4) of Section 25, Township 9, Range 26, Sheridan County, Kansas, being that portion of a 10 acre tract the center of which is located 1540 feet from the South line and 140 feet from the West line of the SW/4 of 25-9-26, including a tract 470 feet by 660 feet from the Southwest Quarter (SW/4) of Section 25, Township 9, Range 26, Sheridan County, Kansas

2. Oil and Gas Lease dated January 3, 2009, from Transue Sisters Trust, dated August 1, 1991, Velda Transue, Trustee, as Lessor, to Nor-West Kansas Oil, LLC, as Lessee, recorded in book 277, pages 191 et seq. in the office of the Register of Deeds in Sheridan County, Kansas,

Said lease covering the following described land, to-wit:

The Southeast Quarter (SE/4) of Section 26, Township 9, Range 26, Sheridan County, Kansas

**Insofar and only insofar as said lease covers:**

A tract in the SE/4 of 26-9-26, 190 feet by 660 feet, being that portion of the 10 acre tract in the SW/4 of 25-9-26 and the SE/4 of 26-9-26, the center of which is located 1540 feet from the South line and 140 feet from the West line of the SW/4 of 25-9-26

WHEREAS, said Oil and Gas Leases contain the following pooling provision, to-wit:

“Lessee, at its option, is hereby given the right and power to pool or combine the acreage covered by this lease or any portion thereof with other land, lease or leases in the immediate vicinity thereof, when in lessee’s judgment it is necessary or advisable to do so in order to properly develop and operate said lease premises so as to promote the conservation of oil, gas or other minerals in and under and that may be produced from said premises, such pooling to be of tracts contiguous to one another and to be into a unit or units not exceeding 40 acres each in the event of an oil well.....”

WHEREAS, the undersigned intends to pool the acreage covered by the above described Oil



“Lessee, at its option, is hereby given the right and power to pool or combine the acreage covered by this lease or any portion thereof with other land, lease or leases in the immediate vicinity thereof, when in lessee’s judgment it is necessary or advisable to do so in order to properly develop and operate said lease premises so as to promote the conservation of oil, gas or other minerals in and under and that may be produced from said premises, such pooling to be of tracts contiguous to one another and to be into a unit or units not exceeding 40 acres each in the event of an oil well.....”

WHEREAS, the undersigned intends to pool the acreage covered by the above described Oil and Gas Leases to form a unit consisting of 10 acres and being described as:

A ten (10) acre tract in the SW/4 of 25-9-26, and the SE/4 of 26-9-26, the center of which is located 1540 feet from the South line and 140 feet from the West line of the SW/4 of 25-9-26, including a tract 470 feet by 660 feet from



the SW/4 of 25-9-26, and including a tract 190 feet by 660 from the Southeast Quarter (SE/4) of Section 26, Township 9, Range 26, Sheridan County, Kansas

NOW THEREFORE, the undersigned elects to pool and unitize the above described 10 acre portion of the acreage covered by said oil and gas leases as provided by the pooling clause in said leases and operate the same as a unit.

This declaration is effective as of the 23 day of FEB, 2010.

Brinker Enterprises, LLC

By: Lee Brinker, MANAGER  
Lee Brinker, Manager

ACKNOWLEDGMENT

STATE OF KANSAS            )  
COUNTY OF Mitchell    ) ss:

The foregoing instrument was acknowledged before me this 23 day of Feb, 2010, by Lee Brinker, Manager of Brinker Enterprises, LLC, on behalf of said LLC.

Karen Brinker  
Notary Public

