

PLAT AND CERTIFICATION OF ACREAGE ATTRIBUTABLE TO A GAS WELL

Kansas Corporation Commission, Conservation Division
 Finney State Office Building, 130 South Market, Room 2078 Wichita, Kansas 67202

API NUMBER 15-
 OPERATOR: Anadarko Petroleum Corporation
 LEASE: Hallock B
 WELL NUMBER: 3H
 FIELD: Hugoton
 NUMBER OF ACRES ATTRIBUTABLE TO WELL: 400
 QTR/QTR/QTR: NW - SE - SE

(Show the location for the well and shade attributable acreage for prorated or spaced wells). (Show the footage to the nearest lease or unit boundary line; and show footage to the nearest common source supply well).

LOCATION OF WELL: COUNTY: Stevens
1250 feet from X South North line of section
1250 feet from X East West line of section

SECTION 36 TWP 33(S) RNG 39W
 IS SECTION X REGULAR or IRREGULAR
 IF SECTION IS IRREGULAR, LOCATE WELL FROM
 NEAREST CORNER BOUNDARY (check line below)
 Section corner used: NE NW X SE SW

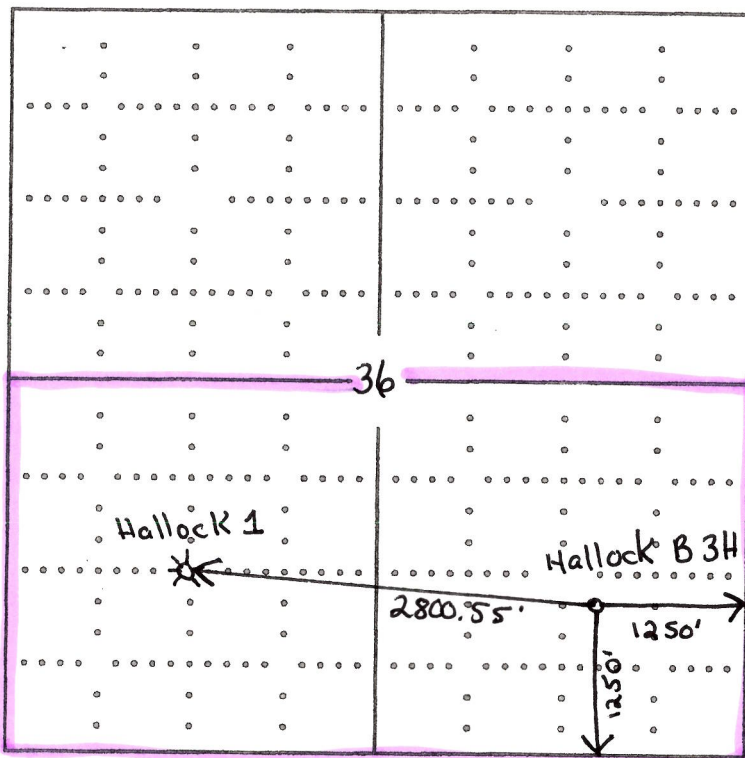

SEE ENCLOSED FOR
 MAP OF UNIT

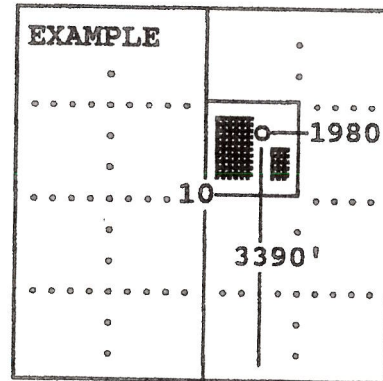

SEWARD CO.

UNIT = $s/2$ 36-33S-39W
 $E/2SE/4$ 17-34S-39W

The undersigned hereby certifies as Staff Regulatory Analyst (title) for Anadarko Petroleum Corporation (Co.), a duly authorized agent, that all information shown hereon is true and correct to the best of my knowledge and belief, that all acreage claimed attributable to the well named herein is held by production from that well and hereby make application for an allowable to be assigned to the well upon the filing of this form and the State test, whichever is later.

Signature Diana Smart

Subscribed and sworn before me this 5 day of February, 2010

Anna Elmore

Notary Public

My Commission expires

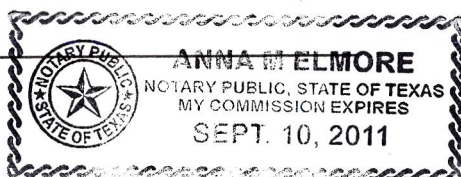

FORM CG-8 (12/94)

KS-0000167300	GENEVIEVE 28-1 RENE 28-4 CENTRAL PLAINS 27-3 CENTRAL PLAINS 27-3 MORGAN C-1	MORGAN C-1 KS-0000180720	KS-0000185110 KS-0000185112
29 KS-000016732(1) KS-000016732(2) KNELLER H-1H	INCR DENS 185-28 LIGHT 1 RENEE 28-1 RENEE 28-5 RENEE 28-5	27 MORGAN C-2H DOROTHY 26-1 DOROTHY 26-1 MORGAN C-2H MORGAN /A-1 MORGAN A-1	25 KS-0000181950 KS-000018203(3) KS-000018204(0) GPCU 25-1 GPCU 25-1
KS-000016734(1) ATU 182-183-184	6 33S 39W LIGHT 1 LIGHT 1-33 INCR DENS 185-28	KS-0000180710 KS-000018205(0) LIGHT D-1	BERRYMAN 1-36 BERRYMAN 1 6 33S 38W
32 KS-000016738(0) KS-000016739(0) LIGHT 'G' 2H LIGHT 'G' 2H HINSHAW A-1H	ANADARKO D-1 LIGHT 'G' 1 LIGHT 'G' 1	ISOM 1 ISOM 1-34 JORDAN 35-2 COULTER 35 #1 KS-000018265(0)	HALLOCK 1 HALLOCK 2 HALLOCK 2 HALLOCK 2 HALLOCK 1-36 BANE 1-36
KS-000016740(0) KIMES /A-1 KIMES A-1 KS-000016749(0) KS-000016852(0) T G HICKS UNIT 2	DOLE A-1 DOLE A-1 BEN NIX 1 NIX 1-3 W MANGLES 1 INCR DENS 71 NIX /B-1 NIX B-1	KS-000018266(0) BURROWS E-1H NIX /A-1 NIX A-1	SIBON 1 ISOM 1 KS-000018497(4) KS-000018497(2) KS-000018497(5) KS-000018497(7) KS-000018497(9) KS-000018497(6) KS-000018497(8) KS-000018497(3) KS-000018497(1) KS-000018497(13)
5 ARMSTRONG 1-4 ELIJAH D THOMPSON ZARMSTRONG 2 NIX 'B' 2 NIX B-2 ARMSTRONG #2 UNIT 4 ARMSTRONG #2 UNIT 3 ARMSTRONG 'C' 1H	ARMSTRONG 1-4 ARMSTRONG 2 NIX 'B' 2 NIX B-2 ARMSTRONG C-1H ARMSTRONG 'C' 1H	ARMSTRONG 3 NIX 1 NIX 1 NIX 2-2 KS-000018361(0)	GRACE #1 UNIT 3 GRACE #1 UNIT 3
ROLLA STATE BANK 1 DREIBELBIS 3 DREIBELBIS 1 P W DREIBELBIS UNIT 1 STAINBROOK C-2H STAINBROOK C-1H JORDAN 11-1	STAINBROOK C-1H STAINBROOK C-2H INCR DENS 70 GRABER FEE #1 UNIT 2	ISOM 1-12 ISOM 1	ISOM 1-12 ISOM 1
6 34S 39W HJV HAYWARD 'O' 1 HAYWARD 1 THOMPSON F A UNIT 2	SNARE 1 KS-000016974(0) KS-000018326(0) JENKENS 1	YOUNG 1-11 YOUNG 1 KS-000018351(0)	T G HICKS UNIT 1 HICKS 1
ARMSTRONG-1 UNIT 2 ARMSTRONG 1 DOLLIE THOMPSON UNIT 1 EEF 16 #1 AEF 16 #1	KS-000018267(0) MCCALLP A-1H MCCALLP A-1H	KERR B-1H KERR B-1H KS-000018367(0) KS-000018368(0) YOUNG 'D' 1H YOUNG 2	NIX 'G' 1H NIX G-1H
17 KS-000016975(0)	KS-000016979(0) ARMSTRONG 1 INCR DENS 77 ARMSTRONG /B-1 KS-000018236(3) KS-000018236(5)	SMITH, RL SMITH R L UNIT 1	MANTZKE 1 KS-000018234(0) MANTZKE A-1 ATU 75-96
20	21	22	23
20	21	22	23

UNIT = S/2 36-33S-39W
E/2 SE/4 17-34S-39W

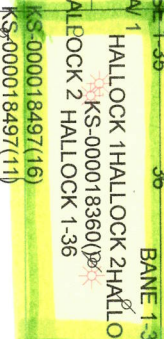

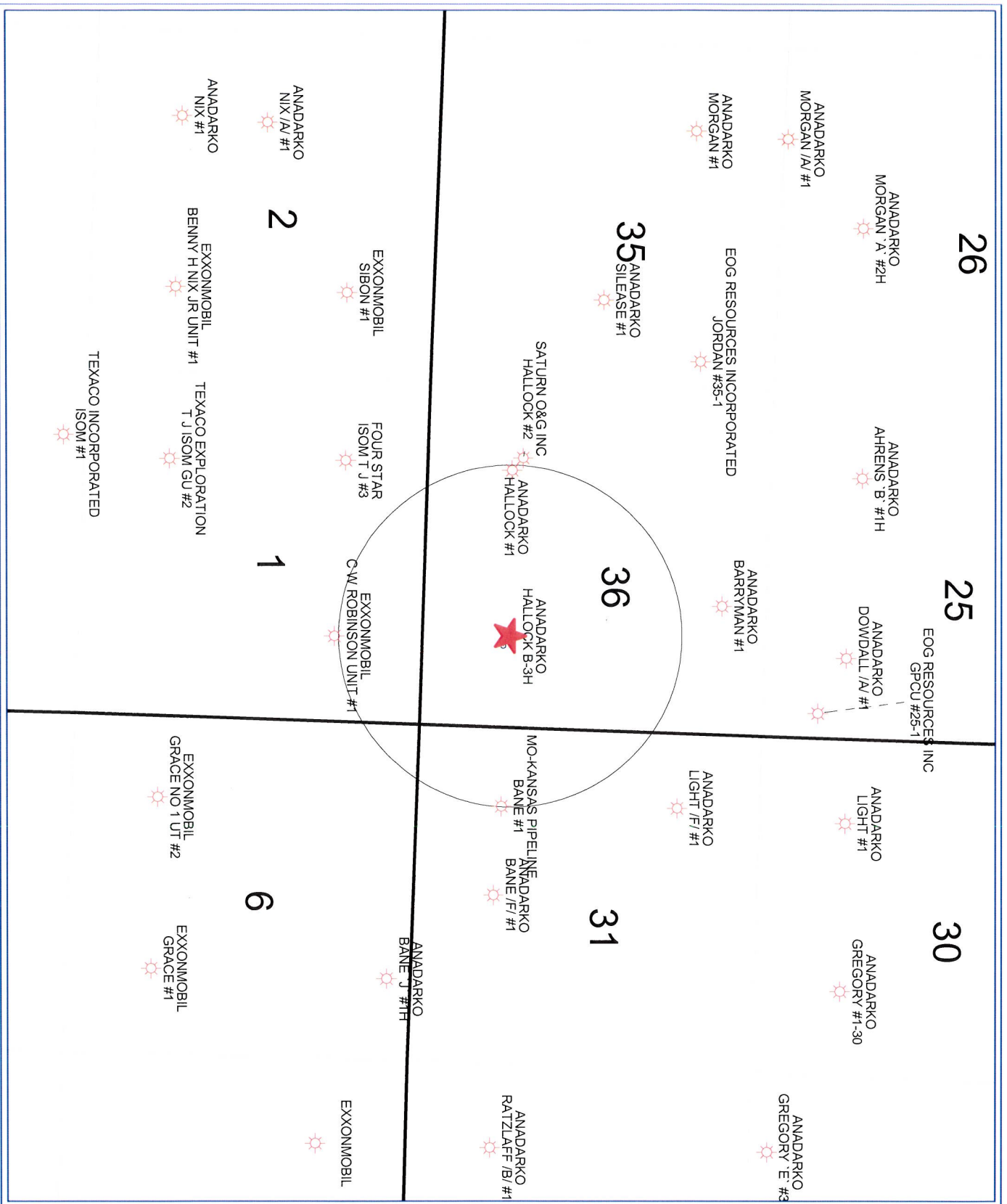

Anadarko
Petroleum Corporation

Hallock B-3H
36-335-39W
Stevens County, Kansas

POSTED WELL DATA
Operator
Well Label

WELL SYMBOLS
 ○ LOCATION
 ☀ Gas Well

0 2,063
 FEET

February 4, 2010