





1038098

**IN ALL CASES PLOT THE INTENDED WELL ON THE PLAT BELOW**

*Plat of acreage attributable to a well in a prorated or spaced field*

**If the intended well is in a prorated or spaced field, please fully complete this side of the form.** If the intended well is in a prorated or spaced field complete the plat below showing that the well will be properly located in relationship to other wells producing from the common source of supply. Please show all the wells and within 1 mile of the boundaries of the proposed acreage attribution unit for gas wells and within 1/2 mile of the boundaries of the proposed acreage attribution unit for oil wells.

API No. 15 - \_\_\_\_\_

Operator: \_\_\_\_\_

Lease: \_\_\_\_\_

Well Number: \_\_\_\_\_

Field: \_\_\_\_\_

Number of Acres attributable to well: \_\_\_\_\_

QTR/QTR/QTR/QTR of acreage: \_\_\_\_\_ - \_\_\_\_\_ - \_\_\_\_\_ - \_\_\_\_\_

Location of Well: County: \_\_\_\_\_

\_\_\_\_\_ feet from  N /  S Line of Section

\_\_\_\_\_ feet from  E /  W Line of Section

Sec. \_\_\_\_\_ Twp. \_\_\_\_\_ S. R. \_\_\_\_\_  E  W

Is Section:  Regular or  Irregular

**If Section is Irregular, locate well from nearest corner boundary.**

Section corner used:  NE  NW  SE  SW

**PLAT**

*(Show location of the well and shade attributable acreage for prorated or spaced wells.)*

*(Show footage to the nearest lease or unit boundary line.)*

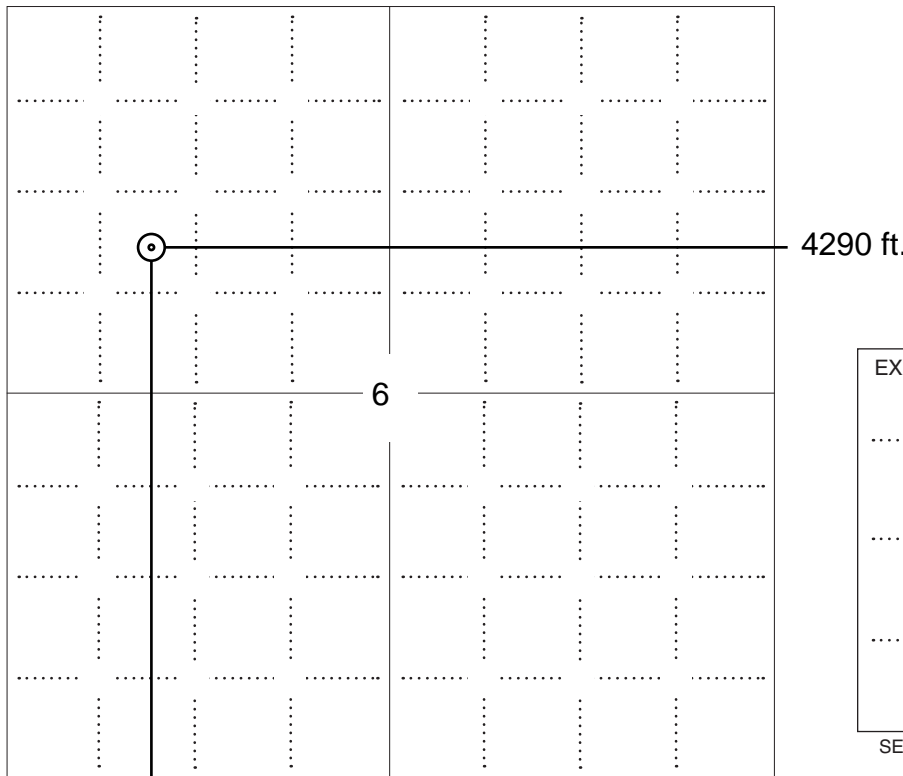

**NOTE: In all cases locate the spot of the proposed drilling location.**

3630 ft.

**In plotting the proposed location of the well, you must show:**

1. The manner in which you are using the depicted plat by identifying section lines, i.e. 1 section, 1 section with 8 surrounding sections, 4 sections, etc.
2. The distance of the proposed drilling location from the south / north and east / west outside section lines.
3. The distance to the nearest lease or unit boundary line (in footage).
4. If proposed location is located within a prorated or spaced field a certificate of acreage attribution plat must be attached: (C0-7 for oil wells; CG-8 for gas wells).



KANSAS CORPORATION COMMISSION 1038098  
OIL & GAS CONSERVATION DIVISION

Form CDP-1  
April 2004  
Form must be Typed

**APPLICATION FOR SURFACE PIT**

*Submit in Duplicate*

Operator Name: _____		License Number: _____	
Operator Address: _____			
Contact Person: _____		Phone Number: _____	
Lease Name & Well No.: _____		Pit Location (QQQQ): _____-_____-_____-_____	
Type of Pit: <input type="checkbox"/> Emergency Pit <input type="checkbox"/> Burn Pit <input type="checkbox"/> Settling Pit <input type="checkbox"/> Drilling Pit <input type="checkbox"/> Workover Pit <input type="checkbox"/> Haul-Off Pit <i>(If WP Supply API No. or Year Drilled)</i>		Pit is: <input type="checkbox"/> Proposed <input type="checkbox"/> Existing If Existing, date constructed: _____ Pit capacity: _____ (bbls)	
Is the pit located in a Sensitive Ground Water Area? <input type="checkbox"/> Yes <input type="checkbox"/> No		Chloride concentration: _____ mg/l <i>(For Emergency Pits and Settling Pits only)</i>	
Is the bottom below ground level? <input type="checkbox"/> Yes <input type="checkbox"/> No		Artificial Liner? <input type="checkbox"/> Yes <input type="checkbox"/> No	
How is the pit lined if a plastic liner is not used?		_____	
Pit dimensions (all but working pits): _____ Length (feet)    _____ Width (feet)    _____ N/A: Steel Pits Depth from ground level to deepest point: _____ (feet)    _____ No Pit			
If the pit is lined give a brief description of the liner material, thickness and installation procedure.		Describe procedures for periodic maintenance and determining liner integrity, including any special monitoring.	
Distance to nearest water well within one-mile of pit _____ feet    Depth of water well _____ feet		Depth to shallowest fresh water _____ feet. Source of information: _____ measured    _____ well owner    _____ electric log    _____ KDWR	
<b>Emergency, Settling and Burn Pits ONLY:</b> Producing Formation: _____ Number of producing wells on lease: _____ Barrels of fluid produced daily: _____ Does the slope from the tank battery allow all spilled fluids to flow into the pit? <input type="checkbox"/> Yes <input type="checkbox"/> No		<b>Drilling, Workover and Haul-Off Pits ONLY:</b> Type of material utilized in drilling/workover: _____ Number of working pits to be utilized: _____ Abandonment procedure: _____ _____ Drill pits must be closed within 365 days of spud date.	
Submitted Electronically			

<b>KCC OFFICE USE ONLY</b>	Steel Pit	RFAC	RFAS
Date Received: _____ Permit Number: _____ Permit Date: _____ Lease Inspection: <input type="checkbox"/> Yes <input type="checkbox"/> No			

**NOTICE TO OPERATORS FILING INTENT TO DRILL  
FOR DISPOSAL OR ENHANCED RECOVERY  
INJECTION WELLS, (CLASS II INJECTION WELL)**

The attached approved Notice of Intent to Drill indicates the proposed well is to be used for injection. An approved "Intent to Drill" does not approve injection authority as a Class II Injection Well in Kansas.

Before any well is used for injection purposes, the operator must file an application for injection authority in accordance with K.A.R. 82-3-401 and provide notice in accordance with K.A.R. 82-3-402. The Conservation Division must issue a written permit granting the application before commencement of injection.

The Conservation Division requirements and restrictions associated with Class II Injection are identified in K.A.R. 82-3-400 et seq of our regulations. Associated regulations governing drilling, completion and injection applications may be found in K.A.R. 82-3-135, Table I, Table II, in the Cedar Hills Sandstone Moratorium, (Docket #156,397-C), and the Eastern Kansas Surface Casing Order, (Docket #133,891-C).

If you have questions regarding the approval of injection authority, an injection application may be filed as a "Design Approval" before actual drilling and completion of the well occurs. If you have any questions or concerns regarding Class II injection wells or regulations, call the Underground Injection Control Department at 316-337-6200.

Failure to obtain commission approval before beginning injection is punishable by a penalty, shut-in of the well or both.



WELL PLUGGING RECORD

NORTH  
Butler County, Sec. 6 Twp. 24 S Rge. 6 (E) (W)  
Location as "NE/CNW/SW" or footage from lines N E S W N W

Lease Owner The Saco Oil Company Well No. 2  
Lease Name Wiebe  
Office Address Box 231, El Dorado, Kansas  
Character of Well (completed as Oil, Gas or Dry Hole) dry hole  
Date well completed 6-16 1957  
Application for plugging filed 6-16 1957  
Application for plugging approved 6-16 1957  
Plugging commenced 6-16 1957  
Plugging completed 19  
Reason for abandonment of well or producing formation dry hole

If a producing well is abandoned, date of last production 19  
Was permission obtained from the Conservation Division or its agents before plugging was commenced? YES

Name of Conservation Agent who supervised plugging of this well Lawrence Matthews, Jr.  
Producing formation \_\_\_\_\_ Depth to top \_\_\_\_\_ Bottom \_\_\_\_\_ Total Depth of Well 2559 Feet  
Show depth and thickness of all water, oil and gas formations.

OIL, GAS OR WATER RECORDS

CASING RECORD

FORMATION	CONTENT	FROM	TO	SIZE	PUT IN	PULLED OUT

Describe in detail the manner in which the well was plugged, indicating where the mud fluid was placed and the method or methods used in introducing it into the hole. If cement or other plugs were used, state the character of same and depth placed, from \_\_\_\_\_ feet to \_\_\_\_\_ feet for each plug set.

Set solid bridge at 125' cement with 15 sacks Fill hole to 30' base of cellar with heavy mud Set solid bridge cement with 10 sacks

Name of Plugging Contractor Red Drilling Company (If additional description is necessary, use BACK of this sheet)  
Address Box 786, El Dorado, Kansas

STATE OF Kansas, COUNTY OF Butler, ss.

F S Murphy (employee of owner) or (owner) of the above-described well, being first duly sworn on oath, says: That I have knowledge of the facts, statements, and matters herein contained and the log of the above-described well as filed and that the same are true and correct. So help me God.

(Signature) A. D. Murphy  
F S Murphy (Address)

Subscribed and sworn to before me this 20th day of June, 1957  
My commission expires 3-19-60  
RE Michael S. Acker  
STATE CORPORATION COMMISSION JUN 23 1957  
#2549 Notary Public.

PLUGGING  
FILE SEC 6 T 24 R 6E  
BOOK PAGE 21 LINE 45



Leon C. Smitherman, Jr.  
14331 Tipperary Circle  
Wichita, Kansas 67230  
Phone 316 733-5434  
FAX 316 733-5554  
MOBILE 316 200-8577  
Email [LCSJRI@aol.com](mailto:LCSJRI@aol.com)

May 13, 2010

Kansas Corporation Commission  
FAX 316.337.6211  
ATTN: Rick Hestermann

RE: Doyle Creek 6-2 SWD Intent to Drill Application

This is a request for an exception to the "Table 1" surface casing requirement for the above referenced well.

Should there be any questions, please contact me.

Sincerely,



Leon C. Smitherman, Jr.

RECEIVED  
MAY 13 2010  
KCC WICHITA

May 18, 2010

Leon C. Smitherman, Jr.  
14331 Tipperary Cir  
Wichita, KS 67203-1517

RE: Doyle Creek 6-2 SWD, NE-SW-NW Sec.6-T24S-R6E, Butler County, Kansas

Dear Mr. Smitherman:

The Kansas Corporation Commission has received your request, dated May 13, 2010, for an exception to the Table 1 minimum surface pipe requirement of 200 feet for the proposed well. From your request, the KCC understands that you are requesting to utilize the existing 120 feet of surface casing in this well bore and Alternate II cementing rules.

After review of this matter by technical staff it was determined that:

1. Bedrock at this location is the Upper Chase Group and is located at or near surface.
2. The deepest water well of record within one mile of the proposed location is 120 feet.

Based on this information, an exception is granted for the Table 1 Minimum Surface Casing Requirements with the following stipulations:

1. Upon completion of the well, the production or long string casing nearest the formation wall shall be immediately cemented from a depth of at least 250 feet back to the surface. Notify the KCC District #2 office prior to spudding the well and one day before cementing the longstring so they may have the opportunity to witness the procedure.
2. In the event the well is dry and no additional production pipe has been cemented in-place, plugging will be performed according to KCC rules per KCC District #2 requirements.

Sincerely Yours,



Doug Louis  
Director

cc: Steve Bond *ok, SB*  
Jeff Klock - Dist #2 *ok via e-mail*