



**For KCC Use:**  
 Effective Date: \_\_\_\_\_  
 District #: \_\_\_\_\_  
 SGA?  Yes  No

**KANSAS CORPORATION COMMISSION 1038109**  
**OIL & GAS CONSERVATION DIVISION**

Form C-1  
 October 2007

**Form must be Typed**  
**Form must be Signed**  
**All blanks must be Filled**

**NOTICE OF INTENT TO DRILL**

*Must be approved by KCC five (5) days prior to commencing well*

Expected Spud Date: \_\_\_\_\_  
 month day year

OPERATOR: License# \_\_\_\_\_  
 Name: \_\_\_\_\_  
 Address 1: \_\_\_\_\_  
 Address 2: \_\_\_\_\_  
 City: \_\_\_\_\_ State: \_\_\_\_\_ Zip: \_\_\_\_\_ + \_\_\_\_\_  
 Contact Person: \_\_\_\_\_  
 Phone: \_\_\_\_\_

CONTRACTOR: License# \_\_\_\_\_  
 Name: \_\_\_\_\_

<b>Well Drilled For:</b>	<b>Well Class:</b>	<b>Type Equipment:</b>
<input type="checkbox"/> Oil	<input type="checkbox"/> Enh Rec	<input type="checkbox"/> Infield
<input type="checkbox"/> Gas	<input type="checkbox"/> Storage	<input type="checkbox"/> Pool Ext.
	<input type="checkbox"/> Disposal	<input type="checkbox"/> Wildcat
<input type="checkbox"/> Seismic ; _____ # of Holes	<input type="checkbox"/> Other	<input type="checkbox"/> Mud Rotary
<input type="checkbox"/> Other: _____		<input type="checkbox"/> Air Rotary
		<input type="checkbox"/> Cable

If OWWO: old well information as follows:  
 Operator: \_\_\_\_\_  
 Well Name: \_\_\_\_\_  
 Original Completion Date: \_\_\_\_\_ Original Total Depth: \_\_\_\_\_

Directional, Deviated or Horizontal wellbore?  Yes  No  
 If Yes, true vertical depth: \_\_\_\_\_  
 Bottom Hole Location: \_\_\_\_\_  
 KCC DKT #: \_\_\_\_\_

Spot Description: \_\_\_\_\_  
 \_\_\_\_\_ - \_\_\_\_\_ - \_\_\_\_\_ - \_\_\_\_\_ Sec. \_\_\_\_\_ Twp. \_\_\_\_\_ S. R. \_\_\_\_\_  E  W  
 (00/000) \_\_\_\_\_ feet from  N /  S Line of Section  
 \_\_\_\_\_ feet from  E /  W Line of Section

Is SECTION:  Regular  Irregular?  
 (Note: Locate well on the Section Plat on reverse side)

County: \_\_\_\_\_  
 Lease Name: \_\_\_\_\_ Well #: \_\_\_\_\_

Field Name: \_\_\_\_\_  
 Is this a Prorated / Spaced Field?  Yes  No

Target Formation(s): \_\_\_\_\_  
 Nearest Lease or unit boundary line (in footage): \_\_\_\_\_

Ground Surface Elevation: \_\_\_\_\_ feet MSL  
 Water well within one-quarter mile:  Yes  No

Public water supply well within one mile:  Yes  No  
 Depth to bottom of fresh water: \_\_\_\_\_

Depth to bottom of usable water: \_\_\_\_\_  
 Surface Pipe by Alternate:  I  II

Length of Surface Pipe Planned to be set: \_\_\_\_\_  
 Length of Conductor Pipe (if any): \_\_\_\_\_

Projected Total Depth: \_\_\_\_\_  
 Formation at Total Depth: \_\_\_\_\_

Water Source for Drilling Operations:  
 Well  Farm Pond Other: \_\_\_\_\_

DWR Permit #: \_\_\_\_\_  
 (Note: Apply for Permit with DWR  )

Will Cores be taken?  Yes  No  
 If Yes, proposed zone: \_\_\_\_\_

**AFFIDAVIT**

The undersigned hereby affirms that the drilling, completion and eventual plugging of this well will comply with K.S.A. 55 et. seq.

It is agreed that the following minimum requirements will be met:

1. Notify the appropriate district office **prior** to spudding of well;
2. A copy of the approved notice of intent to drill **shall be** posted on each drilling rig;
3. The minimum amount of surface pipe as specified below **shall be set** by circulating cement to the top; in all cases surface pipe **shall be set** through all unconsolidated materials plus a minimum of 20 feet into the underlying formation.
4. If the well is dry hole, an agreement between the operator and the district office on plug length and placement is necessary **prior to plugging**;
5. The appropriate district office will be notified before well is either plugged or production casing is cemented in;
6. If an ALTERNATE II COMPLETION, production pipe shall be cemented from below any usable water to surface within **120 DAYS** of spud date. Or pursuant to Appendix "B" - Eastern Kansas surface casing order #133,891-C, which applies to the KCC District 3 area, alternate II cementing must be completed within 30 days of the spud date or the well shall be plugged. **In all cases, NOTIFY district office** prior to any cementing.

**Submitted Electronically**

**For KCC Use ONLY**

API # 15 - \_\_\_\_\_

Conductor pipe required \_\_\_\_\_ feet

Minimum surface pipe required \_\_\_\_\_ feet per ALT.  I  II

Approved by: \_\_\_\_\_

**This authorization expires:** \_\_\_\_\_  
 (This authorization void if drilling not started within 12 months of approval date.)

Spud date: \_\_\_\_\_ Agent: \_\_\_\_\_

**Remember to:**

- File Drill Pit Application (form CDP-1) with Intent to Drill;
- File Completion Form ACO-1 within 120 days of spud date;
- File acreage attribution plat according to field proration orders;
- Notify appropriate district office 48 hours prior to workover or re-entry;
- Submit plugging report (CP-4) after plugging is completed (within 60 days);
- Obtain written approval before disposing or injecting salt water.
- If this permit has expired (See: authorized expiration date) please check the box below and return to the address below.

**Well Not Drilled - Permit Expired** Date: \_\_\_\_\_  
 Signature of Operator or Agent: \_\_\_\_\_



1038109

**IN ALL CASES PLOT THE INTENDED WELL ON THE PLAT BELOW**

*Plat of acreage attributable to a well in a prorated or spaced field*

**If the intended well is in a prorated or spaced field, please fully complete this side of the form.** If the intended well is in a prorated or spaced field complete the plat below showing that the well will be properly located in relationship to other wells producing from the common source of supply. Please show all the wells and within 1 mile of the boundaries of the proposed acreage attribution unit for gas wells and within 1/2 mile of the boundaries of the proposed acreage attribution unit for oil wells.

API No. 15 - \_\_\_\_\_

Operator: \_\_\_\_\_

Lease: \_\_\_\_\_

Well Number: \_\_\_\_\_

Field: \_\_\_\_\_

Number of Acres attributable to well: \_\_\_\_\_

QTR/QTR/QTR/QTR of acreage: \_\_\_\_\_ - \_\_\_\_\_ - \_\_\_\_\_ - \_\_\_\_\_

Location of Well: County: \_\_\_\_\_

\_\_\_\_\_ feet from  N /  S Line of Section

\_\_\_\_\_ feet from  E /  W Line of Section

Sec. \_\_\_\_\_ Twp. \_\_\_\_\_ S. R. \_\_\_\_\_  E  W

Is Section:  Regular or  Irregular

**If Section is Irregular, locate well from nearest corner boundary.**

Section corner used:  NE  NW  SE  SW

**PLAT**

*(Show location of the well and shade attributable acreage for prorated or spaced wells.)*

*(Show footage to the nearest lease or unit boundary line.)*

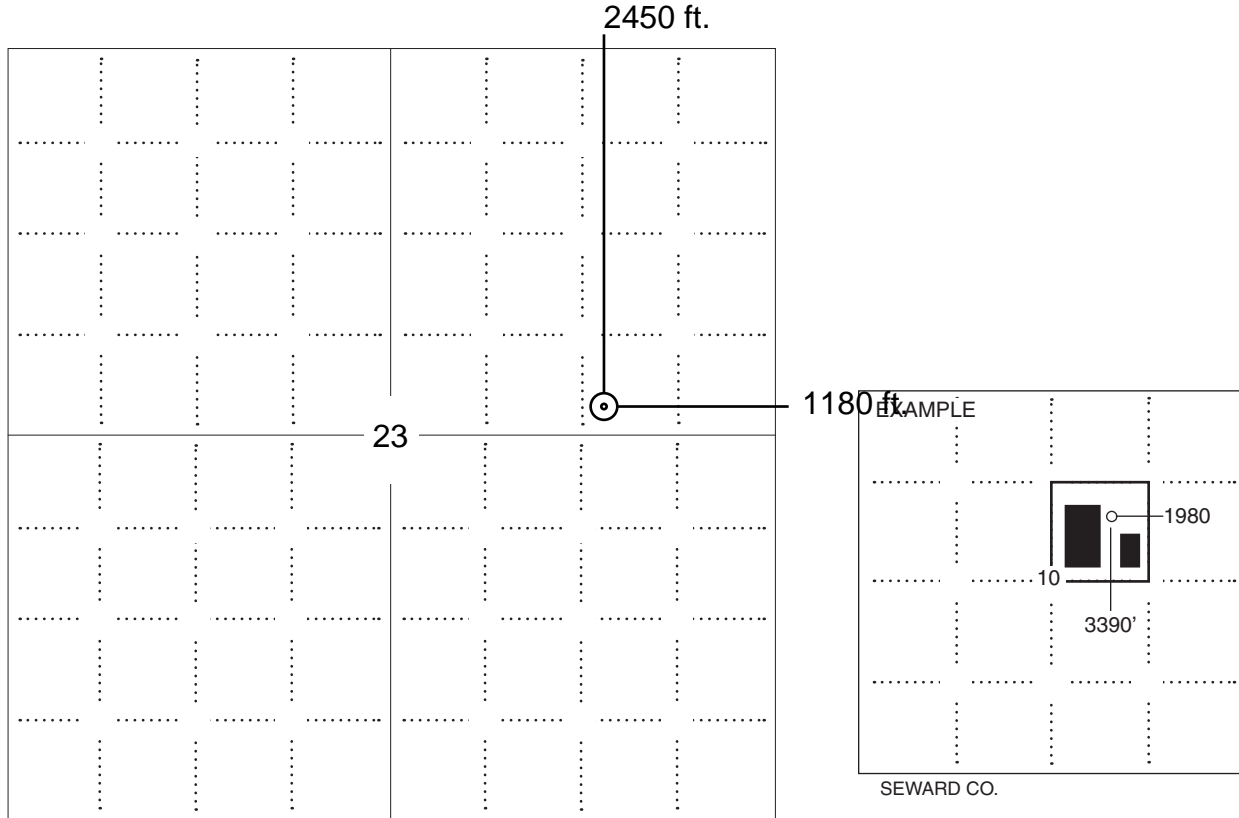

**NOTE: In all cases locate the spot of the proposed drilling locaton.**

**In plotting the proposed location of the well, you must show:**

1. The manner in which you are using the depicted plat by identifying section lines, i.e. 1 section, 1 section with 8 surrounding sections, 4 sections, etc.
2. The distance of the proposed drilling location from the south / north and east / west outside section lines.
3. The distance to the nearest lease or unit boundary line (in footage).
4. If proposed location is located within a prorated or spaced field a certificate of acreage attribution plat must be attached: (C0-7 for oil wells; CG-8 for gas wells).



KANSAS CORPORATION COMMISSION 1038109  
OIL & GAS CONSERVATION DIVISION

Form CDP-1  
April 2004  
Form must be Typed

**APPLICATION FOR SURFACE PIT**

*Submit in Duplicate*

Operator Name: _____		License Number: _____	
Operator Address: _____			
Contact Person: _____		Phone Number: _____	
Lease Name & Well No.: _____		Pit Location (QQQQ): _____ - _____ - _____ - _____	
Type of Pit: <input type="checkbox"/> Emergency Pit <input type="checkbox"/> Burn Pit <input type="checkbox"/> Settling Pit <input type="checkbox"/> Drilling Pit <input type="checkbox"/> Workover Pit <input type="checkbox"/> Haul-Off Pit <i>(If WP Supply API No. or Year Drilled)</i>		Pit is: <input type="checkbox"/> Proposed <input type="checkbox"/> Existing If Existing, date constructed: _____ Pit capacity: _____ (bbls)	
Is the pit located in a Sensitive Ground Water Area? <input type="checkbox"/> Yes <input type="checkbox"/> No		Chloride concentration: _____ mg/l <i>(For Emergency Pits and Settling Pits only)</i>	
Is the bottom below ground level? <input type="checkbox"/> Yes <input type="checkbox"/> No		Artificial Liner? <input type="checkbox"/> Yes <input type="checkbox"/> No	
How is the pit lined if a plastic liner is not used?		_____	
Pit dimensions (all but working pits): _____ Length (feet)    _____ Width (feet)    _____ N/A: Steel Pits Depth from ground level to deepest point: _____ (feet)    _____ No Pit			
If the pit is lined give a brief description of the liner material, thickness and installation procedure.		Describe procedures for periodic maintenance and determining liner integrity, including any special monitoring.	
Distance to nearest water well within one-mile of pit _____ feet    Depth of water well _____ feet		Depth to shallowest fresh water _____ feet. Source of information: _____ measured    _____ well owner    _____ electric log    _____ KDWR	
<b>Emergency, Settling and Burn Pits ONLY:</b> Producing Formation: _____ Number of producing wells on lease: _____ Barrels of fluid produced daily: _____ Does the slope from the tank battery allow all spilled fluids to flow into the pit? <input type="checkbox"/> Yes <input type="checkbox"/> No		<b>Drilling, Workover and Haul-Off Pits ONLY:</b> Type of material utilized in drilling/workover: _____ Number of working pits to be utilized: _____ Abandonment procedure: _____ _____ Drill pits must be closed within 365 days of spud date.	
Submitted Electronically			

<b>KCC OFFICE USE ONLY</b>		Steel Pit	RFAC	RFAS
Date Received: _____	Permit Number: _____	Permit Date: _____	Lease Inspection: <input type="checkbox"/> Yes <input type="checkbox"/> No	

FLATIRONS RESOURCES, LLC  
LAWRENCE LEASE  
NE.1/4, SECTION 23, T16S, R28W  
LANE COUNTY, KANSAS

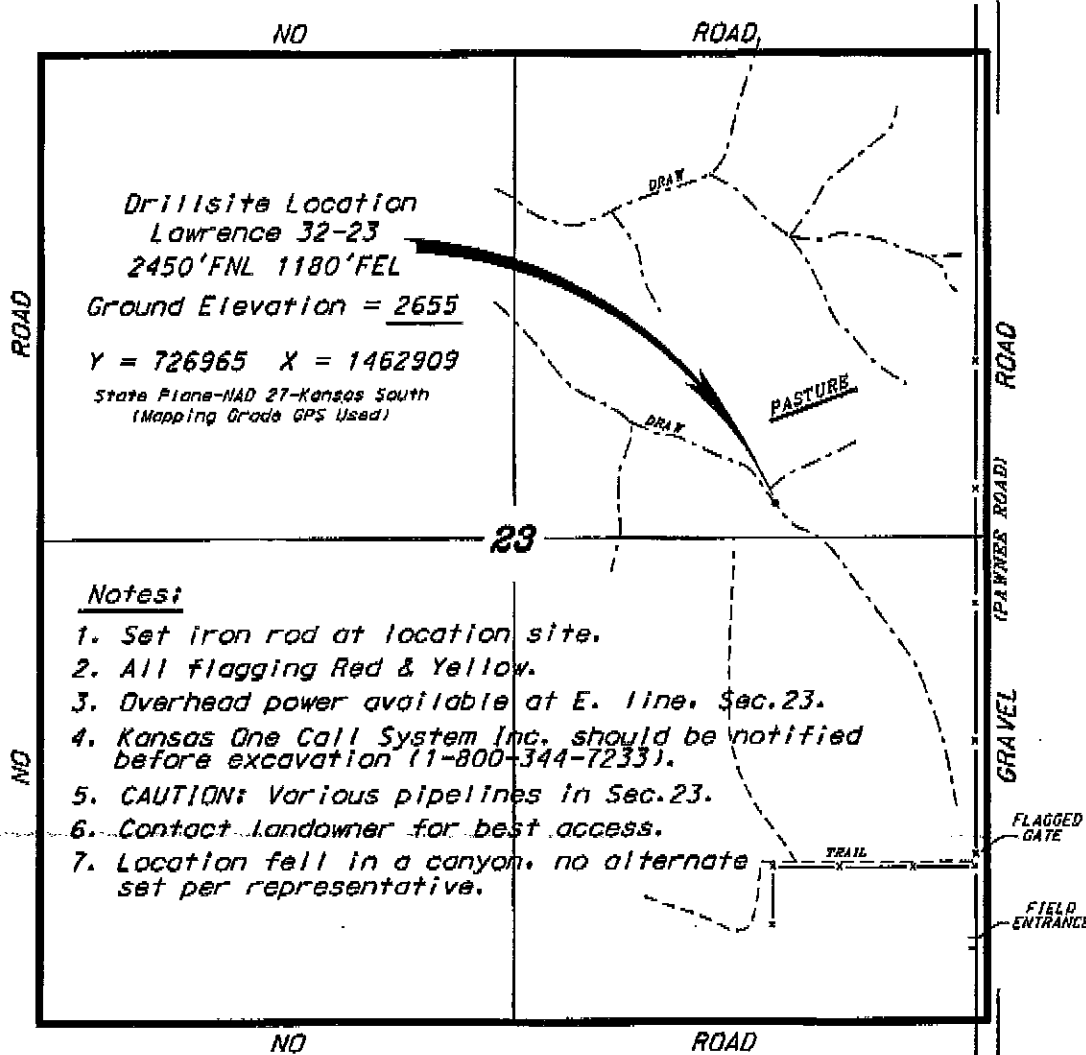

\*Ingress and egress to location as shown on this plat is per usage only and may not be legally opened for public use. Contact landowner, tenant and county road department for access.

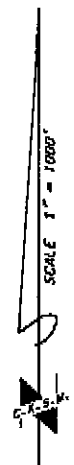

Notes:

1. Set iron rod at location site.
2. All flagging Red & Yellow.
3. Overhead power available at E. line, Sec.23.
4. Kansas One Call System Inc. should be notified before excavation (1-800-344-7233).
5. CAUTION: Various pipelines in Sec.23.
6. Contact landowner for best access.
7. Location fell in a canyon, no alternate set per representative.

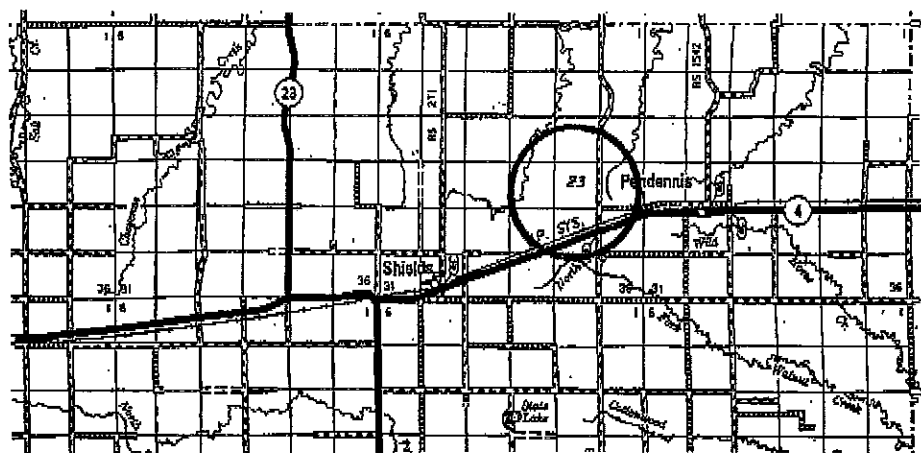

\*Controlling data is based upon the best maps and photographs available to us and upon a regular section of land, containing 640 acres.

\*Approximate section lines were determined using the normal standard of care of oilfield surveyors practicing in the state of Kansas. The section corners, which establish the precise section lines, were not necessarily located, and the exact location of the drillsite location in the section is not guaranteed. Therefore, the operator securing this service and occupying this plat and all other parcels paying thereon agree to hold Central Kansas Oilfield Services, Inc., its officers and employees harmless from all claims, costs and expenses and hold activities released from any liability from this plat or any consequential damages.

\*Elevations derived from National Geodetic Vertical Datum.

Date April 21, 2010

PRODUCERS 88-PAID UP  
NUMERICAL  
DIRECT  
INDIRECT  
/COMP. ORIG.  
COMPUTER

## OIL AND GAS LEASE

Rev. No. 1 (PR 01/08) KANSAS

STATE OF KANSAS, LANE COUNTY, SS  
This instrument was filed for record on the  
27 day of July  
A.D. 2010 at 11 o'clock AM and  
duly recorded in Book 230 on page 78

Fee 1.20  
Quinn De Blauknark  
Register of Deeds

This Oil and Gas Lease ("Lease") is made this 23rd day of December, 2009, by and between Howard Lawrence and Carolyn Lawrence, husband and wife, whose mailing address of 266 N. Laredo, Shields, Kansas 67839 ("Lessor", whether one or more) and **FLATIRONS RESOURCES, LLC** with an office at **303 East 17th Avenue, Suite 940, Denver, Colorado 80203** ("Lessee").

WITNESSETH, For and in Consideration of TEN DOLLARS, the covenants and agreements contained herein, and other good and valuable consideration the receipt and sufficiency of which are hereby acknowledged, Lessor does hereby grant, demise, lease and let exclusively unto said Lessee, its successors and assigns, with the exclusive rights for the purposes of drilling (including but not limited to straight, directional or horizontal wells), exploring by geophysical and other methods and operating for and producing therefrom oil and all gas of whatsoever nature or kind (including coalbed gas), and laying pipelines, telephone and telegraph lines, building tanks, plants, power stations, roadways and structures thereon to produce, save and take care of said products (including dewatering of coal bed gas wells), and the exclusive surface or subsurface rights and privileges related in any manner to any and all such operations, including the injection of water, brine and other substances into the subsurface, and any and all other rights and privileges necessary, incident to, or convenient for the operation alone or conjointly with neighboring land for such purposes, all that certain tract or tracts of land situated in **Lane County, Kansas** described as follows:

### Township 16 South, Range 28 West of 6th P.M. Section 23: S/2 & S/2N/2

together with all lakes, streams, roads, easements, and rights-of-way which traverse or adjoin said lands owned or claimed by Lessor, or which may hereinafter be established to be owned by Lessor, and also in addition to the above described lands and rights, any and all strips or parcels of land other than those constituting regular governmental subdivisions, adjoining or contiguous to the above described land owned or claimed by Lessor, all of the above described lands being hereinafter referred to as (the "Premises") and containing **480** acres, more or less.

1. It is agreed that this Lease shall remain in full force for a term of Three (3) years from this date ("Primary Term") and as long thereafter as oil or gas of whatsoever nature or kind is produced from the Premises or on acreage pooled or unitized therewith, or operations are continued as hereinafter provided. If, at the expiration of the Primary Term, oil or gas is not being produced from the Premises or on acreage pooled or unitized therewith but Lessee is then engaged in drilling, reworking or dewatering operations thereon, then this Lease shall continue in force so long as such operations are being continuously prosecuted. Operations shall be considered to be continuously prosecuted if not more than ninety (90) days shall elapse between the completion or abandonment of one well and the beginning of operations for the drilling of a subsequent well. If after discovery of oil or gas on the Premises or on acreage pooled or unitized therewith, the production thereof should cease from any cause after the primary term, this Lease shall not terminate if Lessee commences additional drilling, reworking or dewatering operations within ninety (90) days from date of cessation of production or from date of completion of a dry hole. If oil or gas shall be discovered and produced as a result of such operations at or after the expiration of the Primary Term, this Lease shall continue in force so long as oil or gas is produced from the Premises or on acreage pooled or unitized therewith. If at the expiration of this Lease, Lessee has in use surface or subsurface easements granted to Lessee pursuant to the terms hereof, such easements shall survive the termination of this lease for as long thereafter as so utilized by Lessee.

2. This is a PAID-UP LEASE. In consideration of the payment made herewith, Lessor agrees that Lessee shall not be obligated, except as otherwise provided herein, to commence or continue any operations during the primary term. Lessee may at any time or times during or after the Primary Term surrender this Lease as to all or any portion of the Premises and as to any strata or stratum, by delivering to Lessor or by filing for record a release or releases, and be relieved of all obligations thereafter accruing as to the acreage surrendered.

3. The royalties to be paid by Lessee are: (a) on oil and other liquid hydrocarbons twelve and one-half percent (12 ½%) of that produced and saved from said land, the same to be delivered at the wells, or to the credit of Lessor into the pipeline to which the wells may be connected; Lessee may from time to time purchase any royalty oil in its possession, paying the market price therefore prevailing for the field where produced on the date of purchase; (b) on gas and the constituents thereof produced from said land and sold or used off the premises or in the manufacture of products therefrom, the market value at the well of twelve and one-half percent (12 ½%) of the product sold or used. On product sold at the well, the royalty shall be twelve and one-half percent (12 ½%) of the net proceeds realized from such sale. All royalties paid on gas sold or used off the premises or in the manufacture of products therefrom will be paid after deducting from such royalty Lessor's proportionate amount of all post-production costs, including but not limited to gross production and severance taxes, gathering and transportation costs from the wellhead to the point of sale, treating, compression, and processing. On product sold at the well, the royalty shall be twelve and one-half percent (12 ½%) of the net proceeds realized from such sale, after deducting from such royalty Lessor's proportionate amount of all of the above post-production costs and expenses, if any.

4. Where gas from a well capable of producing gas (or from a well in which dewatering operations have commenced), is not sold or used after the expiration of the Primary Term, Lessee shall pay or tender as royalty to Lessor at the address set forth above One Dollar (\$1.00) per year per net mineral acre, such payment to tender to be made on or before the anniversary date of this Lease next ensuing after the expiration of one hundred twenty (120) days from the date such well is shut in or dewatering operations are commenced and thereafter on or before the anniversary date of this Lease during the period such well is shut in or dewatering operations are being conducted.

5. If Lessor owns a lesser interest in the Premises than the entire and undivided fee simple estate therein, then the royalties (including any shut-in gas royalty) herein provided for shall be paid Lessor only in the proportion which Lessor's interest bears to the whole and undivided fee.

6. Lessee shall have the right to use, free of cost, gas, oil and water produced on the Premises for Lessee's operations thereon, except water from the wells of Lessor.

7. When requested by Lessor, Lessee shall bury Lessee's pipeline below plow depth.

8. No well shall be drilled nearer than 200 feet to the house or barn now on the Premises without written consent of Lessor.

9. Lessee shall pay for damages caused by Lessee's operations to growing crops on the Premises.

10. Lessee shall have the right at any time to remove all machinery and fixtures (including casing) Lessee has placed on the Premises.

11. The rights of the Lessor and Lessee hereunder may be assigned in whole or part. No change in ownership of Lessor's interest (by assignment or otherwise) shall be binding on Lessee until Lessee has been furnished with notice, consisting of certified copies of all recorded instruments or documents and other information necessary to establish a complete chain of record title from Lessor, and then only with respect to payments thereafter made. No other kind of notice, whether actual or constructive, shall be binding on Lessee. No present or future division of Lessor's ownership as to different portions or parcels of the Premises shall operate to enlarge the obligations or diminish the rights of Lessee, and all Lessee's operations may be conducted without regard to any such division. If all or any part of this Lease is assigned, no leasehold owner shall be liable for any act or omission of any other leasehold owner.

12. Lessee, at its option, is hereby given the right and power at any time and from time to time as a recurring right, either before or after production, as to all or any part of the Premises and as to any one or more of the formations thereunder, to pool or unitize the leasehold estate and the mineral estate covered by this Lease with other land, lease or leases in the immediate vicinity for the production of oil and gas, or separately for the production of either, when in Lessee's judgment it is necessary or advisable to do so, and irrespective of whether authority similar to this exists with respect to such other land, lease or leases. Likewise units previously formed to include formations not producing oil or gas may be reformed to exclude such non-producing formations. The forming or reforming of any unit shall be accomplished by Lessee executing and filing of record a declaration of such unitization or reformation, which declaration shall describe the unit. Any unit may include land upon which a well has theretofore been completed or upon which operations for drilling have theretofore been commenced. Production, drilling, reworking or dewatering operations or a well shut in for want of a market anywhere on a unit which includes all or a part of this Lease shall be treated as if it were production, drilling, reworking or dewatering operations or a well shut in for want of a market under this Lease. In lieu of the royalties elsewhere herein specified, including shut-in gas royalties, Lessor shall receive royalties on production from such unit only on the portion of such production allocated to this Lease; such allocation shall be that proportion of the unit production that the total number of surface acres covered by this Lease and included in the Unit bears to the total number of surface acres in such Unit. In addition to the foregoing, Lessee shall have the right to unitize, pool, or combine all or any part of the Premises as to one or more of the formations thereunder with other lands in the same general area by entering into a cooperative or unit plan of development or operation approved by any governmental authority and, from time to time, with like approval, to modify, change or terminate any such plan or agreement and, in such event, the terms, conditions and provisions of this Lease shall be deemed modified to conform to the terms, conditions, and provisions of such approved cooperative or unit plan of development or operation and, particularly, all drilling and development requirements of this Lease, express or implied, shall be satisfied by compliance with the drilling and development requirements of such plan or



May 21, 2010

John Marvin  
Flatirons Resources LLC  
303 E 17TH AVE STE 940  
DENVER, CO 80203

Re: Drilling Pit Application  
Lawrence 32-23  
NE/4 Sec.23-16S-28W  
Lane County, Kansas

Dear John Marvin:

District staff has inspected the above referenced location and has determined that two small working pits should be constructed and be double-lined with plastic. The small jet pit must also be lined and pumped to an off-site reserve pit.

**If production casing is set all completion fluids shall be removed from the working pits daily. NO completion fluids or non-exempt wastes shall be placed in the reserve pit.**

The fluids should be taken to an authorized disposal well. Please call the District Office at (620) 225-8888 when the fluids have been removed. Please file form CDP-5 (August 2008), Exploration and Production Waste Transfer, through SOLAR within 30 days of fluid removal.

**A copy of this letter should be posted in the doghouse along with the approved Intent to Drill.** If you have any questions or concerns please feel free to contact the District Office at (620) 225-8888.

**HAUL-OFF PIT APPLICATION  
FILING REQUIREMENTS**

**82-3-607.**

**DISPOSAL OF DIKE AND PIT CONTENTS.**

- (a) Each operator shall perform one of the following when disposing of dike or pit contents:
- (1) Remove the liquid contents to a disposal well or other oil and gas operation approved by the commission or to road maintenance or construction locations approved by the department;
  - (2) dispose of reserve pit waste down the annular space of a well completed according to the alternate I requirements of K.A.R. 82-3-106, if the waste to be disposed of was generated during the drilling and completion of the well; or
  - (3) dispose of the remaining solid contents in any manner required by the commission. The requirements may include any of the following:
    - (A) Burial in place, in accordance with the grading and restoration requirements in K.A.R. 82-3-602 (f);
    - (B) removal and placement of the contents in an on-site disposal area approved by the commission;
    - (C) removal and placement of the contents in an off-site disposal area on acreage owned by the same landowner or to another producing lease or unit operated by the same operator, if prior written permission from the landowner has been obtained; or
    - (D) removal of the contents to a permitted off-site disposal area approved by the department.
- (b) Each violation of this regulation shall be punishable by the following:
- (1) A \$1,000 penalty for the first violation;

- (2) a \$2,500 penalty for the second violation; and
- (3) a \$5,000 penalty and an operator license review for the third violation.

**File Haul-Off Pit Application in SOLAR. Review the information below and attach all required documents to the pit application when submitting through SOLAR. This form will automatically generate and fill in from questions asked in SOLAR.**

Haul-off pit will be located in an on-site disposal area: \_\_\_Yes \_\_\_No

Haul-off pit is located in an off-site disposal area on acreage owned by the same landowner: \_\_\_Yes \_\_\_No If yes, written permission from the land owner must be obtained. Attach written permission to haul-off pit application.

Haul-off pit is located in an off-site disposal area on another **producing** lease or unit operated by the same operator: \_\_\_Yes \_\_\_No If yes, written permission from the land owner must be obtained. Attach permission and a copy of the lease assignment that covers the acreage where the haul-off pit is to be located, to the haul-off pit application.