

For KCC Use:  
Effective Date: \_\_\_\_\_  
District # \_\_\_\_\_  
SGA?  Yes  No

NOTICE OF INTENT TO DRILL

Must be approved by KCC five (5) days prior to commencing well

Form KSONA-1, Certification of Compliance with the Kansas Surface Owner Notification Act, MUST be submitted with this form.

Expected Spud Date: \_\_\_\_\_  
month day year

OPERATOR: License# \_\_\_\_\_  
Name: \_\_\_\_\_  
Address 1: \_\_\_\_\_  
Address 2: \_\_\_\_\_  
City: \_\_\_\_\_ State: \_\_\_\_\_ Zip: \_\_\_\_\_ + \_\_\_\_\_  
Contact Person: \_\_\_\_\_  
Phone: \_\_\_\_\_  
CONTRACTOR: License# \_\_\_\_\_  
Name: \_\_\_\_\_

Well Drilled For:  Oil  Gas  Seismic ; \_\_\_\_\_ # of Holes  Other: \_\_\_\_\_  
Well Class:  Enh Rec  Storage  Disposal  Infield  Pool Ext.  Wildcat  Other  
Type Equipment:  Mud Rotary  Air Rotary  Cable

If OWWO: old well information as follows:  
Operator: \_\_\_\_\_  
Well Name: \_\_\_\_\_  
Original Completion Date: \_\_\_\_\_ Original Total Depth: \_\_\_\_\_

Directional, Deviated or Horizontal wellbore?  Yes  No  
If Yes, true vertical depth: \_\_\_\_\_  
Bottom Hole Location: \_\_\_\_\_  
KCC DKT #: \_\_\_\_\_

Spot Description: \_\_\_\_\_  
\_\_\_\_\_ - \_\_\_\_\_ - \_\_\_\_\_ Sec. \_\_\_\_\_ Twp. \_\_\_\_\_ S. R. \_\_\_\_\_  E  W  
(Q/Q/Q/Q) \_\_\_\_\_ feet from  N /  S Line of Section  
\_\_\_\_\_ feet from  E /  W Line of Section  
Is SECTION:  Regular  Irregular?  
(Note: Locate well on the Section Plat on reverse side)

County: \_\_\_\_\_  
Lease Name: \_\_\_\_\_ Well #: \_\_\_\_\_  
Field Name: \_\_\_\_\_  
Is this a Prorated / Spaced Field?  Yes  No  
Target Formation(s): \_\_\_\_\_  
Nearest Lease or unit boundary line (in footage): \_\_\_\_\_  
Ground Surface Elevation: \_\_\_\_\_ feet MSL  
Water well within one-quarter mile:  Yes  No  
Public water supply well within one mile:  Yes  No  
Depth to bottom of fresh water: \_\_\_\_\_  
Depth to bottom of usable water: \_\_\_\_\_  
Surface Pipe by Alternate:  I  II  
Length of Surface Pipe Planned to be set: \_\_\_\_\_  
Length of Conductor Pipe (if any): \_\_\_\_\_  
Projected Total Depth: \_\_\_\_\_  
Formation at Total Depth: \_\_\_\_\_  
Water Source for Drilling Operations:  
 Well  Farm Pond  Other: \_\_\_\_\_  
DWR Permit #: \_\_\_\_\_  
(Note: Apply for Permit with DWR )  
Will Cores be taken?  Yes  No  
If Yes, proposed zone: \_\_\_\_\_

AFFIDAVIT

The undersigned hereby affirms that the drilling, completion and eventual plugging of this well will comply with K.S.A. 55 et. seq.

It is agreed that the following minimum requirements will be met:

- 1. Notify the appropriate district office **prior** to spudding of well;
- 2. A copy of the approved notice of intent to drill **shall be** posted on each drilling rig;
- 3. The minimum amount of surface pipe as specified below **shall be set** by circulating cement to the top; in all cases surface pipe **shall be set** through all unconsolidated materials plus a minimum of 20 feet into the underlying formation.
- 4. If the well is dry hole, an agreement between the operator and the district office on plug length and placement is necessary **prior to plugging**;
- 5. The appropriate district office will be notified before well is either plugged or production casing is cemented in;
- 6. If an ALTERNATE II COMPLETION, production pipe shall be cemented from below any usable water to surface within **120 DAYS** of spud date. Or pursuant to Appendix "B" - Eastern Kansas surface casing order #133,891-C, which applies to the KCC District 3 area, alternate II cementing must be completed within 30 days of the spud date or the well shall be plugged. **In all cases, NOTIFY district office** prior to any cementing.

Submitted Electronically

For KCC Use ONLY  
API # 15 - \_\_\_\_\_  
Conductor pipe required \_\_\_\_\_ feet  
Minimum surface pipe required \_\_\_\_\_ feet per ALT.  I  II  
Approved by: \_\_\_\_\_  
This authorization expires: \_\_\_\_\_  
(This authorization void if drilling not started within 12 months of approval date.)  
Spud date: \_\_\_\_\_ Agent: \_\_\_\_\_

Remember to:

- File Certification of Compliance with the Kansas Surface Owner Notification Act (KSONA-1) with Intent to Drill;
- File Drill Pit Application (form CDP-1) with Intent to Drill;
- File Completion Form ACO-1 within 120 days of spud date;
- File acreage attribution plat according to field proration orders;
- Notify appropriate district office 48 hours prior to workover or re-entry;
- Submit plugging report (CP-4) after plugging is completed (within 60 days);
- Obtain written approval before disposing or injecting salt water.
- If well will not be drilled or permit has expired (See: authorized expiration date) please check the box below and return to the address below.

Well will not be drilled or Permit Expired Date: \_\_\_\_\_  
Signature of Operator or Agent: \_\_\_\_\_



**For KCC Use ONLY**  
API # 15 - \_\_\_\_\_

**IN ALL CASES PLOT THE INTENDED WELL ON THE PLAT BELOW**

In all cases, please fully complete this side of the form. Include items 1 through 5 at the bottom of this page.

Operator: \_\_\_\_\_  
Lease: \_\_\_\_\_  
Well Number: \_\_\_\_\_  
Field: \_\_\_\_\_  
Number of Acres attributable to well: \_\_\_\_\_  
QTR/QTR/QTR of acreage: \_\_\_\_\_ - \_\_\_\_\_ - \_\_\_\_\_ - \_\_\_\_\_

Location of Well: County: \_\_\_\_\_  
\_\_\_\_\_ feet from  N /  S Line of Section  
\_\_\_\_\_ feet from  E /  W Line of Section  
Sec. \_\_\_\_\_ Twp. \_\_\_\_\_ S. R. \_\_\_\_\_  E  W

Is Section:  Regular or  Irregular

**If Section is Irregular, locate well from nearest corner boundary.**

Section corner used:  NE  NW  SE  SW

**PLAT**

Show location of the well. Show footage to the nearest lease or unit boundary line. Show the predicted locations of lease roads, tank batteries, pipelines and electrical lines, as required by the Kansas Surface Owner Notice Act (House Bill 2032). You may attach a separate plat if desired.

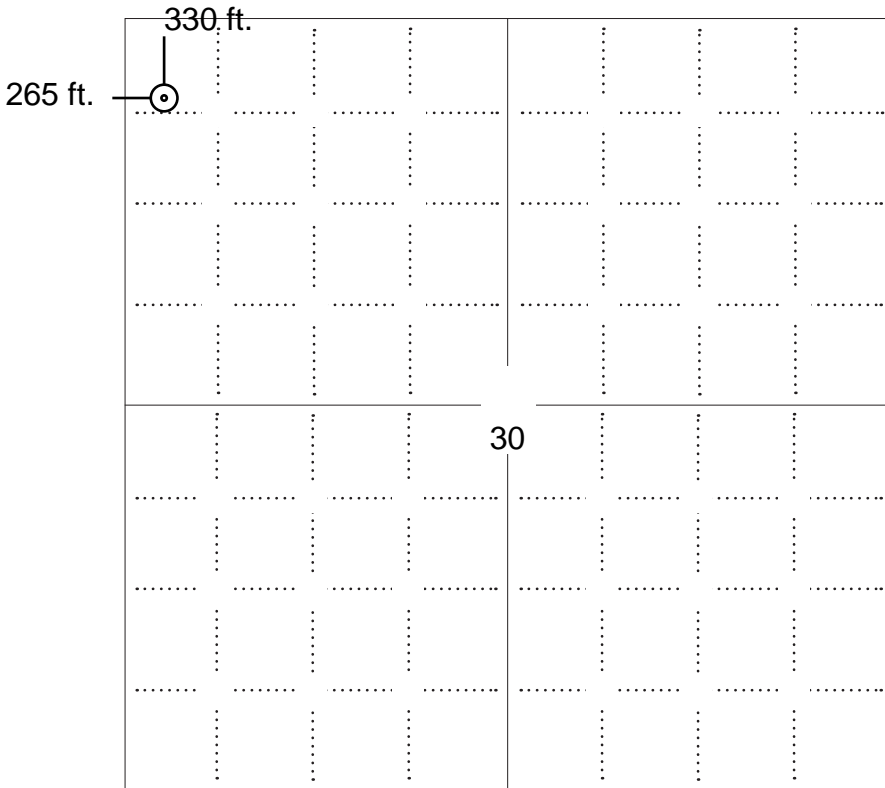

**LEGEND**

- Well Location
- Tank Battery Location
- Pipeline Location
- Electric Line Location
- Lease Road Location



**NOTE: In all cases locate the spot of the proposed drilling locaton.**

**In plotting the proposed location of the well, you must show:**

1. The manner in which you are using the depicted plat by identifying section lines, i.e. 1 section, 1 section with 8 surrounding sections, 4 sections, etc.
2. The distance of the proposed drilling location from the south / north and east / west outside section lines.
3. The distance to the nearest lease or unit boundary line (in footage).
4. If proposed location is located within a prorated or spaced field a certificate of acreage attribution plat must be attached: (C0-7 for oil wells; CG-8 for gas wells).
5. The predicted locations of lease roads, tank batteries, pipelines, and electrical lines.

**APPLICATION FOR SURFACE PIT***Submit in Duplicate*

Operator Name:		License Number:	
Operator Address:			
Contact Person:		Phone Number:	
Lease Name & Well No.:		Pit Location (QQQQ): ____ - ____ - ____ - ____ Sec. ____ Twp. ____ R. ____ <input type="checkbox"/> East <input type="checkbox"/> West ____ Feet from <input type="checkbox"/> North / <input type="checkbox"/> South Line of Section ____ Feet from <input type="checkbox"/> East / <input type="checkbox"/> West Line of Section ____ County	
Type of Pit: <input type="checkbox"/> Emergency Pit <input type="checkbox"/> Burn Pit <input type="checkbox"/> Settling Pit <input type="checkbox"/> Drilling Pit <input type="checkbox"/> Workover Pit <input type="checkbox"/> Haul-Off Pit <i>(If WP Supply API No. or Year Drilled)</i>	Pit is: <input type="checkbox"/> Proposed <input type="checkbox"/> Existing If Existing, date constructed: _____ Pit capacity: _____ (bbls)		
Is the pit located in a Sensitive Ground Water Area? <input type="checkbox"/> Yes <input type="checkbox"/> No		Chloride concentration: _____ mg/l <i>(For Emergency Pits and Settling Pits only)</i>	
Is the bottom below ground level? <input type="checkbox"/> Yes <input type="checkbox"/> No	Artificial Liner? <input type="checkbox"/> Yes <input type="checkbox"/> No	How is the pit lined if a plastic liner is not used?	
Pit dimensions (all but working pits): _____ Length (feet) _____ Width (feet) <input type="checkbox"/> N/A: Steel Pits Depth from ground level to deepest point: _____ (feet) <input type="checkbox"/> No Pit			
If the pit is lined give a brief description of the liner material, thickness and installation procedure.		Describe procedures for periodic maintenance and determining liner integrity, including any special monitoring.	
Distance to nearest water well within one-mile of pit: _____ feet    Depth of water well _____ feet		Depth to shallowest fresh water _____ feet. Source of information: <input type="checkbox"/> measured <input type="checkbox"/> well owner <input type="checkbox"/> electric log <input type="checkbox"/> KDWR	
<b>Emergency, Settling and Burn Pits ONLY:</b> Producing Formation: _____ Number of producing wells on lease: _____ Barrels of fluid produced daily: _____ Does the slope from the tank battery allow all spilled fluids to flow into the pit? <input type="checkbox"/> Yes <input type="checkbox"/> No		<b>Drilling, Workover and Haul-Off Pits ONLY:</b> Type of material utilized in drilling/workover: _____ Number of working pits to be utilized: _____ Abandonment procedure: _____ _____ Drill pits must be closed within 365 days of spud date.	
<b>Submitted Electronically</b>			

**KCC OFFICE USE ONLY** Liner     Steel Pit     RFAC     RFASDate Received: \_\_\_\_\_ Permit Number: \_\_\_\_\_ Permit Date: \_\_\_\_\_ Lease Inspection:  Yes  No

**CERTIFICATION OF COMPLIANCE WITH THE  
KANSAS SURFACE OWNER NOTIFICATION ACT**

*This form must be submitted with all Forms C-1 (Notice of Intent to Drill); CB-1 (Cathodic Protection Borehole Intent); T-1 (Request for Change of Operator Transfer of Injection or Surface Pit Permit); and CP-1 (Well Plugging Application). Any such form submitted without an accompanying Form KSONA-1 will be returned.*

Select the corresponding form being filed:  C-1 (Intent)  CB-1 (Cathodic Protection Borehole Intent)  T-1 (Transfer)  CP-1 (Plugging Application)

OPERATOR: License # \_\_\_\_\_

Well Location:

Name: \_\_\_\_\_

\_\_\_\_ - \_\_\_\_ - \_\_\_\_ - \_\_\_\_ Sec. \_\_\_\_ Twp. \_\_\_\_ S. R. \_\_\_\_  East  West

Address 1: \_\_\_\_\_

County: \_\_\_\_\_

Address 2: \_\_\_\_\_

Lease Name: \_\_\_\_\_ Well #: \_\_\_\_\_

City: \_\_\_\_\_ State: \_\_\_\_\_ Zip: \_\_\_\_\_ + \_\_\_\_\_

*If filing a Form T-1 for multiple wells on a lease, enter the legal description of the lease below:*

Contact Person: \_\_\_\_\_

Phone: ( \_\_\_\_\_ ) \_\_\_\_\_ Fax: ( \_\_\_\_\_ ) \_\_\_\_\_

Email Address: \_\_\_\_\_

**Surface Owner Information:**

Name: \_\_\_\_\_

*When filing a Form T-1 involving multiple surface owners, attach an additional sheet listing all of the information to the left for each surface owner. Surface owner information can be found in the records of the register of deeds for the county, and in the real estate property tax records of the county treasurer.*

Address 1: \_\_\_\_\_

Address 2: \_\_\_\_\_

City: \_\_\_\_\_ State: \_\_\_\_\_ Zip: \_\_\_\_\_ + \_\_\_\_\_

*If this form is being submitted with a Form C-1 (Intent) or CB-1 (Cathodic Protection Borehole Intent), you must supply the surface owners and the KCC with a plat showing the predicted locations of lease roads, tank batteries, pipelines, and electrical lines. The locations shown on the plat are preliminary non-binding estimates. The locations may be entered on the Form C-1 plat, Form CB-1 plat, or a separate plat may be submitted.*

**Select one of the following:**

- I certify that, pursuant to the Kansas Surface Owner Notice Act (House Bill 2032), I have provided the following to the surface owner(s) of the land upon which the subject well is or will be located: 1) a copy of the Form C-1, Form CB-1, Form T-1, or Form CP-1 that I am filing in connection with this form; 2) if the form being filed is a Form C-1 or Form CB-1, the plat(s) required by this form; and 3) my operator name, address, phone number, fax, and email address.
- I have not provided this information to the surface owner(s). I acknowledge that, because I have not provided this information, the KCC will be required to send this information to the surface owner(s). To mitigate the additional cost of the KCC performing this task, I acknowledge that I am being charged a \$30.00 handling fee, payable to the KCC, which is enclosed with this form.

*If choosing the second option, submit payment of the \$30.00 handling fee with this form. If the fee is not received with this form, the KSONA-1 form and the associated Form C-1, Form CB-1, Form T-1, or Form CP-1 will be returned.*

Submitted Electronically

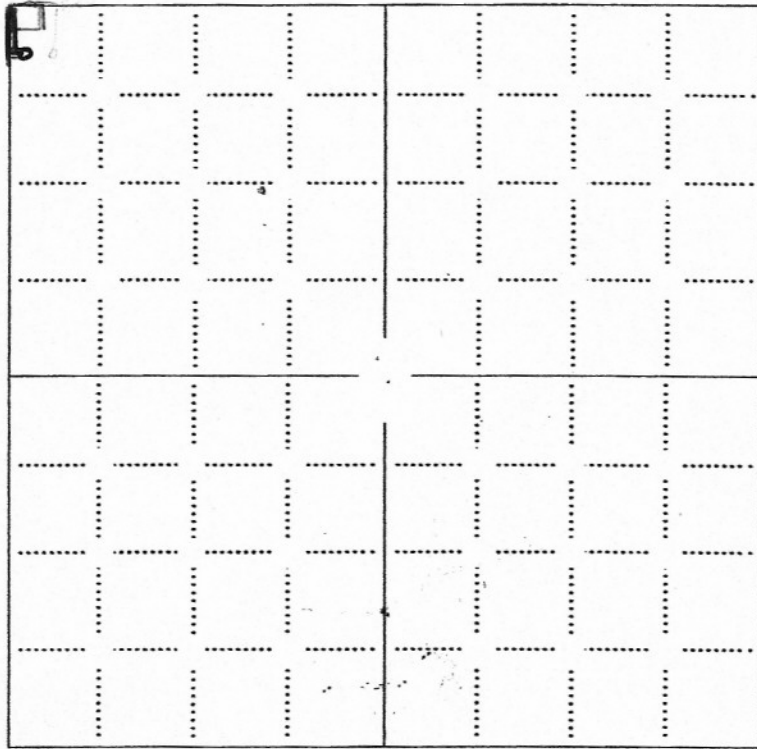

**LEGEND**

- Well Location
- Tank Battery Location
- Pipeline Location
- - - - Electric Line Location
- ▬ Lease Road Location

Form 88 - (PRODUCER'S SPECIAL) (PAID-UP)

63U (Rev. 1981)

OIL AND GAS LEASE

Register No. 09-118



AGREEMENT, Made and entered into the 29th day of July 2010 by and between The Evelyn L. Shriver Living Trust dated March 24, 1993, as re-stated June 12, 2002, and as amended July 19, 2006, by Evelyn L. Shriver, Initial Co-Trustee, OR TA 4 Taylor Avenue Augusta, KS 67010 WILLIAM K SHRIVER, CO-TRUSTEE WKS

whose mailing address is hereinafter called Lessor (whether one or more), and Marmik Oil Company, 200 N. Jefferson, Suite 500, El Dorado, Arkansas 71730 hereinafter called Lessee

Lessee, in consideration of Ten and More Dollars \$ 10.00 & More hereinafter called Consideration and of the royalties herein provided and of the covenants of the lease herein contained, hereby grants, leases and lets exclusively unto Lessee for the purpose of investigating, exploring, prospecting, drilling, mining and operating for and producing oil, liquid hydrocarbons, all gases, and their respective constituent products, including gas, water, other fluids, and air into subsurface strata, laying pipe lines, running out, building tanks, power stations, telephone lines, and other structures and things thereon to produce, store, take care of, treat, manufacture, process, store and transport said oil, liquid hydrocarbons, gases and their respective constituent products and other products manufactured therefrom, and housing and otherwise caring for its employees, the following described land, together with any reversionary rights and after-acquired interest, therein situated in County of Butler State of Kansas described as follows, to-wit:

Northeast Quarter (NE/4) of Section 25, Township 27 South, Range 7 East and Lots Five (5), Six (6), Seven (7), Eight (8) and Nine (9)

In Section 30 Township 27 South Range 8 East and containing 44.7 acres, more or less, and all accretions therein.

Subject to the provisions herein contained, this lease shall remain in force for a term of 18 months from this date to-wit: primary term, and so long thereafter as oil, liquid hydrocarbons, gas or other respective constituent products, or any of them, is produced from said land or land with which said land is pooled.

In consideration of the premises the said lease covenants and agrees: 1st. To deliver to the credit of Lessor, free of cost, in the pipeline in which Lessee may connect wells on said land, the equal one-eighth (1/8) part of all oil produced and saved from the leased premises. 2nd. To pay Lessee for gas of whatever nature or kind produced and sold, or used off the premises, or used in the manufacture of any products therefrom, one-eighth (1/8) at the market price at the well, fluid, as to gas sold by Lessee, in no event more than one-eighth (1/8) of the proceeds received by Lessee from such sales, for the gas sold, used off the premises, or in the manufacture of products therefrom, said payments to be made monthly. Where gas from a well producing gas only is not sold or used, Lessee may pay or tender as royalty One Dollar (\$1.00) per acre per net mineral acre retained hereunder, and if such payment or tender is made it will be considered that gas is being produced within the meaning of the preceding paragraph.

This lease may be maintained during the primary term hereof without further payment or drilling operations. If the Lessee shall commence to drill a well within the term of this lease or any extension thereof, the Lessee shall have the right to drill such well in conjunction with reasonable diligence and dispatch, and if all or any, or either of them, be found in paying quantities, this lease shall continue and be in force with like effect as if such well had been completed within the term of years first mentioned.

If said Lessee owns a less interest in the above described land than the entire and undivided fee simple estate therein, then the royalties herein provided for shall be paid the said Lessor only in the proportion which Lessee's interest bears to the whole and undivided fee.

Lessee shall have the right to use, free of cost, gas, oil and water produced on said land for Lessee's operation thereon, except water from the wells of Lessor.

When reticulated by Lessor, Lessee shall bury Lessee's pipe lines below plow depth.

No well shall be drilled nearer than 200 feet to the house or barn now on said premises without written consent of Lessor.

Lessee shall pay for damages caused by Lessee's operations on said land.

Lessee shall have the right at any time to remove all machinery and fixtures placed on said premises, including the right to draw and remove casing.

If the estate of either party hereto is assigned, and the performance of assigning in whole or in part is expressly allowed, the covenants hereof shall extend to their heirs, executors, administrators, successors or assigns, but no change in the ownership of the land or assignment of rentals or royalties shall be binding on the Lessee until after the Lessee has been furnished with a written transfer or assignment or a true copy thereof. In case Lessee assigns this lease, in whole or in part, Lessor shall be relieved of all obligations with respect to the assigned portion or portions arising subsequent to the date of assignment.

Lessee may at any time execute and deliver to Lessor, or place of record a release or releases covering any portion or portions of the above described premises and thereby surrender this lease as to such portion or portions and be relieved of all obligations as in the aforesaid surrendered.

All express or implied covenants of this lease shall be subject to all Federal and State Laws, Executive Orders, Rules or Regulations, and this lease shall not be terminated, in whole or in part, nor Lessee held liable in damages for failure to comply therewith, if compliance is prevented by, or if such failure is the result of, any such Law, Order, Rule or Regulation.

Lessee hereby warrants and agrees to defend the title to the lands herein described, and agrees that the Lessee shall have the right at any time in redem for Lessor, by payment any mortgages, loans or other liens on the above described lands, in the event of default of payment by Lessor, and be subrogated to the rights of the holder thereof, and the undersigned Lessor, for themselves and their heirs, successors and assigns, hereby surrender and release all right, of dower and homestead in the premises described herein, in as far as said right of dower and homestead may in any way affect the purposes for which this lease is made, as recited herein.

Lessee, at its option, is hereby given the right and power to pool or combine the acreage covered by this lease or any portion thereof with other land, lease or leases in the immediate vicinity thereof, when in Lessee's judgment it is necessary or advisable to do so in order to properly develop and operate said lease premises so as to promote the conservation of oil, gas or other minerals in and under and that may be produced from said premises, such pooling to be of units contiguous to one another and to be into a unit or units not exceeding 40 acres each in the event of an oil well, or into a unit or units not exceeding 80 acres each in the event of a gas well. Lessee shall execute in writing and record in the appropriate records of the county in which the land herein leased is situated an instrument identifying and describing the pooled acreage. The entire acreage so pooled into a unit or units shall be treated, for all purposes except the payment of royalties on production from the pooled unit, as if it were included in this lease. If production is found on the pooled acreage, it shall be treated as if production in and from this lease, whether the well or wells be located on the premises covered by this lease or not. In lieu of the royalties elsewhere herein specified, Lessor shall receive on production from a unit so pooled only such portion of the royalty stipulated herein as the amount of his acreage placed in the unit or his royalty interest therein on an acreage basis bears to the total acreage so pooled in the particular unit involved.

See Exhibit "A" attached hereto and made a part hereof.

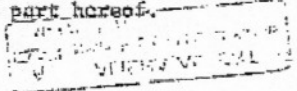

BUTLER COUNTY, KS REGISTER OF DEEDS Marcia McCoy Book: 2011 Page: 8015 Receipt #: 64993 Total Fees: \$16.00 Pages Recorded: 3 Date Recorded: 8/4/2010 11:10:36 AM

IN WITNESS WHEREOF, the undersigned execute this instrument as of the day and year first above written THE EVELYN L. SHRIVER LIVING TRUST DATED MARCH 24, 1993, AS RE-STATED JUNE 12, 2002, AND AS AMENDED JULY 19, 2006

By: Evelyn L. Shriver, Initial Co-Trustee OR WILLIAM K SHRIVER, CO-TRUSTEE Tax I.D. No.: 470-44-5972

PLEASE RETURN TO: BRUCE B. ELLEN 300 W. Douglas, Ste. 1000 Wichita, KS 67202

REC. COMP. NUM. 12/1/10

---

**EXHIBIT 'A'**

---

Attached-to and made a part of that certain Oil and Gas Lease dated July 29, 2010, by and between The Evelyn L. Shriver Living Trust dated March 24, 1993, as re-stated June 12, 2002, and as amended July 19, 2006, by Evelyn L. Shriver, Initial Co-Trustee, Lessor, and Marmik Oil Company, Lessee.

1. Lessee or its assigns agree to use existing roadways, or to otherwise consult with Lessor as to route of ingress and egress on the leased premises. If tank batteries are placed on the leased premises, Lessee or its assigns shall obtain permission from Lessor as to their location. Permission from Lessor will not be unreasonably withheld.
2. Lessee or its assigns agree that any water used for drilling operations that come from the leased premises shall be negotiated for and agreed upon with Lessor prior to drilling operations.
3. In the event drilling operations are conducted on the leased premises, all trash and flagging materials shall be removed upon completion of operations.
4. Lessee or its assigns agree that in the event of drilling operations to restore the surface of the land to its original contour and condition as nearly as is reasonably practicable including the one-time reseeded of native grass mix, and to pay for damages caused by its operations. All topsoil shall be piled separately and returned to the surface when the pits are filled, which pits shall not be filled until they are sufficiently dry.
5. If the leased premises is subject to pasturing livestock, Lessee or its assigns agree to properly fence all drilling pits and afterwards to fence the equipment in the event of continuing production operations.

**SIGNED FOR IDENTIFICATION:**

The Evelyn L. Shriver Living Trust dated  
March 24, 1993, as re-stated June 12,  
2002, and as amended July 19, 2006

By: *Evelyn L. Shriver*  
Evelyn L. Shriver, Initial Co-Trustee

STATE OF KANSAS  
COUNTY OF BUTLER

ACKNOWLEDGMENT FOR INDIVIDUAL (KsOkCoNe)

The foregoing instrument was acknowledged before me this 2nd day of AUGUST, 2010,  
by Evelyn L. Shriver, Initial Co-Trustee of The Evelyn L. Shriver Living Trust dated  
March 24, 1993, as re-stated June 12, 2002, and as amended July 19, 2006

My commission expires 11/30/10

Alisha Albert  
Notary Public

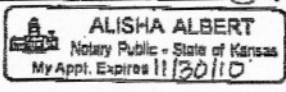

STATE OF Kansas  
COUNTY OF BUTLER

ACKNOWLEDGMENT FOR INDIVIDUAL (KsOkCoNe)

The foregoing instrument was acknowledged before me this 2nd day of AUGUST, 2010,  
by WILLIAM K. SHRIVER, CO-TRUSTEE OF THE EVELYN L. SHRIVER LIVING TRUST  
dated March 24, 1993, as re-stated June 12, 2002, and as amended July 19, 2006

My commission expires 11/30/10

Alisha Albert  
Notary Public

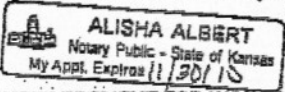

STATE OF \_\_\_\_\_  
COUNTY OF \_\_\_\_\_

ACKNOWLEDGMENT FOR INDIVIDUAL (KsOkCoNe)

The foregoing instrument was acknowledged before me this \_\_\_\_\_ day of \_\_\_\_\_, 19\_\_\_\_,  
by \_\_\_\_\_ and \_\_\_\_\_

My commission expires \_\_\_\_\_

Notary Public

STATE OF \_\_\_\_\_  
COUNTY OF \_\_\_\_\_

ACKNOWLEDGMENT FOR INDIVIDUAL (KsOkCoNe)

The foregoing instrument was acknowledged before me this \_\_\_\_\_ day of \_\_\_\_\_, 19\_\_\_\_,  
by \_\_\_\_\_ and \_\_\_\_\_

My commission expires \_\_\_\_\_

Notary Public

No. \_\_\_\_\_  
OIL AND GAS LEASE

FROM

TO

Date \_\_\_\_\_, 19\_\_\_\_

Section \_\_\_\_\_ Twp. \_\_\_\_\_ Rge. \_\_\_\_\_

No. of Acres \_\_\_\_\_ Term \_\_\_\_\_

County \_\_\_\_\_

STATE OF \_\_\_\_\_

County \_\_\_\_\_

This instrument was filed for record on the \_\_\_\_\_

day of \_\_\_\_\_, 19\_\_\_\_

at \_\_\_\_\_ o'clock \_\_\_\_\_ M., and duly recorded

in Book \_\_\_\_\_ Page \_\_\_\_\_ of \_\_\_\_\_

the records of this office.

By \_\_\_\_\_

Registrar of Deeds.

When recorded, return to \_\_\_\_\_

STATE OF \_\_\_\_\_  
COUNTY OF \_\_\_\_\_

ACKNOWLEDGMENT FOR CORPORATION (KsOkCoNe)

The foregoing instrument was acknowledged before me this \_\_\_\_\_ day of \_\_\_\_\_, 19\_\_\_\_,  
by \_\_\_\_\_

of \_\_\_\_\_ a \_\_\_\_\_  
corporation, on behalf of the corporation.

My commission expires \_\_\_\_\_

Notary Public



## Summary of Changes

Lease Name and Number: SHRIVER 1

API/Permit #: 15-015-23864-00-00

Doc ID: 1041469

Correction Number: 1

Approved By: Rick Hestermann 05/11/2010

Field Name	Previous Value	New Value
Feet to Nearest Water Well Within One-Mile of Pit	N/A	n/a
KCC Only - Date Received	05/11/2010	08/09/2010
KCC Only - Production Comment		Oil & Gas lease submitted.
KCC Only - Regular Section Quarter Calls	NW NW NW	W2 NW NW NW
KSONA Contact Fax Area Code		918
KSONA Contact Person		James Haver
KSONA Contact Phone Area Code		918
KSONA Contact Phone Number		291-3200
KSONA Fax Number		291-3220
Kansas Surface Owner Notification Act Certification		Yes

Summary of changes for correction 1 continued

Field Name	Previous Value	New Value
LocationInfoLink	<a href="https://solar.kgs.ku.edu/kcc/detail/locationInformation.cfm?section=30&amp;t330">https://solar.kgs.ku.edu/kcc/detail/locationInformation.cfm?section=30&amp;t330</a>	<a href="https://solar.kgs.ku.edu/kcc/detail/locationInformation.cfm?section=30&amp;t265">https://solar.kgs.ku.edu/kcc/detail/locationInformation.cfm?section=30&amp;t265</a>
Number of Feet East or West From Section Line	330	265
Number of Feet East or West From Section Line	330	265
Save Link	<a href="../../kcc/detail/operatorEditDetail.cfm?docID=1037969">../../kcc/detail/operatorEditDetail.cfm?docID=1037969</a>	<a href="../../kcc/detail/operatorEditDetail.cfm?docID=1041469">../../kcc/detail/operatorEditDetail.cfm?docID=1041469</a>
Surface Owner Address Line 1		4 Taylor Avenue
Surface Owner City		Augusta
Surface Owner Name		Evelyn & William Shriver
Surface Owner State Name		KS
Surface Owner Zip		67010

## Summary of Attachments

Lease Name and Number: SHRIVER 1

API: 15-015-23864-00-00

Doc ID: 1041469

Correction Number: 1

Approved By: Rick Hestermann 05/11/2010

Attachment Name