

Proposed Plan of Construction
Hicks D-1
Sec 9-T25S-R32W
Finney Co, KS

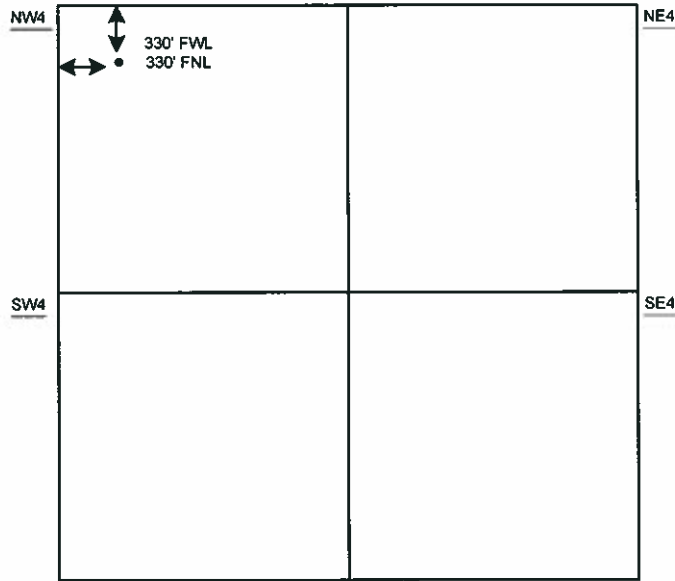

Sec 9 - T25S - R32W

Production Facilities for the Hicks D-1 will be located in the NW corner of the NW quarter.

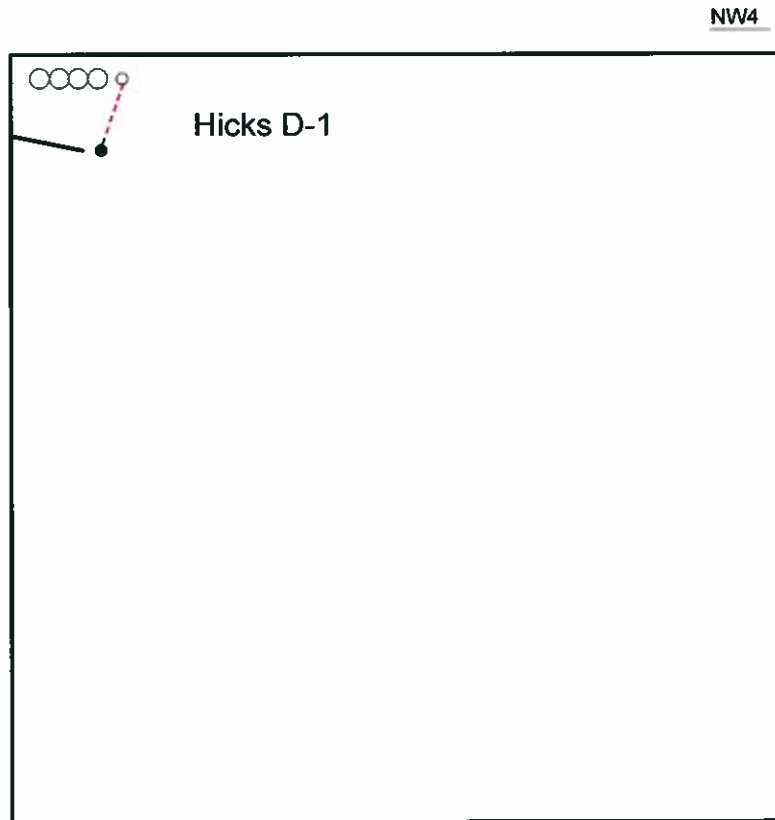

Detail of
NW4 Sec 9-T25S-R32W

- Well Location
- Lease Road
- - - Proposed Pipeline
- Tank Battery Equipment

Note-Drawing **Not** to Scale

Site Diagram
Hicks D-1
Aug. 2, 2010

