

ADVANTAGE ELEVATIONS

OIL FIELD SURVEYORS

BOX 8604 - PRATT, KS 67124
(620) 672-6491

804101
INVOICE NO.

R & B OIL & GAS, INC.

OPERATOR

1

NO

Schwartz "A"

FARM

Barber

COUNTY

22

S

34s

T

10w

R

SE SE NW

LOCATION

ELEVATION ... 1346 GR

R & B OIL & GAS, INC.
PO BOX 195
Attica, KS 67009-0195



AUTHORIZED BY: Randy Newberry

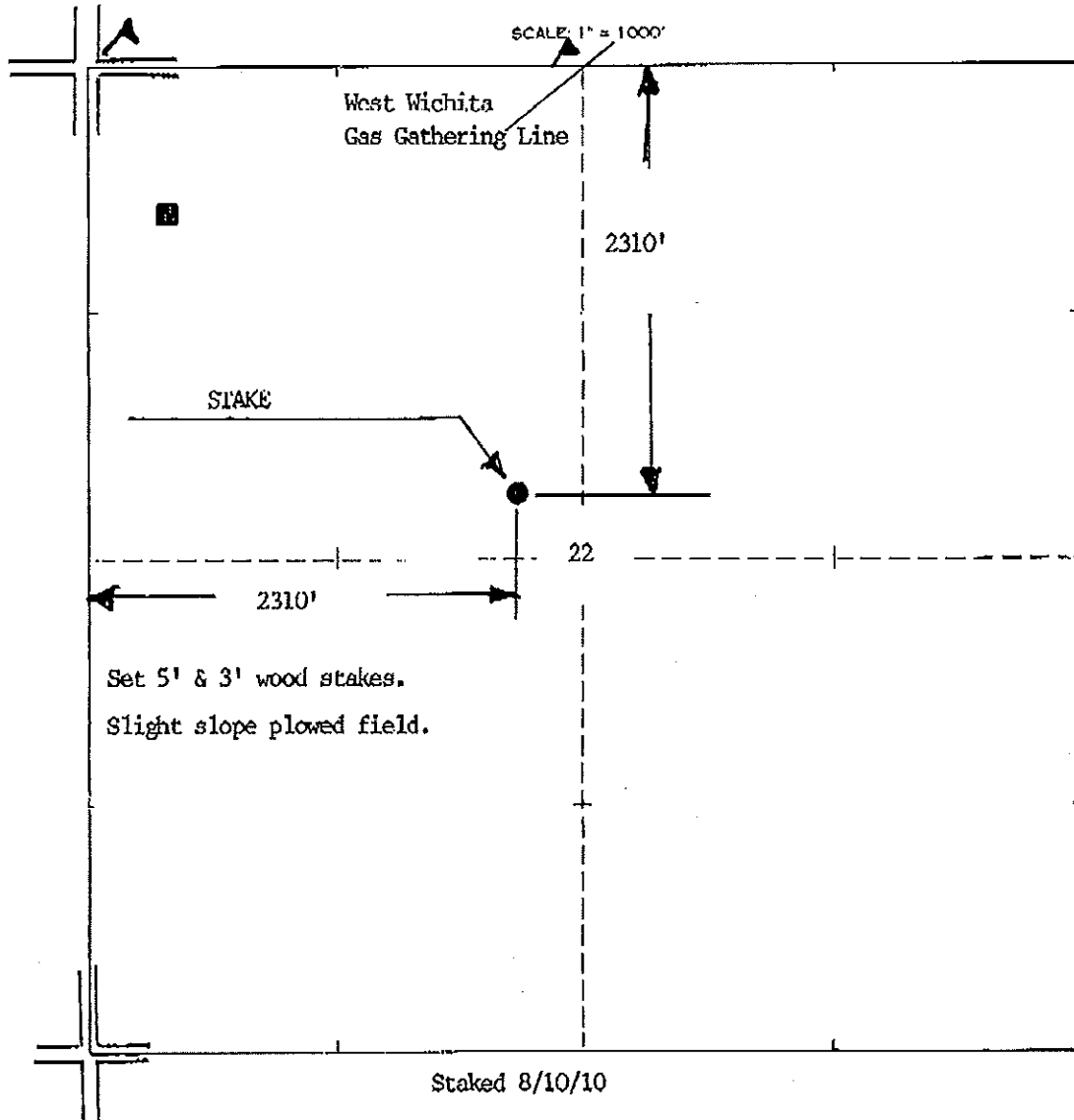

Hazelton

T O N

SCHWARTZ A #1

22

