

OPERATOR : Samuel Gary Jr & Associates, Inc 1515 Wynkoop Street, Suite 700
Denver, Colorado 80202 office :303-831-4673 ; fax :303-863-7285
WELL NAME : SCHUMACHER-DREILING 1-1

LOCATION : 2500 FNL / 1460 FWL Sec. 1-15S-17W ELLIS COUNTY

SURFACE OWNER : Marion Schumacher
1877 Kazan St
Hays, Kansas 67601

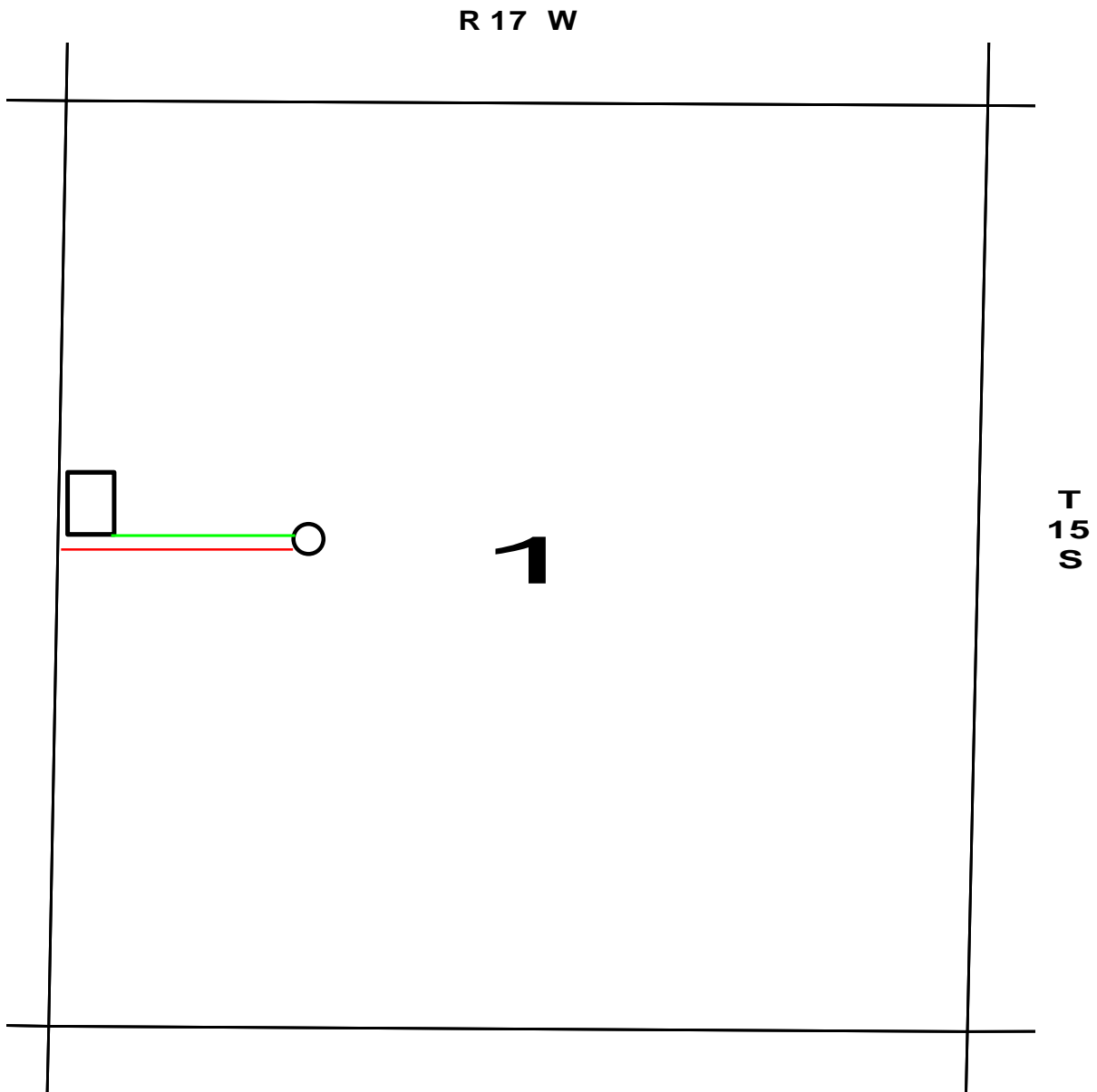

○ PROPOSED WELL LOCATION

□ ESTIMATED LOCATION OF TANK BATTERY

— ESTIMATED LOCATION OF FLOW LINES

— ESTIMATED LOCATION OF ELECTRICAL LINES