



For KCC Use:
Effective Date:
District #
SGA? Yes No

KANSAS CORPORATION COMMISSION 1044127
OIL & GAS CONSERVATION DIVISION

Form C-1
March 2010

Form must be Typed
Form must be Signed
All blanks must be Filled

NOTICE OF INTENT TO DRILL

Must be approved by KCC five (5) days prior to commencing well

Form KSONA-1, Certification of Compliance with the Kansas Surface Owner Notification Act, MUST be submitted with this form.

Expected Spud Date: month day year

OPERATOR: License#
Name:
Address 1:
Address 2:
City: State: Zip:
Contact Person:
Phone:
CONTRACTOR: License#
Name:

Well Drilled For: Oil, Gas, Seismic, Other
Well Class: Enh Rec, Storage, Disposal, Infield, Pool Ext, Wildcat, Other
Type Equipment: Mud Rotary, Air Rotary, Cable
Operator:
Well Name:
Original Completion Date: Original Total Depth:

Directional, Deviated or Horizontal wellbore?
If Yes, true vertical depth:
Bottom Hole Location:
KCC DKT #:

Spot Description:
Sec. Twp. S. R.
feet from N / S Line of Section
feet from E / W Line of Section
Is SECTION: Regular Irregular?
(Note: Locate well on the Section Plat on reverse side)

County:
Lease Name: Well #:
Field Name:
Is this a Prorated / Spaced Field?
Target Formation(s):
Nearest Lease or unit boundary line (in footage):
Ground Surface Elevation: feet MSL
Water well within one-quarter mile:
Public water supply well within one mile:
Depth to bottom of fresh water:
Depth to bottom of usable water:
Surface Pipe by Alternate: I II
Length of Surface Pipe Planned to be set:
Length of Conductor Pipe (if any):
Projected Total Depth:
Formation at Total Depth:
Water Source for Drilling Operations:
DWR Permit #:
Will Cores be taken?
If Yes, proposed zone:

AFFIDAVIT

The undersigned hereby affirms that the drilling, completion and eventual plugging of this well will comply with K.S.A. 55 et. seq.
It is agreed that the following minimum requirements will be met:
1. Notify the appropriate district office prior to spudding of well;
2. A copy of the approved notice of intent to drill shall be posted on each drilling rig;
3. The minimum amount of surface pipe as specified below shall be set by circulating cement to the top; in all cases surface pipe shall be set through all unconsolidated materials plus a minimum of 20 feet into the underlying formation.
4. If the well is dry hole, an agreement between the operator and the district office on plug length and placement is necessary prior to plugging;
5. The appropriate district office will be notified before well is either plugged or production casing is cemented in;
6. If an ALTERNATE II COMPLETION, production pipe shall be cemented from below any usable water to surface within 120 DAYS of spud date. Or pursuant to Appendix "B" - Eastern Kansas surface casing order #133,891-C, which applies to the KCC District 3 area, alternate II cementing must be completed within 30 days of the spud date or the well shall be plugged. In all cases, NOTIFY district office prior to any cementing.

Submitted Electronically

For KCC Use ONLY
API # 15 -
Conductor pipe required feet
Minimum surface pipe required feet per ALT. I II
Approved by:
This authorization expires:
(This authorization void if drilling not started within 12 months of approval date.)
Spud date: Agent:

Remember to:

- File Certification of Compliance with the Kansas Surface Owner Notification Act (KSONA-1) with Intent to Drill;
- File Drill Pit Application (form CDP-1) with Intent to Drill;
- File Completion Form ACO-1 within 120 days of spud date;
- File acreage attribution plat according to field proration orders;
- Notify appropriate district office 48 hours prior to workover or re-entry;
- Submit plugging report (CP-4) after plugging is completed (within 60 days);
- Obtain written approval before disposing or injecting salt water.
- If well will not be drilled or permit has expired (See: authorized expiration date) please check the box below and return to the address below.

Well will not be drilled or Permit Expired Date:
Signature of Operator or Agent:

E
W



1044127

For KCC Use ONLY

API # 15 - _____

IN ALL CASES PLOT THE INTENDED WELL ON THE PLAT BELOW

In all cases, please fully complete this side of the form. Include items 1 through 5 at the bottom of this page.

Operator: _____

Lease: _____

Well Number: _____

Field: _____

Number of Acres attributable to well: _____

QTR/QTR/QTR/QTR of acreage: _____ - _____ - _____ - _____

Location of Well: County: _____

_____ feet from N / S Line of Section

_____ feet from E / W Line of Section

Sec. _____ Twp. _____ S. R. _____ E W

Is Section: Regular or Irregular

If Section is Irregular, locate well from nearest corner boundary.

Section corner used: NE NW SE SW

PLAT

Show location of the well. Show footage to the nearest lease or unit boundary line. Show the predicted locations of lease roads, tank batteries, pipelines and electrical lines, as required by the Kansas Surface Owner Notice Act (House Bill 2032). You may attach a separate plat if desired.

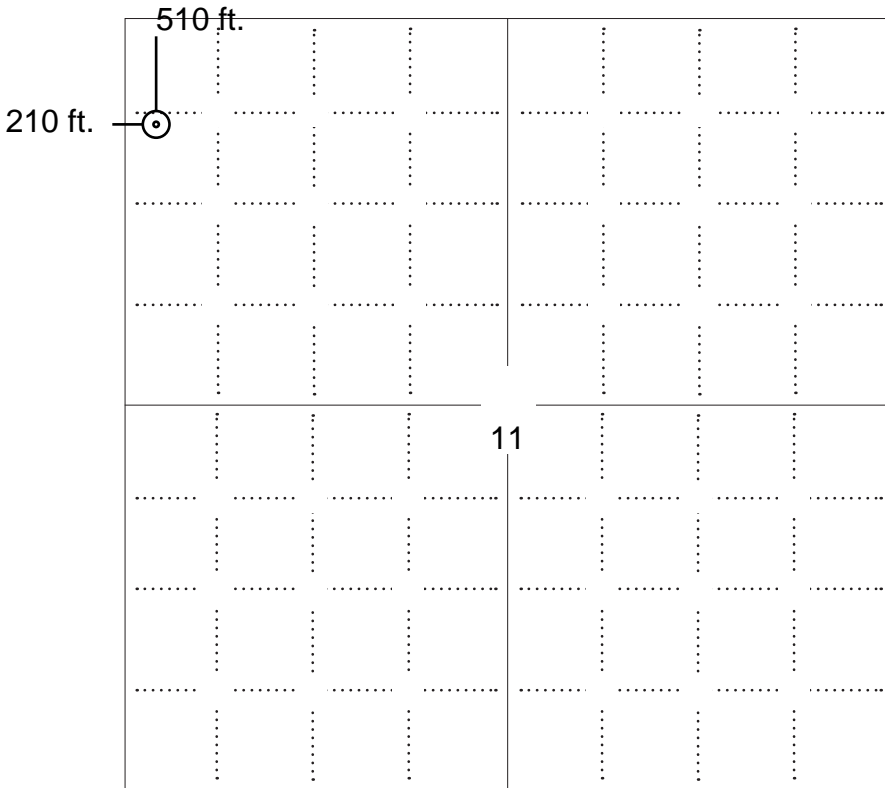

LEGEND

- Well Location
- Tank Battery Location
- Pipeline Location
- Electric Line Location
- Lease Road Location

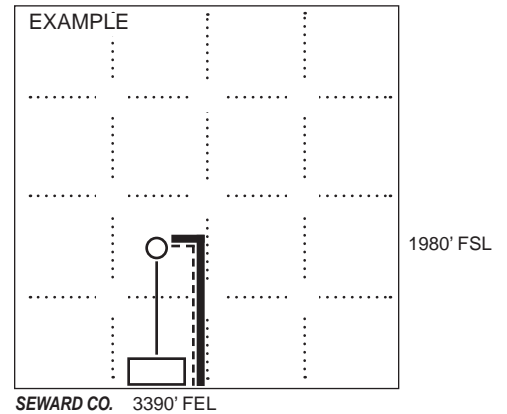

NOTE: In all cases locate the spot of the proposed drilling locaton.

In plotting the proposed location of the well, you must show:

- The manner in which you are using the depicted plat by identifying section lines, i.e. 1 section, 1 section with 8 surrounding sections, 4 sections, etc.
- The distance of the proposed drilling location from the south / north and east / west outside section lines.
- The distance to the nearest lease or unit boundary line (in footage).
- If proposed location is located within a prorated or spaced field a certificate of acreage attribution plat must be attached: (C0-7 for oil wells; CG-8 for gas wells).
- The predicted locations of lease roads, tank batteries, pipelines, and electrical lines.



KANSAS CORPORATION COMMISSION 1044127
OIL & GAS CONSERVATION DIVISION

Form CDP-1
May 2010
Form must be Typed

APPLICATION FOR SURFACE PIT

Submit in Duplicate

| | | | |
|---|--|--|--|
| Operator Name: | | License Number: | |
| Operator Address: | | | |
| Contact Person: | | Phone Number: | |
| Lease Name & Well No.: | | Pit Location (QQQQ): ____ - ____ - ____ - ____ | |
| Type of Pit: <input type="checkbox"/> Emergency Pit <input type="checkbox"/> Burn Pit <input type="checkbox"/> Settling Pit <input type="checkbox"/> Drilling Pit <input type="checkbox"/> Workover Pit <input type="checkbox"/> Haul-Off Pit <i>(If WP Supply API No. or Year Drilled)</i> | | Pit is: <input type="checkbox"/> Proposed <input type="checkbox"/> Existing If Existing, date constructed: _____ Pit capacity: _____ (bbls) | |
| Is the pit located in a Sensitive Ground Water Area? <input type="checkbox"/> Yes <input type="checkbox"/> No | | Chloride concentration: _____ mg/l <i>(For Emergency Pits and Settling Pits only)</i> | |
| Is the bottom below ground level? <input type="checkbox"/> Yes <input type="checkbox"/> No | | Artificial Liner? <input type="checkbox"/> Yes <input type="checkbox"/> No | |
| How is the pit lined if a plastic liner is not used? | | | |
| Pit dimensions (all but working pits): _____ Length (feet) _____ Width (feet) <input type="checkbox"/> N/A: Steel Pits Depth from ground level to deepest point: _____ (feet) <input type="checkbox"/> No Pit | | | |
| If the pit is lined give a brief description of the liner material, thickness and installation procedure. | | Describe procedures for periodic maintenance and determining liner integrity, including any special monitoring. | |
| Distance to nearest water well within one-mile of pit: _____ feet Depth of water well _____ feet | | Depth to shallowest fresh water _____ feet. Source of information: <input type="checkbox"/> measured <input type="checkbox"/> well owner <input type="checkbox"/> electric log <input type="checkbox"/> KDWR | |
| Emergency, Settling and Burn Pits ONLY: Producing Formation: _____ Number of producing wells on lease: _____ Barrels of fluid produced daily: _____ Does the slope from the tank battery allow all spilled fluids to flow into the pit? <input type="checkbox"/> Yes <input type="checkbox"/> No | | Drilling, Workover and Haul-Off Pits ONLY: Type of material utilized in drilling/workover: _____ Number of working pits to be utilized: _____ Abandonment procedure: _____ _____ Drill pits must be closed within 365 days of spud date. | |
| <p>Submitted Electronically</p> | | | |

| | | | |
|----------------------------|--|---|--|
| KCC OFFICE USE ONLY | | | |
| | | <input type="checkbox"/> Liner <input type="checkbox"/> Steel Pit <input type="checkbox"/> RFAC <input type="checkbox"/> RFAS | |
| Date Received: _____ | | Permit Number: _____ | |
| | | Permit Date: _____ Lease Inspection: <input type="checkbox"/> Yes <input type="checkbox"/> No | |



CERTIFICATION OF COMPLIANCE WITH THE KANSAS SURFACE OWNER NOTIFICATION ACT

This form must be submitted with all Forms C-1 (Notice of Intent to Drill); CB-1 (Cathodic Protection Borehole Intent); T-1 (Request for Change of Operator Transfer of Injection or Surface Pit Permit); and CP-1 (Well Plugging Application). Any such form submitted without an accompanying Form KSONA-1 will be returned.

Select the corresponding form being filed: C-1 (Intent) CB-1 (Cathodic Protection Borehole Intent) T-1 (Transfer) CP-1 (Plugging Application)

OPERATOR: License # _____
Name: _____
Address 1: _____
Address 2: _____
City: _____ State: _____ Zip: _____ + _____
Contact Person: _____
Phone: (_____) _____ Fax: (_____) _____
Email Address: _____

Well Location:
____ - ____ - ____ - ____ Sec. ____ Twp. ____ S. R. ____ East West
County: _____
Lease Name: _____ Well #: _____

If filing a Form T-1 for multiple wells on a lease, enter the legal description of the lease below:

Surface Owner Information:

Name: _____
Address 1: _____
Address 2: _____
City: _____ State: _____ Zip: _____ + _____

When filing a Form T-1 involving multiple surface owners, attach an additional sheet listing all of the information to the left for each surface owner. Surface owner information can be found in the records of the register of deeds for the county, and in the real estate property tax records of the county treasurer.

If this form is being submitted with a Form C-1 (Intent) or CB-1 (Cathodic Protection Borehole Intent), you must supply the surface owners and the KCC with a plat showing the predicted locations of lease roads, tank batteries, pipelines, and electrical lines. The locations shown on the plat are preliminary non-binding estimates. The locations may be entered on the Form C-1 plat, Form CB-1 plat, or a separate plat may be submitted.

Select one of the following:

- I certify that, pursuant to the Kansas Surface Owner Notice Act (House Bill 2032), I have provided the following to the surface owner(s) of the land upon which the subject well is or will be located: 1) a copy of the Form C-1, Form CB-1, Form T-1, or Form CP-1 that I am filing in connection with this form; 2) if the form being filed is a Form C-1 or Form CB-1, the plat(s) required by this form; and 3) my operator name, address, phone number, fax, and email address.
- I have not provided this information to the surface owner(s). I acknowledge that, because I have not provided this information, the KCC will be required to send this information to the surface owner(s). To mitigate the additional cost of the KCC performing this task, I acknowledge that I am being charged a \$30.00 handling fee, payable to the KCC, which is enclosed with this form.

If choosing the second option, submit payment of the \$30.00 handling fee with this form. If the fee is not received with this form, the KSONA-1 form and the associated Form C-1, Form CB-1, Form T-1, or Form CP-1 will be returned.

I Submitted Electronically

I

TATE OF KANSAS } ss:
County of Clark
This instrument filed for record this
11th day of Oct 2001
2:32 o'clock P. M. and
recorded in Book 126 Page 7
Fees \$ 10.00
Melissa L. Young, Registrar of Deeds

(Prod. Pooling)(Kansas, Oklahoma)(640 Shut-In)(Paid-Up)

OIL AND GAS LEASE
(Paid-up)

AGREEMENT, made and entered into this 26th day of September, 2001, by and between, Giles Ranch Company, a Kansas limited partnership, P. O. Box 1000, Ashland, KS 67831, party of the first part, hereinafter called Lessor (whether one or more), and Wint Harris, P. O. Box 489, Elkhart, KS 67950, party of the second part, hereinafter called Lessee.

WITNESSETH, that the said Lessor, for and in consideration of Ten Dollars, cash in hand paid, and other good and valuable consideration receipt of which is hereby acknowledged and of the covenants and agreements hereinafter contained on the part of Lessee to be paid, kept and performed, has granted, demised, leased and let and by these presents does exclusively grant, demise, lease and let unto the said Lessee, for the sole and only purpose of exploring by geophysical and other methods, mining and operating for oil (including but not limited to distillate and condensate), gas (including casinghead gas and helium and all other constituents), and for laying pipelines, and building tanks, power stations and structures thereon, to produce, save and take care of said products, all that certain tract of land, together with any reversionary rights therein, situated in the County of Clark, State of Kansas, described as follows, to-wit:

The West Half of the Northwest Quarter (W/2 NW/4) and the Northwest Quarter of the Southwest Quarter (NW/4 SW/4) of Section 11, Township 31 South, Range 22 West. Containing 120.00 acres more or less.

1. It is agreed that this lease shall remain in force for a term of Three (3) years from date (herein called primary term) and so long thereafter as oil or gas, or either of them, is produced from said land or lands pooled therewith
2. In consideration of the premises the said Lessee covenants and agrees:
 - A. To deliver to the credit of Lessor free of cost, in the pipeline to which it may connect its wells, a 1/8th part of all oil (including but not limited to condensate and distillate) produced and saved from the leased premises.
 - B. To pay Lessor for gas (including casinghead gas) and all other substances covered hereby, a royalty of 1/8th of the proceeds realized by Lessee from the sale thereof, less a proportionate part of the production, severance and other excise taxes and the cost incurred by lessee in producing, compressing, dehydrating, transporting, and marketing, or otherwise making such gas or other substances ready for sale or use, said payments to be made monthly. During any period (whether before or after expiration of the primary term hereof) when gas is not being so sold or used and the well or wells are shut in and there is no current production of oil or operations on said leased premises sufficient to keep this lease in force, Lessee shall pay or tender a royalty of One Dollar (\$1.00) per year per net royalty acre retained hereunder, such payment or tender to be made, on or before the later of ninety (90) days following the date of shut in or the anniversary date of this lease during the period such well is shut in, to the Lessor. When such payment or tender is made it will be considered that gas is being produced within the meaning of the entire lease.
3. If, at the expiration of the primary term, there is no production in paying quantities on the leased land or on lands pooled therewith but Lessee is conducting operations for drilling, completing or reworking a well, this lease nevertheless shall continue as long as such operations are prosecuted or additional operations are commenced and prosecuted (whether on the same or successive wells) with no cessation of more than one hundred eighty (180) days, and if production is discovered, this lease shall continue as long thereafter as oil or gas are produced. In addition, if at any time or times after the primary term, there is a total cessation of all production, for any cause (other than an event of force majeure), this lease shall not terminate if Lessee commences or resumes any drilling or reworking operations or production within one hundred eighty (180) days after such cessation. Drilling operations or mining operations shall be deemed to be commenced when the first material is placed on the leased premises or when the first work other than surveying or staking the location is done thereon which is necessary for such operations.
4. Lessee is hereby granted the right at any time and from time to time to unitize the leased premises or any portion or portions thereof, as to all strata or any stratum or strata, with any other lands as to all strata or any stratum or strata, for the production primarily of oil or primarily of gas with or without distillate. However, no unit for the production primarily of oil shall embrace more than 160 acres, or for the production primarily of gas with or without distillate more than 640 acres; provided that if any governmental regulation shall permit or prescribe a spacing pattern for the development of the field or allocate a producing allowable based on acreage per well, then any such unit may embrace as much additional acreage as may be so permitted or prescribed or as may be used in such allocation of allowable. Lessee shall file written unit designations in the county in which the leased premises are located unless the pooling or unitization results from governmental order or rule, in which case no such written designation shall be required. Operations upon and production from the unit shall be treated as if such operations were upon or such production were from the leased premises whether or not the well or wells are located thereon. The entire acreage within a unit shall be treated for all purposes as if it were covered by and included in this lease except that the royalty on production from the unit shall be as below provided, and except that in calculating the amount of any shut in gas royalties, only the part of the acreage originally leased and then actually embraced by this lease shall be counted. In respect to production from the unit, Lessee shall pay Lessor, in lieu of other royalties thereon, only such proportion of the royalties stipulated herein as the amount of his acreage placed in the unit, or his royalty interest therein on an acreage basis bears to the total acreage in the unit.
5. If said Lessor owns a less interest in the above described land than the entire and undivided fee simple estate therein, then the royalties herein provided shall be paid to the Lessor only in the proportion which his interest bears to the whole and undivided fee.

STATE OF KANSAS } SS:
County of Clark
This instrument filed for record this
30th day of April, 2004
2:00 o'clock P.M. and
recorded in Book 129 Page 395
Fees \$ 20.00
Melissa L. Young, Register of Deeds

(Prod. Pooling)(Kansas, Oklahoma)(640 Shut-In)(Paid-Up)

OIL AND GAS LEASE
(Paid-up)

AGREEMENT, made and entered into this 19th day of November, 2004, by and between, Giles Ranch Company, a Partnership, P. O. Box 1000, Ashland, KS 67831, party of the first part, hereinafter called Lessor (whether one or more), and Wint Harris, P. O. Box 489, Elkhart, KS 67950, party of the second part, hereinafter called Lessee.

WITNESSETH, that the said Lessor, for and in consideration of Ten Dollars, cash in hand paid, and other good and valuable consideration receipt of which is hereby acknowledged and of the covenants and agreements hereinafter contained on the part of Lessee to be paid, kept and performed, has granted, demised, leased and let and by these presents does exclusively grant, demise, lease and let unto the said Lessee, for the sole and only purpose of exploring by geophysical and other methods, mining and operating for oil (including but not limited to distillate and condensate), gas (including casinghead gas and helium and all other constituents), and for laying pipelines, and building tanks, power stations and structures thereon, to produce, save and take care of said products, all that certain tract of land, together with any reversionary rights therein, situated in the County of Clark, State of Kansas, described as follows, to-wit:

The Northeast Quarter (NE/4) of Section 10, Township 31 South, Range 22 West.
Containing 160.00 acres more or less.

1. It is agreed that this lease shall remain in force for a term of Three (3) years from date (herein called primary term) and so long thereafter as oil or gas, or either of them, is produced from said land or lands pooled therewith
2. In consideration of the premises the said Lessee covenants and agrees:
 - A. To deliver to the credit of Lessor free of cost, in the pipeline to which it may connect its wells, a 1/8th part of all oil (including but not limited to condensate and distillate) produced and saved from the leased premises.
 - B. The Lessee shall pay to the Lessor as royalty, one-eighth (1/8th) of the proceeds received by the Lessee from the sale of gas, gas condensate, gas distillate, casinghead gas, gas used for the manufacture of gasoline or any other product, and for all other gases, including their constituent parts, produced from the land herein leased. During any period (whether before or after expiration of the primary term hereof) when gas is not being so sold or used and the well or wells are shut in and there is no current production of oil or operations on said leased premises sufficient to keep this lease in force, Lessee shall pay or tender a royalty of One Dollar (\$1.00) per year per net royalty acre retained hereunder, such payment or tender to be made, on or before the later of ninety (90) days following the date of shut in or the anniversary date of this lease during the period such well is shut in, to the Lessor. When such payment or tender is made it will be considered that gas is being produced within the meaning of the entire lease.
3. If, at the expiration of the primary term, there is no production in paying quantities on the leased land or on lands pooled therewith but Lessee is conducting operations for drilling, completing or reworking a well, this lease nevertheless shall continue as long as such operations are prosecuted or additional operations are commenced and prosecuted (whether on the same or successive wells) with no cessation of more than one hundred eighty (180) days, and if production is discovered, this lease shall continue as long thereafter as oil or gas are produced. In addition, if at any time or times after the primary term, there is a total cessation of all production, for any cause (other than an event of force majeure), this lease shall not terminate if Lessee commences or resumes any drilling or reworking operations or production within one hundred eighty (180) days after such cessation. Drilling operations or mining operations shall be deemed to be commenced when the first material is placed on the leased premises or when the first work other than surveying or staking the location is done thereon which is necessary for such operations.
4. Lessee is hereby granted the right at any time and from time to time to unitize the leased premises or any portion or portions thereof, as to all strata or any stratum or strata, with any other lands as to all strata or any stratum or strata, for the production primarily of oil or primarily of gas with or without distillate. However, no unit for the production primarily of oil shall embrace more than 40 acres, or for the production primarily of gas with or without distillate more than 640 acres; provided that if any governmental regulation shall permit or prescribe a spacing pattern for the development of the field or allocate a producing allowable based on acreage per well, then any such unit may embrace as much additional acreage as may be so permitted or prescribed or as may be used in such allocation of allowable. Lessee shall file written unit designations in the county in which the leased premises are located unless the pooling or unitization results from governmental order or rule, in which case no such written designation shall be required. Operations upon and production from the unit shall be treated as if such operations were upon or such production were from the leased premises whether or not the well or wells are located thereon. The entire acreage within a unit shall be treated for all purposes as if it were covered by and included in this lease except that the royalty on production from the unit shall be as below provided, and except that in calculating the amount of any shut in gas royalties, only the part of the acreage originally leased and then actually embraced by this lease shall be counted. In respect to production from the unit, Lessee shall pay Lessor, in lieu of other royalties thereon, only such proportion of the royalties stipulated herein as the amount of his acreage placed in the unit, or his royalty interest therein on an acreage basis bears to the total acreage in the unit.
5. If said Lessor owns a less interest in the above described land than the entire and undivided fee simple estate therein, then the royalties herein provided shall be paid to the Lessor only in the proportion which his interest bears to the whole and undivided fee.
6. If the leased premises are now or shall hereafter be owned in severalty or in separate tracts, the premises may nonetheless be developed and operated as one lease, and all royalties accruing hereunder shall be divided among and paid to such separate

ADVANTAGE ELEVATIONS
OIL FIELD SURVEYORS

BOX 8604 - PRATT, KS 67124
(620) 672-6491

901102
INVOICE NO

FALCON EXPLORATION INC 3-11 GRC
OPERATOR NO FARM

Clark 11 31s 22w 510' FNL & 210' FNL
COUNTY S T R LOCATION

ELEVATION: 2202' gr



FALCON EXPLORATION INC
125 N Market St. Ste 1252
Wichita KS 67202

AUTHORIZED BY: Jason

0
0
0

EXISTING T/B

SCALE: 1" = 100'

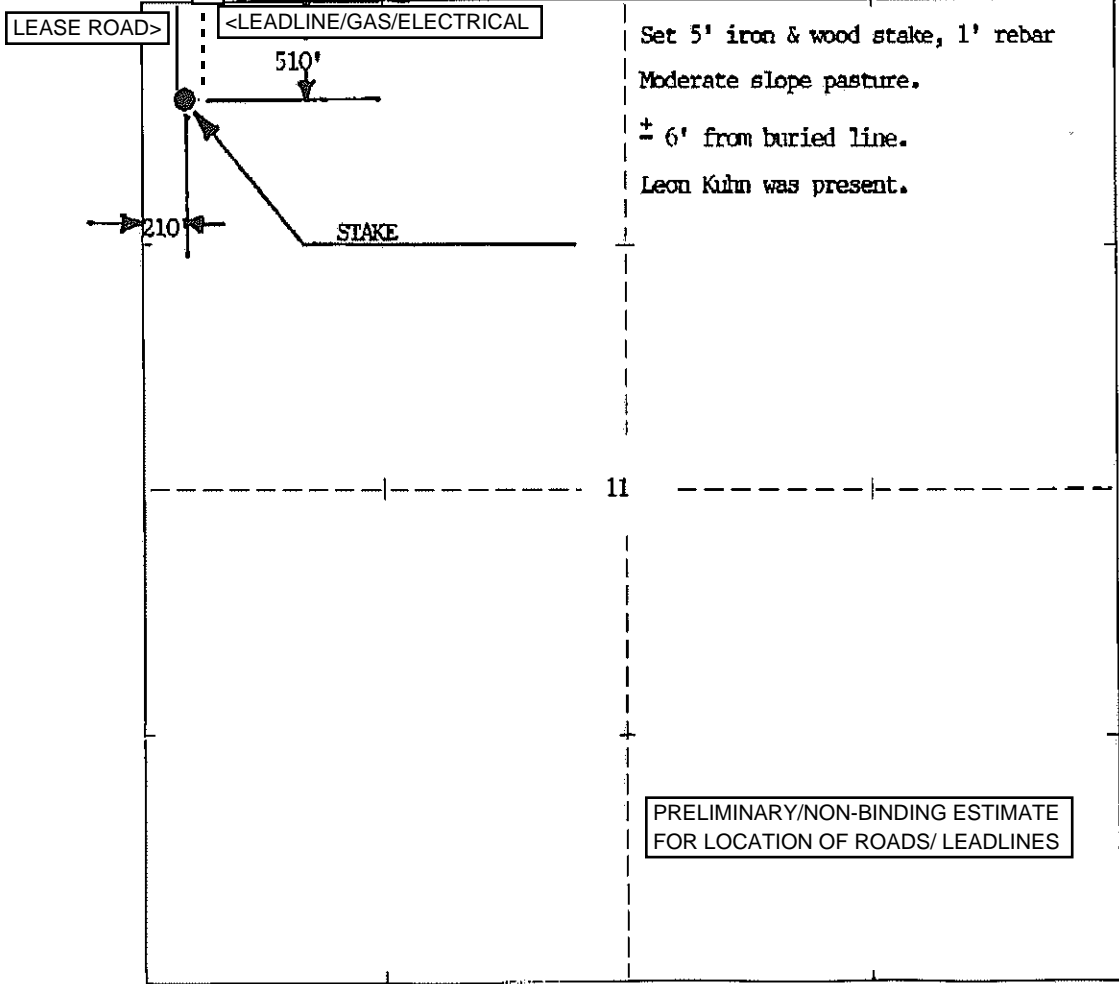

Staked 09/02/2010



*Mark Parkinson, Governor
Thomas E. Wright, Chairman
Joseph F. Harkins, Commissioner
Ward Loyd, Commissioner*

September 09, 2010

MICHEAL MITCHELL
Falcon Exploration, Inc.
125 N MARKET STE 1252
WICHITA, KS 67202-1719

Re: Drilling Pit Application
GRC 3-11(NW)
NW/4 Sec.11-31S-22W
Clark County, Kansas

Dear MICHEAL MITCHELL:

District staff has inspected the location and has determined that an unsealed condition will present a pollution threat to water resources.

District staff has instructed that no earthen pits are to be used at this location. Steel pits are to be used. Please inform the Commission in writing as to which disposal well you utilized to dispose of the contents in the steel pits and the amount of fluid that was disposed. Please file form CDP-5 (August 2008), Exploration and Production Waste Transfer, within 30 days of fluid removal.

Should a haul-off pit be necessary please file form CDP-1 (April 2004), Application for Surface Pit, through KOLAR. This location will have to be inspected prior to approval of the haul-off pit application.

CONSERVATION DIVISION

Finney State Office Building, 130 S. Market, Room 2078, Wichita, KS 67202-3802
(316) 337-6200 • Fax: (316) 337-6211 • <http://kcc.ks.gov/>

**HAUL-OFF PIT APPLICATION
FILING REQUIREMENTS**

82-3-607.

DISPOSAL OF DIKE AND PIT CONTENTS.

- (a) Each operator shall perform one of the following when disposing of dike or pit contents:
- (1) Remove the liquid contents to a disposal well or other oil and gas operation approved by the commission or to road maintenance or construction locations approved by the department;
 - (2) dispose of reserve pit waste down the annular space of a well completed according to the alternate I requirements of K.A.R. 82-3-106, if the waste to be disposed of was generated during the drilling and completion of the well; or
 - (3) dispose of the remaining solid contents in any manner required by the commission. The requirements may include any of the following:
 - (A) Burial in place, in accordance with the grading and restoration requirements in K.A.R. 82-3-602 (f);
 - (B) removal and placement of the contents in an on-site disposal area approved by the commission;
 - (C) removal and placement of the contents in an off-site disposal area on acreage owned by the same landowner or to another producing lease or unit operated by the same operator, if prior written permission from the landowner has been obtained; or
 - (D) removal of the contents to a permitted off-site disposal area approved by the department.
- (b) Each violation of this regulation shall be punishable by the following:
- (1) A \$1,000 penalty for the first violation;

- (2) a \$2,500 penalty for the second violation; and
- (3) a \$5,000 penalty and an operator license review for the third violation.

File Haul-Off Pit Application in KOLAR. Review the information below and attach all required documents to the pit application when submitting through KOLAR. This form will automatically generate and fill in from questions asked in KOLAR.

Haul-off pit will be located in an on-site disposal area: ___Yes ___No

Haul-off pit is located in an off-site disposal area on acreage owned by the same landowner: ___Yes ___No If yes, written permission from the land owner must be obtained. Attach written permission to haul-off pit application.

Haul-off pit is located in an off-site disposal area on another **producing** lease or unit operated by the same operator: ___Yes ___No If yes, written permission from the land owner must be obtained. Attach permission and a copy of the lease assignment that covers the acreage where the haul-off pit is to be located, to the haul-off pit application.