

WOOLSEY OPERATING COMPANY, LLC
KISLING LEASE
 NE. 1/4, SECTION 22, T34S, R10W
 BARBER COUNTY, KANSAS

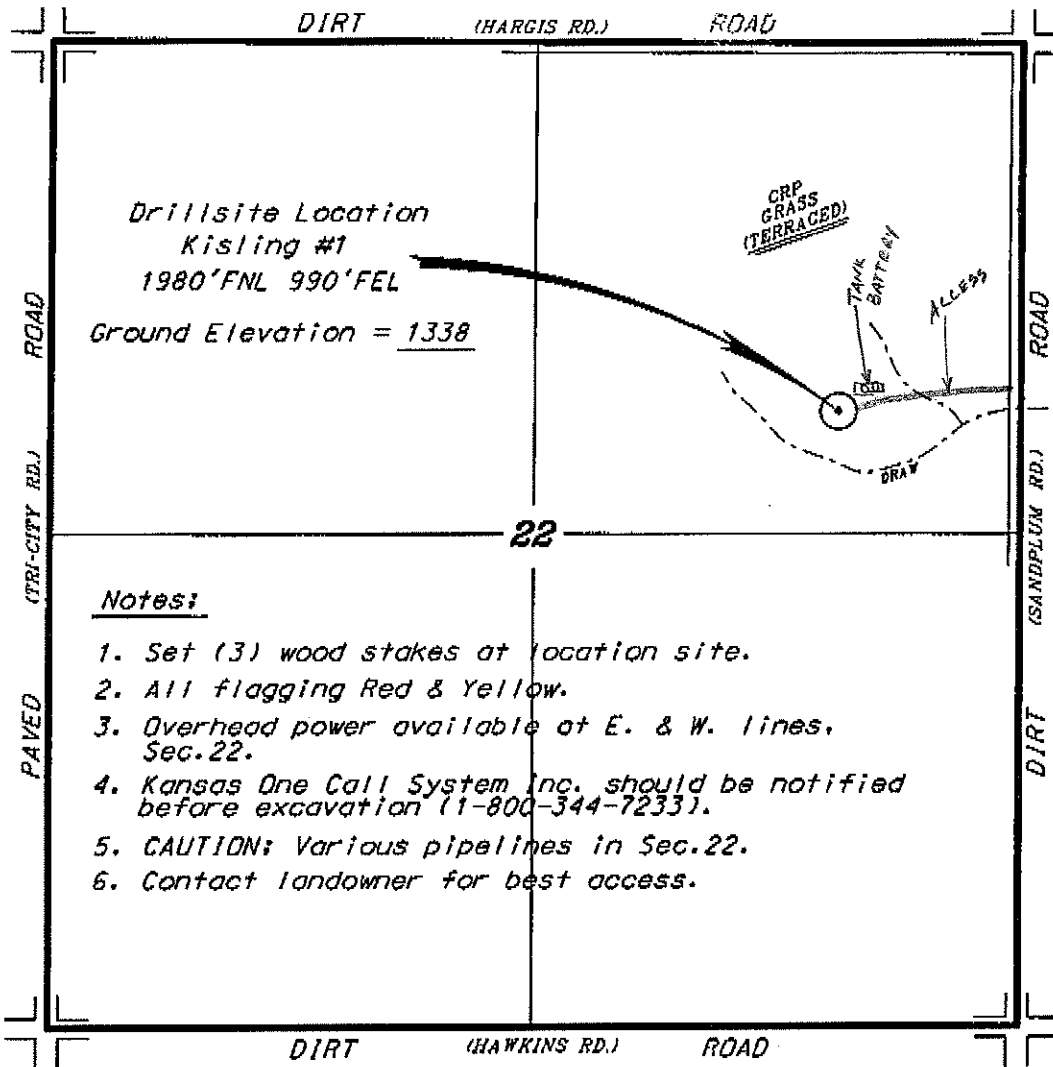

Drillsite Location
Kisling #1
 1980'FNL 990'FEL
 Ground Elevation = 1338

Notes:

1. Set (3) wood stakes at location site.
2. All flagging Red & Yellow.
3. Overhead power available at E. & W. lines, Sec. 22.
4. Kansas One Call System Inc. should be notified before excavation (1-800-344-7233).
5. CAUTION: Various pipelines in Sec. 22.
6. Contact landowner for best access.

*Ingress and egress to location as shown on this plot is per usage only and may not be legally opened for public use. Contact landowner, tenant and county road department for access.

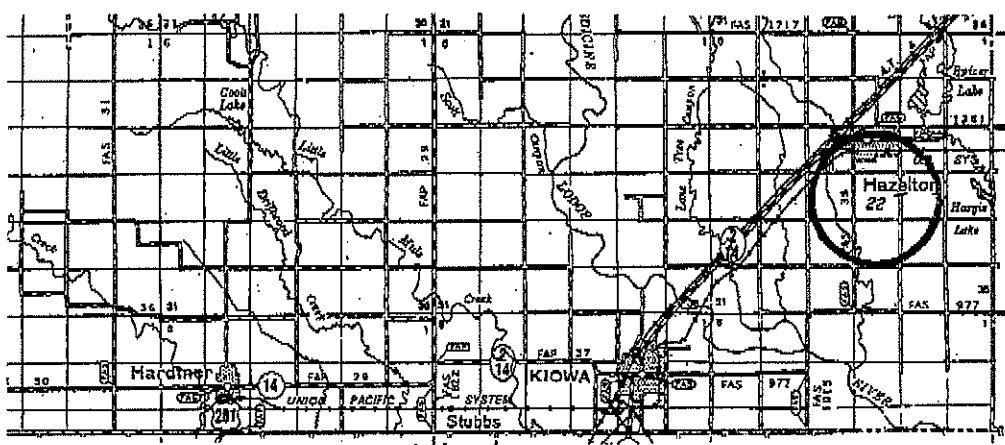
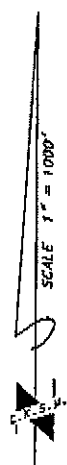

*collect
 Read out.*

Controlling data is based upon the best maps and photographs available to us and upon a regular section of land containing 640 acres.

Approximate section lines were determined using the normal standard of care of oilfield surveyors practicing in the state of Kansas. The section corners, which establish the precise section lines, were not necessarily located, and the exact location of the drilling location in the section is not guaranteed. Therefore, the operator assuming this service and occupying this plot and all other parties relying thereon agree to hold Central Kansas Oilfield Services, Inc., its officers and employees harmless from all losses, costs and expenses and civil liabilities released from any liability from incidental or consequential damages.

Elevations derived from National Geodetic Vertical Datum.

Date September 1, 2010