

Proposed Plan of Construction
 Atkins J-4
 Sec 33-T26S-R33W
 Finney County, KS

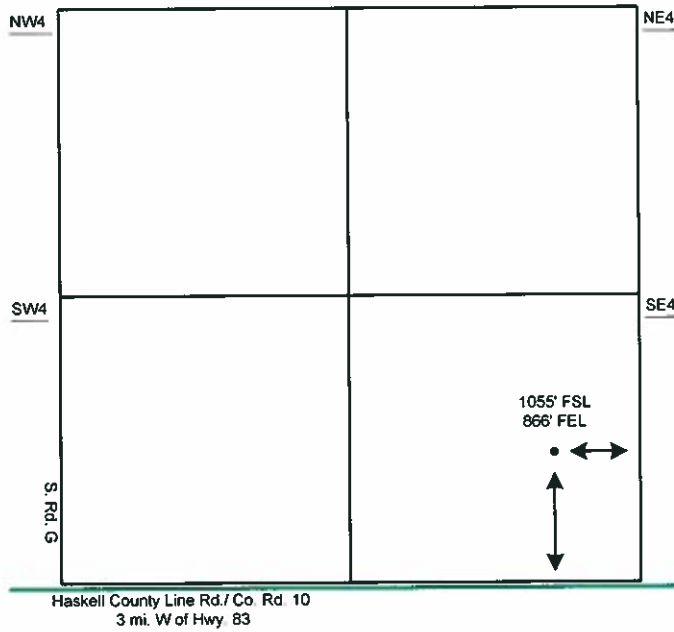

Sec 33 - T26S - R33W

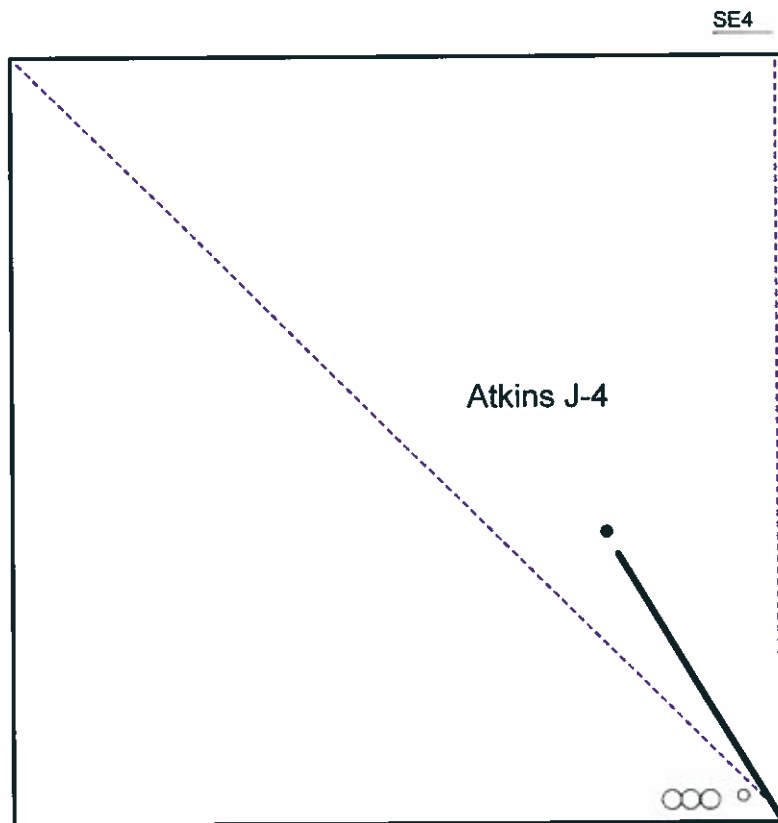

- Well Location
- Lease Roads
- - - Proposed Pipeline
- Tank Battery Equipment
- Power Lines
- - - Existing Pipeline

The Tank Battery Location has **NOT** been determined. The **PROPOSED** Tank Battery for the Atkins J-4 will be located in the SE of the SE quarter.

Detail of
 SE4 Sec 33-T26S-R33W

Note-Drawing **Not** to Scale

Site Diagram
 Atkins J-4
 Sep. 1, 2010

