

Proposed Plan of Construction

McMillan B-1  
Sec 13-T32S-R40W  
Morton County, KS

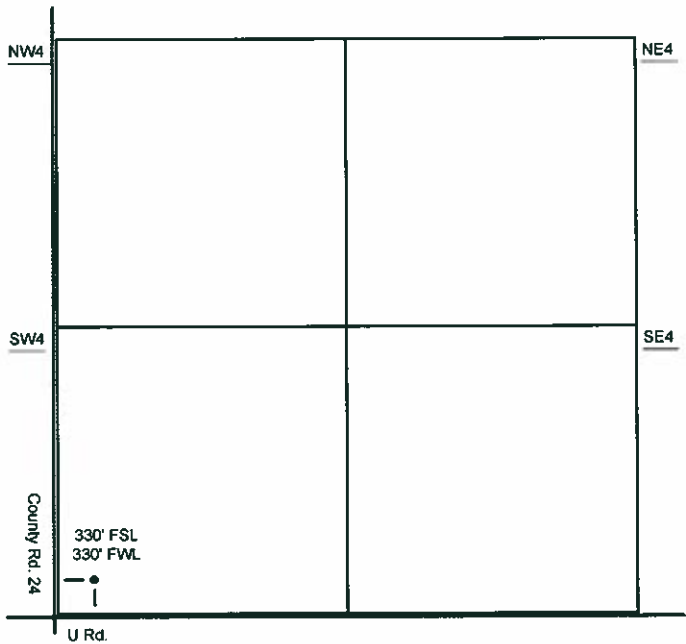

Sec 13 - T32S - R40W

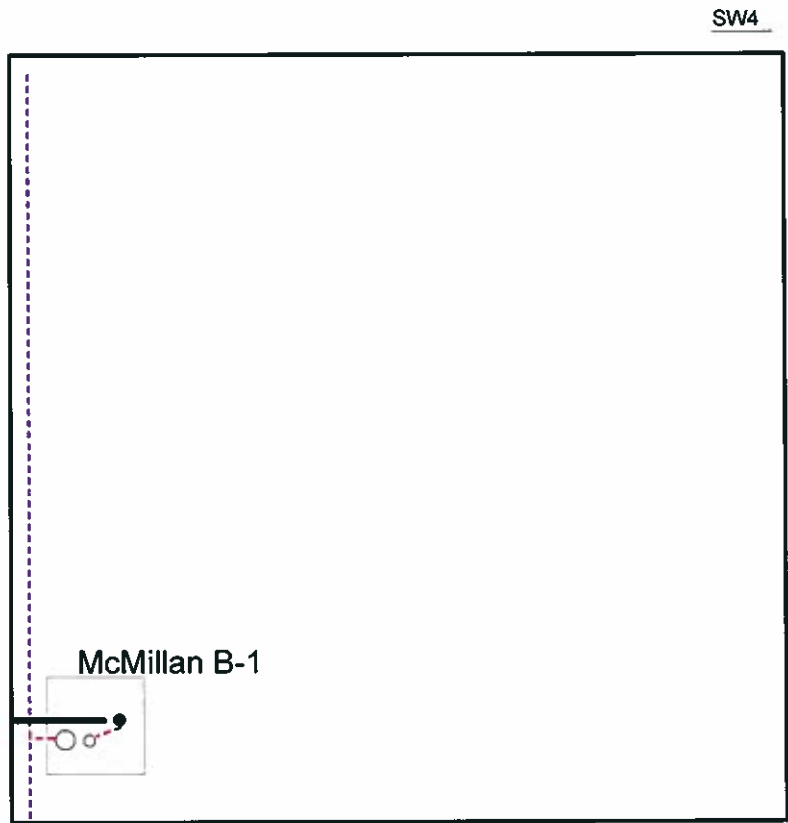

- Well Location
- Lease Roads
- - - Proposed Pipeline
- Tank Battery Equipment
- Power Lines
- - - Existing Pipeline

The **PROPOSED** Tank Battery for the McMillan B-1 will be located in the SW of the SW quarter.

Detail of  
SW4 Sec 13-T32S-R40W

Note-Drawing **Not** to Scale

Site Diagram  
McMillan B-1  
Sep. 7, 2010

