

# ADVANTAGE ELEVATIONS

OIL FIELD SURVEYORS

BOX 8604 - PRATT, KS 67124  
(620) 672-6491



907101  
INVOICE NO.

N-10 EXPLORATION LLC OPERATOR      3 NO.      Medicine River Ranch B FARM

Barber COUNTY      15 S      34s T      11w R      SW NE SW LOCATION

ELEVATION: 1330' gr

■ N-10 EXPLORATION LLC  
PO Box 195  
Attica KS 67009  
■

AUTHORIZED BY: Tim

SCALE: 1" = 1000'

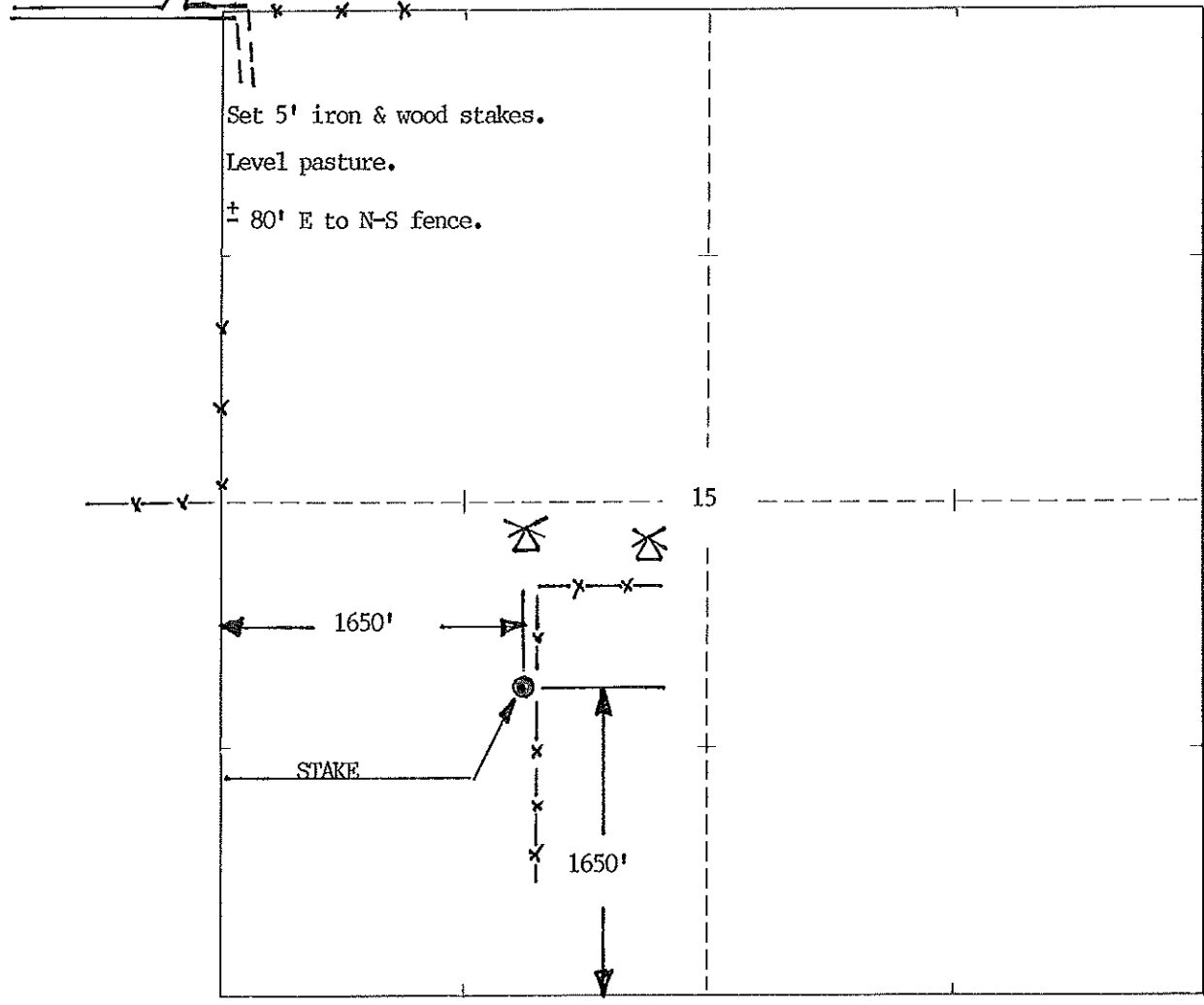

Staked 09/08/2010

COPY COPY

BM

1371

1350

OLD

16

1388

1331

RAILROAD

LINE

LODGE

MEDICINE RIVER RANCH B-3

1332

Wells

1335

RIVER

1338

1330

15

1350

1350

1334

5'

4105

Stubs: KS Scale: 1" = 0.189mi 305M 1.000Ft 1 Mi = 5.280' 1 cm = 120M

