

Proposed Plan of Construction
 Longbotham #4
 Sec 3-T30S-R32W
 Haskell County, KS

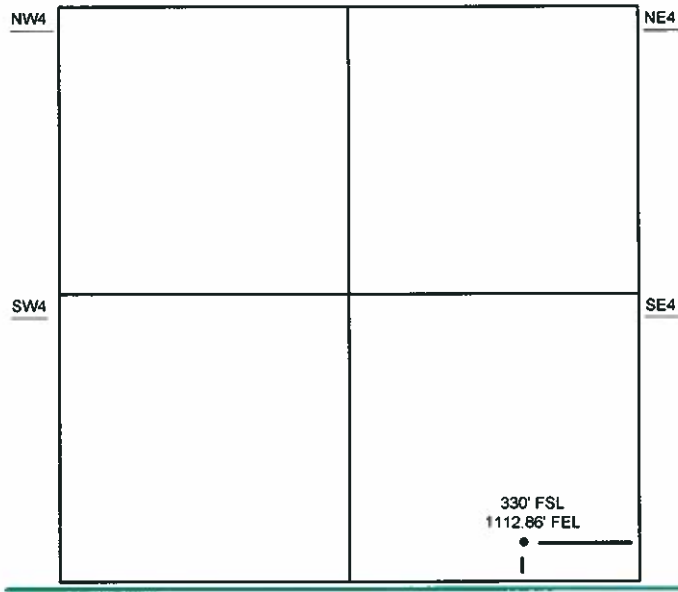

Sec 3 - T30S - R32W

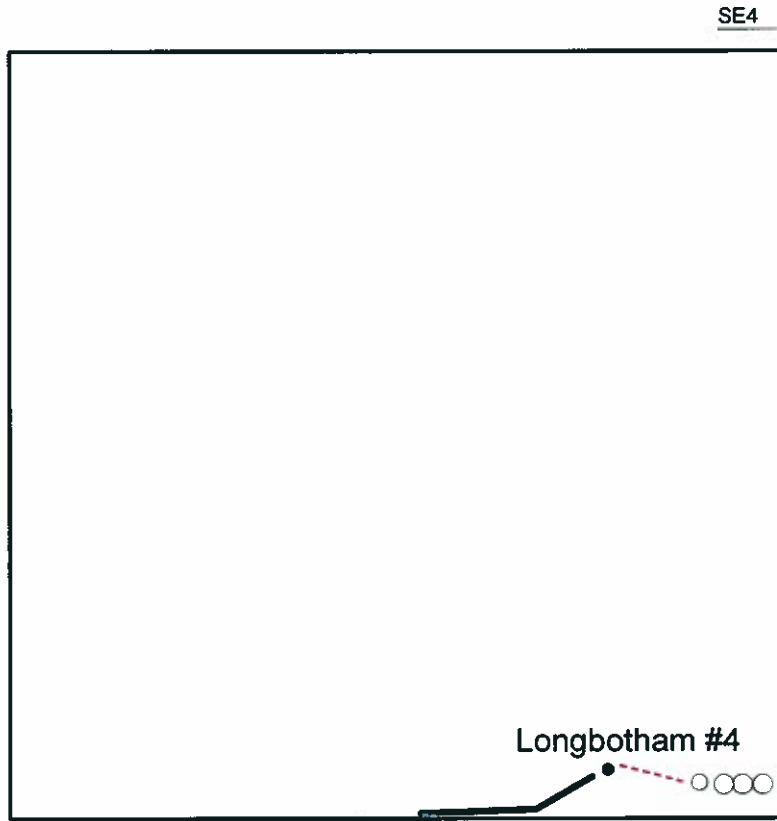

- Well Location
- Lease Roads
- - - Proposed Pipeline
- Tank Battery Equipment
- Power Lines
- - - Existing Pipeline

The Proposed Tank Battery for the Longbotham #4 is located in the SE of the SE quarter.

Detail of
 SE/4 Sec 3-T30S-R32W

Note-Drawing **Not** to Scale

Site Diagram
 Longbotham #4
 Oct. 15, 2010

