

PENCO ENGINEERING, P.A.
 P.O. BOX 392
 PLAINVILLE, KS 67663
 (785) 434-4611

BILL TO:

NW 1/4, SE 1/4, NE 1/4 Section 8, T8S, R21W
 LOCATION

October 14, 2010
 DATE

Bamber #1
 LEASE LOCATION NO.

Graham
 COUNTY

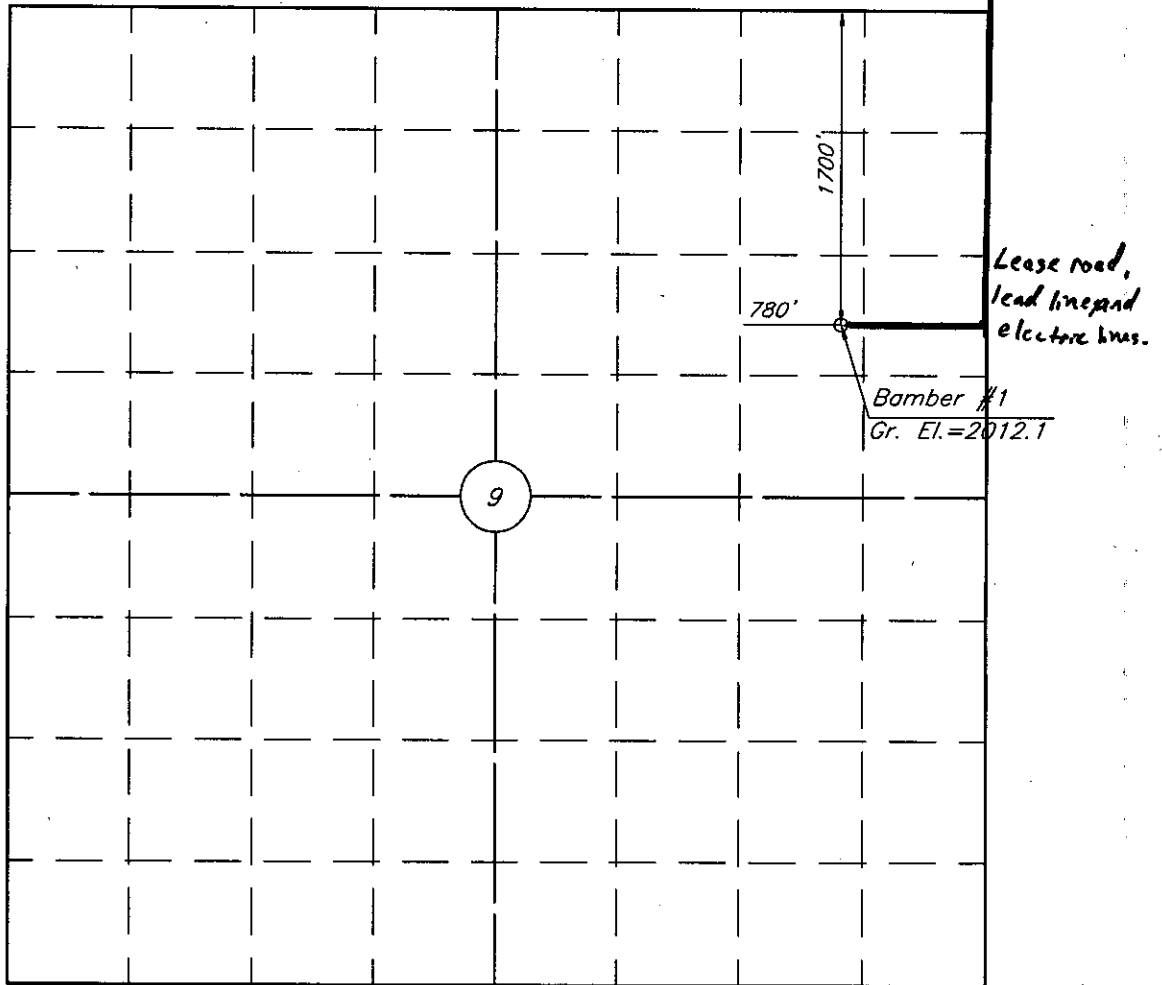

Elevations based on a Quad Map Elevation for the Intersection of US Highway 24 and Kansas Highway 18. Elev. 2029.0



Scale: 1" = 1000'