

**OPERATOR :** Samuel Gary Jr & Associates, Inc 1515 Wynkoop Street, Suite 700  
Denver, Colorado 80202 office :303-831-4673 ; fax :303-863-7285

**WELL NAME :** SCHECK 1-10

**LOCATION :** 330 FNL / 1850 FWL Sec. 10-16S-16W RUSH COUNTY

**SURFACE OWNER :** Dian Scheck  
3818 Forest Ave  
Great Bend, KS 67530

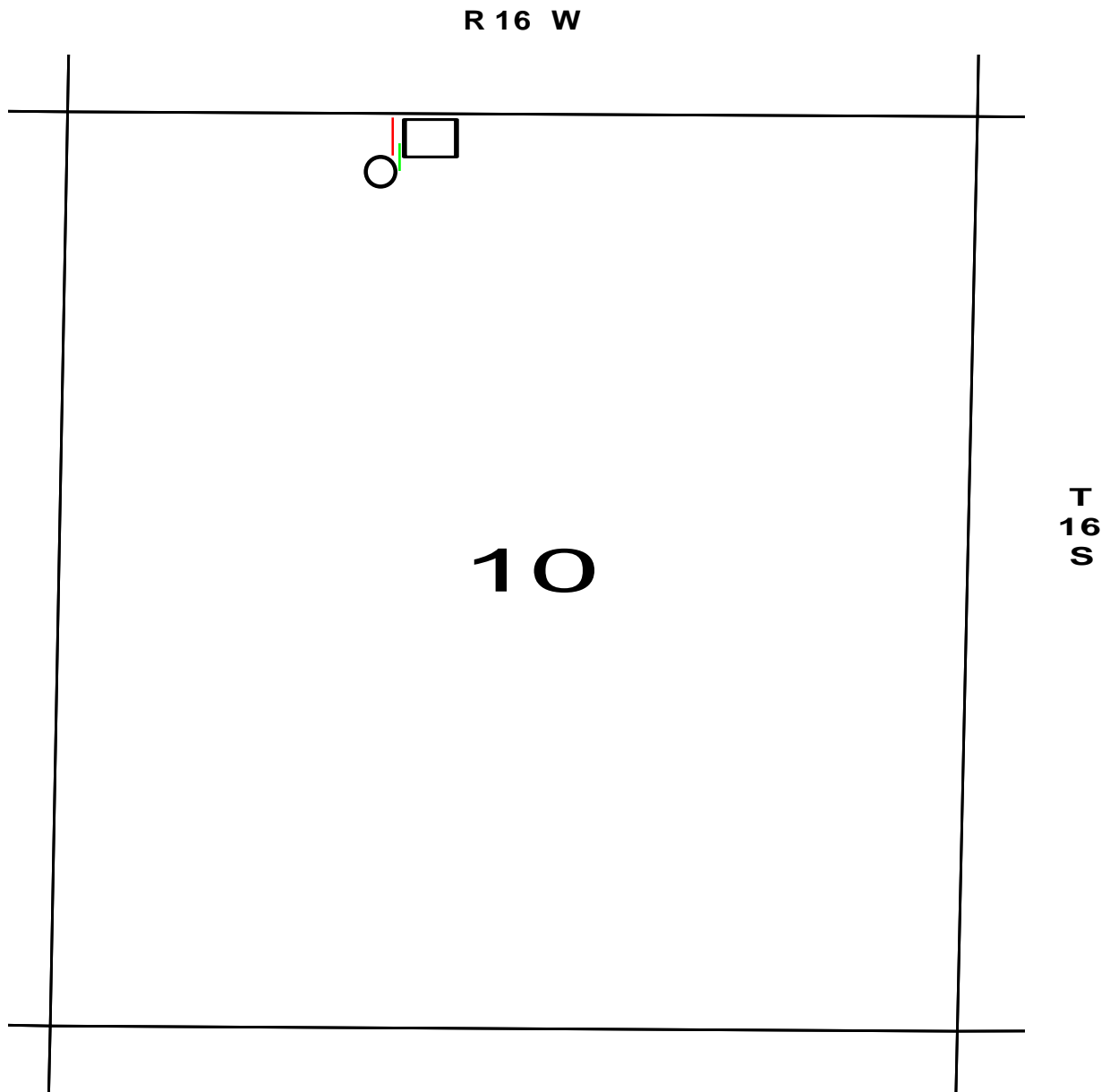

○ PROPOSED WELL LOCATION

□ ESTIMATED LOCATION OF TANK BATTERY

— ESTIMATED LOCATION OF FLOW LINES

— ESTIMATED LOCATION OF ELECTRICAL LINES