

Proposed Plan of Construction
 Longbotham #5
 Sec 3-T30S-R32W
 Haskell County, KS

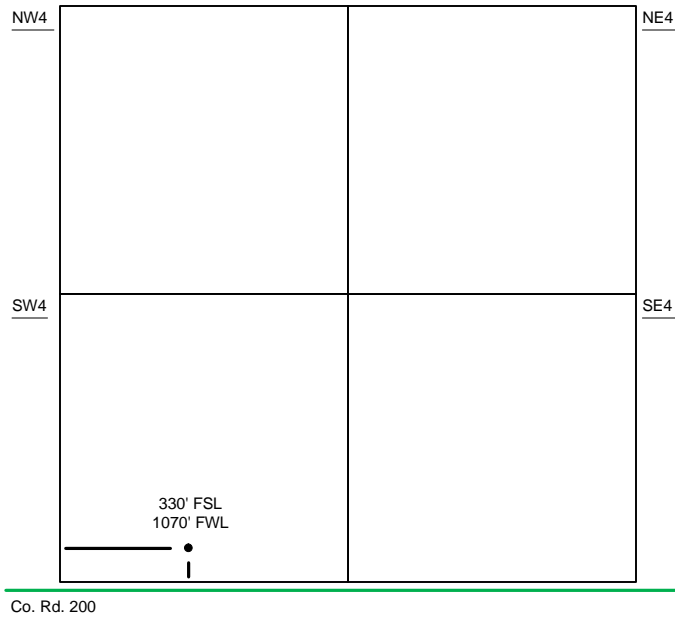

Sec 3 – T30S – R32W

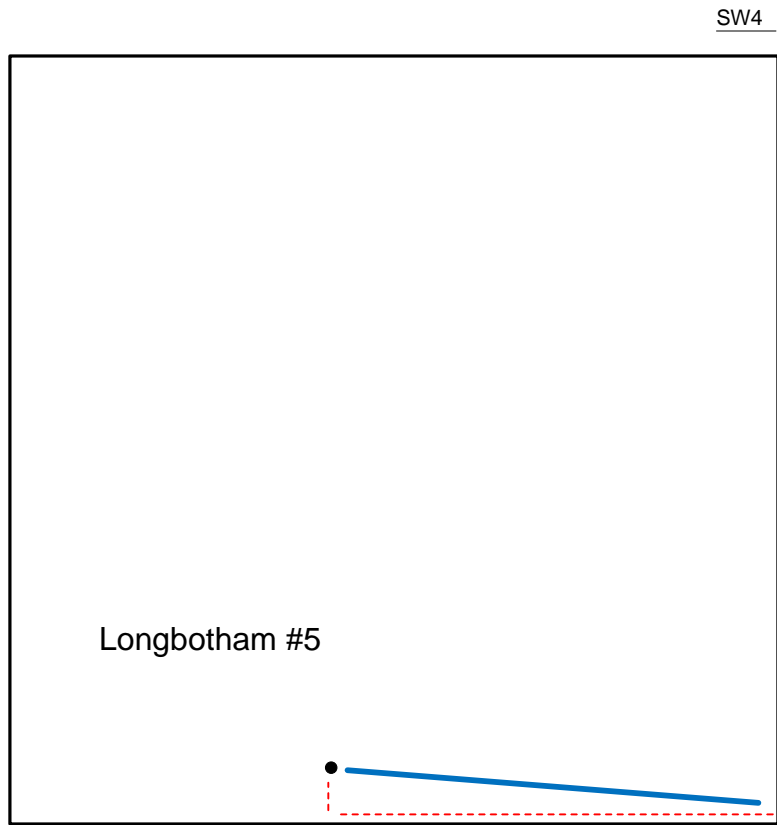

- Well Location
- Lease Roads
- - - Proposed Pipeline
- Tank Battery Equipment
- Power Lines
- - - Existing Pipeline

The **Proposed** Tank Battery for the Longbotham #5 is located in the SE of the SE quarter. Access to the well follow circle NW to site.

Detail of
 SW/4 Sec 3-T30S-R32W

Note-Drawing **Not** to Scale

