



1048984

For KCC Use ONLY

API # 15 - _____

IN ALL CASES PLOT THE INTENDED WELL ON THE PLAT BELOW

In all cases, please fully complete this side of the form. Include items 1 through 5 at the bottom of this page.

Operator: _____

Lease: _____

Well Number: _____

Field: _____

Number of Acres attributable to well: _____

QTR/QTR/QTR/QTR of acreage: _____ - _____ - _____ - _____

Location of Well: County: _____

_____ feet from N / S Line of Section

_____ feet from E / W Line of Section

Sec. _____ Twp. _____ S. R. _____ E W

Is Section: Regular or Irregular

If Section is Irregular, locate well from nearest corner boundary.

Section corner used: NE NW SE SW

PLAT

Show location of the well. Show footage to the nearest lease or unit boundary line. Show the predicted locations of lease roads, tank batteries, pipelines and electrical lines, as required by the Kansas Surface Owner Notice Act (House Bill 2032). You may attach a separate plat if desired.

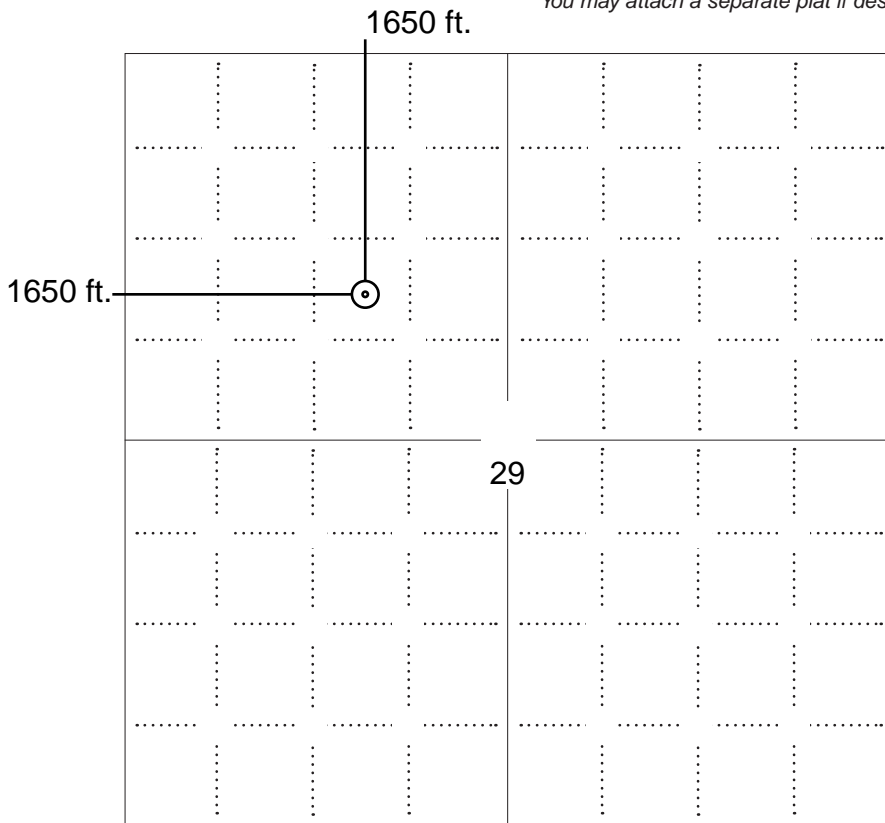

LEGEND

- Well Location
- Tank Battery Location
- Pipeline Location
- Electric Line Location
- Lease Road Location



NOTE: In all cases locate the spot of the proposed drilling locaton.

In plotting the proposed location of the well, you must show:

1. The manner in which you are using the depicted plat by identifying section lines, i.e. 1 section, 1 section with 8 surrounding sections, 4 sections, etc.
2. The distance of the proposed drilling location from the south / north and east / west outside section lines.
3. The distance to the nearest lease or unit boundary line (in footage).
4. If proposed location is located within a prorated or spaced field a certificate of acreage attribution plat must be attached: (C0-7 for oil wells; CG-8 for gas wells).
5. The predicted locations of lease roads, tank batteries, pipelines, and electrical lines.



APPLICATION FOR SURFACE PIT

Submit in Duplicate

Operator Name: _____		License Number: _____	
Operator Address: _____			
Contact Person: _____		Phone Number: _____	
Lease Name & Well No.: _____		Pit Location (QQQQ): _____-_____-_____-_____	
Type of Pit: <input type="checkbox"/> Emergency Pit <input type="checkbox"/> Burn Pit <input type="checkbox"/> Settling Pit <input type="checkbox"/> Drilling Pit <input type="checkbox"/> Workover Pit <input type="checkbox"/> Haul-Off Pit <i>(If WP Supply API No. or Year Drilled)</i>		Pit is: <input type="checkbox"/> Proposed <input type="checkbox"/> Existing If Existing, date constructed: _____ Pit capacity: _____ (bbls)	
Is the pit located in a Sensitive Ground Water Area? <input type="checkbox"/> Yes <input type="checkbox"/> No		Chloride concentration: _____ mg/l <i>(For Emergency Pits and Settling Pits only)</i>	
Is the bottom below ground level? <input type="checkbox"/> Yes <input type="checkbox"/> No		Artificial Liner? <input type="checkbox"/> Yes <input type="checkbox"/> No	
How is the pit lined if a plastic liner is not used?		_____	
Pit dimensions (all but working pits): _____ Length (feet) _____ Width (feet) <input type="checkbox"/> N/A: Steel Pits Depth from ground level to deepest point: _____ (feet) <input type="checkbox"/> No Pit			
If the pit is lined give a brief description of the liner material, thickness and installation procedure.		Describe procedures for periodic maintenance and determining liner integrity, including any special monitoring.	
Distance to nearest water well within one-mile of pit: _____ feet Depth of water well _____ feet		Depth to shallowest fresh water _____ feet. Source of information: <input type="checkbox"/> measured <input type="checkbox"/> well owner <input type="checkbox"/> electric log <input type="checkbox"/> KDWR	
Emergency, Settling and Burn Pits ONLY: Producing Formation: _____ Number of producing wells on lease: _____ Barrels of fluid produced daily: _____ Does the slope from the tank battery allow all spilled fluids to flow into the pit? <input type="checkbox"/> Yes <input type="checkbox"/> No		Drilling, Workover and Haul-Off Pits ONLY: Type of material utilized in drilling/workover: _____ Number of working pits to be utilized: _____ Abandonment procedure: _____ _____ Drill pits must be closed within 365 days of spud date.	
<p>Submitted Electronically</p>			

KCC OFFICE USE ONLY

Liner Steel Pit RFAC RFAS

Date Received: _____ Permit Number: _____ Permit Date: _____ Lease Inspection: Yes No



CERTIFICATION OF COMPLIANCE WITH THE KANSAS SURFACE OWNER NOTIFICATION ACT

This form must be submitted with all Forms C-1 (Notice of Intent to Drill); CB-1 (Cathodic Protection Borehole Intent); T-1 (Request for Change of Operator Transfer of Injection or Surface Pit Permit); and CP-1 (Well Plugging Application). Any such form submitted without an accompanying Form KSONA-1 will be returned.

Select the corresponding form being filed: C-1 (Intent) CB-1 (Cathodic Protection Borehole Intent) T-1 (Transfer) CP-1 (Plugging Application)

OPERATOR: License # _____
Name: _____
Address 1: _____
Address 2: _____
City: _____ State: _____ Zip: _____ + _____
Contact Person: _____
Phone: (_____) _____ Fax: (_____) _____
Email Address: _____

Well Location:
____ - ____ - ____ - ____ Sec. ____ Twp. ____ S. R. ____ East West
County: _____
Lease Name: _____ Well #: _____

If filing a Form T-1 for multiple wells on a lease, enter the legal description of the lease below:

Surface Owner Information:

Name: _____
Address 1: _____
Address 2: _____
City: _____ State: _____ Zip: _____ + _____

When filing a Form T-1 involving multiple surface owners, attach an additional sheet listing all of the information to the left for each surface owner. Surface owner information can be found in the records of the register of deeds for the county, and in the real estate property tax records of the county treasurer.

If this form is being submitted with a Form C-1 (Intent) or CB-1 (Cathodic Protection Borehole Intent), you must supply the surface owners and the KCC with a plat showing the predicted locations of lease roads, tank batteries, pipelines, and electrical lines. The locations shown on the plat are preliminary non-binding estimates. The locations may be entered on the Form C-1 plat, Form CB-1 plat, or a separate plat may be submitted.

Select one of the following:

- I certify that, pursuant to the Kansas Surface Owner Notice Act (House Bill 2032), I have provided the following to the surface owner(s) of the land upon which the subject well is or will be located: 1) a copy of the Form C-1, Form CB-1, Form T-1, or Form CP-1 that I am filing in connection with this form; 2) if the form being filed is a Form C-1 or Form CB-1, the plat(s) required by this form; and 3) my operator name, address, phone number, fax, and email address.
- I have not provided this information to the surface owner(s). I acknowledge that, because I have not provided this information, the KCC will be required to send this information to the surface owner(s). To mitigate the additional cost of the KCC performing this task, I acknowledge that I am being charged a \$30.00 handling fee, payable to the KCC, which is enclosed with this form.

If choosing the second option, submit payment of the \$30.00 handling fee with this form. If the fee is not received with this form, the KSONA-1 form and the associated Form C-1, Form CB-1, Form T-1, or Form CP-1 will be returned.

I Submitted Electronically

I

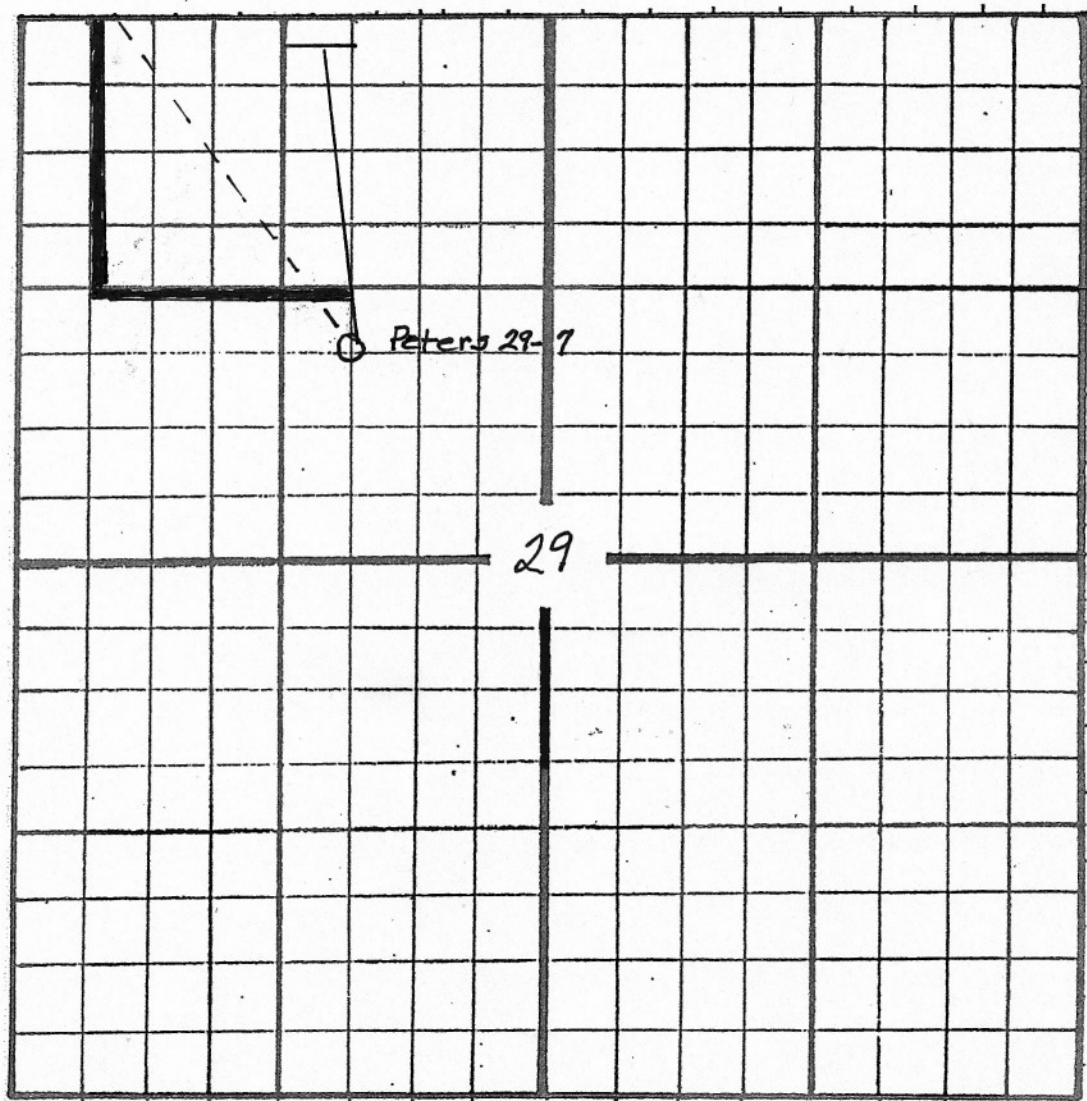

January 6, 2011

This letter is in request of an exception to the Table One surface pipe requirement of 300 feet since the well has only 120 feet of surface casing. The production string will be cemented in from 350 feet back to surface.

15-035-19432-0000

STATE OF KANSAS
STATE CORPORATION COMMISSION

WELL PLUGGING RECORD

Give All Information Completely
Make Required Affidavit
Mail or Deliver Report to:
Conservation Division
State Corporation Commission
800 Biting Building
Wichita, Kansas

Cowley County, Sec. 29 Twp. 34S Rge. 3 (E) (W)

Location as "NE/CNW&SWK" or footage from lines NW SE NW

Lease Owner White Eagle Oil Company

Lease Name Gibson Well No. 1

Office Address First Nat'l Bank Bldg., Tulsa 3, Oklahoma

Character of Well (completed as Oil, Gas or Dry Hole) Dry Hole

Date well completed March 12 1953

Application for plugging filed March 12 1953

Application for plugging approved March 12 1953

Plugging commenced March 13 1953

Plugging completed March 13 1953

Reason for abandonment of well or producing formation _____

If a producing well is abandoned, date of last production _____ 19____

Was permission obtained from the Conservation Division or its agents before plugging was commenced? Yes

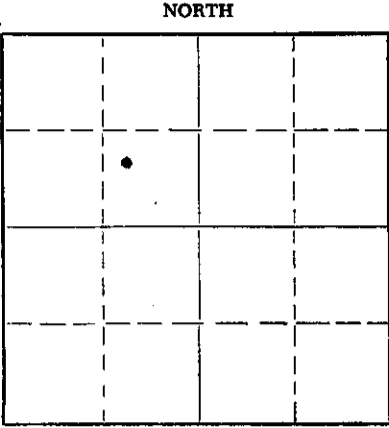

Locate well correctly on above
Section Plat

Name of Conservation Agent who supervised plugging of this well W. S. Lemaster

Producing formation _____ Depth to top _____ Bottom _____ Total Depth of Well 3396 Feet

Show depth and thickness of all water, oil and gas formations.

OIL, GAS OR WATER RECORDS

CASING RECORD

FORMATION	CONTENT	FROM	TO	SIZE	PUT IN	PULLED OUT
Stalnaker Sand		2222		8 5/8	120	None
Layton Sand		2655				
Layton Sand Porosity		2680				
Kansas City Lime		2865				
Big-Lime-Oswago		3070				
Cherokee Shale		3175				
Bartlesville Zone		3343				
Mississippi chert		3390				

Describe in detail the manner in which the well was plugged, indicating where the mud fluid was placed and the method or methods used in introducing it into the hole. If cement or other plugs were used, state the character of same and depth placed, from _____ feet to _____ feet for each plug set.

Filled with heavy mud from 3396 feet to 1450 feet, plug set at 1450 feet & Cemented with 35 sacks, heavy mud to 180 feet, plug set at 180 feet with 15 sacks cement, top plug cemented with 10 sacks.

(If additional description is necessary, use BACK of this sheet)

Name of Plugging Contractor Earl F. Wakefield

Address 307 Union National Bank Building, Wichita, Kansas

STATE OF Oklahoma, COUNTY OF Tulsa, ss.

Harry Saye (employee of owner) or (owner or operator) of the above-described well, being first duly sworn on oath, says: That I have knowledge of the facts, statements, and matters herein contained and the log of the above-described well as filed and that the same are true and correct. So help me, God.

(Signature) Harry Saye

Vice President

(Address)

SUBSCRIBED AND SWORN TO before me this 19th day of March 1953

My commission expires August 29, 1955

Notary Public.

PLUGGING
FILE SEC 29 T 34 R 3 E
BOOK PAGE 24 LINE 30

24-2675-5

RECEIVED
STATE CORPORATION COMMISSION

MAR 21 1953

CONSERVATION DIVISION
Wichita, Kansas



*Mark Parkinson, Governor
Thomas E. Wright, Chairman
Joseph F. Harkins, Commissioner
Ward Loyd, Commissioner*

January 10, 2011

JAMES HAVER
Cyclone Petroleum, Incorporated
7030C S LEWIS ST STE 541
TULSA, OK 74136

Re: Drilling Pit Application
PETERS 29-7
NW/4 Sec.29-34S-03E
Cowley County, Kansas

Dear JAMES HAVER:

District staff has inspected the above referenced location and has determined that the reserve pit shall be constructed **without slots**, the bottom shall be flat and reasonably level, and the free fluids must be removed. The fluids are to be removed from the reserve pit within 96 hours of completion of drilling operations.

If production casing is set all completion fluids shall be removed from the working pits daily. NO completion fluids or non-exempt wastes shall be placed in the reserve pit.

The fluids should be taken to an authorized disposal well. Please call the District Office at (316) 630-4000 when the fluids have been removed. Please file form CDP-5 (August 2008), Exploration and Production Waste Transfer, through KOLAR within 30 days of fluid removal.

A copy of this letter should be posted in the doghouse along with the approved Intent to Drill. If you have any questions or concerns please feel free to contact the District Office at (316) 630-4000.

January 7, 2011

James Haver
Cyclone Petroleum, Inc.
7030 C S Lewis St, Ste. 541
Tulsa, OK 74136

RE: Peters 29-7, NW-SE-NW Sec.29-T34S-R3E, Cowley County, Kansas

Dear Mr. Haver:

The Kansas Corporation Commission (KCC) has received your request, dated January 6, 2011, for an exception to the Table 1 minimum surface pipe requirement of 300 feet for the proposed well. From your request, the KCC understands that Cyclone Petroleum, Inc. is requesting to utilize the existing 120 feet of surface casing in this well bore and Alternate II cementing rules.

After review of this matter by technical staff it was determined that:

1. Bedrock at this location is the Permian Sumner Group and is located at or near surface.
2. The deepest water well of record within one mile of the proposed location is 90 feet.
3. The base of the Winfield limestone is at approximately 260 feet.

Based on this information, an exception is granted for the Table 1 Minimum Surface Casing Requirements with the following stipulations:

1. Upon completion of the well, the production or long string casing nearest the formation wall shall be immediately cemented from a depth of at least 350 feet back to the surface. Notify the KCC District #2 office prior to spudding the well and one day before cementing the longstring so they may have the opportunity to witness the procedure.
2. In the event the well is dry and no additional production pipe has been cemented in-place, plugging will be performed according to KCC rules and KCC District #2 requirements.

Sincerely Yours,

A handwritten signature in blue ink that reads "Doug Louis".

Doug Louis
Director

cc: Steve Bond '38
Jeff Klock - Dist #2 ✓ok via e-mail