



APPLICATION FOR COMMINGLING OF PRODUCTION (K.A.R. 82-3-123) OR FLUIDS (K.A.R. 82-3-123a) *Commingling ID # _____*

OPERATOR: License # _____ API No. 15 - _____
Name: _____ Spot Description: _____
Address 1: _____ - - - - - Sec. _____ Twp. _____ S. R. _____ East West
Address 2: _____ Feet from North / South Line of Section
City: _____ State: _____ Zip: _____ + _____ Feet from East / West Line of Section
Contact Person: _____ County: _____
Phone: (_____) _____ Lease Name: _____ Well #: _____

1. Name and upper and lower limit of each production interval to be commingled:
Formation: _____ (Perfs): _____
Formation: _____ (Perfs): _____
Formation: _____ (Perfs): _____
Formation: _____ (Perfs): _____
Formation: _____ (Perfs): _____

2. Estimated amount of fluid production to be commingled from each interval:
Formation: _____ BOPD: _____ MCFPD: _____ BWPD: _____
Formation: _____ BOPD: _____ MCFPD: _____ BWPD: _____
Formation: _____ BOPD: _____ MCFPD: _____ BWPD: _____
Formation: _____ BOPD: _____ MCFPD: _____ BWPD: _____
Formation: _____ BOPD: _____ MCFPD: _____ BWPD: _____

3. Plat map showing the location of the subject well, all other wells on the subject lease, and all wells on offsetting leases within a 1/2 mile radius of the subject well, and for each well the names and addresses of the lessee of record or operator.

4. Signed certificate showing service of the application and affidavit of publication as required in K.A.R. 82-3-135a.

For Commingling of PRODUCTION ONLY, include the following:

- 5. Wireline log of subject well. Previously Filed with ACO-1: Yes No
- 6. Complete Form ACO-1 (*Well Completion form*) for the subject well.

For Commingling of FLUIDS ONLY, include the following:

- 7. Well construction diagram of subject well.
- 8. Any available water chemistry data demonstrating the compatibility of the fluids to be commingled.

AFFIDAVIT: I am the affiant and hereby certify that to the best of my current information, knowledge and personal belief, this request for commingling is true and proper and I have no information or knowledge, which is inconsistent with the information supplied in this application.

Submitted Electronically

KCC Office Use Only
 Denied Approved
15-Day Periods Ends: _____
Approved By: _____ Date: _____

Protests may be filed by any party having a valid interest in the application. Protests must be in writing and comply with K.A.R. 82-3-135b and must be filed within 15 days of publication of the notice of application.

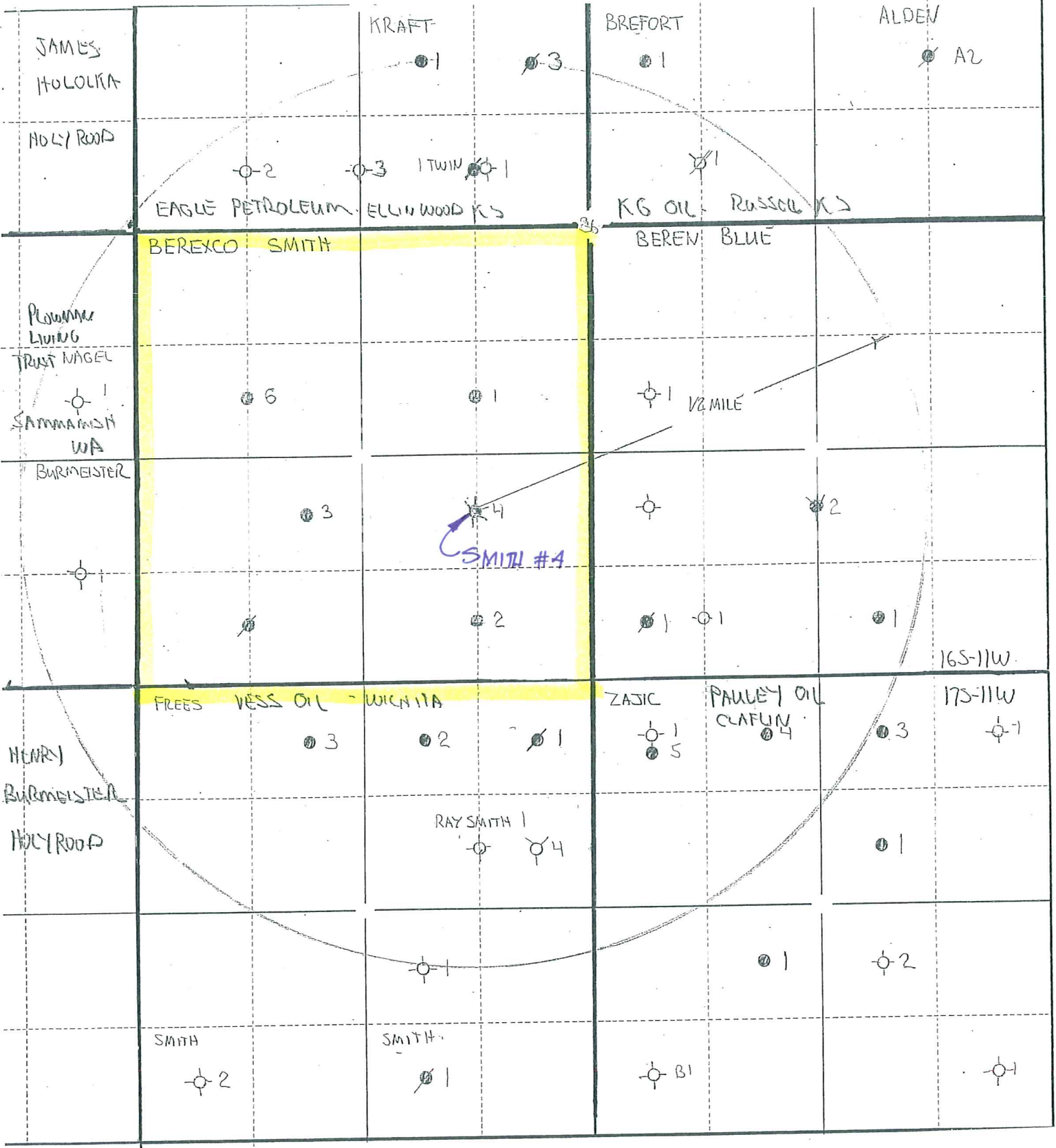

JAMES
HOLOLKA

KRAFT

BREFORT

ALDEN

HOLY ROOD

EAGLE PETROLEUM

ELLINWOOD K's

KG OIL

RUSSELL K's

BEREXCO

SMITH

BEREV

BLUE

PLUMMER
LIVING

TRUST NAGEL

SAMMAMISH
WA

BURMEISTER

1/2 MILE

SMITH #4

16S-11W

FREES

VESS OIL

WICHITA

ZAJIC

PAULEY OIL

17S-11W

HENRY

BURMEISTER

HOLY ROOD

RAY SMITH 1

SMITH

SMITH

B1

Smith #4 notice area

Unleased mineral owner – NE/4 Sec. 35-16S-11W

James A. Homolka
1835 NE 150th Ave.
Holyrood, KS 67530

Operator – NW/4 Sec. 36-16S-11W

Eagle Petroleum Inc.
P. O. Box 335
Ellinwood, KS 67526

Operator – NE/4 Sec. 36-16S-11W

KG Oil Company
18103 Walters Lane
Russell, KS 67665

Operator – SE/4 Sec. 36-16S-11W

Beren Corporation
P. O. Box 20380
Wichita, KS 67208

Operator – SW/4 Sec. 36-16S-11W

Berexco, LLC
P. O. Box 20380
Wichita, KS 67208

Unleased mineral owner – SE/4 Sec. 35-16S-11W

Plowman Living Trust
3212 218th Avenue SE
Sammamish, WA 98075

Operator – NE/4 Sec. 1-17S-11W

Pauley Oil Company
314 5th St.
Claflin, KS 67525

Operator – NW/4 Sec. 1-17S-11W

Vess Oil Corporation
1700 Waterfront Parkway, Building 500
Wichita, KS 67206

Unleased mineral owner – NE/4 Sec. 2-17S-11W

Henry Burmeister
1651 NE 150th Avenue
Hollyrood, KS 67450

AFFIDAVIT

STATE OF KANSAS \
- SS.
County of Sedgwick /

Mark Fletchall, of lawful age, being first duly sworn, deposeth and saith: That he is Record Clerk of The Wichita Eagle, a daily newspaper published in the City of Wichita, County of Sedgwick, State of Kansas, and having a general paid circulation on a daily basis in said County, which said newspaper has been continuously and uninterruptedly published in said County for more than one year prior to the first publication of the notice hereinafter mentioned, and which said newspaper has been entered as second class mail matter at the United States Post Office in Wichita, Kansas, and which said newspaper is not a trade, religious or fraternal publication and that a notice of a true copy is hereto attached was published in the regular and entire Morning issue of said The Wichita Eagle for 1 issues, that the first publication of said notice was

made as aforesaid on the 10th of

February A.D. 2011 , with

subsequent publications being made on the following dates:

And affiant further says that he has personal knowledge of the statements above set forth and that they are true.

Mark Fletchall

Subscribed and sworn to before me this

10th day of February, 2011

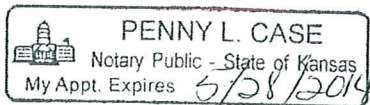

Penny L. Case
Notary Public Sedgwick County, Kansas

Printer's Fee : \$103.60

LEGAL PUBLICATION

Published in The Wichita Eagle
February 10, 2011 (3096915)
BEFORE THE STATE
CORPORATION COMMISSION
OF THE STATE OF KANSAS
NOTICE OF FILING APPLICATION.
Re: Berexco LLC. Application for a permit to commingle production in the Lansing Kansas City and the Arbuckle of the Smith #4 well, located in Barton County, Kansas.
To: All Oil and Gas Producers, Unleased Mineral Interest Owners, Landowners, and all persons whosoever concerned.
You, and each of you, are hereby notified that Berexco LLC. has filed an application to commingle production from the Lansing Kansas City and Arbuckle formations in the Smith #4 well located in the N/2 SE/4 SW/4 (990' FSL, 3300' FEL) of Sec 36 -16S-11W, Barton County, KS.
Any persons who object to or protest this application shall be required to file their objections or protests with the Conservation Division of the State Corporation Commission of the State of Kansas within fifteen (15) days from the date of this publication. These protests shall be filed pursuant to Commission regulations and must state specific reasons why the grant of the application may cause waste, violate correlative rights or pollute the natural resources of the state of Kansas.
All persons interested or concerned shall take notice of the foregoing and shall govern themselves accordingly.
Berexco LLC
2020 N. Bramblewood
Wichita, Kansas 67206
Phone: 316-265-3311

STATE OF KANSAS

BARTON COUNTY

Proof of Publication

SS.

MARY HOISINGTON

of lawful age, duly sworn upon oath states that SHE

is the PUBLISHER

of THE GREAT BEND TRIBUNE

THAT said newspaper has been published at least weekly fifty (50) times a year and has been so published for at least five years prior to the first publication of the attached notice:

THAT said paper was entered as second class mail matter at the post office of its publication:

THAT said paper has a general paid circulation on a daily, or weekly, or monthly, or yearly basis in

BARTON County, Kansas, and is

NOT a trade, religious or fraternal publication and has been PRINTED and published in BARTON County, Kansas.

That the attached notice was published in a regular issue of said newspaper

for 1 consecutive weeks, the first publication being on the 4th day

of February 20 11 and the last publication on the 4th day

of February 20 11.

Publication Fee \$ _____

Affidavit, Notary's Fees \$ _____

Additional Copies _____ at _____ \$ _____

Total Publication Fee \$ 30.50

Witness my hand this 4th day of February, 20 11

SUBSCRIBED and Sworn to before me this 4th

day of February 20 11

Notary Public signature

State of Kansas - Notary Public RAEGINA WERTH

My commission expires 7-26-14

NOTICE OF FILING APPLICATION for Berexco LLC. Application for a permit to commence production of oil, gas, and geothermal energy from the Lansing, Kansas City and Arbuckle formations in the Smith #4 well located in the N2 SE/4 SW/4 (90' E3L, 330' F3L) of Sec 36 - 18S - 17W, Barton County, KS.

Stamp: 2-18-11 25540 30.50

Advertising Invoice

Great Bend Tribune
 PO BOX 228, 2012 FOREST AVE
 GREAT BEND, KS 67530
 Phone: (620) 792-1211
 Fax: (620) 792-3441

3

Zhanna Pekarsky
 *Berexco LLC
 2020 N. Bramblewood
 WICHITA, KS 67206

Cust#: 02108557-000
 Phone: (316)265-3311
 Date: 02/04/11
 Due Date: 02/25/11

Ad#	Text	Start	Stop	Days	Amount	Prepaid	Due
03508352-001	Smith #4 (First	02/04/11	02/04/11	1	30.50	0.00	30.50

(First published in the Great Bend Tribune February 4, 2011)1T
 BEFORE THE STATE CORPORATION COMMISSION OF THE STATE OF KANSAS
 NOTICE OF FILING APPLICATION

Re: Berexco LLC. Application for a permit to commingle production in the Lansing Kansas City and the Arbuckle of the Smith #4 well, located in Barton County, Kansas.

To: All Oil and Gas Producers, Unleased Mineral Interest Owners, Landowners, and all persons whosoever concerned.

You, and each of you, are hereby notified that Berexco LLC, has filed an application to commingle production from the Lansing Kansas City and Arbuckle formations in the Smith #4 well located in the N/2 SE/4 SW/4 (990 FSL, 3300' FEL) of Sec 36 - 16S-11W, Barton County, KS.

Any persons who object to or protest this application shall be required to file their objections or protests with the Conservation Division of the State Corporation Commission of the State of Kansas within fifteen (15) days from the date of this publication. These protests shall be filed pursuant to Commission regulations and must state specific reasons why the grant of the application may cause waste, violate correlative rights or pollute the natural resources of the state of Kansas.

All persons interested or concerned shall take notice of the foregoing and shall govern themselves accordingly.

Berexco LLC
 2020 N. Bramblewood
 Wichita, Kansas 67206
 Phone: 316-265-3311

Please return a copy with payment

Total Due

30.50

**BEFORE THE STATE CORPORATION COMMISSION
OF THE STATE OF KANSAS**

IN THE MATTER OF THE APPLICATION OF)
BEREXCO LLC FOR COMMINGLING OF)
PRODUCTION OR FLUIDS IN THE SMITH #4)
WELL LOCATED IN SECTION 36, TOWNSHIP 16 S.,)
RANGE 11 W, BARTON COUNTY, KANSAS.)

AFFIDAVIT OF MAILING

STATE OF KANSAS)
) ss.
SEDGWICK COUNTY)

Richard Smith, of lawful age, being first duly sworn on oath states:

That he is an Engineering Technician for Applicant; that he served a copy of the attached Application by depositing same in the United State mail, postage prepaid, on the 21 day of February 2011, addressed to the persons listed on Exhibit A in accordance with K.A.R. 82-3-135a.

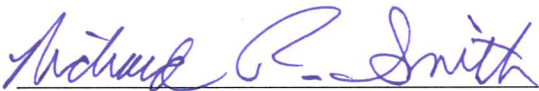
Richard Smith

SUBSCRIBED AND SWORN to before me this 21st day of February 2011.

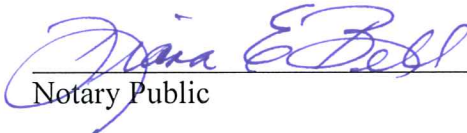

Notary Public

My appointment expires: Aug 10, 2011

BARTON COUNTY

Proof of Publication

SS.

MARY HOISINGTON

of lawful age, duly sworn upon oath states that SHE

is the PUBLISHER

of **THE GREAT BEND TRIBUNE**

THAT said newspaper has been published at least weekly fifty (50) times a year and has been so published for at least five years prior to the first publication of the attached notice:

THAT said paper was entered as second class mail matter at the post office of its publication:

THAT said paper has a general paid circulation on a daily, or weekly, or monthly, or yearly basis in

BARTON County, Kansas, and is

NOT a trade, religious or fraternal publication and has been PRINTED and published in BARTON County, Kansas.

That the attached notice was published in a regular issue of said newspaper

for 1 consecutive weeks, the first publication being on the 4th day

of February 20 11 and the last publication on the 4th day

of February 20 11

Publication Fee \$ _____

Affidavit, Notary's Fees \$ _____

Additional Copies _____ at _____ \$ _____

Total Publication Fee \$ 30.50

(Sign) Mary Hoisington

Witness my hand this 4th day of February, 20 11

SUBSCRIBED and Sworn to before me this 4th

day of February 2011

Raegina Wirth

(Notary Public)

(First published in the *Great Bend Tribune* February 4, 2011)1T
 BEFORE THE STATE CORPORATION COMMISSION OF THE STATE OF KANSAS
 NOTICE OF FILING APPLICATION
 Re: Berexco LLC. Application for a permit to commingle production in the Lansing Kansas City and the Arbuckle of the Smith #4 well, located in Barton County, Kansas.
 To: All Oil and Gas Producers, Unleased Mineral Interest Owners, Landowners, and all persons whosoever concerned.
 You, and each of you, are hereby notified that Berexco LLC. has filed an application to commingle production from the Lansing Kansas City and Arbuckle formations in the Smith #4 well located in the N/2 SE/4 SW/4 (990' FSL, 3300' FEL) of Sec 36 - 16S-11W, Barton County, KS.
 Any persons who object to or protest this application shall be required to file their objections or protests with the Conservation Division of the State Corporation Commission of the State of Kansas within fifteen (15) days from the date of this publication. These protests shall be filed pursuant to Commission regulations and must state specific reasons why the grant of the application may cause waste, violate correlative rights or pollute the natural resources of the state of Kansas.
 All persons interested or concerned shall take notice of the foregoing and shall govern themselves accordingly.
 Berexco LLC
 2020 N. Bramblewood
 Wichita, Kansas 67206
 Phone: 316-265-3311

2-18-11 25540
 \$30.50 (old)



State of Kansas - Notary Public

RAEGINA WERTH

My commission expires _____ My Commission Expires 7-26-14



March 8, 2011

Bruce Meyer
BEREXCO LLC
2020 N. Bramblewood
Wichita, KS 67206-1094

RE: Approved Commingling CO021102
Smith #4, Sec. 36-T16S-R11W, Barton County
API No. 15-009-03217-00-01

Dear Mr. Meyer:

Your Application for Commingling (ACO-4) for the above described well has been reviewed and approved by the Kansas Corporation Commission (KCC) per K.A.R. 82-3-123. Notice was examined and found to be proper per K.A.R. 82-3-135a. No protest had been filed within the 15-day protest period. This application, which was received by the KCC on February 21, 2011 concerns approval to simultaneously produce from the following sources of supply through the same tubing string in the same wellbore:

Source of Supply	Estimated Current Production			Perf Depth
	BOPD	MCFPD	BWPD	
Lansing/KS City	1.4	100	30	3083-3298
Arbuckle	1.4	0	10	3382-3393
Total Estimated Current Production	2.8	100	40	

Based upon the depth of the Arbuckle formation perforations, total oil production shall not exceed 100 BOPD and total gas production shall not exceed 50% of the absolute open flow (AOF).

Commingling ID number CO021102 has been assigned to this approved application. Use this number for well completion reports (ACO-1) and other correspondence that may concern this approved commingling.

Sincerely,

Rick Hestermann
Production Department