



1050906

For KCC Use ONLY

API # 15 - _____

IN ALL CASES PLOT THE INTENDED WELL ON THE PLAT BELOW

In all cases, please fully complete this side of the form. Include items 1 through 5 at the bottom of this page.

Operator: _____

Lease: _____

Well Number: _____

Field: _____

Number of Acres attributable to well: _____

QTR/QTR/QTR/QTR of acreage: _____ - _____ - _____ - _____

Location of Well: County: _____

_____ feet from N / S Line of Section

_____ feet from E / W Line of Section

Sec. _____ Twp. _____ S. R. _____ E W

Is Section: Regular or Irregular

If Section is Irregular, locate well from nearest corner boundary.

Section corner used: NE NW SE SW

PLAT

Show location of the well. Show footage to the nearest lease or unit boundary line. Show the predicted locations of lease roads, tank batteries, pipelines and electrical lines, as required by the Kansas Surface Owner Notice Act (House Bill 2032). You may attach a separate plat if desired.

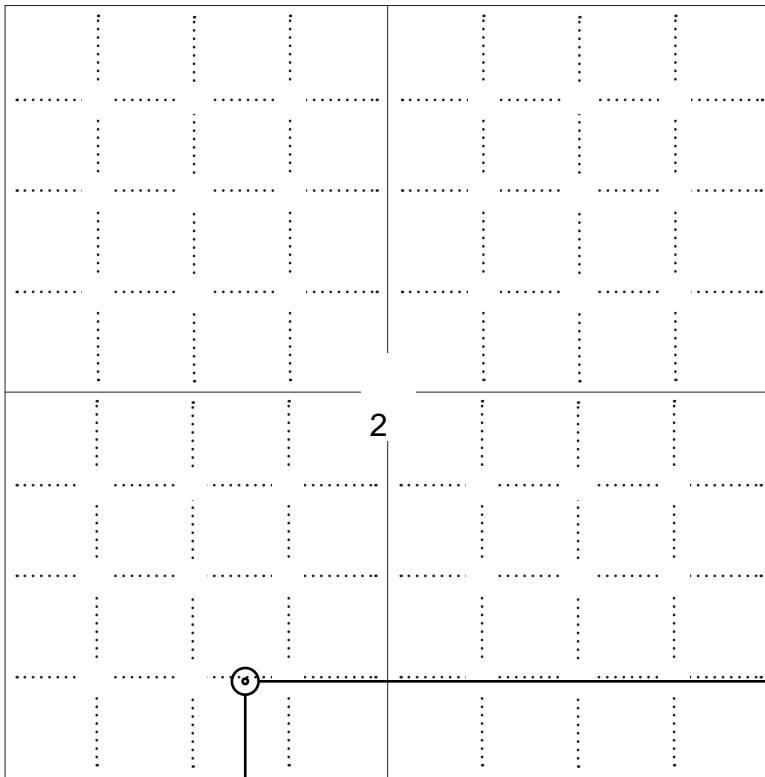

LEGEND

- Well Location
- Tank Battery Location
- Pipeline Location
- Electric Line Location
- Lease Road Location

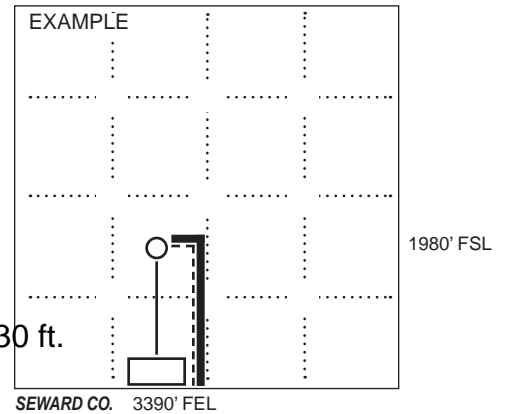

NOTE: In all cases locate the spot of the proposed drilling location.

660 ft.

In plotting the proposed location of the well, you must show:

1. The manner in which you are using the depicted plat by identifying section lines, i.e. 1 section, 1 section with 8 surrounding sections, 4 sections, etc.
2. The distance of the proposed drilling location from the south / north and east / west outside section lines.
3. The distance to the nearest lease or unit boundary line (in footage).
4. If proposed location is located within a prorated or spaced field a certificate of acreage attribution plat must be attached: (C0-7 for oil wells; CG-8 for gas wells).
5. The predicted locations of lease roads, tank batteries, pipelines, and electrical lines.



KANSAS CORPORATION COMMISSION 1050906
OIL & GAS CONSERVATION DIVISION

Form CDP-1
May 2010
Form must be Typed

APPLICATION FOR SURFACE PIT

Submit in Duplicate

Operator Name:		License Number:	
Operator Address:			
Contact Person:		Phone Number:	
Lease Name & Well No.:		Pit Location (QQQQ): ____ - ____ - ____ - ____	
Type of Pit: <input type="checkbox"/> Emergency Pit <input type="checkbox"/> Burn Pit <input type="checkbox"/> Settling Pit <input type="checkbox"/> Drilling Pit <input type="checkbox"/> Workover Pit <input type="checkbox"/> Haul-Off Pit <i>(If WP Supply API No. or Year Drilled)</i>		Pit is: <input type="checkbox"/> Proposed <input type="checkbox"/> Existing If Existing, date constructed: _____ Pit capacity: _____ (bbls)	
Is the pit located in a Sensitive Ground Water Area? <input type="checkbox"/> Yes <input type="checkbox"/> No		Chloride concentration: _____ mg/l <i>(For Emergency Pits and Settling Pits only)</i>	
Is the bottom below ground level? <input type="checkbox"/> Yes <input type="checkbox"/> No		Artificial Liner? <input type="checkbox"/> Yes <input type="checkbox"/> No	
How is the pit lined if a plastic liner is not used?			
Pit dimensions (all but working pits): _____ Length (feet) _____ Width (feet) <input type="checkbox"/> N/A: Steel Pits Depth from ground level to deepest point: _____ (feet) <input type="checkbox"/> No Pit			
If the pit is lined give a brief description of the liner material, thickness and installation procedure.		Describe procedures for periodic maintenance and determining liner integrity, including any special monitoring.	
Distance to nearest water well within one-mile of pit: _____ feet Depth of water well _____ feet		Depth to shallowest fresh water _____ feet. Source of information: <input type="checkbox"/> measured <input type="checkbox"/> well owner <input type="checkbox"/> electric log <input type="checkbox"/> KDWR	
Emergency, Settling and Burn Pits ONLY: Producing Formation: _____ Number of producing wells on lease: _____ Barrels of fluid produced daily: _____ Does the slope from the tank battery allow all spilled fluids to flow into the pit? <input type="checkbox"/> Yes <input type="checkbox"/> No		Drilling, Workover and Haul-Off Pits ONLY: Type of material utilized in drilling/workover: _____ Number of working pits to be utilized: _____ Abandonment procedure: _____ _____ Drill pits must be closed within 365 days of spud date.	
<p>Submitted Electronically</p>			

KCC OFFICE USE ONLY

Liner Steel Pit RFAC RFAS

Date Received: _____ Permit Number: _____ Permit Date: _____ Lease Inspection: Yes No



CERTIFICATION OF COMPLIANCE WITH THE KANSAS SURFACE OWNER NOTIFICATION ACT

This form must be submitted with all Forms C-1 (Notice of Intent to Drill); CB-1 (Cathodic Protection Borehole Intent); T-1 (Request for Change of Operator Transfer of Injection or Surface Pit Permit); and CP-1 (Well Plugging Application). Any such form submitted without an accompanying Form KSONA-1 will be returned.

Select the corresponding form being filed: C-1 (Intent) CB-1 (Cathodic Protection Borehole Intent) T-1 (Transfer) CP-1 (Plugging Application)

OPERATOR: License # _____
Name: _____
Address 1: _____
Address 2: _____
City: _____ State: _____ Zip: _____ + _____
Contact Person: _____
Phone: (_____) _____ Fax: (_____) _____
Email Address: _____

Well Location:
____ - ____ - ____ - ____ Sec. ____ Twp. ____ S. R. ____ East West
County: _____
Lease Name: _____ Well #: _____

If filing a Form T-1 for multiple wells on a lease, enter the legal description of the lease below:

Surface Owner Information:

Name: _____
Address 1: _____
Address 2: _____
City: _____ State: _____ Zip: _____ + _____

When filing a Form T-1 involving multiple surface owners, attach an additional sheet listing all of the information to the left for each surface owner. Surface owner information can be found in the records of the register of deeds for the county, and in the real estate property tax records of the county treasurer.

If this form is being submitted with a Form C-1 (Intent) or CB-1 (Cathodic Protection Borehole Intent), you must supply the surface owners and the KCC with a plat showing the predicted locations of lease roads, tank batteries, pipelines, and electrical lines. The locations shown on the plat are preliminary non-binding estimates. The locations may be entered on the Form C-1 plat, Form CB-1 plat, or a separate plat may be submitted.

Select one of the following:

- I certify that, pursuant to the Kansas Surface Owner Notice Act (House Bill 2032), I have provided the following to the surface owner(s) of the land upon which the subject well is or will be located: 1) a copy of the Form C-1, Form CB-1, Form T-1, or Form CP-1 that I am filing in connection with this form; 2) if the form being filed is a Form C-1 or Form CB-1, the plat(s) required by this form; and 3) my operator name, address, phone number, fax, and email address.
- I have not provided this information to the surface owner(s). I acknowledge that, because I have not provided this information, the KCC will be required to send this information to the surface owner(s). To mitigate the additional cost of the KCC performing this task, I acknowledge that I am being charged a \$30.00 handling fee, payable to the KCC, which is enclosed with this form.

If choosing the second option, submit payment of the \$30.00 handling fee with this form. If the fee is not received with this form, the KSONA-1 form and the associated Form C-1, Form CB-1, Form T-1, or Form CP-1 will be returned.

I Submitted Electronically

SIDE ONE

TIGHT HOLE

STATE CORPORATION COMMISSION OF KANSAS
OIL & GAS CONSERVATION DIVISION
WELL COMPLETION OR RECOMPLETION FORM
ADD-1 WELL HISTORY
DESCRIPTION OF WELL AND LEASE

API NO. 15-079-20,640
County...Harvey
W/2 SE. SW. Sec. 2... Twp. 23. Rge. 2. East
660 Ft North from Southeast Corner of Section
3930 Ft West from Southeast Corner of Section
(Note: Locate well in section plat below)
Lease Name...Harvey Grant Farms, Well #...2
Field Name...Halstead West (Pool Extension)
Producing Formation...Mississippian
Elevation: Ground 1435 KB 1440

Operator: License # 4569
Name NAY, RAY, OIL, INC.
Address 535 Fourth Financial Center
City/State/Zip Wichita, KS, 67202
Purchaser...Koch Oil Company
Wichita, Kansas
Operator Contact Person GARY SHARP
Phone (316) 264-2700
Contractor: License # 5418
Name ALLEN DRILLING COMPANY
Wellsite Geologist MIKE BYRAT
Phone (316) 838-6640

Designate Type of Completion
 New Well Re-Entry Workover
 Oil SWD Temp Abd
 Gas Inj Delayed Comp.
 Dry Other (Core, Water Supply etc.)
If CWNO: old well into as follows:
Operator
Well Name
Comp. Date Old Total Depth

RECEIVED
STATE CORPORATION COMMISSION
MAY 6 1989
CONSERVATION DIVISION
Wichita, Kansas

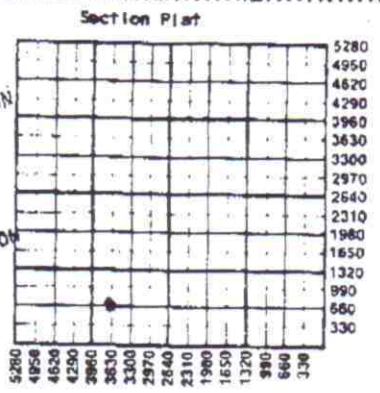

WATER SUPPLY INFORMATION
Disposition of Produced Water: Disposal
Docket # Repressuring

WELL HISTORY
Drilling Method: Mud Rotary Air Rotary Cable
2/28/88.. 12/15/88... 12/30/88...
Spud Date Date Reached TD Completion Date
3455'
Total Depth PSTD
Amount of Surface Pipe Set and Cemented at 258 feet
Multiple Stage Cementing Collar Used? Yes No
If yes, show depth set...feet
If alternate 2 completion, cement circulated from...feet depth to...w/...SX cmt
Cement Company Name
Invoice #

Questions on this portion of the ACO-1 call:
Water Resources Board (913) 296-3717
Source of Water:
Division of Water Resources Permit #.....
Groundwater.....Ft North from Southeast Corner (Well)
.....Ft West from Southeast Corner of Sec Twp Rge East West
Surface Water.....Ft North from Southeast Corner (Stream, pond etc).....Ft West from Southeast Corner Sec Twp Rge East West
 Other (explain)...Driller Supplied Water.... (purchased from city, R.W.D. #)

INSTRUCTIONS: This form shall be completed in triplicate and filed with the Kansas Corporation Commission, 200 Colorado Derby Building, Wichita, Kansas 67202, within 120 days of the spud date of any well. Rule 82-3-130, 82-3-107 and 82-3-106 apply.
Information on side two of this form will be held confidential for a period of 12 months if requested in writing and submitted with the form. See rule 82-3-107 for confidentiality in excess of 12 months.
One copy of all wireline logs and drillers time log shall be attached with this form. Submit CP-A form with all plugged wells. Submit CP-111 form with all temporarily abandoned wells.

All requirements of the statutes, rules and regulations promulgated to regulate the oil and gas industry have been fully complied with, and the statements herein are complete and correct to the best of my knowledge.

Signature *Betty B. Herring*
Title...Operations Secretary Date 04/05/89
Subscribed and sworn to before me this 5th day of April 1989
Notary Public...Betty B. Herring
Date Commission Expires 10-27-89

K.C.C. OFFICE USE ONLY
 Letter of Confidentiality Attached
 Wireline Log Received
 Drillers Time Log Received
Distribution
 KCC SWD/Rep NGPA
 KGS Plug Other (Specify)

BETTY B. HERRING
NOTARY PUBLIC
STATE OF KANSAS
My Appt. Exp. 10-27-89

4-6-89
Form ACO-1 (3-86)

Rank
Battery

Heavy
Gant
#1

Heavy
Gant
#2

Existing Wells and Tank
Battery

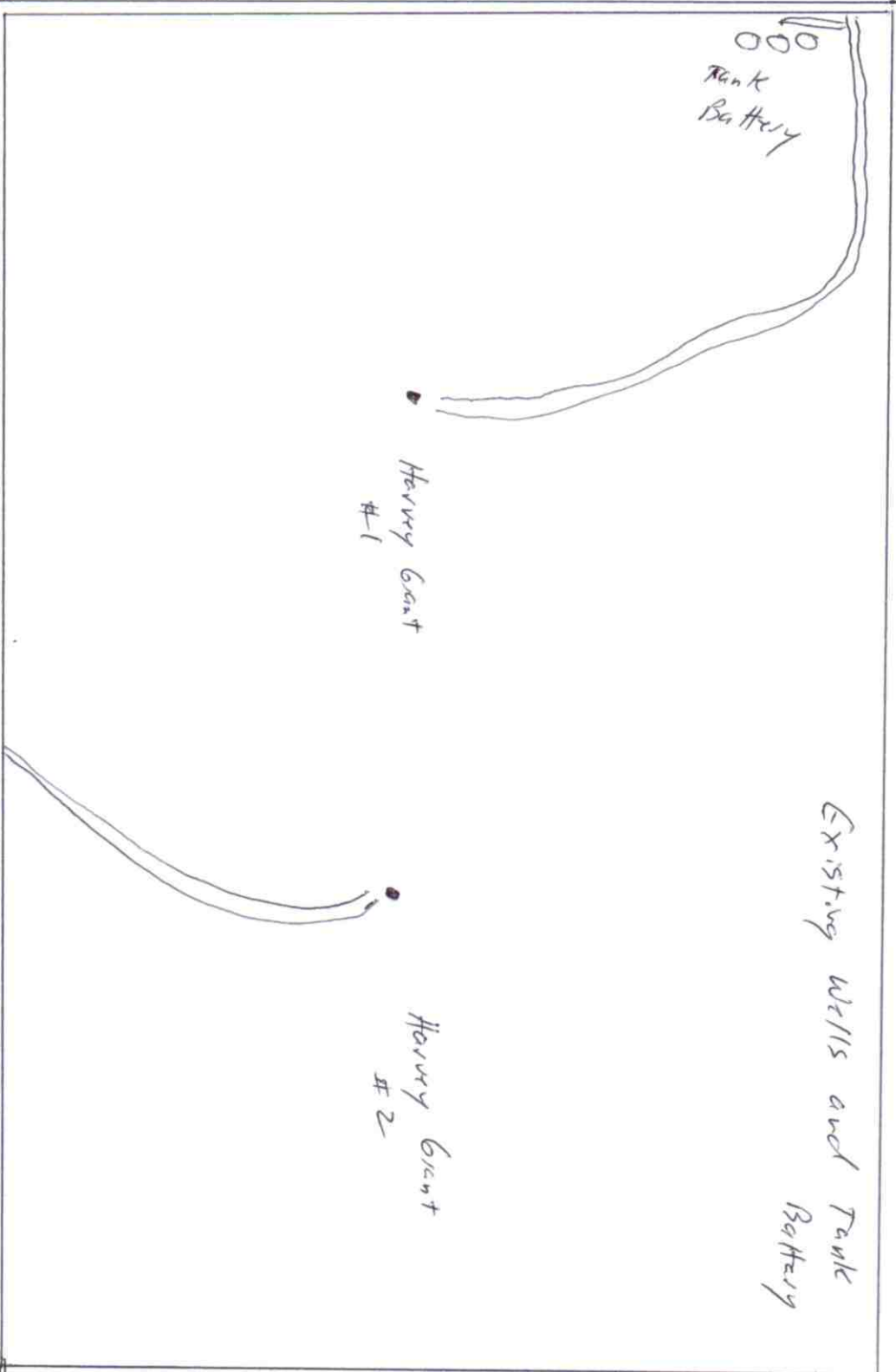

HOLES

SIDE TWO

Jay Boy Oil, Inc.

Lease Name: Harvey, Grant, Farm

Sec. 2 Twp. 23 Rge. 2

East
 West

County: Harvey

RELEASED
MAY 08 1990

WELL LOG

FROM CONFIDENTIAL

INSTRUCTIONS: Show important tops and base of formations penetrated. Detail all cores. Report all drill tests giving interval tested, time tool open and closed, flowing and shut-in pressures, whether surface pressure reached static level, hydrostatic pressures, bottom hole temperature, fluid recovery, and flow rate if gas to surface during test. Attach extra sheet if more space is needed. Attach copy of log.

Drill Stem Tests Taken Yes No
Samples Sent to Geological Survey Yes No
Cores Taken Yes No

Formation Description
 Log Sample

DST #1: 2926-2980' (Mississippian)
1st op, GTS/11" Flow Oil/22" Ga 67 MCF,
Rec: 4 1/2 BO (450' oil) 120' MGO (22%
M, 34%G, 44%O).
IHP: 1439#
IFP: 375-635#
ISIP: 802#
FHP: 1428#
DST #2: 3340-3355' (Viola) 45-60-45-60
1st op weak blow inc 4"; 2nd op
weak blow thru-out.
Rec: 60' clean oil (27 degree gravity)
30' OCMW (14%O, 27%M, 59%W) 60'
OCMW (7%O, 19%M, 74%W) Chl 41,000
ppm, system 2000 ppm.
IHP: 1711#
IFP: 10-20#
ISIP: 937#
BHT: 110°

Name	Top	Bottom
Heebner	2113	
	(-673)	
Lansing	2344	
	(-904)	
Ft. Scott	2852	
	(-1412)	
Cke Sh	2878	
	(-1436)	
Mississippian	2950	
	(-1510)	
Kinderhook	3226	
	(-1786)	
Mis/Hunton	3245	
	(-1805)	
Viola	3347	
	(-1907)	
Simpson Sd	3395	
	(-1955)	

CASING RECORD <input type="checkbox"/> New <input checked="" type="checkbox"/> Used							
Report all strings set-conductor, surface, intermediate, production, etc.							
Purpose of String	Size Hole Drilled	Size Casing Set (In O.D.)	Weight Lbs/Ft.	Setting Depth	Type of Cement	#Sacks Used	Type and Percent Additives
Surface Production	12-1/4"	8-5/8"	20#	261'	60/40 Poz	120	28 gal 39 cc 10 gal 42 cc
	7-7/8"	5-1/2"	14#	345'	Standard	250	
PERFORATION RECORD				Acid, Fracture, Shot, Cement Squeeze Record			
Specify Footage of Each Interval Perforated				(Amount and Kind of Material Used) Depth			
3056-3065 (Mississippian)				A 250 gal (77% HCA)			

METHOD OF COMPLETION
Disposition of gas: Vented Open Hole Perforation
 Sold Other (Specify)
 Used on Lease
 Dually Completed Coning/Led
Production Interval: 3056-63 Mississippian

BOY OIL, INC.

Harvey Grant Farms
DST Continued

RELEASED

MAY 0 8 1990

FROM CONFIDENTIAL

**TIGHT
HOLE!**

DST #3: (Simpson) 3382-3420', 30-30-30-30
25' of oil spk'd muddy water (1% Oil, 42%M, 57%W)
IHP: 1742#
IFP: 31-31#
ISIP: 854#
FFP: 31-31#
FSIP: 812#
FHP: 1732#
BHT: 113°

RECEIVED
STATE CORPORATION COMMISSION

APR 6 1989

KANSAS GEOLOGICAL SURVEY
WICHITA BRANCH

CONSERVATION DIVISION
Wichita, Kansas



March 10, 2011

P. J. Buck
Jones & Buck Development, a General
Partnership
PO BOX 68
SEDAN, KS 67361-0068

Re: Drilling Pit Application
Harvey Grant 2
SW/4 Sec.02-23S-02W
Harvey County, Kansas

Dear P. J. Buck:

District staff has inspected the location and has determined that an unsealed condition will present a pollution threat to water resources.

District staff has recommended that the reserve pit be kept on the south side of the stake and lined. The plastic liner must have a minimum thickness of 10 mil. Integrity of the liner must be maintained at all times.

If production casing is set all completion fluids shall be removed from the working pits daily. NO completion fluids or non-exempt wastes shall be placed in the reserve pit.

The free fluids in the reserve pit should be removed as soon as practical after drilling operations have ceased. The fluids should be taken to an authorized disposal well. Please call the District Office at (316) 630-4000 when the fluids have been removed. Please file form CDP-5 (August 2008), Exploration and Production Waste Transfer, through KOLAR within 30 days of fluid removal.

A copy of this letter should be posted in the doghouse along with the approved Intent to Drill. If you have any questions or concerns please feel free to contact the District Office at (316) 630-4000.