

SIDE ONE

TIGHT HOLE

STATE CORPORATION COMMISSION OF KANSAS
OIL & GAS CONSERVATION DIVISION
WELL COMPLETION OR RECOMPLETION FORM
ADD-1 WELL HISTORY
DESCRIPTION OF WELL AND LEASE

API NO. 15-079-20,640
County...Harvey
W/2 SE. SW. Sec. 2... Twp. 23. Rge. 2. East
650 Ft North from Southeast Corner of Section
3930 Ft West from Southeast Corner of Section
(Note: Locate well in section plat below)
Lease Name...Harvey Grant Farms, Well #...2
Field Name...Halstead West (Pool Extension)
Producing Formation...Mississippian
Elevation: Ground 1435 KB 1440

Operator: License # 4569
Name NAY, BAY, OIL, INC.
Address 535 Fourth Financial Center
City/State/Zip Wichita, KS, 67202
Purchaser...Koch Oil Company
Wichita, Kansas
Operator Contact Person GARY SHARP
Phone (316) 264-2700
Contractor: License # 5418
Name Allen Drilling Company
Wellsite Geologist Mike Bryant
Phone (316) 838-6640

Designate Type of Completion
 New Well Re-Entry Workover
 Oil SWD Temp Abd
 Gas Inj Delayed Comp.
 Dry Other (Core, Water Supply etc.)
If CWNO: old well into as follows:
Operator
Well Name
Comp. Date Old Total Depth

RECEIVED
STATE CORPORATION COMMISSION
MAY 6 1989
CONSERVATION DIVISION
Wichita, Kansas

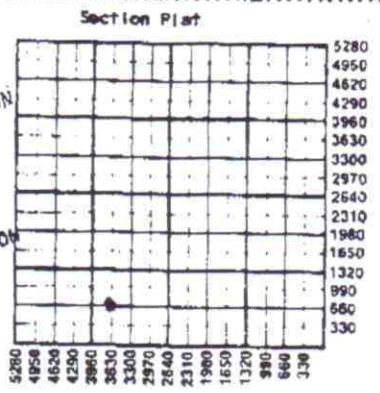

WELL HISTORY
Drilling Method: Mud Rotary Air Rotary Cable
2/28/88.. 12/15/88.. 12/30/88...
Spud Date Date Reached TD Completion Date
3455'
Total Depth PSTD
Amount of Surface Pipe Set and Cemented at 258 feet
Multiple Stage Cementing Collar Used? Yes No
If yes, show depth set...feet
If alternate 2 completion, cement circulated
from...feet depth to...w/...SX cmt
Cement Company Name
Invoice #

WATER SUPPLY INFORMATION
Disposition of Produced Water: Disposal
Docket # Repressuring

Questions on this portion of the ACO-1 call:
Water Resources Board (913) 296-3717
Source of Water:
Division of Water Resources Permit #
Groundwater...Ft North from Southeast Corner
(Well) ...Ft West from Southeast Corner of
Sec Twp Rge East West
Surface Water...Ft North from Southeast Corner
(Stream, pond etc) ...Ft West from Southeast Corner
Sec Twp Rge East West
 Other (explain)...Driller Supplied Water....
(purchased from city, R.W.D. #)

INSTRUCTIONS: This form shall be completed in triplicate and filed with the Kansas Corporation Commission, 200 Colorado Derby Building, Wichita, Kansas 67202, within 120 days of the spud date of any well. Rule 82-3-130, 82-3-107 and 82-3-106 apply.
Information on side two of this form will be held confidential for a period of 12 months if requested in writing and submitted with the form. See rule 82-3-107 for confidentiality in excess of 12 months.
One copy of all wireline logs and drillers time log shall be attached with this form. Submit CP-A form with all plugged wells. Submit CP-111 form with all temporarily abandoned wells.

All requirements of the statutes, rules and regulations promulgated to regulate the oil and gas industry have been fully complied with, and the statements herein are complete and correct to the best of my knowledge.

Signature *Betty B. Herring*
Title...Operations Secretary Date 04/05/89
Subscribed and sworn to before me this 5th day of April 1989
Notary Public...Betty B. Herring
Date Commission Expires 10-27-89

K.C.C. OFFICE USE ONLY
 Letter of Confidentiality Attached
 Wireline Log Received
 Drillers Time Log Received
Distribution
 KCC SWD/Rep NGPA
 KGS Plug Other
(Specify)

BETTY B. HERRING
NOTARY PUBLIC
STATE OF KANSAS
My Appt. Exp. 10-27-89

4-6-89 X2
Form ACO-1 (3-86)

Rank
Battery

Heavy
Gant
#1

Heavy
Gant
#2

Existing Wells and Tank
Battery

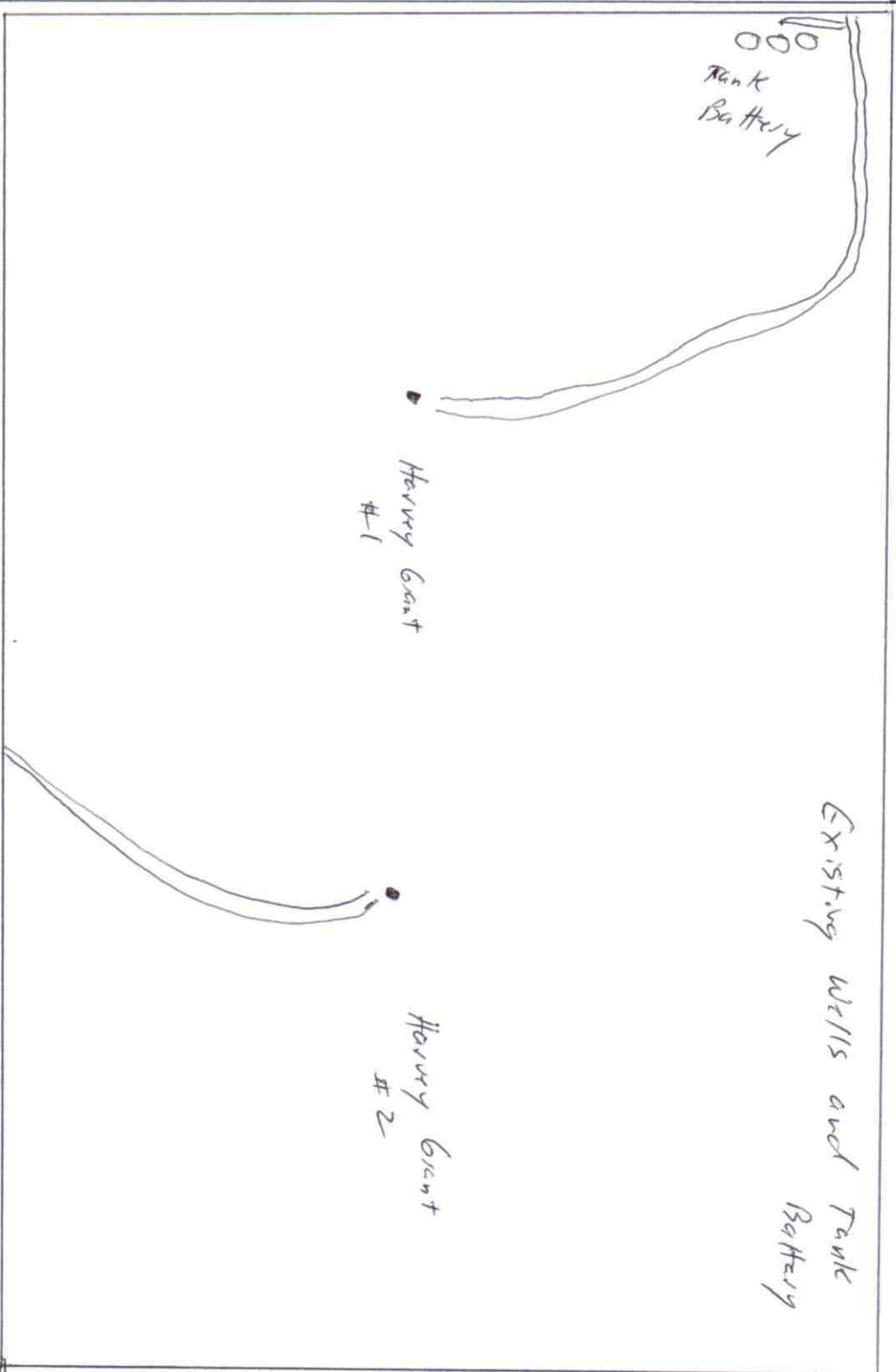

HOLES

SIDE TWO

Jay Boy Oil, Inc.

Lease Name: HARVEY GRANT FARM # 2

Sec. 2 Twp. 23 Rge. 2

East West

County: HARVEY

RELEASED MAY 18 1990

WELL LOG

FROM CONFIDENTIAL

INSTRUCTIONS: Show important tops and base of formations penetrated. Detail all cores. Report all drill tests giving interval tested, time tool open and closed, flowing and shut-in pressures, whether shut pressure reached static level, hydrostatic pressures, bottom hole temperature, fluid recovery, and flow if gas to surface during test. Attach extra sheet if more space is needed. Attach copy of log.

Drill Stem Tests Taken [x] Yes [] No
Samples Sent to Geological Survey [x] Yes [] No
Cores Taken [] Yes [x] No

Formation Description [x] Log [] Sample

DST #1: 2926-2980' (Mississippian)
1st op, GTS/11" Flow Oil/22" Ga 67 MCF,
Rec: 4 1/2 BO (450' oil) 120' MGO(22% M, 34%G, 44%O).
IHP: 1439#
IFP: 375-635#
ISIP: 802#
FHP: 1428#
DST #2: 3340-3355' (Viola) 45-60-45-60
1st op weak blow inc 4"; 2nd op weak blow thru-out.
Rec: 60' clean oil (27 degree gravity)
30' OCMW (14%O, 27%M, 59%W) 60' OCMW (7%O, 19%M, 74%W) Chl 41,000 ppm, system 2000 ppm.
IHP: 1711#
IFP: 10-20#
ISIP: 937#
BHT: 110°

Table with 3 columns: Name, Top, Bottom. Rows include Heebner, Lansing, Ft. Scott, Cke Sh, Mississippian, Kinderhook, Mis/Hunton, Viola, Simpson Sd.

CASING RECORD table with columns: Purpose of String, Size Hole Drilled, Size Casing Set (in O.D.), Weight Lbs/Ft., Setting Depth, Type of Cement, #Sacks Used, Type and Percent Additives. Includes PERFORATION RECORD and Acid, Fracture, Shot, Cement Squeeze Record.

METHOD OF COMPLETION
Disposition of gas: [] Vented [] Sold [x] Used on Lease
[] Open Hole [x] Perforation [] Other (Specify)
[] Dually Completed [] Coning/Led
Production Interval: 305A-63 Mississippian

BOY OIL, INC.

Harvey Grant Farms
DST Continued

RELEASED

MAY 0 8 1990

FROM CONFIDENTIAL

**TIGHT
HOLE!**

DST #3: (Simpson) 3382-3420', 30-30-30-30
25' of oil spk'd muddy water (1% Oil, 42%M, 57%W)
IHP: 1742#
IFP: 31-31#
ISIP: 854#
FFP: 31-31#
FSIP: 812#
FHP: 1732#
BHT: 113°

RECEIVED
STATE CORPORATION COMMISSION

APR 6 1989

KANSAS GEOLOGICAL SURVEY
WICHITA BRANCH

CONSERVATION DIVISION
Wichita, Kansas