



For KCC Use:
Effective Date:
District #
SGA? Yes No

KANSAS CORPORATION COMMISSION 1052697
OIL & GAS CONSERVATION DIVISION

Form C-1
March 2010

Form must be Typed
Form must be Signed
All blanks must be Filled

NOTICE OF INTENT TO DRILL

Must be approved by KCC five (5) days prior to commencing well

Form KSONA-1, Certification of Compliance with the Kansas Surface Owner Notification Act, MUST be submitted with this form.

Expected Spud Date: month day year

OPERATOR: License#
Name:
Address 1:
Address 2:
City: State: Zip:
Contact Person:
Phone:
CONTRACTOR: License#
Name:

Well Drilled For: Well Class: Type Equipment:
Oil Gas Enh Rec Storage Disposal Seismic; # of Holes Other
Infield Pool Ext. Wildcat Other
Mud Rotary Air Rotary Cable
If OWWO: old well information as follows:
Operator:
Well Name:
Original Completion Date: Original Total Depth:

Directional, Deviated or Horizontal wellbore? Yes No
If Yes, true vertical depth:
Bottom Hole Location:
KCC DKT #:

Spot Description:
Sec. Twp. S. R. E W
feet from N S Line of Section
feet from E W Line of Section
Is SECTION: Regular Irregular
(Note: Locate well on the Section Plat on reverse side)

County:
Lease Name: Well #:
Field Name:
Is this a Prorated / Spaced Field? Yes No
Target Formation(s):
Nearest Lease or unit boundary line (in footage):
Ground Surface Elevation: feet MSL
Water well within one-quarter mile: Yes No
Public water supply well within one mile: Yes No
Depth to bottom of fresh water:
Depth to bottom of usable water:
Surface Pipe by Alternate: I II
Length of Surface Pipe Planned to be set:
Length of Conductor Pipe (if any):
Projected Total Depth:
Formation at Total Depth:
Water Source for Drilling Operations: Well Farm Pond Other:
DWR Permit #:
(Note: Apply for Permit with DWR)
Will Cores be taken? Yes No
If Yes, proposed zone:

AFFIDAVIT

The undersigned hereby affirms that the drilling, completion and eventual plugging of this well will comply with K.S.A. 55 et. seq.
It is agreed that the following minimum requirements will be met:

- 1. Notify the appropriate district office prior to spudding of well;
2. A copy of the approved notice of intent to drill shall be posted on each drilling rig;
3. The minimum amount of surface pipe as specified below shall be set by circulating cement to the top; in all cases surface pipe shall be set through all unconsolidated materials plus a minimum of 20 feet into the underlying formation.
4. If the well is dry hole, an agreement between the operator and the district office on plug length and placement is necessary prior to plugging;
5. The appropriate district office will be notified before well is either plugged or production casing is cemented in;
6. If an ALTERNATE II COMPLETION, production pipe shall be cemented from below any usable water to surface within 120 DAYS of spud date. Or pursuant to Appendix "B" - Eastern Kansas surface casing order #133,891-C, which applies to the KCC District 3 area, alternate II cementing must be completed within 30 days of the spud date or the well shall be plugged. In all cases, NOTIFY district office prior to any cementing.

Submitted Electronically

For KCC Use ONLY
API # 15 -
Conductor pipe required feet
Minimum surface pipe required feet per ALT. I II
Approved by:
This authorization expires:
(This authorization void if drilling not started within 12 months of approval date.)
Spud date: Agent:

Remember to:

- File Certification of Compliance with the Kansas Surface Owner Notification Act (KSONA-1) with Intent to Drill;
- File Drill Pit Application (form CDP-1) with Intent to Drill;
- File Completion Form ACO-1 within 120 days of spud date;
- File acreage attribution plat according to field proration orders;
- Notify appropriate district office 48 hours prior to workover or re-entry;
- Submit plugging report (CP-4) after plugging is completed (within 60 days);
- Obtain written approval before disposing or injecting salt water.
- If well will not be drilled or permit has expired (See: authorized expiration date) please check the box below and return to the address below.

Well will not be drilled or Permit Expired Date:
Signature of Operator or Agent:

Mail to: KCC - Conservation Division,
130 S. Market - Room 2078, Wichita, Kansas 67202

E
W



1052697

For KCC Use ONLY

API # 15 - _____

IN ALL CASES PLOT THE INTENDED WELL ON THE PLAT BELOW

In all cases, please fully complete this side of the form. Include items 1 through 5 at the bottom of this page.

Operator: _____

Lease: _____

Well Number: _____

Field: _____

Number of Acres attributable to well: _____

QTR/QTR/QTR/QTR of acreage: _____ - _____ - _____ - _____

Location of Well: County: _____

_____ feet from N / S Line of Section

_____ feet from E / W Line of Section

Sec. _____ Twp. _____ S. R. _____ E W

Is Section: Regular or Irregular

If Section is Irregular, locate well from nearest corner boundary.

Section corner used: NE NW SE SW

PLAT

Show location of the well. Show footage to the nearest lease or unit boundary line. Show the predicted locations of lease roads, tank batteries, pipelines and electrical lines, as required by the Kansas Surface Owner Notice Act (House Bill 2032). You may attach a separate plat if desired.

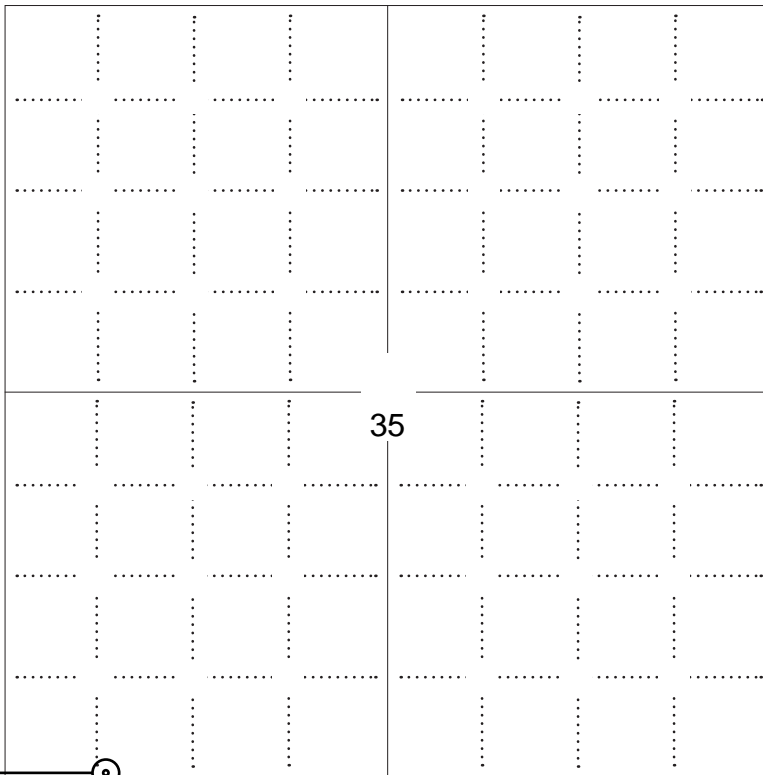

NOTE: In all cases locate the spot of the proposed drilling location.

35 ft.

In plotting the proposed location of the well, you must show:

1. The manner in which you are using the depicted plat by identifying section lines, i.e. 1 section, 1 section with 8 surrounding sections, 4 sections, etc.
2. The distance of the proposed drilling location from the south / north and east / west outside section lines.
3. The distance to the nearest lease or unit boundary line (in footage).
4. If proposed location is located within a prorated or spaced field a certificate of acreage attribution plat must be attached: (C0-7 for oil wells; CG-8 for gas wells).
5. The predicted locations of lease roads, tank batteries, pipelines, and electrical lines.

LEGEND

- Well Location
- Tank Battery Location
- Pipeline Location
- - - - Electric Line Location
- Lease Road Location

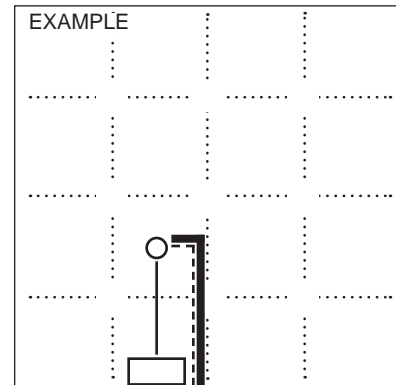

1980' FSL



APPLICATION FOR SURFACE PIT

Submit in Duplicate

Operator Name:		License Number:	
Operator Address:			
Contact Person:		Phone Number:	
Lease Name & Well No.:		Pit Location (QQQQ): ____ - ____ - ____ - ____	
Type of Pit: <input type="checkbox"/> Emergency Pit <input type="checkbox"/> Burn Pit <input type="checkbox"/> Settling Pit <input type="checkbox"/> Drilling Pit <input type="checkbox"/> Workover Pit <input type="checkbox"/> Haul-Off Pit <i>(If WP Supply API No. or Year Drilled)</i>		Pit is: <input type="checkbox"/> Proposed <input type="checkbox"/> Existing If Existing, date constructed: _____ Pit capacity: _____ (bbls)	
Is the pit located in a Sensitive Ground Water Area? <input type="checkbox"/> Yes <input type="checkbox"/> No		Chloride concentration: _____ mg/l <i>(For Emergency Pits and Settling Pits only)</i>	
Is the bottom below ground level? <input type="checkbox"/> Yes <input type="checkbox"/> No		Artificial Liner? <input type="checkbox"/> Yes <input type="checkbox"/> No	
Pit dimensions (all but working pits): _____ Length (feet) _____ Width (feet)		<input type="checkbox"/> N/A: Steel Pits	
Depth from ground level to deepest point: _____ (feet)		<input type="checkbox"/> No Pit	
If the pit is lined give a brief description of the liner material, thickness and installation procedure.		Describe procedures for periodic maintenance and determining liner integrity, including any special monitoring.	
Distance to nearest water well within one-mile of pit: _____ feet Depth of water well _____ feet		Depth to shallowest fresh water _____ feet. Source of information: <input type="checkbox"/> measured <input type="checkbox"/> well owner <input type="checkbox"/> electric log <input type="checkbox"/> KDWR	
Emergency, Settling and Burn Pits ONLY: Producing Formation: _____ Number of producing wells on lease: _____ Barrels of fluid produced daily: _____ Does the slope from the tank battery allow all spilled fluids to flow into the pit? <input type="checkbox"/> Yes <input type="checkbox"/> No		Drilling, Workover and Haul-Off Pits ONLY: Type of material utilized in drilling/workover: _____ Number of working pits to be utilized: _____ Abandonment procedure: _____ _____ Drill pits must be closed within 365 days of spud date.	
<p>Submitted Electronically</p>			

KCC OFFICE USE ONLY

Liner Steel Pit RFAC RFAS

Date Received: _____ Permit Number: _____ Permit Date: _____ Lease Inspection: Yes No



CERTIFICATION OF COMPLIANCE WITH THE KANSAS SURFACE OWNER NOTIFICATION ACT

This form must be submitted with all Forms C-1 (Notice of Intent to Drill); CB-1 (Cathodic Protection Borehole Intent); T-1 (Request for Change of Operator Transfer of Injection or Surface Pit Permit); and CP-1 (Well Plugging Application). Any such form submitted without an accompanying Form KSONA-1 will be returned.

Select the corresponding form being filed: C-1 (Intent) CB-1 (Cathodic Protection Borehole Intent) T-1 (Transfer) CP-1 (Plugging Application)

OPERATOR: License # _____
Name: _____
Address 1: _____
Address 2: _____
City: _____ State: _____ Zip: _____ + _____
Contact Person: _____
Phone: (_____) _____ Fax: (_____) _____
Email Address: _____

Well Location:
____ - ____ - ____ - ____ Sec. ____ Twp. ____ S. R. ____ East West
County: _____
Lease Name: _____ Well #: _____

If filing a Form T-1 for multiple wells on a lease, enter the legal description of the lease below:

Surface Owner Information:

Name: _____
Address 1: _____
Address 2: _____
City: _____ State: _____ Zip: _____ + _____

When filing a Form T-1 involving multiple surface owners, attach an additional sheet listing all of the information to the left for each surface owner. Surface owner information can be found in the records of the register of deeds for the county, and in the real estate property tax records of the county treasurer.

If this form is being submitted with a Form C-1 (Intent) or CB-1 (Cathodic Protection Borehole Intent), you must supply the surface owners and the KCC with a plat showing the predicted locations of lease roads, tank batteries, pipelines, and electrical lines. The locations shown on the plat are preliminary non-binding estimates. The locations may be entered on the Form C-1 plat, Form CB-1 plat, or a separate plat may be submitted.

Select one of the following:

- I certify that, pursuant to the Kansas Surface Owner Notice Act (House Bill 2032), I have provided the following to the surface owner(s) of the land upon which the subject well is or will be located: 1) a copy of the Form C-1, Form CB-1, Form T-1, or Form CP-1 that I am filing in connection with this form; 2) if the form being filed is a Form C-1 or Form CB-1, the plat(s) required by this form; and 3) my operator name, address, phone number, fax, and email address.
- I have not provided this information to the surface owner(s). I acknowledge that, because I have not provided this information, the KCC will be required to send this information to the surface owner(s). To mitigate the additional cost of the KCC performing this task, I acknowledge that I am being charged a \$30.00 handling fee, payable to the KCC, which is enclosed with this form.

If choosing the second option, submit payment of the \$30.00 handling fee with this form. If the fee is not received with this form, the KSONA-1 form and the associated Form C-1, Form CB-1, Form T-1, or Form CP-1 will be returned.

I Submitted Electronically

I

Map showing land parcels with owner names and parcel numbers. Owners include: Anna L. Jites, Bruce Alen Boydston, J.R. & W. Brown, M. & P. Hollome, Clifford & Misty Stahl, Jan. A. & Lorita Longnecker, Sidney A. McKnight, Jr., Daniel A. & Karen S. Wood, Gregory A. Garrota, Earl Edward Seif, Alvin O'Connell, James F. & Mima J. Ptacek, Alan & F. McDow, D. J. McPherson, Marvin & Anna L. Sities, Doris M. West, Kenneth Chese, F. & B. Hines, Bruce A. & Rita E. Boydston, Thomas Bland, Orvel Hoff, Thomas King, Betty Lou Oltam, W.J. & J.L. Page, J.D. & C.A. Self, Doug Melone, Larry R. & Irma Thompson, Sterling Vanlandingham, C.M. Hutton, Stephen & Cherry Buckley, George H. & Marilyn K. Stahl, HD Ventures LLC, Michael A. Kaiser, George & Marilyn Stahl, William L. Dyser, Gerald J. & Yvonne Atkins, John & Fred L. Kautl, Fred Louie Kautl, Kenneth Sloan, F.J. & J. Kesting, Richard Campbell, Mitchell W. Hylton, Paul J. & Edna Boots, Paul J. & Edna Boots, Sandra Kay Sandford, Charles & Carolyn Dunlop, Michael E. Wunach, G. & F. Hitz, J.J. Stahl, George Stahl, G.H. & M.K. Stahl, Joan Smith, Doria & Lois Breuel, Eugene & Nancy L. Lanham, Kenneth Sloan, Roman Catholic Archdiocese, Calvin Glen Zimmerman, Thomas M. Gilkison, C. & C. Dunlop, Kenton Workman, Gen. Fle. K, James & Colleen, C. Stahl, Ronald Zimmerman, Robert A. Zimmerman, Mary J. Gilkison, David Oite, Henry L. DeGraeve, Carl Schroeder, Judith Ann Stanard, Terry & Carolyn Boyle, Scot Jos. S., D.S. & S. Brake, J. & K.K. Morse, R.L. & D. Morse, W.J. & J. Frank, Maxine Breuel, Bernard K. & Susan Dumcum, Kenneth Sloan, R.E. & J. Dunlop, Kevin Whitcomb, Raymone E. & Jessie Dunlop, Mary J. Gilkison, David Oite, Henry L. DeGraeve, Carl Schroeder, D.S. & S. Brake, R.L. & D. Morse, W.J. & J. Frank, Maxine Breuel, Bernard K. & Susan Dumcum, Kenneth Sloan, R.E. & J. Dunlop, Kevin Whitcomb, Raymone E. & Jessie Dunlop, Mary J. Gilkison, David Oite, Henry L. DeGraeve, Carl Schroeder, Lester Hornhausen, Dora & Lois Breuel, Aiden F. Miller, Aiden F. Miller, Wilbur E. Eastwood, Kevin Whitcomb, Donald & Deborah Sellers, Charles Edwin McGrew, Henry L. DeGraeve, Carl Schroeder, Michelle Dawn Kinnel, Max Dale Hudson, Charles E. & Ruth E. McGrew, Ruth E. McGrew, L.D. Oll, Kenneth D. & Kathryn McGee, Nancy Dodson, Nancy Dodson, Kimmye Logan, E. & S. Canada, GHD Investments, Rita L. & Albert B. Wurtz, Sharon J. Johnson, J. & J. Oil, Co., Larry & Wendy Bahr, Betty R. Hudson, Charles E. & Ruth E. McGrew, Charles E. & Ruth E. McGrew, Joyce & John Fulgham, Myra Ingham & John Fulgham, C.E. & R.E. McGrew, C.E. McGrew, C.H.A., Cline Eastwood, Robert Wottin, M.L. & L.G. Frank, Suzanne R. Sprague, Pansy Bigley, James E. Miller, Kenneth Knight, Joanna Gilliland, Rogene K. McPherson, Robert H. Miller, Robert H. Miller, Robert H. Miller, John E. & Helen Barnes, Thomas M. Gilkison, John Brownback, Bobby Thomas, Charles E. & Ruth E. McGrew, Marsha F. Couch, L. & M. L. & M. L. & M. L., Lloyd & Linda Brownback, Loyd & Linda Brownback, Robert R. McArdle, Robert R. McArdle, Earnest E. & Laverne McGee, Mark Smith, Duard Cox, David E. Ughas, Hilma Ungheuer, Eugene Lanham, Walter E. & Joanne Lanham, Ronnie K. & Eva M. Thomas, Marvin G. Phillips, 1st Colony LLC, Victor & Dollie Clark, Larry & Linda Holt, Roger Medlin, Lloyd & Betty Mitchell, Robert & Judith McArdle, Karen Ann Perry, W.M. & F.L. Cox, L.L. III & B. Wilson, Hilma Ungheuer, Eugene Lanham, Dale W. Jackson, Willie & Winnie Clark, Leo Jackson, Dale L. Neal, Ronald E. Stringham, Bobby & Mary Thomas, Richard & Monica Trevor, Zula O. & B.M. Montgomery, David S. & Claudia Matthews, W. Maurice & Frances Cox, Lloyd L. III & Beth Wilson, W. Maurice & Francis L. Cox, Matthew L. Burkhead, Bruce Robinson, Eugene Lanham, L.R. & V. Jackson, L.R. & V. Jackson, Jesse & Janice Randal, K&N Latham, E. & N. Latham, 1st Colony LLC, 1st Colony LLC, W. & W. Clark, Roger Medlin, Richard & Monica Trevor, Midwest Radiology, Harris Family Trust, Duard Elgin Cox, Clifford W. Cox, Earnest & Laverne McGee, Brent Paddock, M.K. & D. Abraham, Lee R. Jackson, Glenn E. McGee, 1st Colony LLC, 1st Colony LLC, John Frank Felix, Gary L. & Kathleen Barnes, Jesse T. & Janice B. Randal, Richard & Monica Trevor, M.T. Smith, Howard R. Wright, William J. Kelly, II, Harris Family Trust, Edith G. Elliott, Clifford Cox, Daniel & Dorothy Morrill, Dale & Lois Wright, Brent Paddock, Glenn E. McGee, Public Wholesale Water, Dennie B. Gould, Wholesale Water, Jimmy D. & Vina L. Carr, Roger Medlin, Lynn Lillio, Jason Lillie, Frank E. & Cheryl Poole, Kandie E. Fairchild, Edward & Ann McLincy, Mary J. Sprague, Francis D. Barbour Jr., Gregory & Susan Johnson, Daniel Jay Morrill, Daniel & Dorothy Morrill, Daniel J. & Dorothy Morrill, D. & D. Morrill, Daniel Morrill, Public Wholesale Water, Glenn E. McGee, Dennie B. Gould, Dennie B. Gould, J.T. & J.B. Randal, Jesse T. & Janice B. Randal, Jesse & Janice Randal, Betty Mazum, William J. Mendle, V. & A. Flynn, Lloyd & Betty Jo Mitchell, Lloyd & Betty Jo Mitchell, B. Welch, Melvin & Kathryn Smith, Philip T. Stuller, E.J. & S. Tyler, Bobby Medlin, Daniel J. & Dorothy Morrill, Dale & Janice Sprague, Dale Sprague, Dale Sprague, Charlotte Morrell, STAL, Charlotte Morrell, STAL, Jack E. Morrell, STAL, Charlotto Morrell, James & Pamela Johnson, Ralph L. & Donna Sities, John & Anita Rowe, City of Mount City, F. & W. Hulans, Cynitha Brinken, Dale R. & Lois M. Wright, Robert E. & Doris M. West, Robert West, Bruce M. Mitchell, Carol Taylor, Dennis K. Harris, Bobby Medlin, Dale Sprague, Dale Sprague, Charlotte Morrell, STAL, Pamala Johnson, Ralph L. & Donna Sities, John & Anita Rowe, Gene Olson & Sue Thyrsa, City of Mount City, James & Nona Knox, Miller Family Trust, Doris M. West, Robert E. West, Melvin & Kathryn Smith, Gard Adrian Robinson, William S. Laughlin, Jeanette & Deter Kinsey, Patrick Curis, Dennis K. Harris, Truman A. & Elva V. Robinson, Bobby G. Medlin, Carol Paddock, Ralph L. & Donna Sities, Wayne E. Jones, Chad & Alicia Stoll, Carl W. Davis, Charlene E. Parker, Mark & Lillo Geenens, Barbara J. Petrie, Irma Hyson, Karl & Blanche Kempinger, Truman A. & Elva V. Robinson, Brent & Lori Paddock, Willis H., Truman A. & Elva V., Truman A. & Elva V., Francis D., Philip Gould, Peter & Eva Wilkin, Gary L. & Elaine Schaal, Philip Gould, Dan L. & Eleanor D., Gerald &



Lanham B1-I
Lanham B3-I
Lanham A2
Lanham A3
Lanham 3-I
Lanham C2
Lanham D3-I
Lanham 13-35
Lanham B5-I
Lanham SWD-1

W 1000 Rd

Current Roads on Property

Image USDA Farm Service Agency

© 2011 Google

lat 38.168217° lon -94.965301° elev 983 ft

©2010 Google

Imagery Date Jun 26, 2008

Eye alt 4362 ft

Lanham Lease

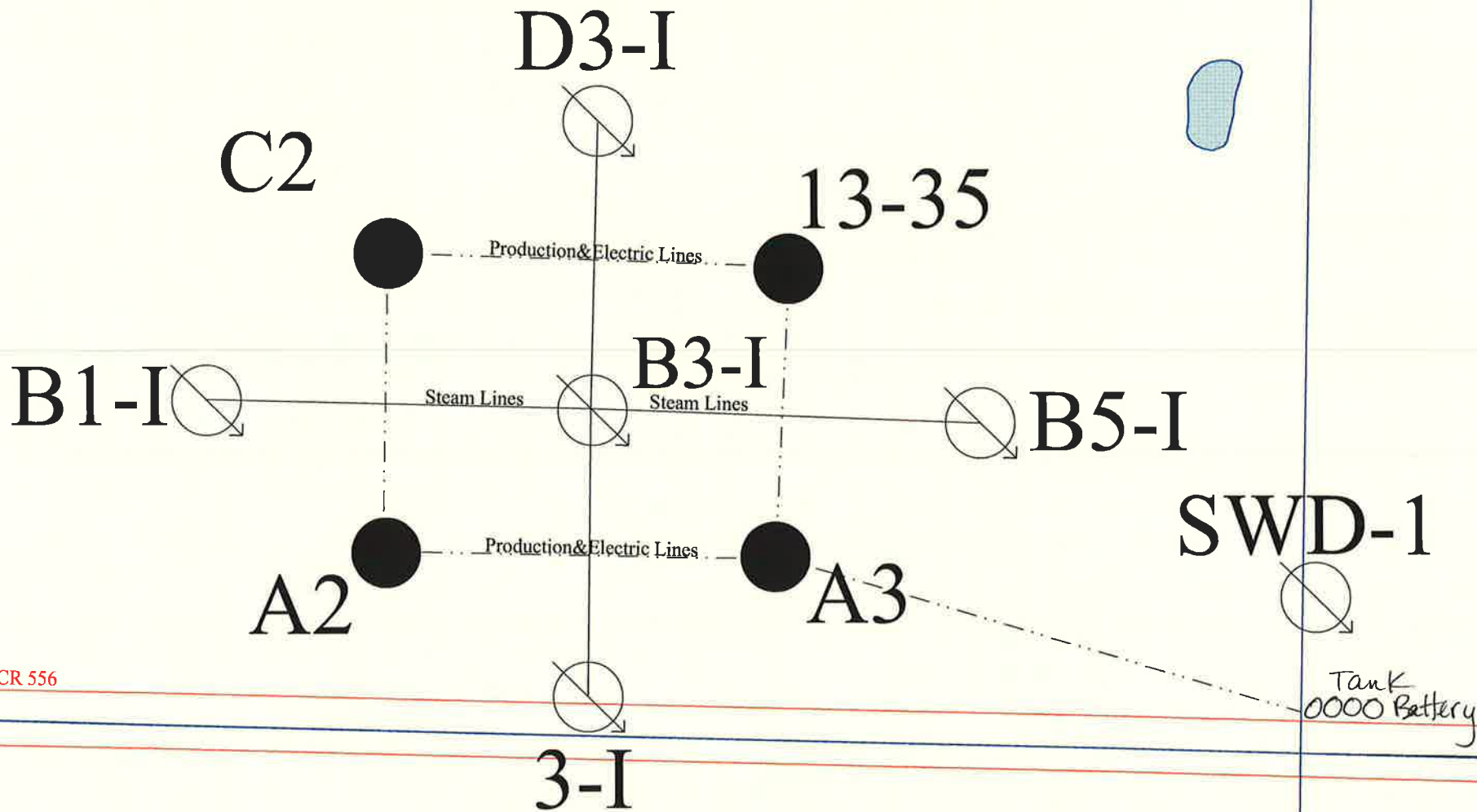

Farris Rd.

W. 1000 Rd./CR 556



**NOTICE TO OPERATORS FILING INTENT TO DRILL
FOR DISPOSAL OR ENHANCED RECOVERY
INJECTION WELLS, (CLASS II INJECTION WELL)**

The attached approved Notice of Intent to Drill indicates the proposed well is to be used for injection. An approved "Intent to Drill" does not approve injection authority as a Class II Injection Well in Kansas.

Before any well is used for injection purposes, the operator must file an application for injection authority in accordance with K.A.R. 82-3-401 and provide notice in accordance with K.A.R. 82-3-402. The Conservation Division must issue a written permit granting the application before commencement of injection.

The Conservation Division requirements and restrictions associated with Class II Injection are identified in K.A.R. 82-3-400 et seq of our regulations. Associated regulations governing drilling, completion and injection applications may be found in K.A.R. 82-3-135, Table I, Table II, in the Cedar Hills Sandstone Moratorium, (Docket #156,397-C), and the Eastern Kansas Surface Casing Order, (Docket #133,891-C).

If you have questions regarding the approval of injection authority, an injection application may be filed as a "Design Approval" before actual drilling and completion of the well occurs. If you have any questions or concerns regarding Class II injection wells or regulations, call the Underground Injection Control Department at 316-337-6200.

Failure to obtain commission approval before beginning injection is punishable by a penalty, shut-in of the well or both.