



For KCC Use:
 Effective Date: _____
 District # _____
 SGA? Yes No

KANSAS CORPORATION COMMISSION 1053529
OIL & GAS CONSERVATION DIVISION

Form C-1
 March 2010
Form must be Typed
Form must be Signed
All blanks must be Filled

NOTICE OF INTENT TO DRILL

Must be approved by KCC five (5) days prior to commencing well

Form KSONA-1, Certification of Compliance with the Kansas Surface Owner Notification Act, MUST be submitted with this form.

Expected Spud Date: _____
month day year

Spot Description: _____

OPERATOR: License# _____
 Name: _____
 Address 1: _____
 Address 2: _____
 City: _____ State: _____ Zip: _____ + _____
 Contact Person: _____
 Phone: _____

_____ - _____ - _____ Sec. _____ Twp. _____ S. R. _____ E W
(Q/Q/Q/Q)
 _____ feet from N / S Line of Section
 _____ feet from E / W Line of Section

Is SECTION: Regular Irregular?
 (Note: Locate well on the Section Plat on reverse side)

CONTRACTOR: License# _____
 Name: _____

County: _____
 Lease Name: _____ Well #: _____

Well Drilled For:	Well Class:	Type Equipment:
<input type="checkbox"/> Oil	<input type="checkbox"/> Enh Rec	<input type="checkbox"/> Infield
<input type="checkbox"/> Gas	<input type="checkbox"/> Storage	<input type="checkbox"/> Mud Rotary
	<input type="checkbox"/> Disposal	<input type="checkbox"/> Pool Ext.
<input type="checkbox"/> Seismic ; _____ # of Holes	<input type="checkbox"/> Wildcat	<input type="checkbox"/> Air Rotary
<input type="checkbox"/> Other: _____	<input type="checkbox"/> Other	<input type="checkbox"/> Cable
<input type="checkbox"/> If OWWO: old well information as follows:		
Operator: _____		
Well Name: _____		
Original Completion Date: _____ Original Total Depth: _____		

Is this a Prorated / Spaced Field? Yes No
 Target Formation(s): _____
 Nearest Lease or unit boundary line (in footage): _____

Ground Surface Elevation: _____ feet MSL
 Water well within one-quarter mile: Yes No
 Public water supply well within one mile: Yes No
 Depth to bottom of fresh water: _____
 Depth to bottom of usable water: _____
 Surface Pipe by Alternate: I II

Length of Surface Pipe Planned to be set: _____
 Length of Conductor Pipe (if any): _____
 Projected Total Depth: _____
 Formation at Total Depth: _____
 Water Source for Drilling Operations:
 Well Farm Pond Other: _____

Directional, Deviated or Horizontal wellbore? Yes No
 If Yes, true vertical depth: _____
 Bottom Hole Location: _____
 KCC DKT #: _____

DWR Permit #: _____
 (Note: Apply for Permit with DWR)
 Will Cores be taken? Yes No
 If Yes, proposed zone: _____

AFFIDAVIT

The undersigned hereby affirms that the drilling, completion and eventual plugging of this well will comply with K.S.A. 55 et. seq.

It is agreed that the following minimum requirements will be met:

1. Notify the appropriate district office **prior** to spudding of well;
2. A copy of the approved notice of intent to drill **shall be** posted on each drilling rig;
3. The minimum amount of surface pipe as specified below **shall be set** by circulating cement to the top; in all cases surface pipe **shall be set** through all unconsolidated materials plus a minimum of 20 feet into the underlying formation.
4. If the well is dry hole, an agreement between the operator and the district office on plug length and placement is necessary **prior to plugging**;
5. The appropriate district office will be notified before well is either plugged or production casing is cemented in;
6. If an ALTERNATE II COMPLETION, production pipe shall be cemented from below any usable water to surface within **120 DAYS** of spud date. Or pursuant to Appendix "B" - Eastern Kansas surface casing order #133,891-C, which applies to the KCC District 3 area, alternate II cementing must be completed within 30 days of the spud date or the well shall be plugged. **In all cases, NOTIFY district office** prior to any cementing.

Submitted Electronically

<p>For KCC Use ONLY</p> <p>API # 15 - _____</p> <p>Conductor pipe required _____ feet</p> <p>Minimum surface pipe required _____ feet per ALT. <input type="checkbox"/> I <input type="checkbox"/> II</p> <p>Approved by: _____</p> <p>This authorization expires: _____ <small>(This authorization void if drilling not started within 12 months of approval date.)</small></p> <p>Spud date: _____ Agent: _____</p>
--

Remember to:

- File Certification of Compliance with the Kansas Surface Owner Notification Act (KSONA-1) with Intent to Drill;
- File Drill Pit Application (form CDP-1) with Intent to Drill;
- File Completion Form ACO-1 within 120 days of spud date;
- File acreage attribution plat according to field proration orders;
- Notify appropriate district office 48 hours prior to workover or re-entry;
- Submit plugging report (CP-4) after plugging is completed (within 60 days);
- Obtain written approval before disposing or injecting salt water.
- If well will not be drilled or permit has expired (See: authorized expiration date) please check the box below and return to the address below.

Well will not be drilled or Permit Expired Date: _____
 Signature of Operator or Agent: _____

E
 W



1053529

For KCC Use ONLY

API # 15 - _____

IN ALL CASES PLOT THE INTENDED WELL ON THE PLAT BELOW

In all cases, please fully complete this side of the form. Include items 1 through 5 at the bottom of this page.

Operator: _____

Lease: _____

Well Number: _____

Field: _____

Number of Acres attributable to well: _____

QTR/QTR/QTR/QTR of acreage: _____ - _____ - _____ - _____

Location of Well: County: _____

_____ feet from N / S Line of Section

_____ feet from E / W Line of Section

Sec. _____ Twp. _____ S. R. _____ E W

Is Section: Regular or Irregular

If Section is Irregular, locate well from nearest corner boundary.

Section corner used: NE NW SE SW

PLAT

Show location of the well. Show footage to the nearest lease or unit boundary line. Show the predicted locations of lease roads, tank batteries, pipelines and electrical lines, as required by the Kansas Surface Owner Notice Act (House Bill 2032).

You may attach a separate plat if desired.

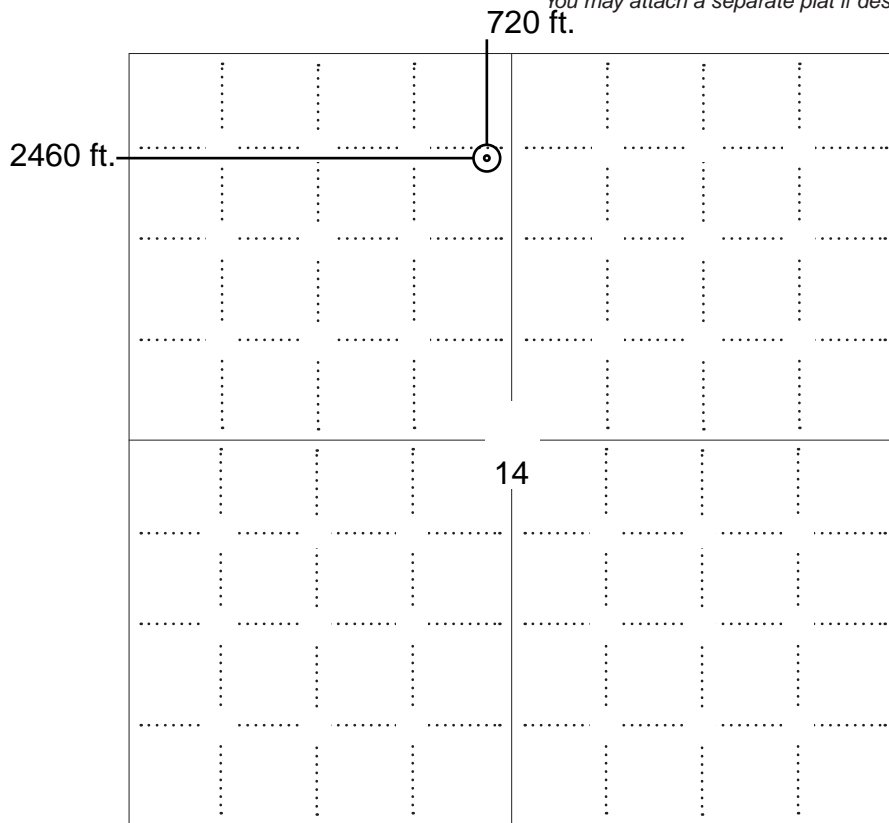

LEGEND

- Well Location
- Tank Battery Location
- Pipeline Location
- Electric Line Location
- Lease Road Location

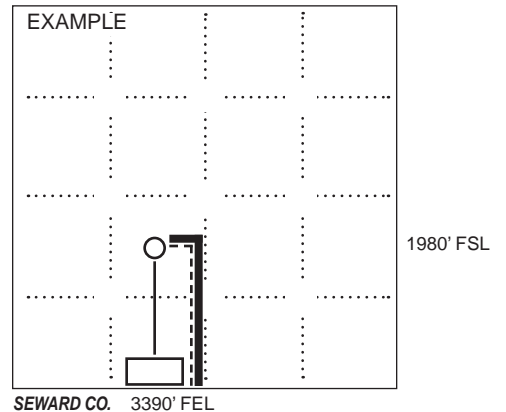

NOTE: In all cases locate the spot of the proposed drilling locaton.

In plotting the proposed location of the well, you must show:

1. The manner in which you are using the depicted plat by identifying section lines, i.e. 1 section, 1 section with 8 surrounding sections, 4 sections, etc.
2. The distance of the proposed drilling location from the south / north and east / west outside section lines.
3. The distance to the nearest lease or unit boundary line (in footage).
4. If proposed location is located within a prorated or spaced field a certificate of acreage attribution plat must be attached: (C0-7 for oil wells; CG-8 for gas wells).
5. The predicted locations of lease roads, tank batteries, pipelines, and electrical lines.



APPLICATION FOR SURFACE PIT

Submit in Duplicate

Operator Name: _____		License Number: _____	
Operator Address: _____			
Contact Person: _____		Phone Number: _____	
Lease Name & Well No.: _____		Pit Location (QQQQ): _____-_____-_____-_____	
Type of Pit: <input type="checkbox"/> Emergency Pit <input type="checkbox"/> Burn Pit <input type="checkbox"/> Settling Pit <input type="checkbox"/> Drilling Pit <input type="checkbox"/> Workover Pit <input type="checkbox"/> Haul-Off Pit <i>(If WP Supply API No. or Year Drilled)</i>		Pit is: <input type="checkbox"/> Proposed <input type="checkbox"/> Existing If Existing, date constructed: _____ Pit capacity: _____ (bbls)	
Is the pit located in a Sensitive Ground Water Area? <input type="checkbox"/> Yes <input type="checkbox"/> No		Chloride concentration: _____ mg/l <i>(For Emergency Pits and Settling Pits only)</i>	
Is the bottom below ground level? <input type="checkbox"/> Yes <input type="checkbox"/> No		Artificial Liner? <input type="checkbox"/> Yes <input type="checkbox"/> No	
How is the pit lined if a plastic liner is not used?			
Pit dimensions (all but working pits): _____ Length (feet) _____ Width (feet) <input type="checkbox"/> N/A: Steel Pits Depth from ground level to deepest point: _____ (feet) <input type="checkbox"/> No Pit			
If the pit is lined give a brief description of the liner material, thickness and installation procedure.		Describe procedures for periodic maintenance and determining liner integrity, including any special monitoring.	
Distance to nearest water well within one-mile of pit: _____ feet Depth of water well _____ feet		Depth to shallowest fresh water _____ feet. Source of information: <input type="checkbox"/> measured <input type="checkbox"/> well owner <input type="checkbox"/> electric log <input type="checkbox"/> KDWR	
Emergency, Settling and Burn Pits ONLY: Producing Formation: _____ Number of producing wells on lease: _____ Barrels of fluid produced daily: _____ Does the slope from the tank battery allow all spilled fluids to flow into the pit? <input type="checkbox"/> Yes <input type="checkbox"/> No		Drilling, Workover and Haul-Off Pits ONLY: Type of material utilized in drilling/workover: _____ Number of working pits to be utilized: _____ Abandonment procedure: _____ _____ Drill pits must be closed within 365 days of spud date.	
<p>Submitted Electronically</p>			

KCC OFFICE USE ONLY

Liner Steel Pit RFAC RFAS

Date Received: _____ Permit Number: _____ Permit Date: _____ Lease Inspection: Yes No



CERTIFICATION OF COMPLIANCE WITH THE KANSAS SURFACE OWNER NOTIFICATION ACT

This form must be submitted with all Forms C-1 (Notice of Intent to Drill); CB-1 (Cathodic Protection Borehole Intent); T-1 (Request for Change of Operator Transfer of Injection or Surface Pit Permit); and CP-1 (Well Plugging Application). Any such form submitted without an accompanying Form KSONA-1 will be returned.

Select the corresponding form being filed: C-1 (Intent) CB-1 (Cathodic Protection Borehole Intent) T-1 (Transfer) CP-1 (Plugging Application)

OPERATOR: License # _____
Name: _____
Address 1: _____
Address 2: _____
City: _____ State: _____ Zip: _____ + _____
Contact Person: _____
Phone: (_____) _____ Fax: (_____) _____
Email Address: _____

Well Location:
____ - ____ - ____ - ____ Sec. ____ Twp. ____ S. R. ____ East West
County: _____
Lease Name: _____ Well #: _____

If filing a Form T-1 for multiple wells on a lease, enter the legal description of the lease below:

Surface Owner Information:

Name: _____
Address 1: _____
Address 2: _____
City: _____ State: _____ Zip: _____ + _____

When filing a Form T-1 involving multiple surface owners, attach an additional sheet listing all of the information to the left for each surface owner. Surface owner information can be found in the records of the register of deeds for the county, and in the real estate property tax records of the county treasurer.

If this form is being submitted with a Form C-1 (Intent) or CB-1 (Cathodic Protection Borehole Intent), you must supply the surface owners and the KCC with a plat showing the predicted locations of lease roads, tank batteries, pipelines, and electrical lines. The locations shown on the plat are preliminary non-binding estimates. The locations may be entered on the Form C-1 plat, Form CB-1 plat, or a separate plat may be submitted.

Select one of the following:

- I certify that, pursuant to the Kansas Surface Owner Notice Act (House Bill 2032), I have provided the following to the surface owner(s) of the land upon which the subject well is or will be located: 1) a copy of the Form C-1, Form CB-1, Form T-1, or Form CP-1 that I am filing in connection with this form; 2) if the form being filed is a Form C-1 or Form CB-1, the plat(s) required by this form; and 3) my operator name, address, phone number, fax, and email address.
- I have not provided this information to the surface owner(s). I acknowledge that, because I have not provided this information, the KCC will be required to send this information to the surface owner(s). To mitigate the additional cost of the KCC performing this task, I acknowledge that I am being charged a \$30.00 handling fee, payable to the KCC, which is enclosed with this form.

If choosing the second option, submit payment of the \$30.00 handling fee with this form. If the fee is not received with this form, the KSONA-1 form and the associated Form C-1, Form CB-1, Form T-1, or Form CP-1 will be returned.

I Submitted Electronically

For KCC Use ONLY
 API # 15 - _____

IN ALL CASES PLOT THE INTENDED WELL ON THE PLAT BELOW

In all cases, please fully complete this side of the form. Include items 1 through 5 at the bottom of this page.

Operator: Red Oak Energy, Inc.
 Lease: Gilley
 Well Number: 1-14
 Field: Wildcat
 Number of Acres attributable to well: 80
 QTR/QTR/QTR/QTR of acreage: NE - SE - NE - NW

Location of Well: County: Ness
720 feet from N / S Line of Section
2460 feet from E / W Line of Section
 Sec. 14 Twp. 18 S. R. 22 E W
 Is Section: Regular or Irregular

If Section is Irregular, locate well from nearest corner boundary.
 Section corner used: NE NW SE SW

PLAT

Show location of the well. Show footage to the nearest lease or unit boundary line. Show the predicted locations of lease roads, tank batteries, pipelines and electrical lines, as required by the Kansas Surface Owner Notice Act (House Bill 2032). You may attach a separate plat if desired.

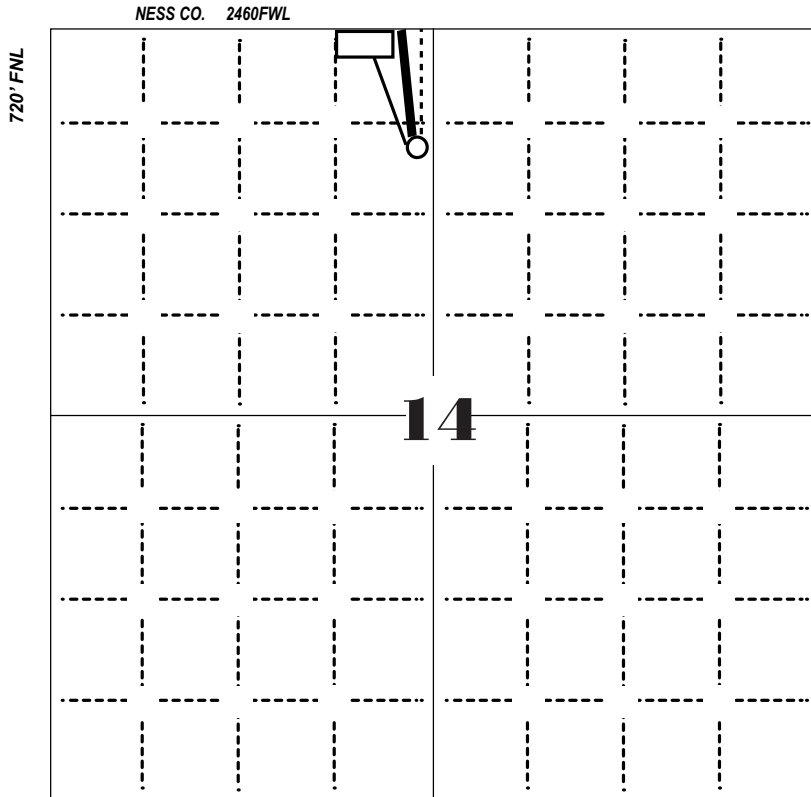

LEGEND

- Well Location
- Tank Battery Location
- Pipeline Location
- Electric Line Location
- Lease Road Location

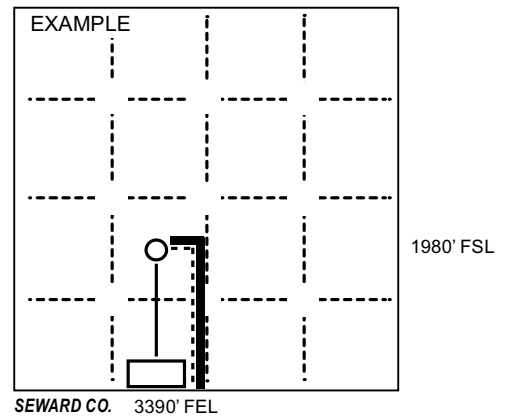

NOTE: In all cases locate the spot of the proposed drilling locaton.

In plotting the proposed location of the well, you must show

1. The manner in which you are using the depicted plat by identifying section lines, i.e. 1 section, 1 section with 8 surrounding sections, 4 sections, etc.
2. The distance of the proposed drilling location from the south / north and east / west outside section lines.
3. The distance to the nearest lease or unit boundary line (in footage). **720' FNL**
4. If proposed location is located within a prorated or spaced field a certificate of acreage attribution plat must be attached: (CO-7 for oil wells; CG-8 for gas wells).
5. The predicted locations of lease roads, tank batteries, pipelines, and electrical lines.

Date Recorded: 8/28/2009 8:10:00 AM

FORMER PRODUCER'S SPECIAL (PAID-UP)

63U (REV. 1993)

Recorded at request, KSA 58-2221.

Reorder No. 09-115

Kansas Blue Print
700 South Main Street, 7th Fl.
Wichita, KS 67202-0725
316-264-8344, 264-5165 fax
www.kbp.com · kbp@kbp.com

13th

August

2009

day of

Lonnie W. Gilley and Laura F. Gilley, Trustees

the Gilley Family Revocable Trust dated 8-28-2008

whose mailing address is 115 South Pecan Pauls Valley, Ok. 73075 hereinafter called Lessor (whether one or more),
and Palomino Petroleum Inc.

Lessor, in consideration of One and More Dollars (\$ One (1.00)) in hand paid, receipt of which is here acknowledged and of the royalties herein provided and of the agreements of the lessee herein contained, hereby grants, leases and lets exclusively unto lessee for the purpose of investigating, exploring by geophysical and other means, prospecting drilling, mining and operating for and producing oil, liquid hydrocarbons, all gases, and their respective constituent products, injecting gas, water, other fluids, and air into subsurface strata, laying pipe lines, storing oil, building tanks, power stations, telephone lines, and other structures and things thereon to produce, save, take care of, treat, manufacture, process, store and transport said oil, liquid hydrocarbons, gases and their respective constituent products and other products manufactured therefrom, and housing and otherwise caring for its employees, the following described land, together with any reversionary rights and after-acquired interest, therein situated in County of Ness State of Kansas described as follows to-wit:

Township 18 South, Range 22 West

Section 14: N/2

Section 11: SE/4- a tract. See RIDER attached

In Section _____ Township _____ Range _____ and containing _____ acra, more or less, and all accretions thereto. 328

Subject to the provisions herein contained, this lease shall remain in force for a term of from August 16, 2009 to August 16, 2011 as oil, liquid hydrocarbons, gas or other respective constituent products, or any of them, is produced from said land or land with which said land is pooled.

In consideration of the premises the said lease covenants and agrees:

1st. To deliver to the credit of lessor, free of cost, in the pipe line to which lessee may connect wells on said land, the equal one-eighth (1/8) part of all oil produced and saved from the leased premises.

2nd. To pay lessor for gas of whatsoever nature or kind produced and sold, or used off the premises, or used in the manufacture of any products therefrom, one-eighth (1/8) at the market price at the well, (but, as to gas sold by lessee, in no event more than one-eighth (1/8) of the proceeds received by lessee from such sales) for the gas sold, used off the premises, or in the manufacture of products therefrom, said payments to be made monthly. Where gas from a well producing gas only is not sold or used, lessee may pay or tender as royalty One Dollar (\$1.00) per year per net mineral acre retained hereunder, and if such payment or tender is made it will be considered that gas is being produced within the meaning of the preceding paragraph.

This lease may be maintained during the primary term hereof without further payment or drilling operations. If the lessee shall commence to drill a well within the term found in paying quantities, this lease shall continue and be in force with like effect as if such well had been completed within the term of years first mentioned.

If said lessor owns a less interest in the above described land than the entire and undivided fee simple estate therein, then the royalties herein provided for shall be paid the said lessor only in the proportion which lessor's interest bears to the whole and undivided fee.

Lessee shall have the right to use, free of cost, gas, oil and water produced on said land for lessee's operation thereon, except water from the wells of lessor.

When requested by lessor, lessee shall bury lessee's pipe lines below plow depth.

No well shall be drilled nearer than 200 feet to the house or barn now on said premises without written consent of lessor.

Lessee shall pay for damages caused by lessee's operations to growing crops on said land.

Lessee shall have the right at any time to remove all machinery and fixtures placed on said premises, including the right to draw and remove casing.

If the estate of either party hereto is assigned, and the privilege of assigning in whole or in part is expressly allowed, the covenants hereof shall extend to their heirs, executors, administrators, successors or assigns, but no change in the ownership of the land or assignment of rentals or royalties shall be binding on the lessee until after the lessee has been furnished with a written transfer or assignment or a true copy thereof. In case lessee assigns this lease, in whole or in part, lessee shall be relieved of all obligations with respect to the assigned portion or portions arising subsequent to the date of assignment.

Lessee may at any time execute and deliver to lessor or place of record a release or releases covering any portion or portions of the above described premises and thereby surrender this lease as to such portion or portions and be relieved of all obligations as to the acreage surrendered.

All express or implied covenants of this lease shall be subject to all Federal and State Laws, Executive Orders, Rules or Regulations, and this lease shall not be terminated, in whole or in part, nor lessee held liable in damages, for failure to comply therewith, if compliance is prevented by, or if such failure is the result of, any such Law, Order, Rule or Regulation.

Lessor hereby warrants and agrees to defend the title to the lands herein described, and agrees that the lessee shall have the right at any time to redeem for lessor, by payment any mortgages, taxes or other liens on the above described lands, in the event of default of payment by lessor, and be subrogated to the rights of the holder thereof, and the undersigned lessors, for themselves and their heirs, successors and assigns, hereby surrender and release all right of dower and homestead in the premises described herein, in so far as said right of dower and homestead may in any way affect the purposes for which this lease is made, as recited herein.

Lessee, at its option, is hereby given the right and power to pool or combine the acreage covered by this lease or any portion thereof with other land; lease or leases in the immediate vicinity thereof, when in lessee's judgment it is necessary or advisable to do so in order to properly develop and operate said lease premises so as to promote the conservation of oil, gas or other minerals in and under and that may be produced from said premises, such pooling to be of tracts contiguous to one another and to be into a unit or units not exceeding 40 acres each in the event of an oil well, or into a unit or units not exceeding 640 acres each in the event of a gas well. Lessee shall execute in writing and record in the conveyance records of the county in which the land herein leased is situated an instrument identifying and describing the pooled acreage. The entire acreage so pooled into a tract or unit shall be treated, for all purposes except the payment of royalties on production from the pooled unit, as if it were included in this lease. If production is found on the pooled acreage, it shall be treated as if production is had from this lease, whether the well or wells be located on the premises covered by this lease or not. In lieu of the royalties elsewhere herein specified, lessor shall receive on production from a unit so pooled only such portion of the royalty stipulated herein as the amount of his acreage placed in the unit or his royalty interest therein on an acreage basis bears to the total acreage so pooled in the particular unit involved.

This lease is comprised of two (2) separate leases described as the following tracts:

Tract 1: NE/4 14-18-22 and tract in SE/4 11-18-22

Tract 2: NW/4 14-18-22

Any unit created by acreage in this lease shall not exceed ten (10) acres in size without written consent of Lessor.

IN WITNESS WHEREOF, the undersigned execute this instrument as of the day and year first above written.

Witnesses:

Lonnie W. Gilley
Lonnie W. Gilley, Trustee

Laura F. Gilley, Trustee

Laura F. Gilley

Trust ID: _____

STATE OF Oklahoma
COUNTY OF Harvin
The foregoing instrument was acknowledged before me this _____ day of _____, _____, by Lonnie W. Gilley

ACKNOWLEDGMENT FOR INDIVIDUAL (KsOkCoNe)
18th day of August, 2009,
by Laura F. Gilley

Trustees of the Gilley Family Revocable Trust 8-28-2008

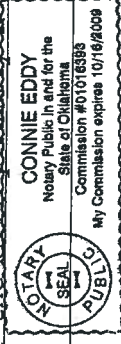

Connie Eddy
Notary Public

My commission expires _____

STATE OF _____
COUNTY OF _____
The foregoing instrument was acknowledged before me this _____ day of _____, _____, by _____ and _____

My commission expires _____
Notary Public

STATE OF _____
COUNTY OF _____
The foregoing instrument was acknowledged before me this _____ day of _____, _____, by _____ and _____

My commission expires _____
Notary Public

STATE OF _____
COUNTY OF _____
The foregoing instrument was acknowledged before me this _____ day of _____, _____, by _____ and _____

My commission expires _____
Notary Public

No. _____

OIL AND GAS LEASE

FROM _____

TO _____

Date _____

Section _____ Twp. _____ Rge. _____

No. of Acres _____ Term _____

County _____

STATE OF _____

County _____

This instrument was filed for record on the _____ day of _____, _____, at _____ o'clock _____ M., and duly recorded in Book _____ Page _____ of the records of this office.

By _____

When recorded, return to _____

Register of Deeds.

STATE OF _____
COUNTY OF _____
The foregoing instrument was acknowledged before me this _____ day of _____, _____, by _____ a _____ corporation, on behalf of the corporation.
My commission expires _____
Notary Public

RIDER

A tract of land in the Southeast Quarter (SE¹/₄) of Section Eleven (11), Township Eighteen (18) South, Range Twenty-two (22) West of the 6th P.M., more fully described as follows: Beginning at a point on the South line of said SE¹/₄, 1463.30 feet west of the Southeast corner of said SE¹/₄; thence N74°28'00"W a distance of 117.95 feet to a point; thence N48°51'57"W a distance of 199.37 feet to a point; thence N50°38'36"W a distance of 398.52 feet to a point; thence N76°46'32"W a distance of 88.87 feet to a point; thence N88°54'34"W a distance of 142.21 feet to a point; thence S87°22'21"W a distance of 161.66 feet to a point; thence S69°16'22"W a distance of 68.56 feet to a point; thence S45°59'46"W a distance of 72.28 feet to a point; thence S31°42'52"W a distance of 90.21 feet to a point; thence S17°21'27"W a distance of 103.47 feet to a point; thence S12°20'29"W a distance of 80.92 feet to a point; thence S28°22'38"W a distance of 29.08 feet to a point; thence S38°21'39"W a distance of 89.96 feet to the Southwest corner of said Southeast Quarter; thence N90°00'00"E along the south line of said SE¹/₄, a distance of 1236.70 feet to the point of beginning, said tract containing 7.867 acres more or less. All bearings are assumed,

Conservation Division
Finney State Office Building
130 S. Market, Rm. 2078
Wichita, KS 67202-3802



phone: 316-337-6200
fax: 316-337-6211
<http://kcc.ks.gov/>

Thomas E. Wright, Chairman
Ward Loyd, Commissioner

Corporation Commission

Sam Brownback, Governor

April 18, 2011

Sean Deenihan
Red Oak Energy, Inc.
7701 E KELLOGG DR STE 710
PO BOX 783140
WICHITA, KS 67207-1738

Re: Drilling Pit Application
Gilley 1-14
NW/4 Sec.14-18S-22W
Ness County, Kansas

Dear Sean Deenihan:

District staff has inspected the above referenced location and has determined that the reserve pit shall be constructed **without slots**, the bottom shall be flat and reasonably level, and the free fluids must be removed. The fluids are to be removed from the reserve pit within 96 hours of completion of drilling operations.

If production casing is set all completion fluids shall be removed from the working pits daily. NO completion fluids or non-exempt wastes shall be placed in the reserve pit.

The fluids should be taken to an authorized disposal well. Please call the District Office at (620) 225-8888 when the fluids have been removed. Please file form CDP-5 (August 2008), Exploration and Production Waste Transfer, through KOLAR within 30 days of fluid removal.

A copy of this letter should be posted in the doghouse along with the approved Intent to Drill. If you have any questions or concerns please feel free to contact the District Office at (620) 225-8888.