

# ADVANTAGE ELEVATIONS

OIL FIELD SURVEYORS

BOX 8604 - PRATT, KS 67124  
(620) 672-6491



511112  
INVOICE NO.

R & B OIL & GAS OPERATOR NO. 2 Hrincher A FARM  
Barber COUNTY 19 S 32s T 10w R SE SE SW LOCATION  
ELEVATION: 1468' GR

R & B OIL & GAS  
PO Box 195  
Attica KS 67009-0195

AUTHORIZED BY: Randy Newberry

SCALE: 1" = 1000'

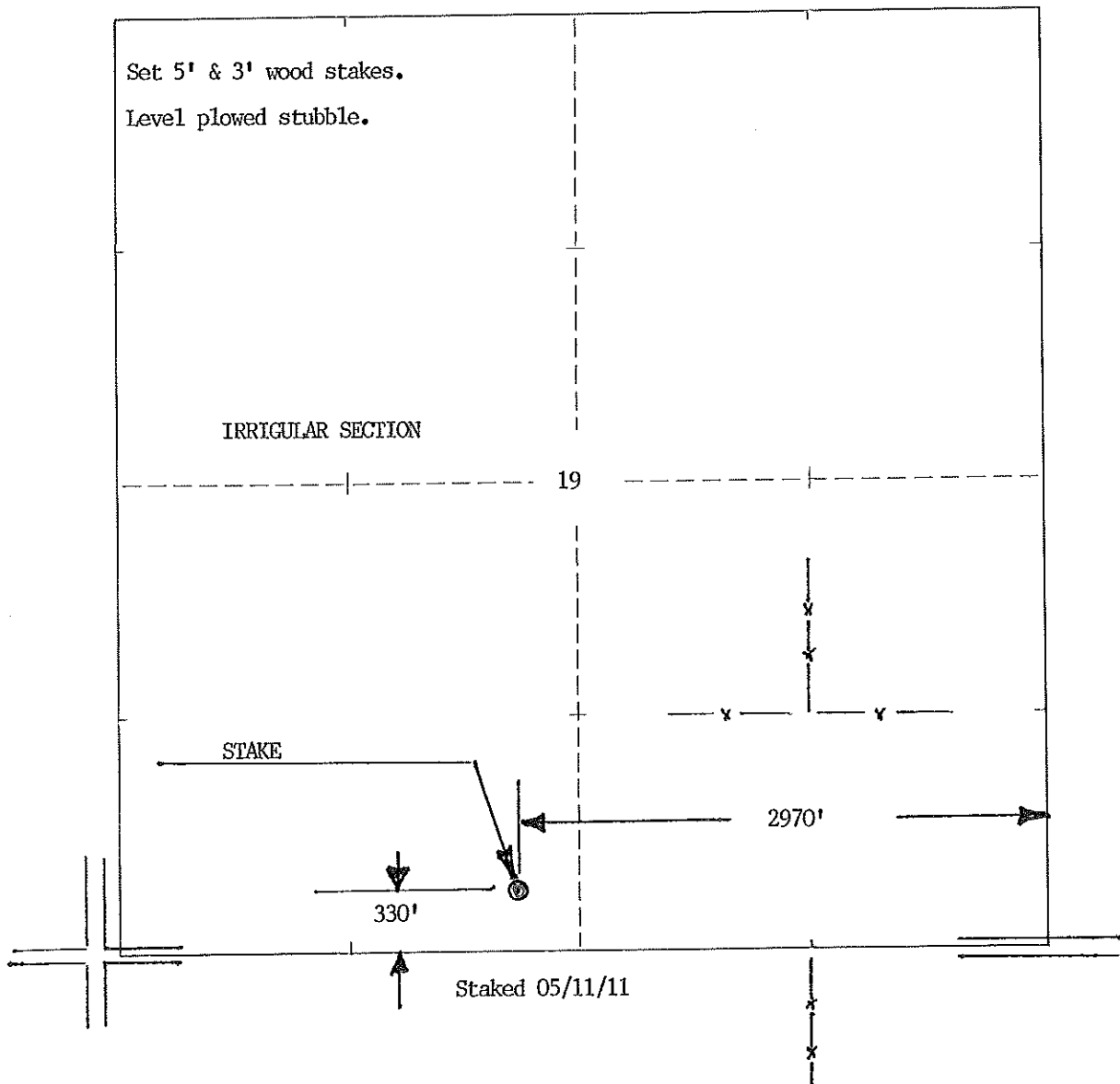



W. 27'30" R. 10 W.

549

6358 IV SW  
(SHARON NORTH)

