



This Form must be Typed
Form must be Signed
All blanks must be Filled

WELL PLUGGING APPLICATION

Form KSONA-1, Certification of Compliance with the Kansas Surface Owner Notification Act,
MUST be submitted with this form.

OPERATOR: License #: _____
Name: _____
Address 1: _____
Address 2: _____
City: _____ State: _____ Zip: _____ + _____
Contact Person: _____
Phone: (_____) _____

API No. 15 - _____
If pre 1967, supply original completion date: _____
Spot Description: _____
____ - ____ - ____ Sec. ____ Twp. ____ S. R. ____ East West
____ Feet from North / South Line of Section
____ Feet from East / West Line of Section
Footages Calculated from Nearest Outside Section Corner:
 NE NW SE SW
County: _____
Lease Name: _____ Well #: _____

Check One: Oil Well Gas Well OG D&A Cathodic Water Supply Well Other: _____
 SWD Permit #: _____ ENHR Permit #: _____ Gas Storage Permit #: _____

Conductor Casing Size: _____ Set at: _____ Cemented with: _____ Sacks
Surface Casing Size: _____ Set at: _____ Cemented with: _____ Sacks
Production Casing Size: _____ Set at: _____ Cemented with: _____ Sacks

List (ALL) Perforations and Bridge Plug Sets:

Elevation: _____ (G.L. / K.B.) T.D.: _____ PBTD: _____ Anhydrite Depth: _____
(Stone Corral Formation)

Condition of Well: Good Poor Junk in Hole Casing Leak at: _____
(Interval)

Proposed Method of Plugging (attach a separate page if additional space is needed):

Is Well Log attached to this application? Yes No Is ACO-1 filed? Yes No

If ACO-1 not filed, explain why:

Plugging of this Well will be done in accordance with K.S.A. 55-101 et. seq. and the Rules and Regulations of the State Corporation Commission

Company Representative authorized to supervise plugging operations: _____
Address: _____ City: _____ State: _____ Zip: _____ + _____
Phone: (_____) _____
Plugging Contractor License #: _____ Name: _____
Address 1: _____ Address 2: _____
City: _____ State: _____ Zip: _____ + _____
Phone: (_____) _____

Proposed Date of Plugging (if known): _____

Payment of the Plugging Fee (K.A.R. 82-3-118) will be guaranteed by Operator or Agent

Submitted Electronically



CERTIFICATION OF COMPLIANCE WITH THE KANSAS SURFACE OWNER NOTIFICATION ACT

This form must be submitted with all Forms C-1 (Notice of Intent to Drill); CB-1 (Cathodic Protection Borehole Intent); T-1 (Request for Change of Operator Transfer of Injection or Surface Pit Permit); and CP-1 (Well Plugging Application). Any such form submitted without an accompanying Form KSONA-1 will be returned.

Select the corresponding form being filed: C-1 (Intent) CB-1 (Cathodic Protection Borehole Intent) T-1 (Transfer) CP-1 (Plugging Application)

OPERATOR: License # _____
Name: _____
Address 1: _____
Address 2: _____
City: _____ State: _____ Zip: _____ + _____
Contact Person: _____
Phone: (_____) _____ Fax: (_____) _____
Email Address: _____

Well Location:
____ - ____ - ____ - ____ Sec. ____ Twp. ____ S. R. ____ East West
County: _____
Lease Name: _____ Well #: _____

If filing a Form T-1 for multiple wells on a lease, enter the legal description of the lease below:

Surface Owner Information:

Name: _____
Address 1: _____
Address 2: _____
City: _____ State: _____ Zip: _____ + _____

When filing a Form T-1 involving multiple surface owners, attach an additional sheet listing all of the information to the left for each surface owner. Surface owner information can be found in the records of the register of deeds for the county, and in the real estate property tax records of the county treasurer.

If this form is being submitted with a Form C-1 (Intent) or CB-1 (Cathodic Protection Borehole Intent), you must supply the surface owners and the KCC with a plat showing the predicted locations of lease roads, tank batteries, pipelines, and electrical lines. The locations shown on the plat are preliminary non-binding estimates. The locations may be entered on the Form C-1 plat, Form CB-1 plat, or a separate plat may be submitted.

Select one of the following:

- I certify that, pursuant to the Kansas Surface Owner Notice Act (House Bill 2032), I have provided the following to the surface owner(s) of the land upon which the subject well is or will be located: 1) a copy of the Form C-1, Form CB-1, Form T-1, or Form CP-1 that I am filing in connection with this form; 2) if the form being filed is a Form C-1 or Form CB-1, the plat(s) required by this form; and 3) my operator name, address, phone number, fax, and email address.
- I have not provided this information to the surface owner(s). I acknowledge that, because I have not provided this information, the KCC will be required to send this information to the surface owner(s). To mitigate the additional cost of the KCC performing this task, I acknowledge that I am being charged a \$30.00 handling fee, payable to the KCC, which is enclosed with this form.

If choosing the second option, submit payment of the \$30.00 handling fee with this form. If the fee is not received with this form, the KSONA-1 form and the associated Form C-1, Form CB-1, Form T-1, or Form CP-1 will be returned.

I Submitted Electronically

WELL RECORD

Mail to Corporation Commission, Oklahoma City, Oklahoma

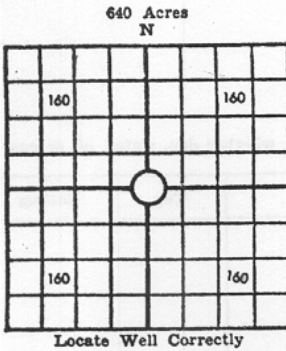

COUNTY McPherson, SEC. 29, TWP. 21S, RGE. 1W
 COMPANY OPERATING Continental Oil Company
 OFFICE ADDRESS Ponca City, Oklahoma
 FARM NAME J.P. Husman WELL NO. #9
 DRILLING STARTED Sept. 4, 1939, DRILLING FINISHED Sept. 30, 1939
 DATE OF FIRST PRODUCTION 10-4-39 COMPLETED
 WELL LOCATED 330' North and 330' East of West 1/4 Corner
of the above section 1/4 it. North of South
 Line and 1/4 it. East of West Line of Quarter Section.
 Elevation (Relative to sea level) DERRICK FLR. 1470 GROUND 1470
 CHARACTER OF WELL (Oil, gas or dry hole) Oil

OIL OR GAS SANDS OR ZONES

Name	From	To	Name	From	To
1 <u>Hunton Lime</u>	<u>3240</u>	<u>3280</u>	<u>4</u>		
2			<u>5</u>		
3			<u>6</u>		

WATER SANDS

Name	From	To	Water level	Name	From	To	Water level
1				<u>4</u>			
2				<u>5</u>			
3				<u>6</u>			

CASING RECORD

Size	Wt.	Thds.	Make	Amount Set		Amount Pulled		Packer Record			
				Ft.	In.	Ft.	In.	Size	Length	Depth Set	Make.
<u>10-3/4"</u>	<u>40</u>	<u>8</u>	<u>LW</u>	<u>138</u>	<u>1</u>		<u>None</u>				
<u>6"</u>	<u>15</u>	<u>8 DP</u>	<u>SS</u>	<u>3266</u>	<u>4</u>		<u>None</u>				

Liner Record: Amount Kind Top Bottom

CEMENTING AND MUDDING RECORD

Size	Amount Set		Sacks Cement	Chemical		Method of Cementing	Amount	Mudding Method	Results (See Note)
	Feet	In.		Gal.	Make				
<u>10-3/4"</u>	<u>138</u>	<u>1</u>	<u>165</u>			<u>Halliburton</u>			
<u>6"</u>	<u>3266</u>	<u>4</u>	<u>300</u>			<u>do</u>			
				<u>4,000</u>	<u>Chemical Process Co</u>				

NOTE: What method was used to protect sands when outer strings were pulled?

NOTE: Were bottom hole plugs used? If so, state kind, depth set and results obtained

TOOLS USED

Rotary tools were used from 0 feet to 3254 feet, and from feet to
 Cable tools were used from 3254 feet to 3280 feet, and from feet to
 Type Rig.

PRODUCTION DATA

Production first 24 hours 427 bbls. Gravity, Emulsion per cent., Water per cent
 Production second 24 hours bbls. Gravity, Emulsion per cent., Water per cent
 If gas well, cubic per 24 hours Rock Pressure lbs. per square inch

I, the undersigned, being first duly sworn upon oath, state that this well record is true, correct and complete according to the records of this office and to the best of my knowledge and belief.

JPN:HW
 10-6-39
 LPC
 GEOL.
 GULE
 OHIO
 FILE

J.P. Husman
 Name and title of representative of company.

Subscribed and sworn to before me this the 6 day of October 1939

My Commission expires Notary Public.

FORMATION RECORD

Give detailed description and thickness of all formations drilled through and contents of sands, whether dry, water, oil or gas

Formation	Top	Bottom	Formation	Top	Bottom
Surface Clay & Sand	0	20			
Shale	20	44			
Shale & Shells	44	84			
Sand	84	99			
Sandy Lime	99	129			
Sand and Lime	129	148	Run & set 138'1" of 10-3/4" casing at		
Lime	148	237	149' cemented w/165 sacks & 200#CC		
Shale & Shells	237	439			
Broken Lime	439	572			
Shale & Shells	572	677			
Lime & Shale Break	677	773			
Broken Lime	773	894			
Lime & Shale	894	1040			
Broken Lime	1040	1142			
Shale & Shells	1142	1621			
Broken Lime	1621	1745			
Shale & Shells	1745	1813			
Broken Lime	1813	1901			
Lime	1901	1996			
Broken Lime	1996	2110			
Sandy Lime	2110	2150			
Broken Lime	2150	2200			
Lime	2200	2210			
Shale	2210	2249			
Shale & Shells	2249	2290			
Shale	2290	2294			
Lime	2294	2557			
Hard Lime	2557	2609			
Sticky Shale	2609	2631			
Broken Lime	2631	2664			
Shale	2664	2692			
Shale & Shells	2692	2741			
Shale	2741	2890			
Chat	2890	2898			
Chert	2898	2942			
Chat	2942	3014			
Chert	3014	3032			
Chat	3032	3037			
Lime	3037	3127			
Shale	3127	3184			
Shale & Shells	3184	3231			
Shale	3231	3240			
Hunton Lime	3240	3254	Show of oil Run & set 3266'4" of 6"OD. at		
Lime	3254	3280	3242' & cemented w/300 sacks Ideal cement		
Total Depth from Ground level 3280'					



Conservation Division
Finney State Office Building
130 S. Market, Rm. 2078
Wichita, KS 67202-3802



Phone: 316-337-6200
Fax: 316-337-6211
<http://kcc.ks.gov/>

Mark Sievers, Chairman
Ward Loyd, Commissioner
Thomas E. Wright, Commissioner

Sam Brownback, Governor

June 09, 2011

Bryan Hess
Hess Oil Company
PO BOX 1009
MCPHERSON, KS 67460-1009

Re: Plugging Application
API 15-113-04611-00-00
HUXMAN JP 9
NW/4 Sec.29-21S-01W
McPherson County, Kansas

Dear Bryan Hess:

This letter is to notify you that the Conservation Division has received your plugging proposal, form CP-1, for the above well and has reviewed the proposal for completeness. The central office will now forward your CP-1 to the district office listed below for review of the proposed plugging method. **Please contact the district office for approval of your proposed plugging method at least five (5) days before plugging the well, pursuant to K.A.R. 82-3-113(b). If a workover pit will be used during the plugging of the well it must be permitted. A CDP-1 form must be filed and approved prior to the use of the pit in accordance with K.A.R. 82-3-600.**

The Conservation Division's review of form CP-1, either in the central or district office, does not include an inquiry into well ownership or the filing operator's legal right to plug the well. This notice in no way constitutes authorization to plug the above well by persons not having legal rights of ownership or interest in the well.

This notice is void after December 06, 2011. The CP-1 filing does not bring the above well into compliance with K.A.R 82-3-111 with regard to the Commission's temporary abandonment requirements.

Sincerely,
Production Department Supervisor

cc: District 2

(316) 630-4000