





1058213

For KCC Use ONLY

API # 15 - \_\_\_\_\_

### IN ALL CASES PLOT THE INTENDED WELL ON THE PLAT BELOW

In all cases, please fully complete this side of the form. Include items 1 through 5 at the bottom of this page.

Operator: \_\_\_\_\_

Lease: \_\_\_\_\_

Well Number: \_\_\_\_\_

Field: \_\_\_\_\_

Number of Acres attributable to well: \_\_\_\_\_

QTR/QTR/QTR/QTR of acreage: \_\_\_\_\_ - \_\_\_\_\_ - \_\_\_\_\_ - \_\_\_\_\_

Location of Well: County: \_\_\_\_\_

\_\_\_\_\_ feet from  N /  S Line of Section

\_\_\_\_\_ feet from  E /  W Line of Section

Sec. \_\_\_\_\_ Twp. \_\_\_\_\_ S. R. \_\_\_\_\_  E  W

Is Section:  Regular or  Irregular

**If Section is Irregular, locate well from nearest corner boundary.**

Section corner used:  NE  NW  SE  SW

### PLAT

Show location of the well. Show footage to the nearest lease or unit boundary line. Show the predicted locations of lease roads, tank batteries, pipelines and electrical lines, as required by the Kansas Surface Owner Notice Act (House Bill 2032). You may attach a separate plat if desired.

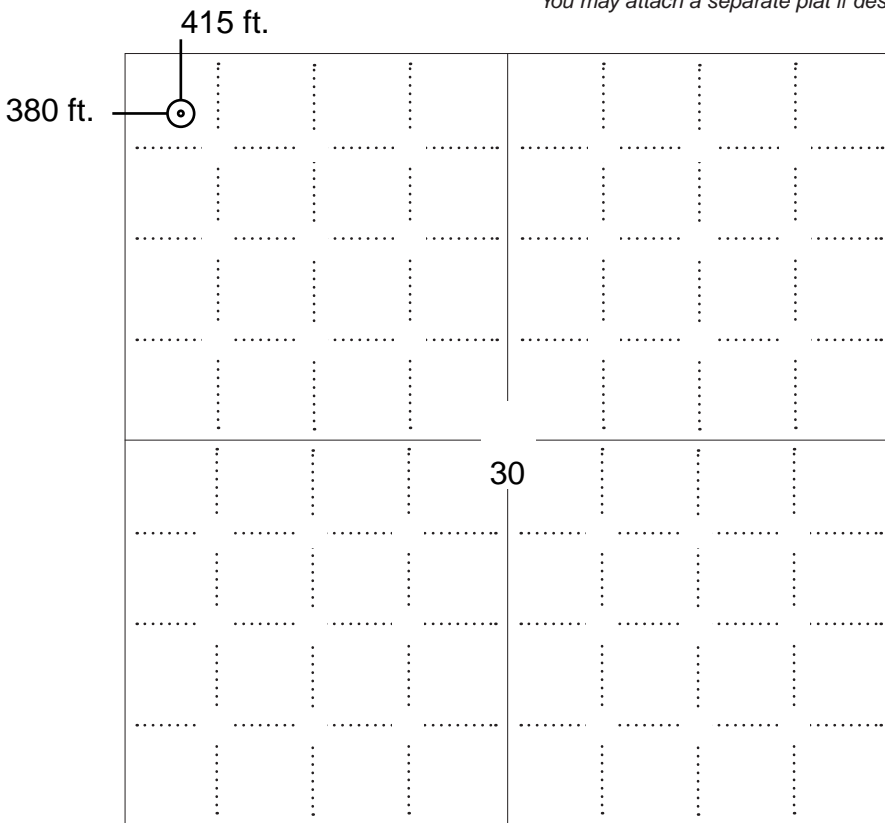

### LEGEND

- Well Location
- Tank Battery Location
- Pipeline Location
- Electric Line Location
- Lease Road Location



**NOTE: In all cases locate the spot of the proposed drilling locaton.**

#### In plotting the proposed location of the well, you must show:

1. The manner in which you are using the depicted plat by identifying section lines, i.e. 1 section, 1 section with 8 surrounding sections, 4 sections, etc.
2. The distance of the proposed drilling location from the south / north and east / west outside section lines.
3. The distance to the nearest lease or unit boundary line (in footage).
4. If proposed location is located within a prorated or spaced field a certificate of acreage attribution plat must be attached: (C0-7 for oil wells; CG-8 for gas wells).
5. The predicted locations of lease roads, tank batteries, pipelines, and electrical lines.



KANSAS CORPORATION COMMISSION 1058213  
OIL & GAS CONSERVATION DIVISION

Form CDP-1  
May 2010  
Form must be Typed

**APPLICATION FOR SURFACE PIT**

*Submit in Duplicate*

Operator Name: _____		License Number: _____	
Operator Address: _____			
Contact Person: _____		Phone Number: _____	
Lease Name & Well No.: _____		Pit Location (QQQQ): _____-_____-_____-_____	
Type of Pit: <input type="checkbox"/> Emergency Pit <input type="checkbox"/> Burn Pit <input type="checkbox"/> Settling Pit <input type="checkbox"/> Drilling Pit <input type="checkbox"/> Workover Pit <input type="checkbox"/> Haul-Off Pit <i>(If WP Supply API No. or Year Drilled)</i>		Pit is: <input type="checkbox"/> Proposed <input type="checkbox"/> Existing If Existing, date constructed: _____ Pit capacity: _____ (bbls)	
Is the pit located in a Sensitive Ground Water Area? <input type="checkbox"/> Yes <input type="checkbox"/> No		Chloride concentration: _____ mg/l <i>(For Emergency Pits and Settling Pits only)</i>	
Is the bottom below ground level? <input type="checkbox"/> Yes <input type="checkbox"/> No		Artificial Liner? <input type="checkbox"/> Yes <input type="checkbox"/> No	
How is the pit lined if a plastic liner is not used?			
Pit dimensions (all but working pits):    _____ Length (feet)    _____ Width (feet) <input type="checkbox"/> N/A: Steel Pits Depth from ground level to deepest point: _____ (feet) <input type="checkbox"/> No Pit			
If the pit is lined give a brief description of the liner material, thickness and installation procedure.		Describe procedures for periodic maintenance and determining liner integrity, including any special monitoring.	
Distance to nearest water well within one-mile of pit: _____ feet    Depth of water well _____ feet		Depth to shallowest fresh water _____ feet. Source of information: <input type="checkbox"/> measured <input type="checkbox"/> well owner <input type="checkbox"/> electric log <input type="checkbox"/> KDWR	
<b>Emergency, Settling and Burn Pits ONLY:</b> Producing Formation: _____ Number of producing wells on lease: _____ Barrels of fluid produced daily: _____ Does the slope from the tank battery allow all spilled fluids to flow into the pit? <input type="checkbox"/> Yes <input type="checkbox"/> No		<b>Drilling, Workover and Haul-Off Pits ONLY:</b> Type of material utilized in drilling/workover: _____ Number of working pits to be utilized: _____ Abandonment procedure: _____ _____ Drill pits must be closed within 365 days of spud date.	
<p><b>Submitted Electronically</b></p>			

**KCC OFFICE USE ONLY**

Liner     Steel Pit     RFAC     RFAS

Date Received: \_\_\_\_\_ Permit Number: \_\_\_\_\_ Permit Date: \_\_\_\_\_ Lease Inspection:     Yes     No



# CERTIFICATION OF COMPLIANCE WITH THE KANSAS SURFACE OWNER NOTIFICATION ACT

*This form must be submitted with all Forms C-1 (Notice of Intent to Drill); CB-1 (Cathodic Protection Borehole Intent); T-1 (Request for Change of Operator Transfer of Injection or Surface Pit Permit); and CP-1 (Well Plugging Application). Any such form submitted without an accompanying Form KSONA-1 will be returned.*

Select the corresponding form being filed:  C-1 (Intent)  CB-1 (Cathodic Protection Borehole Intent)  T-1 (Transfer)  CP-1 (Plugging Application)

OPERATOR: License # \_\_\_\_\_  
Name: \_\_\_\_\_  
Address 1: \_\_\_\_\_  
Address 2: \_\_\_\_\_  
City: \_\_\_\_\_ State: \_\_\_\_\_ Zip: \_\_\_\_\_ + \_\_\_\_\_  
Contact Person: \_\_\_\_\_  
Phone: ( \_\_\_\_\_ ) \_\_\_\_\_ Fax: ( \_\_\_\_\_ ) \_\_\_\_\_  
Email Address: \_\_\_\_\_

Well Location:  
\_\_\_\_ - \_\_\_\_ - \_\_\_\_ - \_\_\_\_ Sec. \_\_\_\_ Twp. \_\_\_\_ S. R. \_\_\_\_  East  West  
County: \_\_\_\_\_  
Lease Name: \_\_\_\_\_ Well #: \_\_\_\_\_

*If filing a Form T-1 for multiple wells on a lease, enter the legal description of the lease below:*

### Surface Owner Information:

Name: \_\_\_\_\_  
Address 1: \_\_\_\_\_  
Address 2: \_\_\_\_\_  
City: \_\_\_\_\_ State: \_\_\_\_\_ Zip: \_\_\_\_\_ + \_\_\_\_\_

*When filing a Form T-1 involving multiple surface owners, attach an additional sheet listing all of the information to the left for each surface owner. Surface owner information can be found in the records of the register of deeds for the county, and in the real estate property tax records of the county treasurer.*

*If this form is being submitted with a Form C-1 (Intent) or CB-1 (Cathodic Protection Borehole Intent), you must supply the surface owners and the KCC with a plat showing the predicted locations of lease roads, tank batteries, pipelines, and electrical lines. The locations shown on the plat are preliminary non-binding estimates. The locations may be entered on the Form C-1 plat, Form CB-1 plat, or a separate plat may be submitted.*

### Select one of the following:

- I certify that, pursuant to the Kansas Surface Owner Notice Act (House Bill 2032), I have provided the following to the surface owner(s) of the land upon which the subject well is or will be located: 1) a copy of the Form C-1, Form CB-1, Form T-1, or Form CP-1 that I am filing in connection with this form; 2) if the form being filed is a Form C-1 or Form CB-1, the plat(s) required by this form; and 3) my operator name, address, phone number, fax, and email address.
- I have not provided this information to the surface owner(s). I acknowledge that, because I have not provided this information, the KCC will be required to send this information to the surface owner(s). To mitigate the additional cost of the KCC performing this task, I acknowledge that I am being charged a \$30.00 handling fee, payable to the KCC, which is enclosed with this form.

*If choosing the second option, submit payment of the \$30.00 handling fee with this form. If the fee is not received with this form, the KSONA-1 form and the associated Form C-1, Form CB-1, Form T-1, or Form CP-1 will be returned.*

I Submitted Electronically

I

Hendrix 3 and WW1 surface rights notification continuation and water well notification

GARY S HUPPE  
17535 EDGERTON RD  
EDGERTON, KS 66021

STEPHEN & JULIE WOLDERHOFF  
37135 W 175TH ST  
EDGERTON, KS 66021

EARL COBB  
3715 W 175TH TERR  
EGERTON, KS 66021

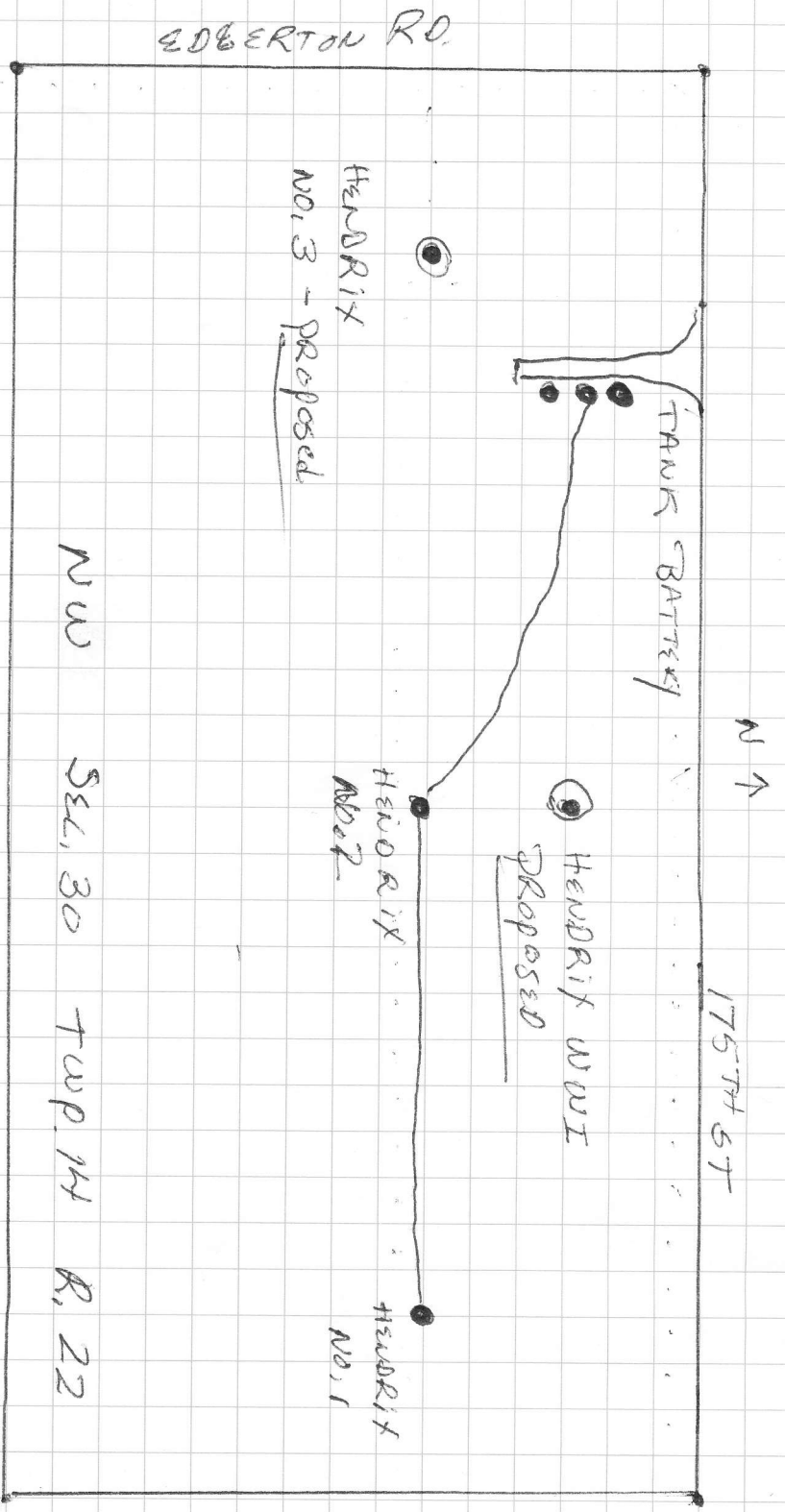

EDGERTON RD.

175th St

N ↓

TANK BATTERY

HENDRIX WWT  
Proposed

HENDRIX  
NO. 1

HENDRIX  
NO. 3 - Proposed

NW SE, 30 TWP. 14 R. 22

JOHNSON CO, KS.

Conservation Division  
Finney State Office Building  
130 S. Market, Rm. 2078  
Wichita, KS 67202-3802



Phone: 316-337-6200  
Fax: 316-337-6211  
<http://kcc.ks.gov/>

Mark Sievers, Chairman  
Ward Loyd, Commissioner  
Thomas E. Wright, Commissioner

Sam Brownback, Governor

June 23, 2011

Bob Reusch  
Reusch Well Service, Inc.  
PO BOX 520  
OTTAWA, KS 66067

Re: Notice of Intent to Drill  
HENDRIX 3  
NW/4 Sec.30-14S-22E  
Johnson County, Kansas

Dear Mr. Reusch:

Records indicate that two domestic water wells are located less than 660 feet from the proposed location. Eastern Kansas Surface Casing Order #133,891-C for Area 2, paragraph 2 states, "No well shall be drilled closer than 660 feet of an existing domestic or municipal water well without written owner notification, a copy of which must be attached to the drilling intent form during filing. Special casing and cementing requirements may be imposed in those areas producing fresh and usable water."

Please attach a copy of the owner notifications to further the processing of your notice of intent to drill. Copies of the water well records are attached

I may be contacted at 316-337-6200 if you need additional information.

Rick Hestermann  
Production Department

cc: Steve Korf, District 3

**WATER WELL RECORD Form WWC-5 KSA 82a-1212 ID No.**

1 LOCATION OF WATER WELL: Fraction <b>NE 1/4 NW 1/4 NW 1/4</b> Section Number <b>30</b> Township Number <b>T 14 S</b> Range Number <b>R 22 E</b>	
County: <b>Johnson</b> Distance and direction from nearest town or city street address of well if located within city? <b>37150 W 176<sup>th</sup> Terr Edgerton, KS, 66021</b>	
2 WATER WELL OWNER: <b>Carl Cobb</b> RR#, St. Address, Box #: <b>9730 Hudson Boulevard</b> City, State, ZIP Code: <b>Lake Elm, MN, 55042</b> Board of Agriculture, Division of Water Resources Application Number:	
3 LOCATE WELL'S LOCATION WITH AN "X" IN SECTION BOX:	4 DEPTH OF COMPLETED WELL: <b>100</b> ft. ELEVATION: Depth(s) Groundwater Encountered: 1. <b>20-80</b> ft. 2. _____ ft. 3. _____ ft. WELL'S STATIC WATER LEVEL: <b>16</b> ft. below land surface measured on mo/day/yr: <b>2-15-02</b> Pump test data: Well water was _____ ft. after _____ hours pumping _____ gpm Est. Yield: <b>8</b> gpm Well water was _____ ft. after _____ hours pumping _____ gpm Bore Hole Diameter: <b>8 1/4</b> in. to <b>100</b> ft. and _____ in. to _____ ft. WELL WATER TO BE USED AS: 5 Public water supply 8 Air conditioning 11 Injection well <input checked="" type="checkbox"/> Domestic 3 Feedlot 6 Oil field water supply 9 Dewatering 12 Other (Specify below) 2 Irrigation 4 Industrial 7 Domestic (lawn & garden) 10 Monitoring well Was a chemical/bacteriological sample submitted to Department? Yes _____ No <input checked="" type="checkbox"/> If yes, mo/day/yr sample was submitted _____ Water Well Disinfected? Yes <input checked="" type="checkbox"/> No _____
5 TYPE OF BLANK CASING USED: 1 Steel 3 RMP (SR) 5 Wrought iron 8 Concrete tile CASING JOINTS: Glued <input checked="" type="checkbox"/> Clamped _____ <input checked="" type="checkbox"/> PVC 4 ABS 7 Fiberglass 9 Other (specify below) Welded _____ Blank casing diameter: <b>5</b> in. to <b>70</b> ft. Dia. <b>5</b> in. to <b>80-100</b> ft. Dia. _____ in. to _____ ft. Casing height above land surface: <b>30</b> in., weight <b>SDR24 160 P.S.I.</b> lbs./ft. Wall thickness or gauge No. _____ TYPE OF SCREEN OR PERFORATION MATERIAL: <input checked="" type="checkbox"/> PVC 10 Asbestos-cement 1 Steel 3 Stainless steel 5 Fiberglass 8 RMP (SR) 11 Other (specify) _____ 2 Brass 4 Galvanized steel 6 Concrete tile 9 ABS 12 None used (open hole) SCREEN OR PERFORATION OPENINGS ARE: 1 Continuous slot <input checked="" type="checkbox"/> Small slot 5 Gauzed wrapped 8 Saw cut 11 None (open hole) 2 Louvered shutter 4 Key punched 7 Torch cut 9 Drilled holes 10 Other (specify) _____ ft. SCREEN-PERFORATED INTERVALS: From <b>70-80</b> ft. to _____ ft. From _____ ft. to _____ ft. GRAVEL PACK INTERVALS: From _____ ft. to _____ ft. From _____ ft. to _____ ft. From _____ ft. to _____ ft. From _____ ft. to _____ ft.	
6 GROUT MATERIAL: 1 Neat cement 2 Cement grout <input checked="" type="checkbox"/> Bentonite 4 Other _____ Grout Intervals: From <b>20</b> ft. to <b>0</b> ft. From _____ ft. to _____ ft. From _____ ft. to _____ ft. What is the nearest source of possible contamination: 1 Septic tank 4 Lateral lines 7 Pit privy 11 Fuel storage 14 Abandoned water well 2 Sewer lines 5 Cess pool 8 Sewage lagoon 12 Fertilizer storage 15 Oil well/Gas well 3 Watertight sewer lines 6 Seepage pit 9 Feedyard 13 Insecticide storage 16 Other (specify below) _____ Direction from well? _____ How many feet? _____	
7 CONTRACTOR'S OR LANDOWNER'S CERTIFICATION: This water well was <input checked="" type="checkbox"/> constructed, <input type="checkbox"/> reconstructed, or <input type="checkbox"/> plugged under my jurisdiction and was completed on (mo/day/year) <b>2-15-02</b> and this record is true to the best of my knowledge and belief. Kansas Water Well Contractor's Licence No. <b>561</b> This Water Well Record was completed on (mo/day/yr) <b>2-15-02</b> under the business name of <b>GRANS Energy Services</b> by (signature) <b>Scott E. ...</b>	

FROM	TO	LITHOLOGIC LOG	FROM	TO	PLUGGING INTERVALS
0	8	Soil & Clay			
8	42	yellow sandstone + clay			
42	80	sandstone laminated			
80	100	shale			



**CORRECTION(S) TO WATER WELL RECORD (WWC-5)**  
(to rectify lacking or incorrect information)

County: Johnson

Location listed as:

Location changed to:

Section-Township-Range: 30-155-22E

30-145-22E

Fraction (  $\frac{1}{4}$   $\frac{1}{4}$   $\frac{1}{4}$ ): SW NW NW

SW NW NW

Other changes: Initial statements: \_\_\_\_\_

Changed to: \_\_\_\_\_

Comments: \_\_\_\_\_

verification method: Well site address, city street map, and mapping tool & aerial photos on KGS website.

initials: DRF date: 4/30/2010

submitted by: Kansas Geological Survey, Data Resources Library, 1930 Constant Ave., Lawrence, KS 66047-3726  
to: Kansas Dept of Health & Environment, Bureau of Water, 1000 SW Jackson, Suite 420, Topeka, KS 66612-1367.

**WATER WELL RECORD**

**Form WWC-5**

Division of Water Resources; App. No.  

<b>1 LOCATION OF WATER WELL:</b> County: <u>Johnson</u>	Fraction <u>SW 1/4 NW 1/4 NW 1/4</u>	Section Number <u>30</u>	Township Number T <u>15 S</u>	Range Number R <u>22 E</u>
------------------------------------------------------------	-----------------------------------------	-----------------------------	----------------------------------	-------------------------------

Distance and direction from nearest town or city street address of well if located within city?  
37345 West 176<sup>th</sup> Terrace Edgerton, KS.

**Global Positioning Systems** (decimal degrees, min. of 4 digits)  
Latitude: \_\_\_\_\_  
Longitude: \_\_\_\_\_  
Elevation: \_\_\_\_\_  
Datum: \_\_\_\_\_  
Data Collection Method: \_\_\_\_\_

**2 WATER WELL OWNER:** Steve Thomas  
RR#, St. Address, Box # : 536 N Winwood  
City, State, ZIP Code : Gardner, KS, 66030

**3 LOCATE WELL'S LOCATION WITH AN "X" IN SECTION BOX:**

75  
71  
67  
63

NW	NE
SW	SE

63  
59

**4 DEPTH OF COMPLETED WELL** ..... 100 ..... ft.

Depth(s) Groundwater Encountered (1) 40-100 ft. (2)..... ft. (3)..... ft.

WELL'S STATIC WATER LEVEL... 37 ..... ft. below land surface measured on mo/day/yr. 4-13-10.

Pump test data: Well water was.....ft. after..... hours pumping..... gpm

Est. Yield... 12 gpm: Well water was.....ft. after..... hours pumping..... gpm

WELL WATER TO BE USED AS: 5 Public water supply    8 Air conditioning    11 Injection well

Domestic    3 Feedlot    6 Oil field water supply    9 Dewatering    12 Other (Specify below)

2 Irrigation    4 Industrial    7 Domestic (lawn & garden)    10 Monitoring well

Was a chemical/bacteriological sample submitted to Department? Yes ..... No  .....; If yes, mo/day/yrs  
Sample was submitted..... Water well disinfected? Yes  ..... No .....

**5 TYPE OF CASING USED:**

1 Steel	3 RMP (SR)	6 Asbestos-Cement	9 Other (specify below)
<input checked="" type="checkbox"/> PVC	4 ABS	7 Fiberglass	

Blank casing diameter ..... 5 ..... in. to 80 ..... ft., Diameter. .... in. to ..... ft., Diameter ..... in. to ..... ft.

Casing height above land surface..... 24 ..... in., Weight 502.24 lbs./ft. Wall thickness or guage No. 160

**CASING JOINTS:** Glued  ..... Clamped.....  
Welded.....  
Threaded.....

**TYPE OF SCREEN OR PERFORATION MATERIAL:**

1 Steel	3 Stainless Steel	5 Fiberglass	<input checked="" type="checkbox"/> PVC	9 ABS	11 Other (Specify) .....
2 Brass	4 Galvanized Steel	6 Concrete tile	8 RM (SR)	10 Asbestos-Cement	12 None used (open hole)

**SCREEN OR PERFORATION OPENINGS ARE:**

1 Continuous slot	3 Mill slot	5 Gauzed wrapped	7 Torch cut	9 Drilled holes	11 None (open hole)
2 Louvered shutter	4 Key punched	6 Wire wrapped	<input checked="" type="checkbox"/> Saw cut	10 Other (specify) .....	

**SCREEN-PERFORATED INTERVALS:** From 80 ..... ft. to 100 ..... ft., From ..... ft. to ..... ft.

**GRAVEL PACK INTERVALS:** From 100 ..... ft. to 37 ..... ft., From ..... ft. to ..... ft.

**6 GROUT MATERIAL:** 1 Neat cement    2 Cement grout     Bentonite    4 Other .....

Grout Intervals: From 37 ..... ft. to 3 ..... ft., From ..... ft. to ..... ft., From ..... ft. to ..... ft.

What is the nearest source of possible contamination:

<input checked="" type="checkbox"/> Septic tank	<input checked="" type="checkbox"/> Lateral lines	7 Pit privy	10 Livestock pens	13 Insecticide storage	16 Other (specify below)
2 Sewer lines	5 Cess pool	8 Sewage lagoon	11 Fuel storage	14 Abandoned water well	
3 Watertight sewer lines	6 Seepage pit	9 Feedyard	12 Fertilizer storage	15 Oil well/gas well	

Direction from well? South ..... How many feet? 150+

FROM	TO	LITHOLOGIC LOG	FROM	TO	PLUGGING INTERVALS
<u>0</u>	<u>9</u>	<u>Soil + Clay</u>			
<u>9</u>	<u>100</u>	<u>Sandstone</u>			

**7 CONTRACTOR'S OR LANDOWNER'S CERTIFICATION:** This water well was  constructed, (2) reconstructed, or (3) plugged under my jurisdiction and was completed on (mo/day/year) 4-13-10 and this record is true to the best of my knowledge and belief. Kansas Water Well Contractor's License No. 561..... This Water Well Record was completed on (mo/day/year) 4-14-10 under the business name of Evans Energy Dev Inc. by (signature) Scott G. Evans

**INSTRUCTIONS:** Use typewriter or ball point pen. PLEASE PRESS FIRMLY and PRINT clearly. Please mark in blanks, underline or circle the correct answers. Send top three copies to Kansas Department of Health and Environment, Bureau of Water, Geology Section, 1000 SW Jackson St., Suite 420, Topeka, Kansas 66612-1367. Telephone 785-296-5522. Send one to WATER WELL OWNER and retain one for your records. Fee of \$5.00 for each constructed well. Visit us at <http://www.kdheks.gov/waterwell/index.html>.

Reusch Well Service, Inc.  
PO Box 520  
Ottawa, KS 66067

July 13, 2011

Jacqueline Kluge  
11967 E 60<sup>th</sup> St.  
Kansas City, MO 64133

Dear Jacqueline Kluge:

The Kansas Surface Owner Notice Act requires that we provide you notice that we are drilling 2 wells on the Hendrix lease. Enclosed are copies of the Intent to Drill form (C-1) that we have filed with the Kansas Corporation Commission. This requires no response from you, it is for your information only. If you have any questions you may contact Bob Reusch at:

Reusch Well Service, Inc.  
PO Box 520  
Ottawa, KS 66067  
785.418.4254 phone  
785.242.1983 fax  
lreusch@att.net

Sincerely,

A handwritten signature in cursive script, appearing to read "Liz Reusch".

Liz Reusch  
Secretary, Reusch Well Service, Inc.

Reusch Well Service, Inc.  
PO Box 520  
Ottawa, KS 66067

July 13, 2011

Stephen & Julie Wolderhoff  
37135 W 175<sup>th</sup> St.  
Edgerton, KS 66021

Dear Stephen & Julie Wolderhoff:

The Kansas Surface Owner Notice Act requires that we provide you notice that we are drilling 2 wells on the Hendrix lease. Enclosed are copies of the Intent to Drill form (C-1) that we have filed with the Kansas Corporation Commission. This requires no response from you, it is for your information only. If you have any questions you may contact Bob Reusch at:

Reusch Well Service, Inc.  
PO Box 520  
Ottawa, KS 66067  
785.418.4254 phone  
785.242.1983 fax  
lreusch@att.net

Sincerely,

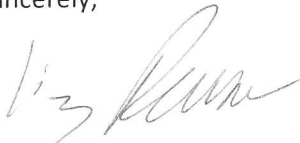
A handwritten signature in cursive script, appearing to read "Liz Reusch".

Liz Reusch  
Secretary, Reusch Well Service, Inc.

Reusch Well Service, Inc.  
PO Box 520  
Ottawa, KS 66067

July 13, 2011

Gary S. Huppe  
17535 Edgerton Rd  
Edgerton, KS 66021

Dear Gary Huppe:

The Kansas Surface Owner Notice Act requires that we provide you notice that we are drilling 2 wells on the Hendrix lease. Enclosed are copies of the Intent to Drill form (C-1) that we have filed with the Kansas Corporation Commission. This requires no response from you, it is for your information only. If you have any questions you may contact Bob Reusch at:

Reusch Well Service, Inc.  
PO Box 520  
Ottawa, KS 66067  
785.418.4254 phone  
785.242.1983 fax  
lreusch@att.net

Sincerely,

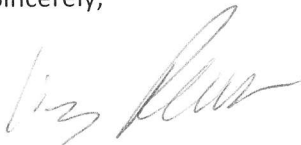
A handwritten signature in cursive script, appearing to read "Liz Reusch".

Liz Reusch  
Secretary, Reusch Well Service, Inc.

Reusch Well Service, Inc.  
PO Box 520  
Ottawa, KS 66067

July 13, 2011

Steve Thomas  
536 N Winwood  
Gardner, KS 66030

Dear Steve Thomas:

Eastern Kansas Surface Casing Order #133.891-C requires us to notify you that we will be drilling an oil well within 660' of your water well. This requires no response from you. If you have any questions you may contact Bob Reusch at 785.418.4254.

Sincerely,

A handwritten signature in cursive script, appearing to read "Liz Reusch".

Liz Reusch  
Secretary, Reusch Well Service, Inc.

Reusch Well Service, Inc.  
PO Box 520  
Ottawa, KS 66067

July 13, 2011

Earl Cobb  
3715 W 176<sup>th</sup> Terr.  
Edgerton, KS 66021

Dear Earl Cobb:

Eastern Kansas Surface Casing Order #133.891-C requires us to notify you that we will be drilling an oil well within 660' of your water well. This requires no response from you. If you have any questions you may contact Bob Reusch at 785.418.4254.

Sincerely,

A handwritten signature in cursive script, appearing to read "Liz Reusch".

Liz Reusch  
Secretary, Reusch Well Service, Inc.

Conservation Division  
Finney State Office Building  
130 S. Market, Rm. 2078  
Wichita, KS 67202-3802



Phone: 316-337-6200  
Fax: 316-337-6211  
<http://kcc.ks.gov/>

Mark Sievers, Chairman  
Ward Loyd, Commissioner  
Thomas E. Wright, Commissioner

Sam Brownback, Governor

July 28, 2011

Bob Reusch  
Reusch Well Service, Inc.  
PO BOX 520  
OTTAWA, KS 66067

Re: Drilling Pit Application  
HENDRIX 3  
NW/4 Sec.30-14S-22E  
Johnson County, Kansas

Dear Bob Reusch:

District staff has inspected the above referenced location and has determined that the reserve pit shall be constructed **without slots**, the bottom shall be flat and reasonably level, and the free fluids must be removed. The fluids are to be removed from the reserve pit as soon as practical after drilling operations have ceased.

**If production casing is set all completion fluids shall be removed from the working pits daily. NO completion fluids or non-exempt wastes shall be placed in the reserve pit.**

The fluids should be taken to an authorized disposal well. Please call the District Office at (620) 432-2300 when the fluids have been removed. Please file form CDP-5 (August 2008), Exploration and Production Waste Transfer, through KOLAR within 30 days of fluid removal.

**A copy of this letter should be posted in the doghouse along with the approved Intent to Drill.** If you have any questions or concerns please feel free to contact the District Office at (620) 432-2300.