



For KCC Use:
 Effective Date: _____
 District # _____
 SGA? Yes No

KANSAS CORPORATION COMMISSION 1058221
 OIL & GAS CONSERVATION DIVISION

Form C-1
 March 2010

Form must be Typed
 Form must be Signed
 All blanks must be Filled

NOTICE OF INTENT TO DRILL

Must be approved by KCC five (5) days prior to commencing well

Form KSONA-1, Certification of Compliance with the Kansas Surface Owner Notification Act, MUST be submitted with this form.

Expected Spud Date: _____
 month day year

OPERATOR: License# _____
 Name: _____
 Address 1: _____
 Address 2: _____
 City: _____ State: _____ Zip: _____ + _____
 Contact Person: _____
 Phone: _____

CONTRACTOR: License# _____
 Name: _____

Well Drilled For:	Well Class:	Type Equipment:
<input type="checkbox"/> Oil	<input type="checkbox"/> Enh Rec	<input type="checkbox"/> Infield
<input type="checkbox"/> Gas	<input type="checkbox"/> Storage	<input type="checkbox"/> Pool Ext.
	<input type="checkbox"/> Disposal	<input type="checkbox"/> Wildcat
<input type="checkbox"/> Seismic ; _____ # of Holes	<input type="checkbox"/> Other	<input type="checkbox"/> Mud Rotary
<input type="checkbox"/> Other: _____		<input type="checkbox"/> Air Rotary
		<input type="checkbox"/> Cable

If OWWO: old well information as follows:

Operator: _____
 Well Name: _____
 Original Completion Date: _____ Original Total Depth: _____

Directional, Deviated or Horizontal wellbore? Yes No
 If Yes, true vertical depth: _____
 Bottom Hole Location: _____
 KCC DKT #: _____

Spot Description: _____
 _____ - _____ - _____ Sec. _____ Twp. _____ S. R. _____ E W
 (Q/Q/Q/Q) _____ feet from N / S Line of Section
 _____ feet from E / W Line of Section

Is SECTION: Regular Irregular?
 (Note: Locate well on the Section Plat on reverse side)

County: _____
 Lease Name: _____ Well #: _____

Field Name: _____
 Is this a Prorated / Spaced Field? Yes No

Target Formation(s): _____
 Nearest Lease or unit boundary line (in footage): _____

Ground Surface Elevation: _____ feet MSL
 Water well within one-quarter mile: Yes No

Public water supply well within one mile: Yes No
 Depth to bottom of fresh water: _____

Depth to bottom of usable water: _____
 Surface Pipe by Alternate: I II

Length of Surface Pipe Planned to be set: _____
 Length of Conductor Pipe (if any): _____

Projected Total Depth: _____
 Formation at Total Depth: _____

Water Source for Drilling Operations:
 Well Farm Pond Other: _____

DWR Permit #: _____
 (Note: Apply for Permit with DWR)

Will Cores be taken? Yes No
 If Yes, proposed zone: _____

AFFIDAVIT

The undersigned hereby affirms that the drilling, completion and eventual plugging of this well will comply with K.S.A. 55 et. seq.

It is agreed that the following minimum requirements will be met:

1. Notify the appropriate district office **prior** to spudding of well;
2. A copy of the approved notice of intent to drill **shall be** posted on each drilling rig;
3. The minimum amount of surface pipe as specified below **shall be set** by circulating cement to the top; in all cases surface pipe **shall be set** through all unconsolidated materials plus a minimum of 20 feet into the underlying formation.
4. If the well is dry hole, an agreement between the operator and the district office on plug length and placement is necessary **prior to plugging**;
5. The appropriate district office will be notified before well is either plugged or production casing is cemented in;
6. If an ALTERNATE II COMPLETION, production pipe shall be cemented from below any usable water to surface within **120 DAYS** of spud date. Or pursuant to Appendix "B" - Eastern Kansas surface casing order #133,891-C, which applies to the KCC District 3 area, alternate II cementing must be completed within 30 days of the spud date or the well shall be plugged. **In all cases, NOTIFY district office** prior to any cementing.

Submitted Electronically

For KCC Use ONLY

API # 15 - _____

Conductor pipe required _____ feet

Minimum surface pipe required _____ feet per ALT. I II

Approved by: _____

This authorization expires: _____
 (This authorization void if drilling not started within 12 months of approval date.)

Spud date: _____ Agent: _____

Remember to:

- File Certification of Compliance with the Kansas Surface Owner Notification Act (KSONA-1) with Intent to Drill;
- File Drill Pit Application (form CDP-1) with Intent to Drill;
- File Completion Form ACO-1 within 120 days of spud date;
- File acreage attribution plat according to field proration orders;
- Notify appropriate district office 48 hours prior to workover or re-entry;
- Submit plugging report (CP-4) after plugging is completed (within 60 days);
- Obtain written approval before disposing or injecting salt water.
- If well will not be drilled or permit has expired (See: authorized expiration date) please check the box below and return to the address below.

Well will not be drilled or Permit Expired Date: _____
 Signature of Operator or Agent: _____

E
 W



1058221

For KCC Use ONLY
 API # 15 - _____

IN ALL CASES PLOT THE INTENDED WELL ON THE PLAT BELOW

In all cases, please fully complete this side of the form. Include items 1 through 5 at the bottom of this page.

Operator: _____
 Lease: _____
 Well Number: _____
 Field: _____
 Number of Acres attributable to well: _____
 QTR/QTR/QTR/QTR of acreage: _____ - _____ - _____ - _____

Location of Well: County: _____
 _____ feet from N / S Line of Section
 _____ feet from E / W Line of Section
 Sec. _____ Twp. _____ S. R. _____ E W

Is Section: Regular or Irregular

If Section is Irregular, locate well from nearest corner boundary.

Section corner used: NE NW SE SW

PLAT

Show location of the well. Show footage to the nearest lease or unit boundary line. Show the predicted locations of lease roads, tank batteries, pipelines and electrical lines, as required by the Kansas Surface Owner Notice Act (House Bill 2032). You may attach a separate plat if desired.

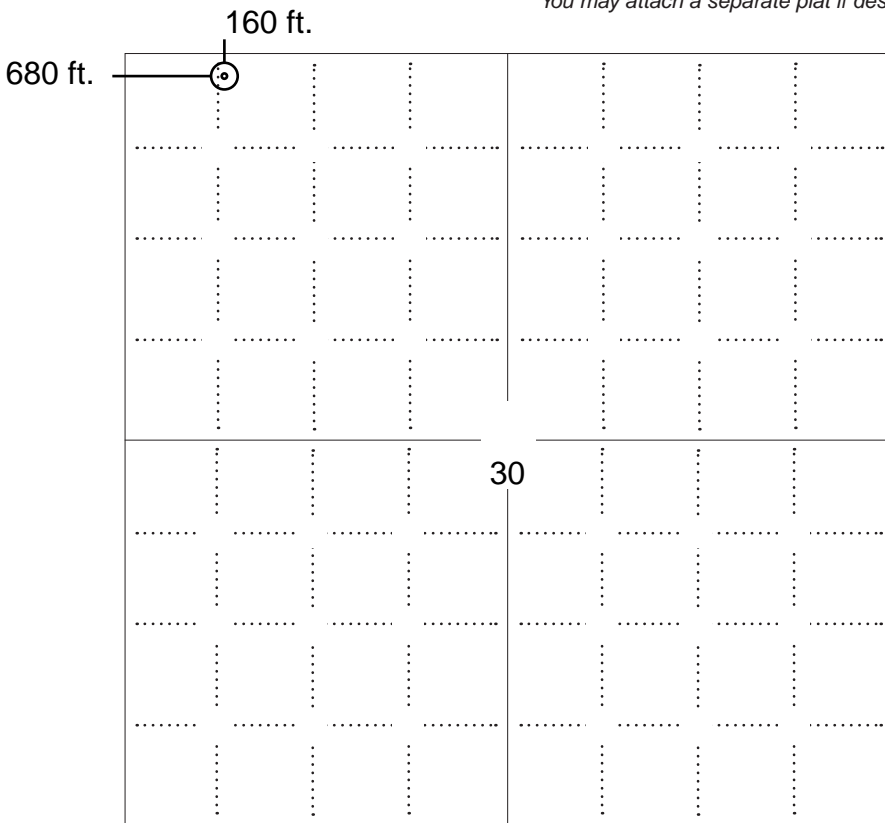

LEGEND

- Well Location
- Tank Battery Location
- Pipeline Location
- Electric Line Location
- Lease Road Location



NOTE: In all cases locate the spot of the proposed drilling locaton.

In plotting the proposed location of the well, you must show:

1. The manner in which you are using the depicted plat by identifying section lines, i.e. 1 section, 1 section with 8 surrounding sections, 4 sections, etc.
2. The distance of the proposed drilling location from the south / north and east / west outside section lines.
3. The distance to the nearest lease or unit boundary line (in footage).
4. If proposed location is located within a prorated or spaced field a certificate of acreage attribution plat must be attached: (C0-7 for oil wells; CG-8 for gas wells).
5. The predicted locations of lease roads, tank batteries, pipelines, and electrical lines.



KANSAS CORPORATION COMMISSION 1058221
OIL & GAS CONSERVATION DIVISION

Form CDP-1
May 2010
Form must be Typed

APPLICATION FOR SURFACE PIT

Submit in Duplicate

Operator Name:		License Number:	
Operator Address:			
Contact Person:		Phone Number:	
Lease Name & Well No.:		Pit Location (QQQQ): ____ - ____ - ____ - ____	
Type of Pit: <input type="checkbox"/> Emergency Pit <input type="checkbox"/> Burn Pit <input type="checkbox"/> Settling Pit <input type="checkbox"/> Drilling Pit <input type="checkbox"/> Workover Pit <input type="checkbox"/> Haul-Off Pit <i>(If WP Supply API No. or Year Drilled)</i>		Pit is: <input type="checkbox"/> Proposed <input type="checkbox"/> Existing If Existing, date constructed: _____ Pit capacity: _____ (bbls)	
Is the pit located in a Sensitive Ground Water Area? <input type="checkbox"/> Yes <input type="checkbox"/> No		Chloride concentration: _____ mg/l <i>(For Emergency Pits and Settling Pits only)</i>	
Is the bottom below ground level? <input type="checkbox"/> Yes <input type="checkbox"/> No		Artificial Liner? <input type="checkbox"/> Yes <input type="checkbox"/> No	
How is the pit lined if a plastic liner is not used?			
Pit dimensions (all but working pits): _____ Length (feet) _____ Width (feet) <input type="checkbox"/> N/A: Steel Pits Depth from ground level to deepest point: _____ (feet) <input type="checkbox"/> No Pit			
If the pit is lined give a brief description of the liner material, thickness and installation procedure.		Describe procedures for periodic maintenance and determining liner integrity, including any special monitoring.	
Distance to nearest water well within one-mile of pit: _____ feet Depth of water well _____ feet		Depth to shallowest fresh water _____ feet. Source of information: <input type="checkbox"/> measured <input type="checkbox"/> well owner <input type="checkbox"/> electric log <input type="checkbox"/> KDWR	
Emergency, Settling and Burn Pits ONLY: Producing Formation: _____ Number of producing wells on lease: _____ Barrels of fluid produced daily: _____ Does the slope from the tank battery allow all spilled fluids to flow into the pit? <input type="checkbox"/> Yes <input type="checkbox"/> No		Drilling, Workover and Haul-Off Pits ONLY: Type of material utilized in drilling/workover: _____ Number of working pits to be utilized: _____ Abandonment procedure: _____ _____ Drill pits must be closed within 365 days of spud date.	
<p>Submitted Electronically</p>			

KCC OFFICE USE ONLY

Liner Steel Pit RFAC RFAS

Date Received: _____ Permit Number: _____ Permit Date: _____ Lease Inspection: Yes No



CERTIFICATION OF COMPLIANCE WITH THE KANSAS SURFACE OWNER NOTIFICATION ACT

This form must be submitted with all Forms C-1 (Notice of Intent to Drill); CB-1 (Cathodic Protection Borehole Intent); T-1 (Request for Change of Operator Transfer of Injection or Surface Pit Permit); and CP-1 (Well Plugging Application). Any such form submitted without an accompanying Form KSONA-1 will be returned.

Select the corresponding form being filed: C-1 (Intent) CB-1 (Cathodic Protection Borehole Intent) T-1 (Transfer) CP-1 (Plugging Application)

OPERATOR: License # _____
Name: _____
Address 1: _____
Address 2: _____
City: _____ State: _____ Zip: _____ + _____
Contact Person: _____
Phone: (_____) _____ Fax: (_____) _____
Email Address: _____

Well Location:
____ - ____ - ____ - ____ Sec. ____ Twp. ____ S. R. ____ East West
County: _____
Lease Name: _____ Well #: _____

If filing a Form T-1 for multiple wells on a lease, enter the legal description of the lease below:

Surface Owner Information:

Name: _____
Address 1: _____
Address 2: _____
City: _____ State: _____ Zip: _____ + _____

When filing a Form T-1 involving multiple surface owners, attach an additional sheet listing all of the information to the left for each surface owner. Surface owner information can be found in the records of the register of deeds for the county, and in the real estate property tax records of the county treasurer.

If this form is being submitted with a Form C-1 (Intent) or CB-1 (Cathodic Protection Borehole Intent), you must supply the surface owners and the KCC with a plat showing the predicted locations of lease roads, tank batteries, pipelines, and electrical lines. The locations shown on the plat are preliminary non-binding estimates. The locations may be entered on the Form C-1 plat, Form CB-1 plat, or a separate plat may be submitted.

Select one of the following:

- I certify that, pursuant to the Kansas Surface Owner Notice Act (House Bill 2032), I have provided the following to the surface owner(s) of the land upon which the subject well is or will be located: 1) a copy of the Form C-1, Form CB-1, Form T-1, or Form CP-1 that I am filing in connection with this form; 2) if the form being filed is a Form C-1 or Form CB-1, the plat(s) required by this form; and 3) my operator name, address, phone number, fax, and email address.
- I have not provided this information to the surface owner(s). I acknowledge that, because I have not provided this information, the KCC will be required to send this information to the surface owner(s). To mitigate the additional cost of the KCC performing this task, I acknowledge that I am being charged a \$30.00 handling fee, payable to the KCC, which is enclosed with this form.

If choosing the second option, submit payment of the \$30.00 handling fee with this form. If the fee is not received with this form, the KSONA-1 form and the associated Form C-1, Form CB-1, Form T-1, or Form CP-1 will be returned.

I Submitted Electronically

I

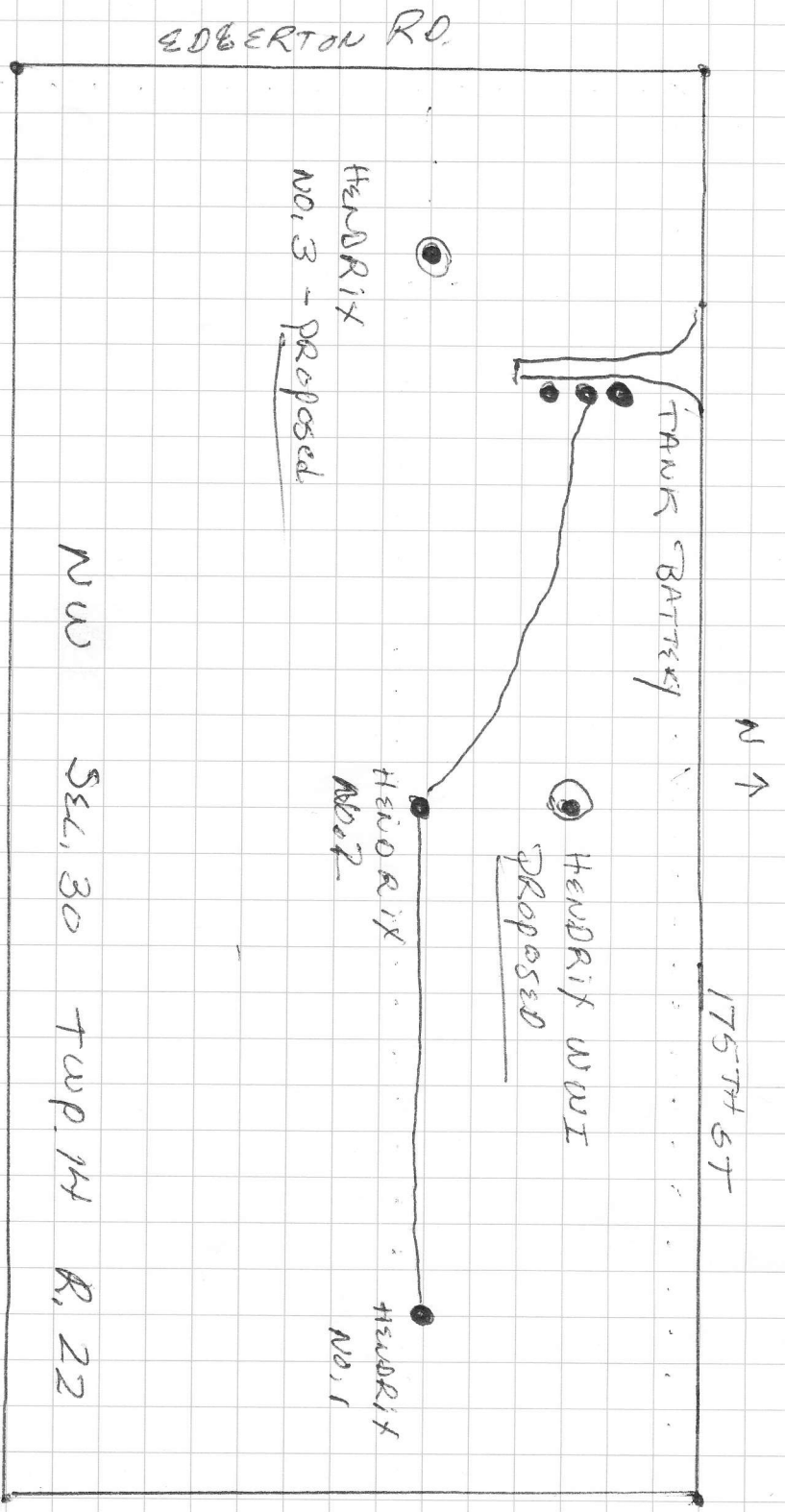

EDGERTON RD.

175th St

N ↑

TANK BATTERY

HENDRIX WWT
Proposed

HENDRIX
No. 1

HENDRIX
No. 2

HENDRIX
No. 3 - Proposed

NW 34 SEC. 30 TWP. 14 R. 22

JOHNSON CO, KS.

Hendrix 3 and WW1 surface rights notification continuation and water well notification

GARY S HUPPE
17535 EDGERTON RD
EDGERTON, KS 66021

STEPHEN & JULIE WOLDERHOFF
37135 W 175TH ST
EDGERTON, KS 66021

EARL COBB
3715 W 175TH TERR
EGERTON, KS 66021

**NOTICE TO OPERATORS FILING INTENT TO DRILL
FOR DISPOSAL OR ENHANCED RECOVERY
INJECTION WELLS, (CLASS II INJECTION WELL)**

The attached approved Notice of Intent to Drill indicates the proposed well is to be used for injection. An approved "Intent to Drill" does not approve injection authority as a Class II Injection Well in Kansas.

Before any well is used for injection purposes, the operator must file an application for injection authority in accordance with K.A.R. 82-3-401 and provide notice in accordance with K.A.R. 82-3-402. The Conservation Division must issue a written permit granting the application before commencement of injection.

The Conservation Division requirements and restrictions associated with Class II Injection are identified in K.A.R. 82-3-400 et seq of our regulations. Associated regulations governing drilling, completion and injection applications may be found in K.A.R. 82-3-135, Table I, Table II, in the Cedar Hills Sandstone Moratorium, (Docket #156,397-C), and the Eastern Kansas Surface Casing Order, (Docket #133,891-C).

If you have questions regarding the approval of injection authority, an injection application may be filed as a "Design Approval" before actual drilling and completion of the well occurs. If you have any questions or concerns regarding Class II injection wells or regulations, call the Underground Injection Control Department at 316-337-6200.

Failure to obtain commission approval before beginning injection is punishable by a penalty, shut-in of the well or both.

Conservation Division
Finney State Office Building
130 S. Market, Rm. 2078
Wichita, KS 67202-3802



Phone: 316-337-6200
Fax: 316-337-6211
<http://kcc.ks.gov/>

Mark Sievers, Chairman
Ward Loyd, Commissioner
Thomas E. Wright, Commissioner

Sam Brownback, Governor

June 23, 2011

BOB REUSCH
Reusch Well Service, Inc.
PO BOX 520
OTTAWA, KS 66067

Re: Notice of Intent to Drill
HENDRIX WW1
NW/4 Sec.30-14S-22E
Johnson County, Kansas

Dear Mr. Reusch:

Records indicate that a domestic water well is located less than 660 feet from the proposed location. Eastern Kansas Surface Casing Order #133,891-C for Area 2, paragraph 2 states, "No well shall be drilled closer than 660 feet of an existing domestic or municipal water well without written owner notification, a copy of which must be attached to the drilling intent form during filing. Special casing and cementing requirements may be imposed in those areas producing fresh and usable water."

Please attach a copy of the owner notification to further the processing of your notice of intent to drill. A copy of the water well record is attached.

I may be contacted at 316-337-6200 if you need additional information.

Rick Hestermann
Production Department

WATER WELL RECORD Form WWC-5 KSA 82a-1212 ID No.

1 LOCATION OF WATER WELL: Fraction NE 1/4 NW 1/4 NW 1/4 Section Number 30 Township Number T 14 S Range Number R 22 E	
County: Johnson Distance and direction from nearest town or city street address of well if located within city? 37150 W 176th Terr Edgerton, KS, 66021	
2 WATER WELL OWNER: Carl Cobb RR#, St. Address, Box #: 9730 Hudson Boulevard City, State, ZIP Code: Lake Elm, MN, 55042 Board of Agriculture, Division of Water Resources Application Number:	
3 LOCATE WELL'S LOCATION WITH AN "X" IN SECTION BOX:	4 DEPTH OF COMPLETED WELL: 100 ft. ELEVATION: Depth(s) Groundwater Encountered: 1. 20-80 ft. 2. 20-80 ft. 3. 20-80 ft. WELL'S STATIC WATER LEVEL: 16 ft. below land surface measured on mo/day/yr: 2-15-02 Pump test data: Well water was _____ ft. after _____ hours pumping _____ gpm Est. Yield: 8 gpm Well water was _____ ft. after _____ hours pumping _____ gpm Bore Hole Diameter: 8 7/8 in. to 100 ft. and _____ in. to _____ ft. WELL WATER TO BE USED AS: 5 Public water supply 8 Air conditioning 11 Injection well <input checked="" type="checkbox"/> Domestic 3 Feedlot 6 Oil field water supply 9 Dewatering 12 Other (Specify below) 2 Irrigation 4 Industrial 7 Domestic (lawn & garden) 10 Monitoring well Was a chemical/bacteriological sample submitted to Department? Yes _____ No <input checked="" type="checkbox"/> If yes, mo/day/yr sample was submitted _____ Water Well Disinfected? Yes <input checked="" type="checkbox"/> No _____
5 TYPE OF BLANK CASING USED: 1 Steel 3 RMP (SR) 5 Wrought iron 8 Concrete tile CASING JOINTS: Glued <input checked="" type="checkbox"/> Clamped _____ <input checked="" type="checkbox"/> PVC 4 ABS 7 Fiberglass Blank casing diameter: 5 in. to 70 ft. Dia. 5 in. to 80-100 ft. Dia. _____ in. to _____ ft. Casing height above land surface: 30 in., weight SDR24 160 P.S.I. lbs./ft. Wall thickness or gauge No. _____ TYPE OF SCREEN OR PERFORATION MATERIAL: <input checked="" type="checkbox"/> PVC 10 Asbestos-cement 1 Steel 3 Stainless steel 5 Fiberglass 8 RMP (SR) 11 Other (specify) _____ 2 Brass 4 Galvanized steel 6 Concrete tile 9 ABS 12 None used (open hole) SCREEN OR PERFORATION OPENINGS ARE: 1 Continuous slot <input checked="" type="checkbox"/> Small slot 5 Gauzed wrapped 8 Saw cut 11 None (open hole) 2 Louvered shutter 4 Key punched 7 Torch cut 9 Drilled holes 10 Other (specify) _____ ft. SCREEN-PERFORATED INTERVALS: From 70-80 ft. to _____ ft. From _____ ft. to _____ ft. GRAVEL PACK INTERVALS: From _____ ft. to _____ ft. From _____ ft. to _____ ft. From _____ ft. to _____ ft. From _____ ft. to _____ ft.	
6 GROUT MATERIAL: 1 Neat cement 2 Cement grout <input checked="" type="checkbox"/> Bentonite 4 Other _____ Grout Intervals: From 20 ft. to 0 ft. From _____ ft. to _____ ft. From _____ ft. to _____ ft. What is the nearest source of possible contamination: 1 Septic tank 4 Lateral lines 7 Pit privy 11 Fuel storage 14 Abandoned water well 2 Sewer lines 5 Cess pool 8 Sewage lagoon 12 Fertilizer storage 15 Oil well/Gas well 3 Watertight sewer lines 6 Seepage pit 9 Feedyard 13 Insecticide storage 16 Other (specify below) _____ Direction from well? _____ How many feet? _____	
7 CONTRACTOR'S OR LANDOWNER'S CERTIFICATION: This water well was <input checked="" type="checkbox"/> constructed, <input type="checkbox"/> reconstructed, or <input type="checkbox"/> plugged under my jurisdiction and was completed on (mo/day/year) 2-15-02 and this record is true to the best of my knowledge and belief. Kansas Water Well Contractor's Licence No. 561 This Water Well Record was completed on (mo/day/yr) 2-15-02 under the business name of GRANS Energy Services by (signature) Scott E. ...	

Reusch Well Service, Inc.
PO Box 520
Ottawa, KS 66067

July 13, 2011

Jacqueline Kluge
11967 E 60th St.
Kansas City, MO 64133

Dear Jacqueline Kluge:

The Kansas Surface Owner Notice Act requires that we provide you notice that we are drilling 2 wells on the Hendrix lease. Enclosed are copies of the Intent to Drill form (C-1) that we have filed with the Kansas Corporation Commission. This requires no response from you, it is for your information only. If you have any questions you may contact Bob Reusch at:

Reusch Well Service, Inc.
PO Box 520
Ottawa, KS 66067
785.418.4254 phone
785.242.1983 fax
lreusch@att.net

Sincerely,

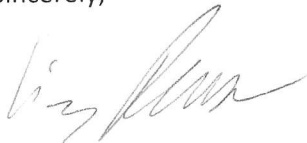
A handwritten signature in cursive script, appearing to read "Liz Reusch".

Liz Reusch
Secretary, Reusch Well Service, Inc.

Reusch Well Service, Inc.
PO Box 520
Ottawa, KS 66067

July 13, 2011

Stephen & Julie Wolderhoff
37135 W 175th St.
Edgerton, KS 66021

Dear Stephen & Julie Wolderhoff:

The Kansas Surface Owner Notice Act requires that we provide you notice that we are drilling 2 wells on the Hendrix lease. Enclosed are copies of the Intent to Drill form (C-1) that we have filed with the Kansas Corporation Commission. This requires no response from you, it is for your information only. If you have any questions you may contact Bob Reusch at:

Reusch Well Service, Inc.
PO Box 520
Ottawa, KS 66067
785.418.4254 phone
785.242.1983 fax
lreusch@att.net

Sincerely,

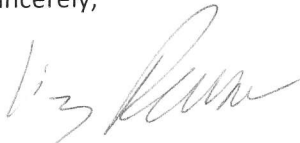
A handwritten signature in cursive script, appearing to read "Liz Reusch".

Liz Reusch
Secretary, Reusch Well Service, Inc.

Reusch Well Service, Inc.
PO Box 520
Ottawa, KS 66067

July 13, 2011

Gary S. Huppe
17535 Edgerton Rd
Edgerton, KS 66021

Dear Gary Huppe:

The Kansas Surface Owner Notice Act requires that we provide you notice that we are drilling 2 wells on the Hendrix lease. Enclosed are copies of the Intent to Drill form (C-1) that we have filed with the Kansas Corporation Commission. This requires no response from you, it is for your information only. If you have any questions you may contact Bob Reusch at:

Reusch Well Service, Inc.
PO Box 520
Ottawa, KS 66067
785.418.4254 phone
785.242.1983 fax
lreusch@att.net

Sincerely,

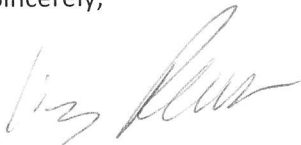
A handwritten signature in cursive script, appearing to read "Liz Reusch".

Liz Reusch
Secretary, Reusch Well Service, Inc.

Reusch Well Service, Inc.
PO Box 520
Ottawa, KS 66067

July 13, 2011

Steve Thomas
536 N Winwood
Gardner, KS 66030

Dear Steve Thomas:

Eastern Kansas Surface Casing Order #133.891-C requires us to notify you that we will be drilling an oil well within 660' of your water well. This requires no response from you. If you have any questions you may contact Bob Reusch at 785.418.4254.

Sincerely,

A handwritten signature in cursive script, appearing to read "Liz Reusch".

Liz Reusch
Secretary, Reusch Well Service, Inc.

Reusch Well Service, Inc.
PO Box 520
Ottawa, KS 66067

July 13, 2011

Earl Cobb
3715 W 176th Terr.
Edgerton, KS 66021

Dear Earl Cobb:

Eastern Kansas Surface Casing Order #133.891-C requires us to notify you that we will be drilling an oil well within 660' of your water well. This requires no response from you. If you have any questions you may contact Bob Reusch at 785.418.4254.

Sincerely,

A handwritten signature in cursive script, appearing to read "Liz Reusch".

Liz Reusch
Secretary, Reusch Well Service, Inc.

Conservation Division
Finney State Office Building
130 S. Market, Rm. 2078
Wichita, KS 67202-3802



Phone: 316-337-6200
Fax: 316-337-6211
<http://kcc.ks.gov/>

Mark Sievers, Chairman
Ward Loyd, Commissioner
Thomas E. Wright, Commissioner

Sam Brownback, Governor

July 28, 2011

BOB REUSCH
Reusch Well Service, Inc.
PO BOX 520
OTTAWA, KS 66067

Re: Drilling Pit Application
HENDRIX WW1
NW/4 Sec.30-14S-22E
Johnson County, Kansas

Dear BOB REUSCH:

District staff has inspected the above referenced location and has determined that the reserve pit shall be constructed **without slots**, the bottom shall be flat and reasonably level, and the free fluids must be removed. The fluids are to be removed from the reserve pit as soon as practical after drilling operations have ceased.

If production casing is set all completion fluids shall be removed from the working pits daily. NO completion fluids or non-exempt wastes shall be placed in the reserve pit.

The fluids should be taken to an authorized disposal well. Please call the District Office at (620) 432-2300 when the fluids have been removed. Please file form CDP-5 (August 2008), Exploration and Production Waste Transfer, through KOLAR within 30 days of fluid removal.

A copy of this letter should be posted in the doghouse along with the approved Intent to Drill. If you have any questions or concerns please feel free to contact the District Office at (620) 432-2300.