

# WELL RECORD

Mail to Corporation Commission, Oklahoma City, Oklahoma

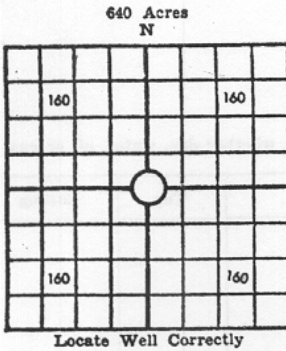

COUNTY McPherson, SEC. 29, TWP. 21S, RGE. 1W  
 COMPANY OPERATING Continental Oil Company  
 OFFICE ADDRESS Ponca City, Oklahoma  
 FARM NAME J.P. Husman WELL NO. #9  
 DRILLING STARTED Sept. 4, 1939, DRILLING FINISHED Sept. 30, 1939  
 DATE OF FIRST PRODUCTION 10-4-39 COMPLETED  
 WELL LOCATED 330' North and 330' East of West 1/4 Corner  
of the above section 1/4 it. North of South  
 Line and 1/4 it. East of West Line of Quarter Section.  
 Elevation (Relative to sea level) DERRICK FLR. 1470 GROUND 1470  
 CHARACTER OF WELL (Oil, gas or dry hole) Oil

OIL OR GAS SANDS OR ZONES

Name	From	To	Name	From	To
1 <u>Hunton Lime</u>	<u>3240</u>	<u>3280</u>	<u>4</u>		
2			<u>5</u>		
3			<u>6</u>		

WATER SANDS

Name	From	To	Water level	Name	From	To	Water level
1				<u>4</u>			
2				<u>5</u>			
3				<u>6</u>			

CASING RECORD

Size	Wt.	Thds.	Make	Amount Set		Amount Pulled		Packer Record			
				Ft.	In.	Ft.	In.	Size	Length	Depth Set	Make.
<u>10-3/4"</u>	<u>40</u>	<u>8</u>	<u>LW</u>	<u>138</u>	<u>1</u>		<u>None</u>				
<u>6"</u>	<u>15</u>	<u>8 DP</u>	<u>SS</u>	<u>3266</u>	<u>4</u>		<u>None</u>				

Liner Record: Amount ..... Kind ..... Top ..... Bottom .....

CEMENTING AND MUDDING RECORD

Size	Amount Set		Sacks Cement	Chemical		Method of Cementing	Amount	Mudding Method	Results (See Note)
	Feet	In.		Gal.	Make				
<u>10-3/4"</u>	<u>138</u>	<u>1</u>	<u>165</u>			<u>Halliburton</u>			
<u>6"</u>	<u>3266</u>	<u>4</u>	<u>300</u>			<u>do</u>			
				<u>4,000</u>	<u>Chemical Process Co</u>				

NOTE: What method was used to protect sands when outer strings were pulled? .....

NOTE: Were bottom hole plugs used? ..... If so, state kind, depth set and results obtained .....

TOOLS USED

Rotary tools were used from 0 feet to 3254 feet, and from ..... feet to .....  
 Cable tools were used from 3254 feet to 3280 feet, and from ..... feet to .....  
 Type Rig. ....

PRODUCTION DATA

Production first 24 hours 427 bbls. Gravity ....., Emulsion ..... per cent., Water ..... per cent  
 Production second 24 hours ..... bbls. Gravity ....., Emulsion ..... per cent., Water ..... per cent  
 If gas well, cubic per 24 hours ..... Rock Pressure lbs. per square inch .....

I, the undersigned, being first duly sworn upon oath, state that this well record is true, correct and complete according to the records of this office and to the best of my knowledge and belief.

JPN:HW  
 10-6-39  
 LPC  
 GEOL.  
 GULE  
 OHIO  
 FILE

J.P. Husman  
 Name and title of representative of company.

Subscribed and sworn to before me this the 6 day of October 1939

My Commission expires ..... Notary Public.

**FORMATION RECORD**

Give detailed description and thickness of all formations drilled through and contents of sands, whether dry, water, oil or gas

Formation	Top	Bottom	Formation	Top	Bottom
Surface Clay & Sand	0	20			
Shale	20	44			
Shale & Shells	44	84			
Sand	84	99			
Sandy Lime	99	129			
Sand and Lime	129	148	Run & set 138'1" of 10-3/4" casing at		
Lime	148	237	149' cemented w/165 sacks & 200#CC		
Shale & Shells	237	439			
Broken Lime	439	572			
Shale & Shells	572	677			
Lime & Shale Break	677	773			
Broken Lime	773	894			
Lime & Shale	894	1040			
Broken Lime	1040	1142			
Shale & Shells	1142	1621			
Broken Lime	1621	1745			
Shale & Shells	1745	1813			
Broken Lime	1813	1901			
Lime	1901	1996			
Broken Lime	1996	2110			
Sandy Lime	2110	2150			
Broken Lime	2150	2200			
Lime	2200	2210			
Shale	2210	2249			
Shale & Shells	2249	2290			
Shale	2290	2294			
Lime	2294	2557			
Hard Lime	2557	2609			
Sticky Shale	2609	2631			
Broken Lime	2631	2664			
Shale	2664	2692			
Shale & Shells	2692	2741			
Shale	2741	2890			
Chat	2890	2898			
Chert	2898	2942			
Chat	2942	3014			
Chert	3014	3032			
Chat	3032	3037			
Lime	3037	3127			
Shale	3127	3184			
Shale & Shells	3184	3231			
Shale	3231	3240			
Hunton Lime	3240	3254	Show of oil Run & set 3266'4" of 6"OD. at		
Lime	3254	3280	3242' & cemented w/300 sacks Ideal cement		

Total Depth from Ground level 3280'

