

**OPERATOR :** Samuel Gary Jr & Associates, Inc 1515 Wynkoop Street, Suite 700  
Denver, Colorado 80202 office :303-831-4673 ; fax :303-863-7285

**WELL NAME :** Legleiter et al 1-10

**LOCATION :** 260 FSL / 2300 FWL Sec. 10 - 16S - 16W  
RUSH COUNTY, KS

**SURFACE OWNER:** William Legleiter  
107 4th Street  
Liebenthal, KS 67553

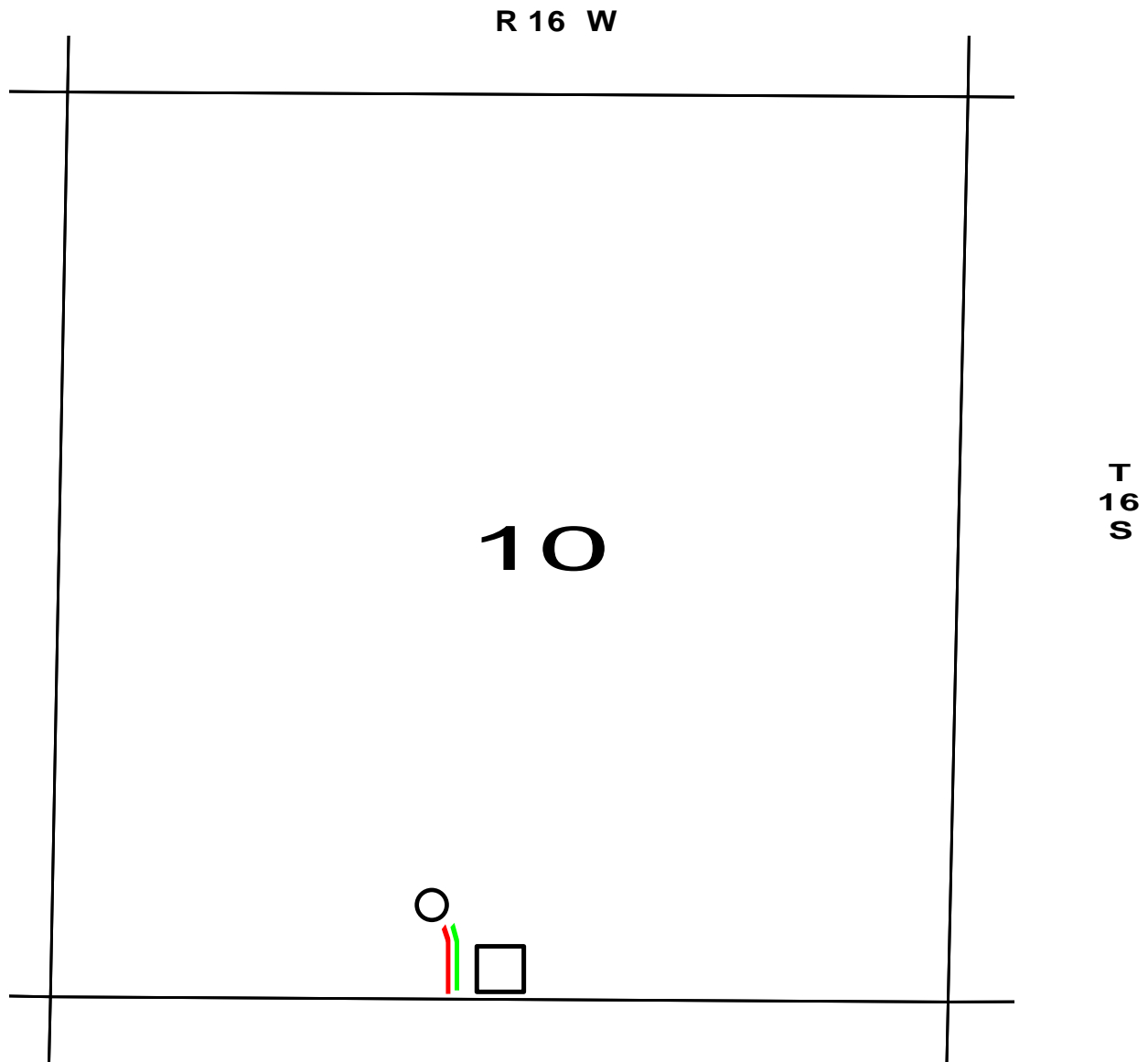

○ PROPOSED WELL LOCATION

□ ESTIMATED LOCATION OF TANK BATTERY

— ESTIMATED LOCATION OF FLOW LINES

— ESTIMATED LOCATION OF ELECTRICAL LINES