

SHELL GULF OF MEXICO, INC.  
 SCHROCK LEASE  
 SW.1/4, SECTION 12, T35S, R10W  
 BARBER COUNTY, KANSAS

Notes:

1. Set (2) wood stakes at location site.
2. All flagging Red & Yellow.
3. Overhead power available at N.1/4 of W. line, Sec.12.
4. Kansas One Call System Inc. should be notified before excavation (1-800-344-7233).
5. CAUTION: Various pipelines in Sec.12.
6. Contact landowner for best access.

\*Ingress and egress to location as shown on this plat is for usage only and may not be legally opened for public use. Contact landowner, tenant and county road department for access.

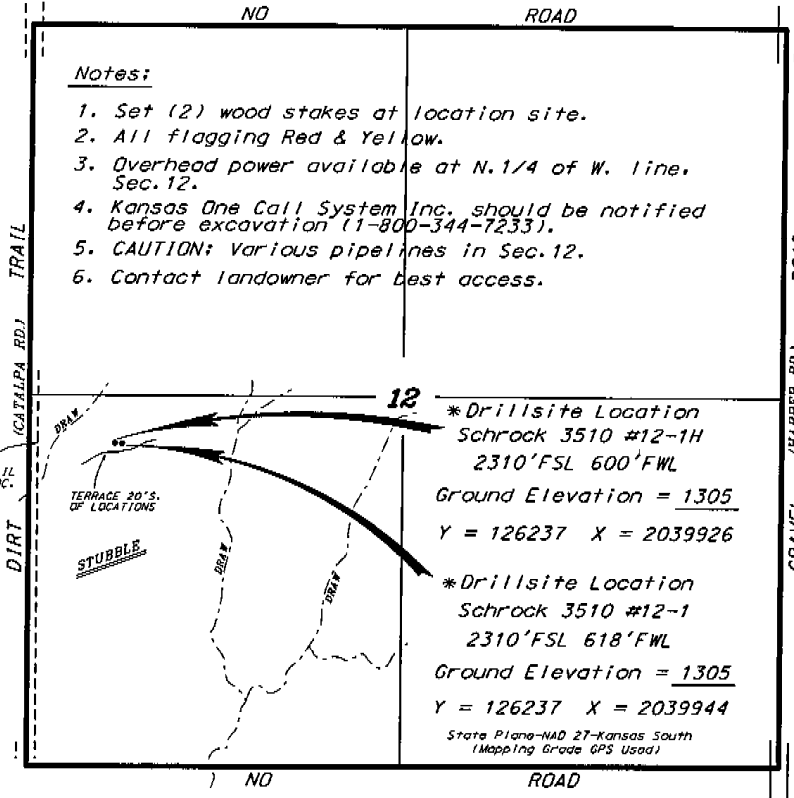

\*Drillsite Location  
 Schrock 3510 #12-1H  
 2310'FSL 600'FWL  
 Ground Elevation = 1305  
 Y = 126237 X = 2039926

\*Drillsite Location  
 Schrock 3510 #12-1  
 2310'FSL 618'FWL  
 Ground Elevation = 1305  
 Y = 126237 X = 2039944

State Plane-NAD 27-Kansas South  
 Mapping Grade GFS Used

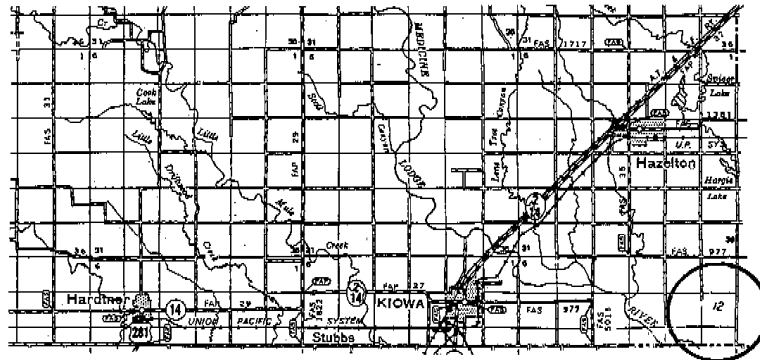

\* Controlling data is based upon the best maps and photographs available to us and upon a regular section of land containing 40 acres.  
 \* Approximate section lines were determined using the normal standard of care of official surveyors practicing in the state of Kansas; the section corners, which establish the precise section lines, were not necessarily located, and the exact location of the drillsite location in the section is not guaranteed; therefore, the operator securing this service and occupying this plat, and all other parties relying thereon agree to hold Central Kansas Oilfield Services, Inc., its officers and employees harmless from all losses, costs and expenses and legal liabilities released from any liability from incidental or consequential damages.  
 \* Elevations derived from National Geodetic Vertical Datum.

Date July 27, 2011

CENTRAL KANSAS OILFIELD SERVICES, INC. (620)792-1977