

OPERATOR : Samuel Gary Jr & Associates, Inc 1515 Wynkoop Street, Suite 700
Denver, Colorado 80202 office :303-831-4673 ; fax :303-863-7285

WELL NAME : HERL 1-34

LOCATION : 2100 FSL / 950 FEL Sec. 34-14S-17W ELLIS COUNTY

SURFACE OWNER : Daniel Herl, Et Ux
742 320th Ave.
Victoria, KS 67671

R 17 W

34

T
14
S

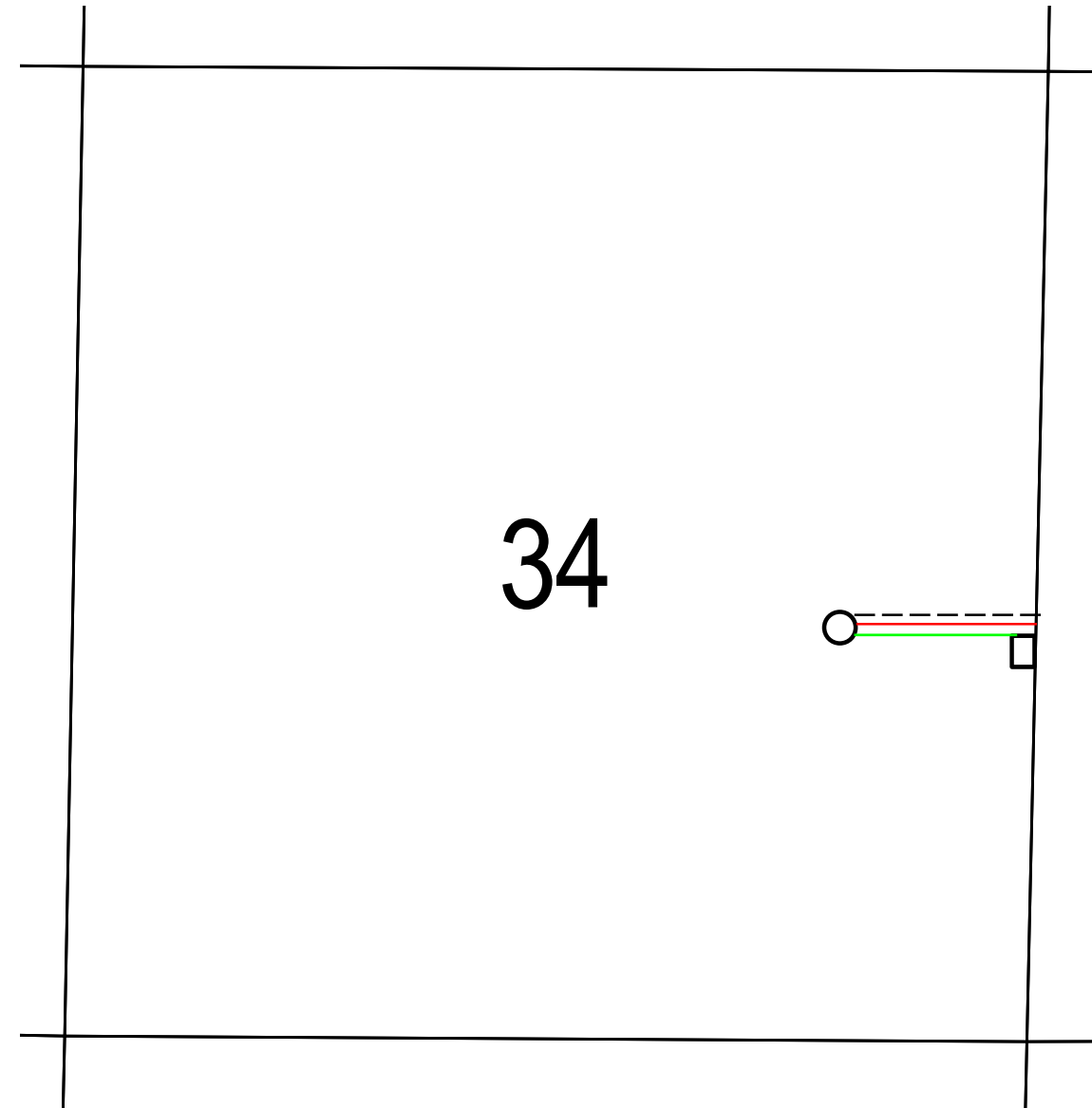

PROPOSED WELL LOCATION



ESTIMATED LOCATION OF TANK BATTERY



ESTIMATED LOCATION OF FLOW LINES
ESTIMATED LOCATION OF ELECTRICAL LINES



ESTIMATED LEASE ROAD