

**BACH OIL PRODUCTION, INC.**  
**JESSUP LEASE**  
**SE. 1/4, SECTION 11, T15, R19W**  
**PHILLIPS COUNTY, KANSAS**

\*Ingress and egress to location as shown on this plat is per usage only and may not be legally opened for public use. Contact landowner, tenant and county road department for access.

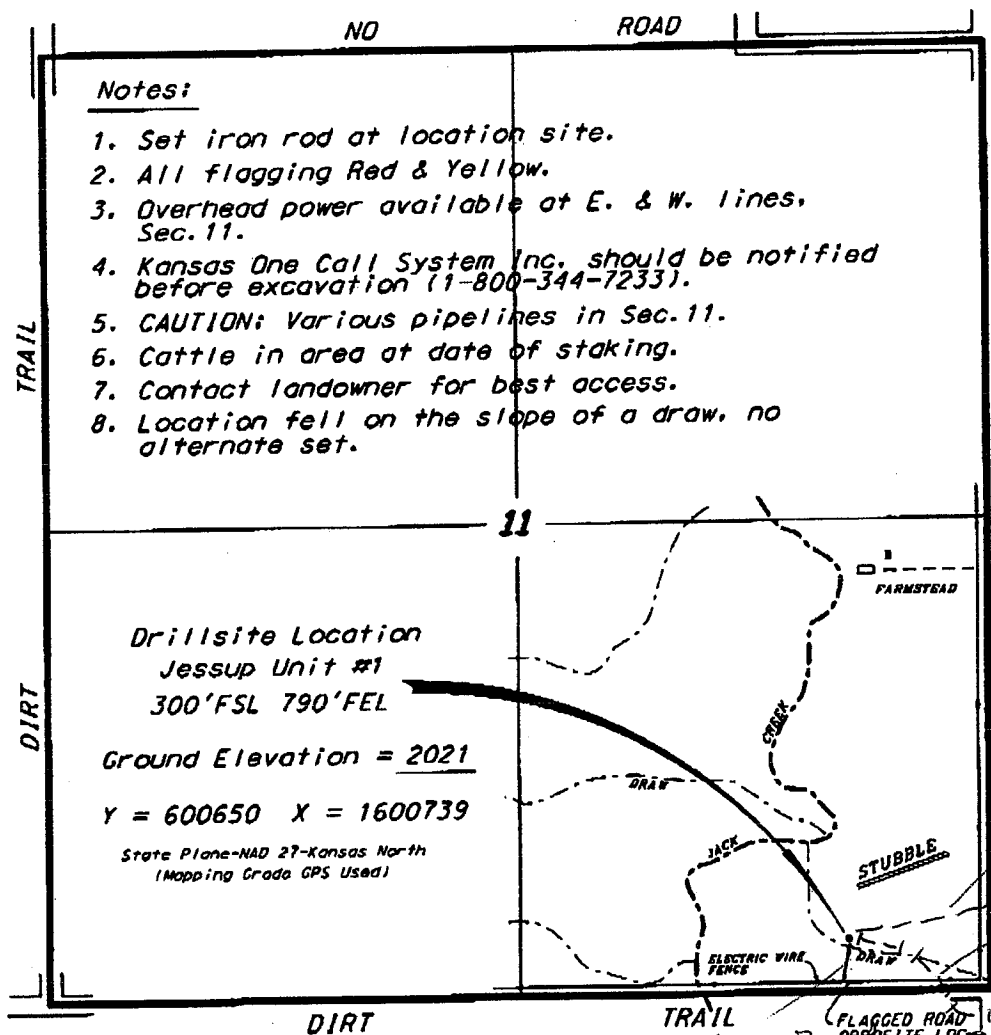

Notes:

1. Set iron rod at location site.
2. All flagging Red & Yellow.
3. Overhead power available at E. & W. lines. Sec. 11.
4. Kansas One Call System Inc. should be notified before excavation (1-800-344-7233).
5. CAUTION: Various pipelines in Sec. 11.
6. Cattle in area at date of staking.
7. Contact landowner for best access.
8. Location fell on the slope of a draw, no alternate set.

**Drillsite Location**  
**Jessup Unit #1**  
**300'FSL 790'FEL**

**Ground Elevation = 2021**

**Y = 600650 X = 1600739**

State Plane-NAD 27-Kansas North  
 (Mapping Grade GPS Used)

SCALE 1" = 1000'

*Electrical Line*  
*Lead Line*

*Tank Batteries*

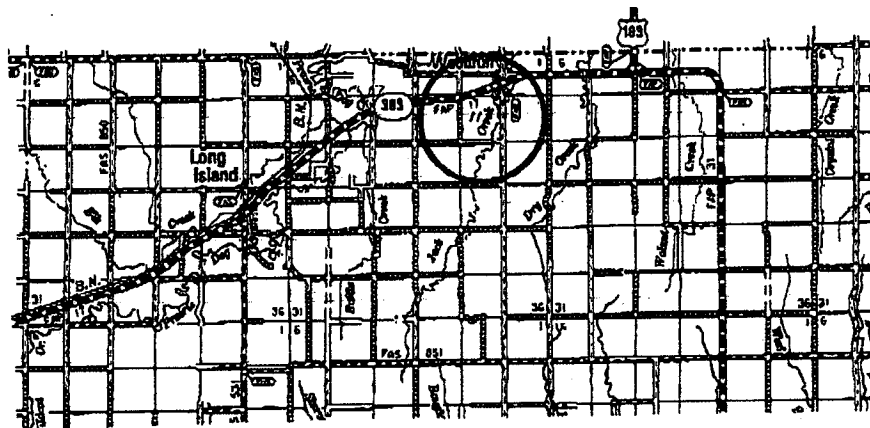

\* Controlling data is based upon the best maps and photographs available to us and upon a regular section of land containing 360 acres.  
 \* Apparent section lines were determined using the normal standard of care of oilfield surveyors practicing in the state of Kansas. The section corners, which establish the precise section lines, were not necessarily located, and the exact location of the drillsite location in the section is not guaranteed. Therefore, the operator assuming this service and accepting this plat and all other services relating thereto agrees to hold Central Kansas Oilfield Services, Inc., its officers and employees harmless from all losses, costs and expenses and said parties released from any liability from incidental or consequential damages.  
 \* Elevations derived from National Geodetic Vertical Datum.

Date November 17, 2011