

ADVANTAGE ELEVATIONS

OIL FIELD SURVEYORS

BOX 8604 - PRATT, KS 67124
(620) 672-6491

1117114
INVOICE NO

N-10 EXPLORATION LLC
OPERATOR

B 9 Medicine River Ranch
NO FARM

Barber 15 34s 11w
COUNTY S T R

2310' FNL & 690' FEL of Sec.
LOCATION

ELEVATION: 1357' GREL.



N-10 EXPLORATION LLC
PO Box 195
Attica, KS 67009-0195

AUTHORIZED BY: Randy Newberry

SCALE: 1" = 1000'

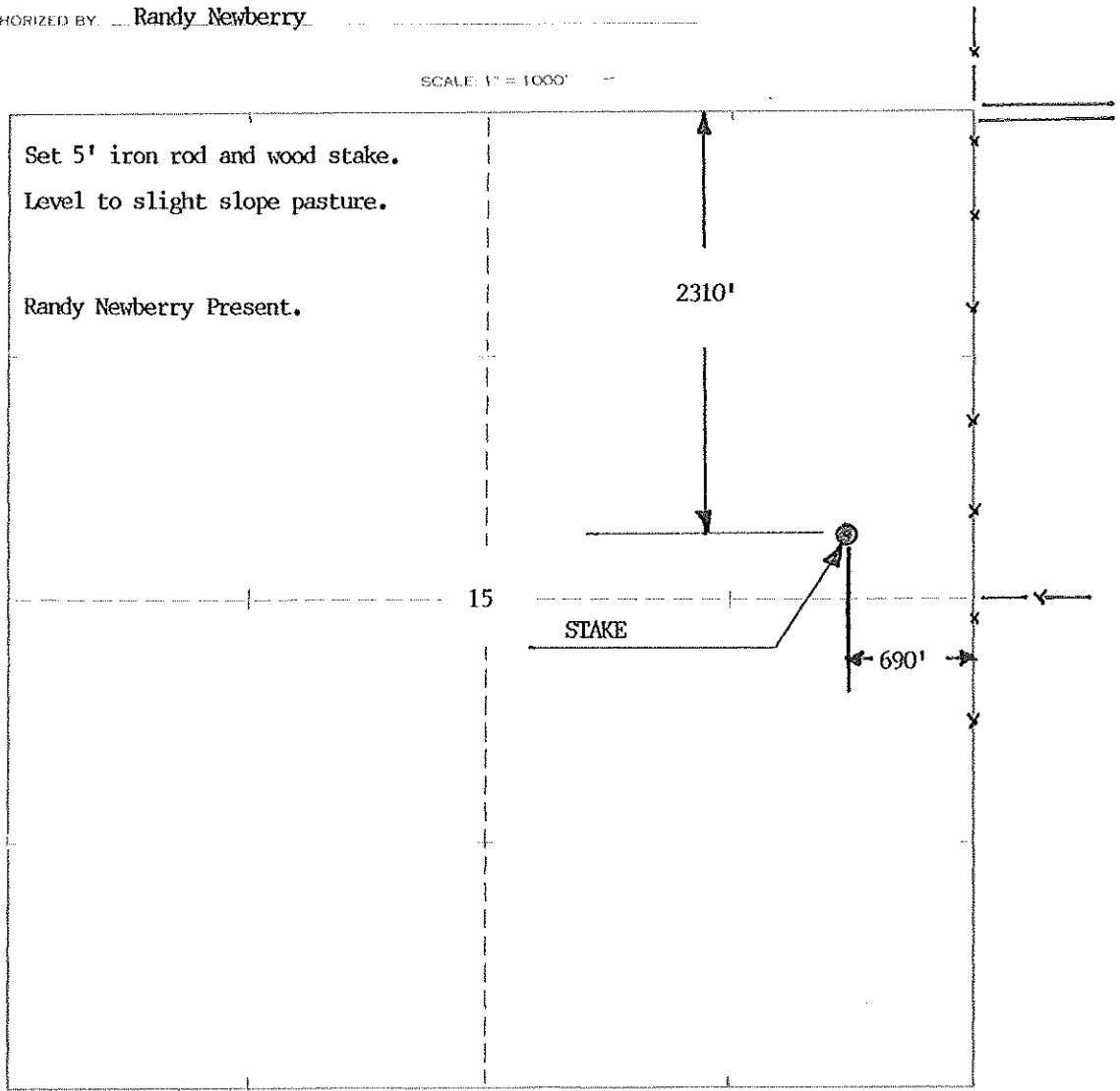

Staked 11/17/11