

OPERATOR : Samuel Gary Jr & Associates, Inc 1515 Wynkoop Street, Suite 700
Denver, Colorado 80202 office :303-831-4673 ; fax :303-863-7285

WELL NAME : ELSIE 2-13

LOCATION : 690' FNL / 1190' FEL Sec. 13-16S-17W RUSH COUNTY



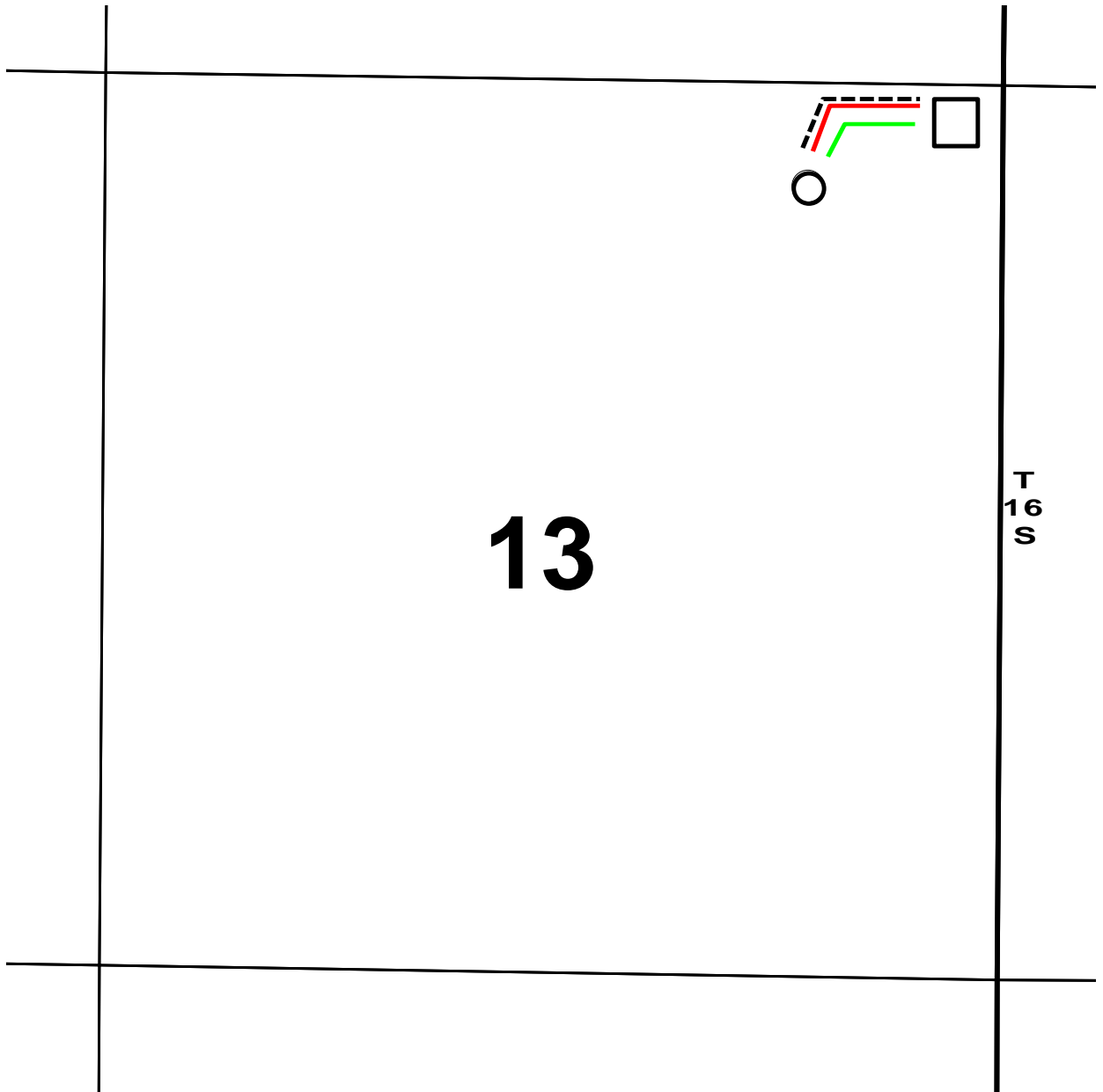

SURFACE OWNER : ELSIE & JULIUS J. SUPPES
PO BOX 96
OTIS, KS 67565

R 17 W



T
16
S

13

-  PROPOSED WELL LOCATION
-  ESTIMATED LOCATION OF TANK BATTERY
-  ESTIMATED LEASE ROAD
-  ESTIMATED LOCATION OF FLOW LINES
-  ESTIMATED LOCATION OF ELECTRICAL LINES