

ATLAS OPERATING, LLC
CYPRESS LEASE
SE.1/4, SECTION 30, T29S, R9W
KINGMAN COUNTY, KANSAS

SAND (SW. 100 ST.) ROAD

Notes:

1. Set (2) wood stakes at location site.
2. All flagging Red & Yellow.
3. Overhead power available at S., E. & W. lines, Sec. 30.
4. Kansas One Call System Inc. should be notified before excavation (1-800-344-7233).
5. CAUTION: Various pipelines in Sec. 30.
6. Contact landowner for best access.
7. Location fell 80' west of the flowline of a creek (wet), no alternate set.
8. Set alternate 12/27/11 per instructions.
9. Set second alternate 1/3/12 per instructions.

Drillsite Location
Cypress #1

660'FSL 1320'FEL
Ground Elevation = 1617
Y = 298965 X = 2046079

*Alternate Location
560'FSL 1420'FEL
Ground Elevation = 1618

Y = 298865 X = 2045979

*Alternate Location
330'FSL 1420'FEL
Ground Elevation = 1618
Y = 298635 X = 2045979

State Plane NAD 27-Kansas South
(Mapping Grade GPS Used)

30

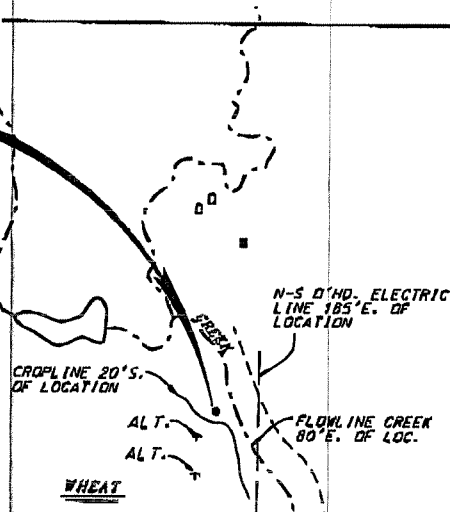

GRAVEL (SW. 110 ST.) ROAD

FLAGGED ROAD
OPPOSITE LOC.

FIELD ENTRANCE

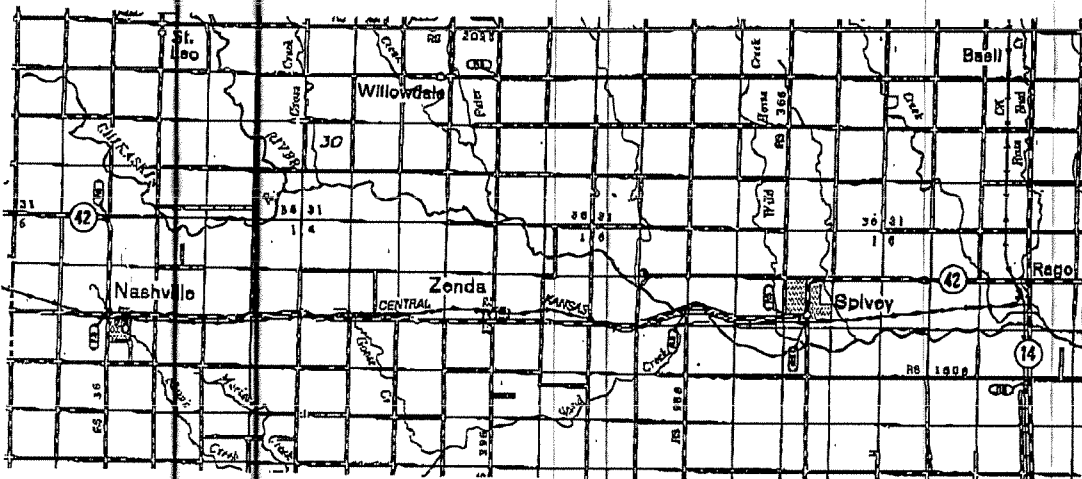

*Ingress and egress to location as shown on this plat is for usage only and may not be legally opened for public use. Contact landowner, tenant and county road department for access.



Central Kansas Surveying data is based upon the best maps and photographs available to us and upon a regular section of land containing 640 acres.

Approximate section lines were determined using the national standard of care of oilfield surveyors practicing in the state of Kansas. The section corners, which establish the precise section lines, were not necessarily located, and the exact location of the drillsite location in the section is not guaranteed. Therefore, the operator accepting this service and accepting this plat and all other parties relying thereon agree to hold Central Kansas Drilling Services, Inc., its officers and employees harmless from all losses, costs and expenses and said entities released from any liability for personal or consequential damages.

Elevations derived from National Geodetic Vertical Datum.

Date January 3, 2012

